

# Installation instructions

## For set # 3.3158 & 3.3159

| Set # 3.3158       | Set # 3.3159       |
|--------------------|--------------------|
| Position #1,2,3    | Position #1,2,3    |
| 3210 Bushing       | 3210 Bushing       |
| 3213 Thrust washer | 3213 Thrust washer |
| Position # 4       | Position # 4       |
| 3011 Bushing       | 3230 Bushing       |
| 3231 Thrust washer | 3231 Thrust washer |

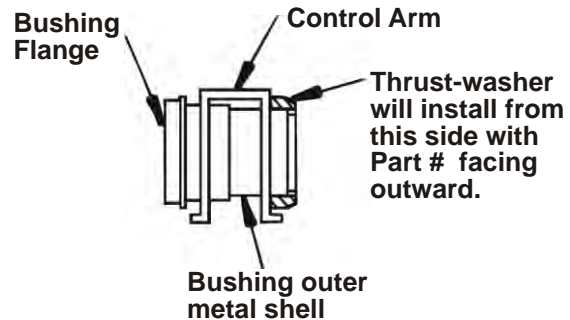

### MUST USE EXISTING OUTER METAL SHELLS AT POSITIONS # 1,2 & 3.

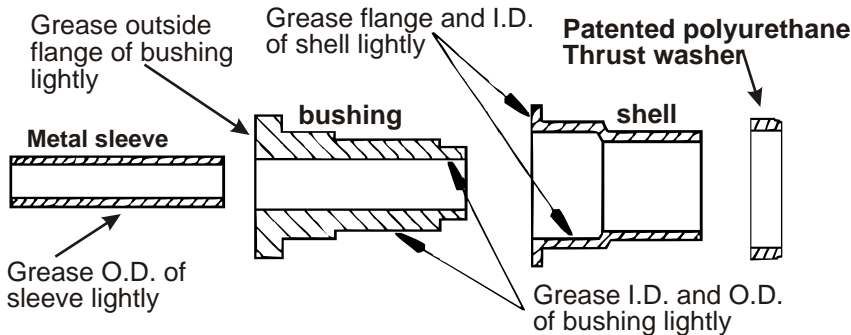

The thrust washers are designed to prevent the control arm from walking side-to-side by accepting side load pressure created during hard cornering. Most kits contain more than one part #. It is very important to install them at the correct location.

**See illustration A**

If your new bushing kit does not have new shells and/or sleeves, you must reuse the original shells and /or sleeves.

For ease of installation of bushing and sleeve (or new shell when supplied) disassemble new bushing unit. (When supplied install shell first). Grease I.D. of shell. Grease bushing and install in shell. Grease sleeve and install in bushing

**IMPORTANT:** Coat urethane bushing, sleeve and shell I.D. lightly with supplied grease. (all surfaces of bushings that contact metal)

**Note:** When reusing original shells, make sure inside surfaces are free of all old bushing material.

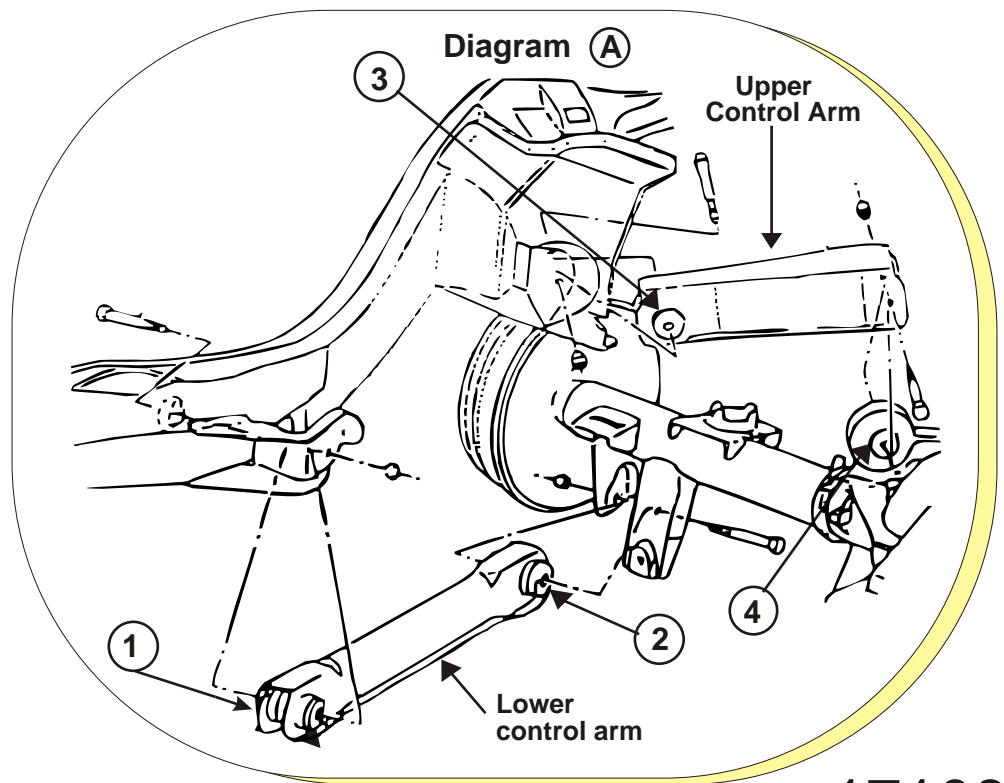

17108