

# Multi Purpose Differential Thrust-Washer Instruction Sheet

The thrust washers are designed to prevent the control arm from walking side-to-side by accepting side load pressure created during hard cornering. Most kits contain more than one part #. It is very important to install them at the correct location. See illustration for your set #. Remember, apply a light amount of the supplied grease to all faces that contact metal.

**Notes:** On GM vehicles with a 12 bolt inspection cover, a slight modification must be done to one of Pt. # 3089. A flat area must be cut on thrust washer (see illustration) before installing. This allows for sufficient clearance between bushing outer shell and differential casting on drivers side upper. **(12 bolt only)**

**Set # 3-3132:** Vehicles with boxed in lower control arms use Pt. #3087 instead of Pt. # 3088. 1964-67 vehicles use Pt. # 3088

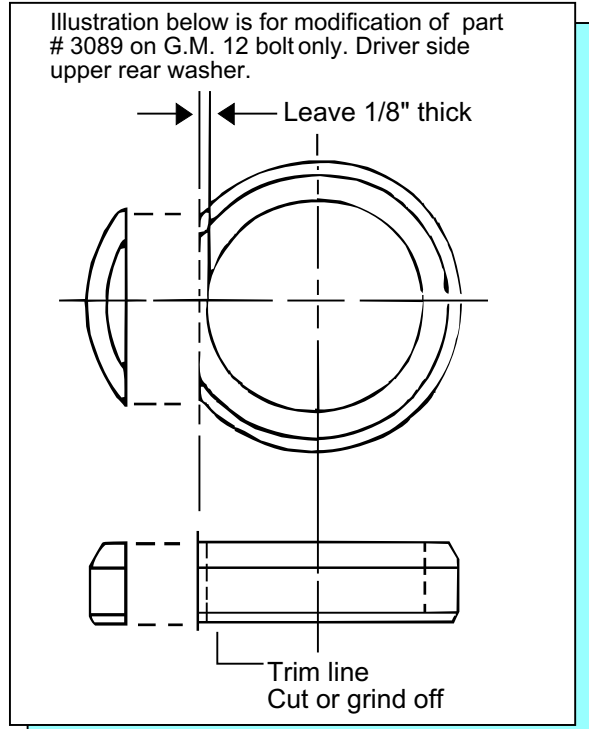
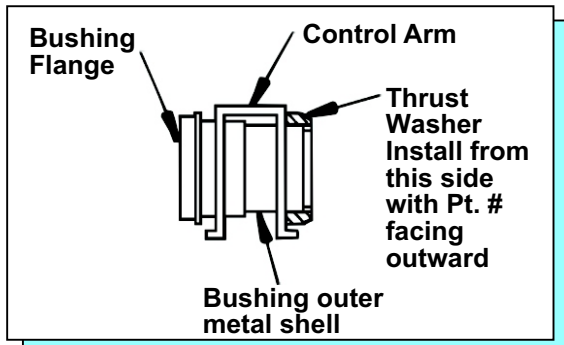

- Find your set # below. Use parts list with positional diagram (A)**
- |                                 |                     |
|---------------------------------|---------------------|
| <b>Set # 3-3132</b> (see Notes) | <b>Set # 4-3120</b> |
| Position # 1 - 3088             | Position # 1 - 3087 |
| Position # 2 - 3088             | Position # 2 - 3087 |
| Position # 3 - 3087             | Position # 3 - 3141 |
| Position # 4 - 3089             |                     |
- 
- |                     |
|---------------------|
| <b>Set # 3-3133</b> |
| Position # 1 - 3088 |
| Position # 2 - 3088 |
| Position # 3 - 3087 |
| Position # 4 - 3110 |
- 
- |                     |
|---------------------|
| <b>Set # 3-3136</b> |
| Position # 1 - 3232 |
| Position # 2 - 3232 |
- 
- |                     |
|---------------------|
| <b>Set # 3-3140</b> |
| Position # 1 - 3128 |
| Position # 2 - 3119 |
| Position # 3 - 3114 |
| Position # 4 - 3114 |
- 
- |                     |
|---------------------|
| <b>Set # 3-3141</b> |
| Position # 1 - 3112 |
| Position # 2 - 3112 |
- 
- |                               |
|-------------------------------|
| <b>Set # 4-3114 or 4-3135</b> |
| Position # 1 - 3100           |
| Position # 2 - 3101           |
| Position # 3 - 3099           |
| Position # 4 - 3098           |
- 
- |                     |
|---------------------|
| <b>Set # 4-3115</b> |
| Position # 1 - 3109 |
| Position # 2 - 3101 |
| Position # 3 - 3099 |
| Position # 4 - 3098 |

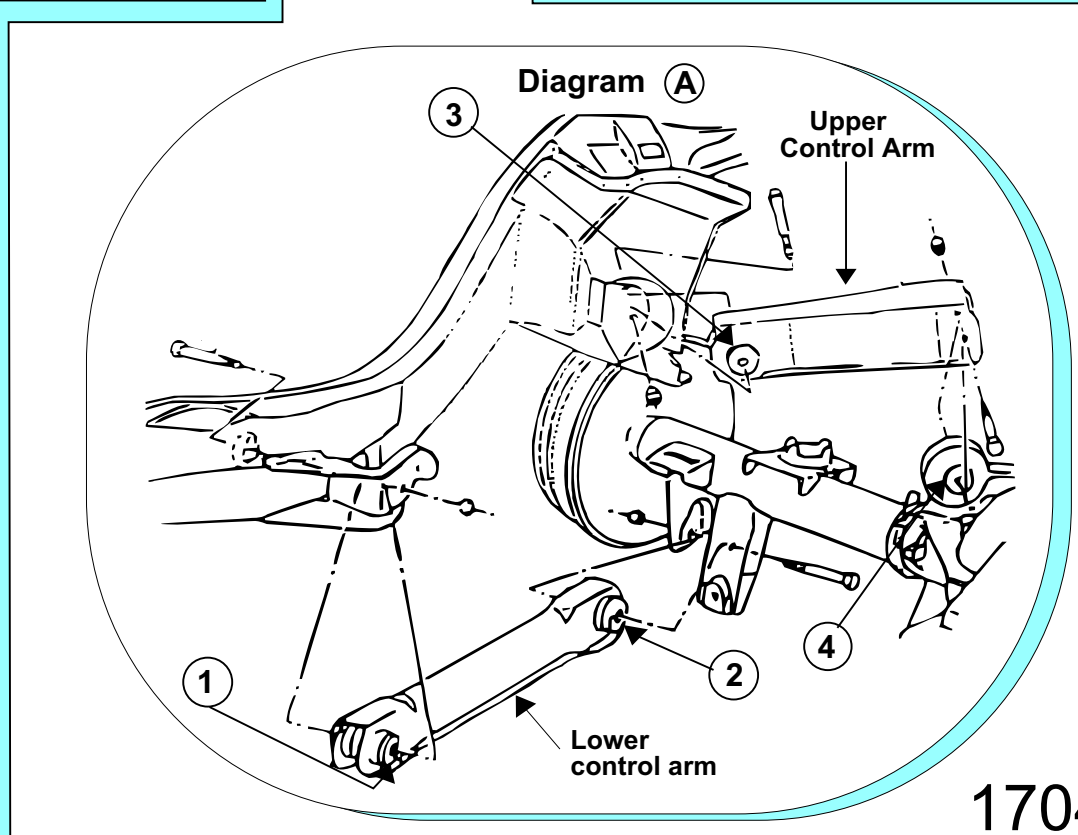

17041