

# EGR INSTALLATION INSTRUCTIONS

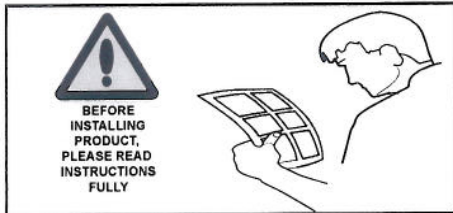

**Tools Required**



**Cleaning Notes**

- Spray with a firm water spray to remove any loose dirt.
- Wash with water, detergent and a soft cloth or sponge.
- Do not use petroleum based solvents or abrasives.
- Do not drive for four hours after installation.
- Do not use automatic car wash.

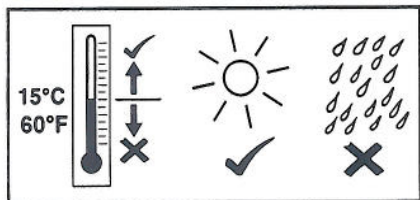
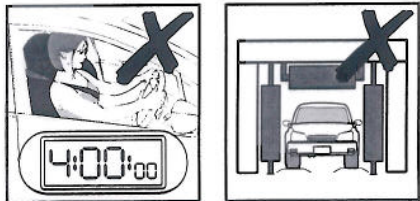

MADE IN USA

1. Clean the front and rear door frames with a mild car wash soap and water solution. Dry the door frames using a clean soft cloth.

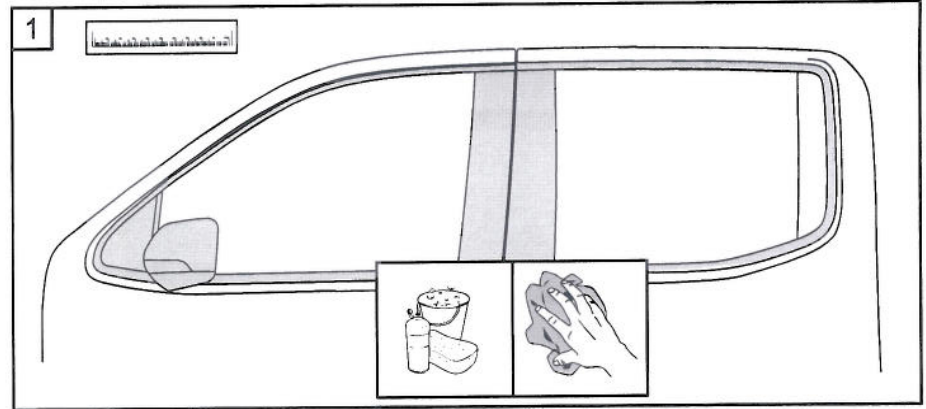

2. Wind the front window down and trial fit the slimline weathershield onto the front door frame. Using a ruler, align the rear edge of the slimline weathershield 40mm (1 1/2) forward from the rear edge of the door frame. Align the top edge of the slimline weathershield 19mm (3/4) down from the top edge of the door frame. Note the tape attachment areas.

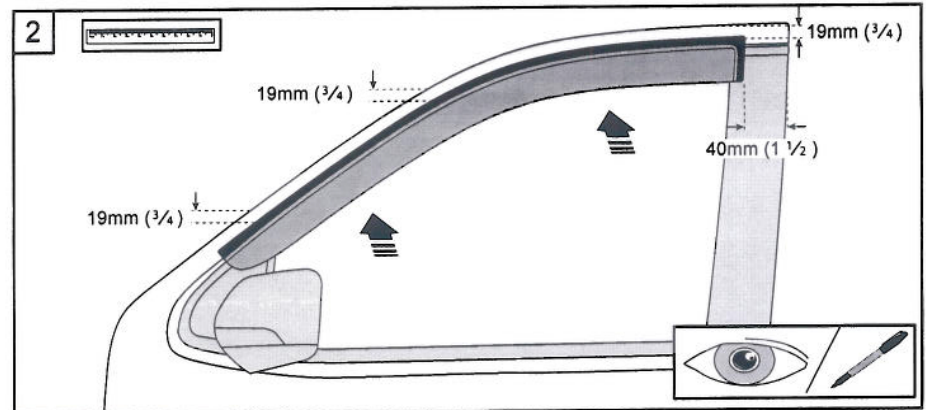

3. Wind the rear window down and trial fit the slimline weathershield onto the rear door frame. Using a ruler, align the front edge of the slimline weathershield 40mm (1 1/2) back from the front edge of the door frame. Align the top front edge and top center edge of the slimline weathershield 19mm (3/4) down from the top edge of the door frame. Note the tape attachment areas.

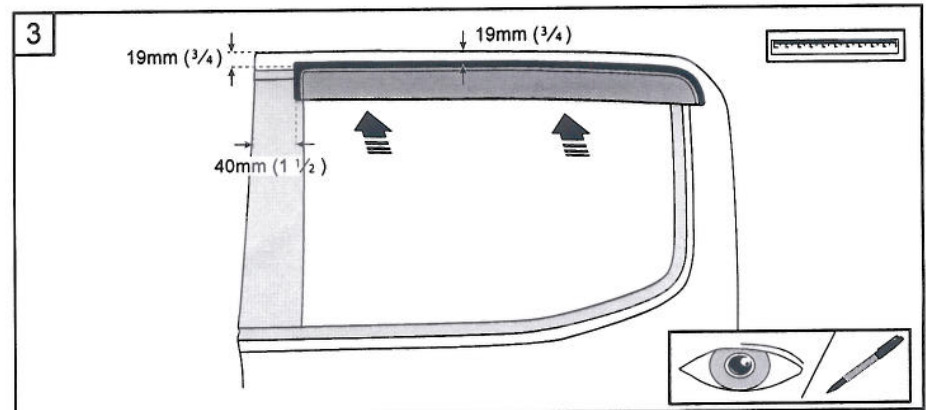

# EGR INSTALLATION INSTRUCTIONS

- 4• Clean the tape attachment areas on the door frame thoroughly with the alcohol prep pad provided. Wipe dry with a clean, dry cloth.

**IMPORTANT:**

Door frame must be clean prior to installing part on the door frame. Failure to clean will result in reduced tape adhesion to the door frame.

- 5• On the front weathershield peel back approximately 50mm (2") of the protective tape liner on the backing tape from each of the tape sections and fold the protective liner at 45° to the outside of the slimline weathershield.

**IMPORTANT:**

Do not touch the exposed surface of the backing tape.

- 6• Position the front slimline weathershield on the door frame. Double check the positioning of the slimline weathershield following the dimensions shown in step 2, then apply light pressure to the tape areas.

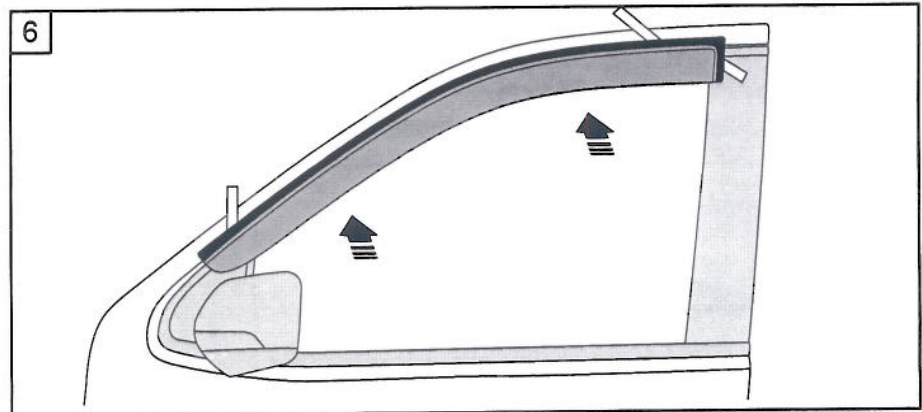
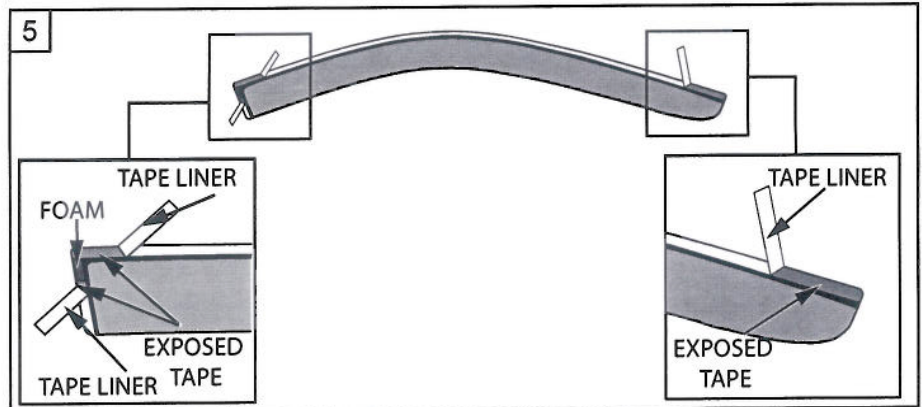
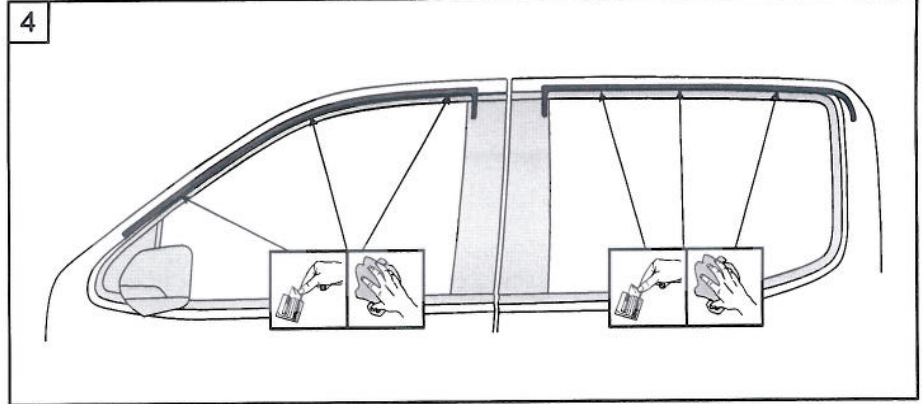

# EGR INSTALLATION INSTRUCTIONS

7• Slowly peel the remaining protective tape liner away by pulling on the exposed ends of liner, and apply firm pressure around the exposed attachment areas.

8• Using a clean, soft cloth, firmly rub down over the attachment areas 4 times to ensure maximum adhesion.

Repeat the previous steps for right hand side to complete the installation of the front slimline weathershields.

9• On the rear weathershield peel back approximately 50mm (2") of the protective tape liner on the backing tape from each end of the tape sections and fold the protective liner at 45° to the outside of the slimline weathershield.

**IMPORTANT:**  
Do not touch the exposed surface of the backing tape.

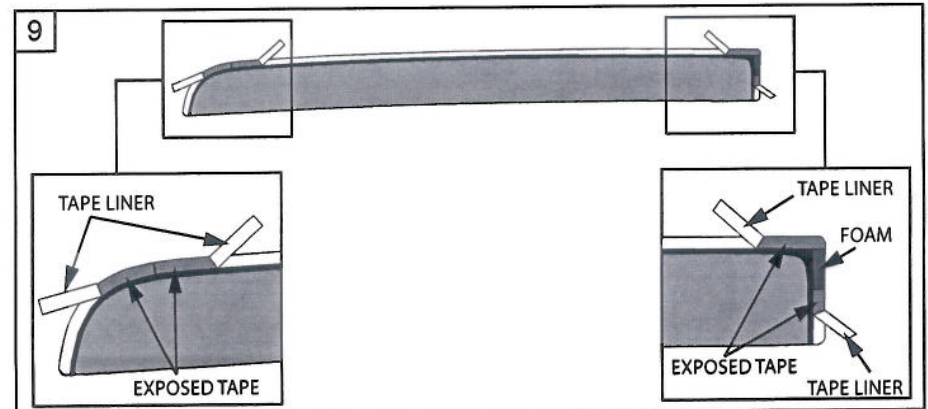
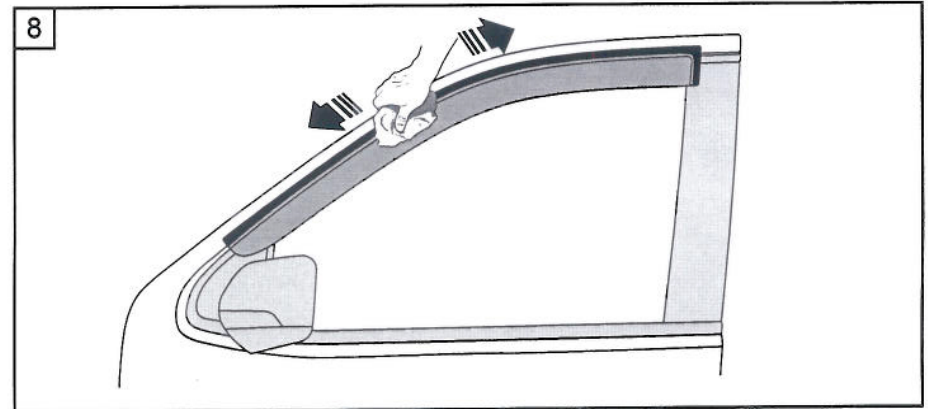
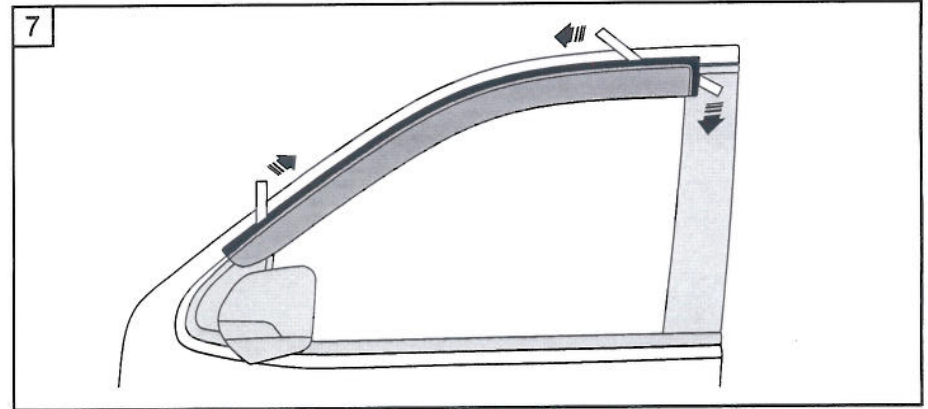

# EGR INSTALLATION INSTRUCTIONS

10• Position the rear slimline weathershield on the door frame. Double check the positioning of the slimline weathershield following the dimensions shown in step 3, then apply light pressure to the exposed tape areas.

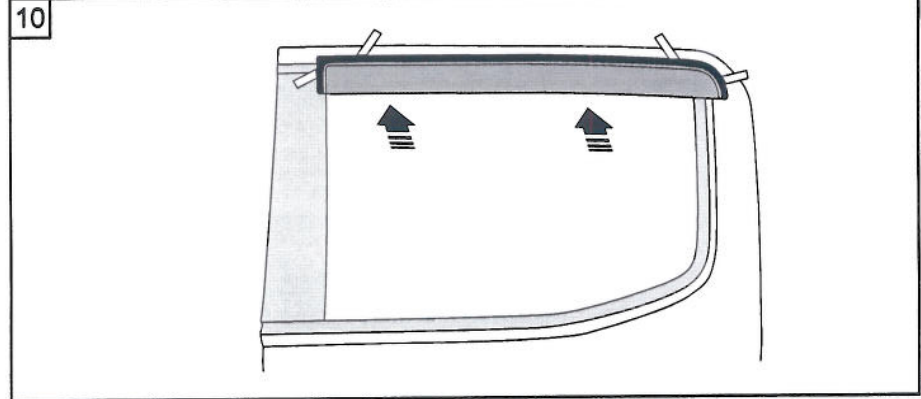

11• Slowly peel the remaining protective tape liner away by pulling on the exposed ends of liner, and apply firm pressure around the attachment areas.

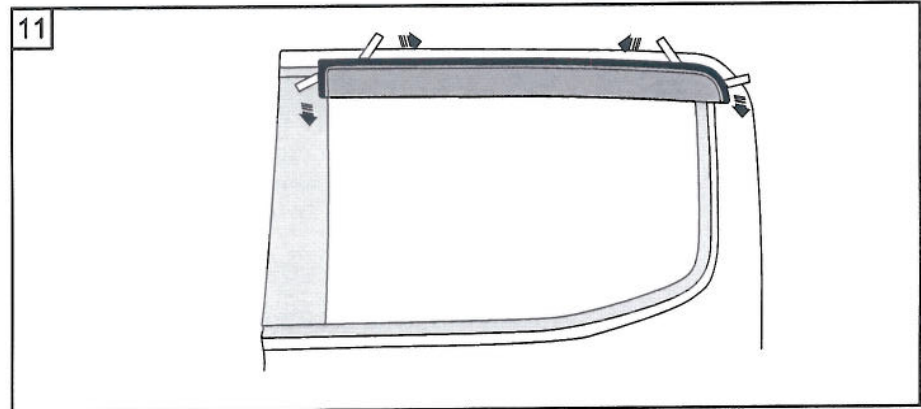

12• Using a clean, soft cloth, firmly rub down over the attachment areas 4 times to ensure maximum adhesion.

Repeat the previous steps for right hand side to complete the installation of the rear slimline weathershields.

