

Jammer CAI

INSTALL GUIDE

2009-2017 Dodge/RAM
5.7L HEMI

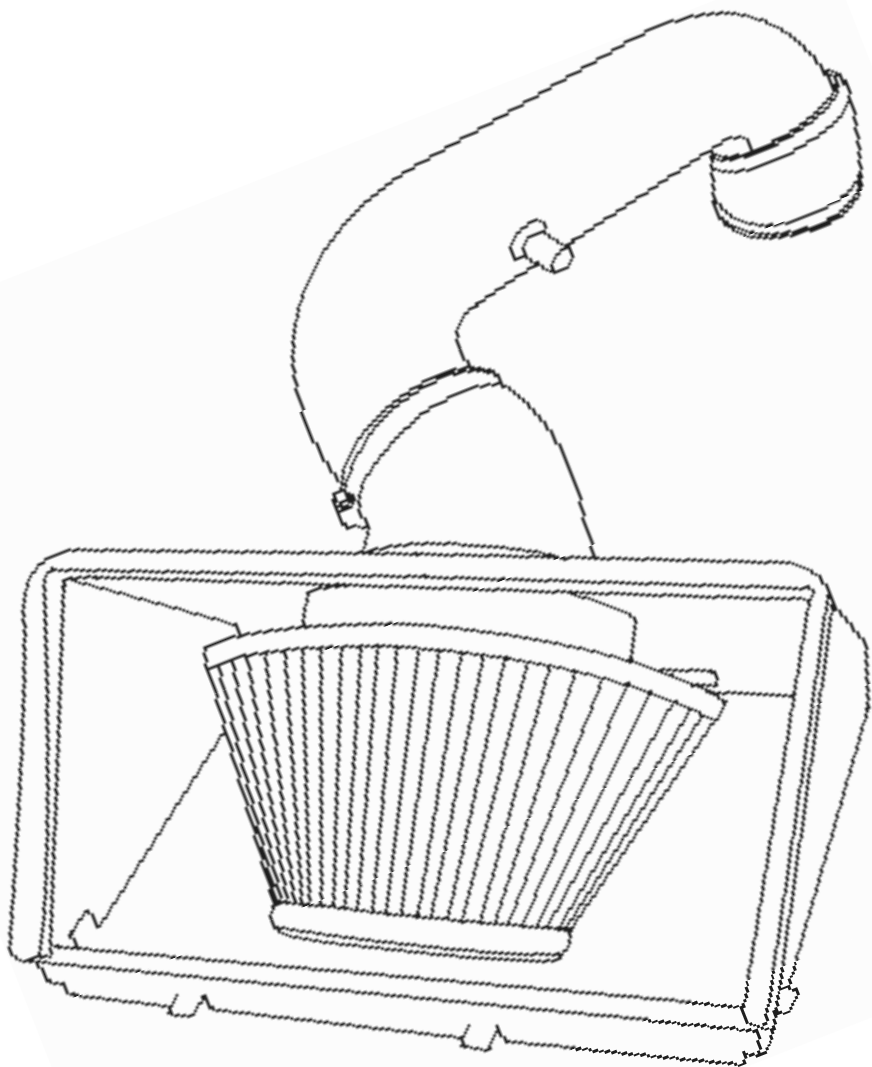

TABLE OF CONTENTS

3	GETTING STARTED
3	PARTS LIST
4	INSTALLATION INSTRUCTIONS
4	REMOVING THE STOCK INTAKE ASSEMBLY
6	INSTALLING THE AIR FILTER
7	INSTALLING THE HOUSING
9	INSTALLING THE INTAKE TUBE

GETTING STARTED

PARTS LIST

Item	Description	Qty
1	COUPLING, (3.5x2).....	1
2	GROMMET.....	1
3	INTAKE TUBE.....	1
4	CLAMP #056.....	3
5	COUPLING, ELBOW SILICONE.....	1
6	CLAMP #064.....	1
7	HEAT SHIELD.....	1
8	TRIM SEAL (29.25").....	1
9	AIR FILTER.....	1
10	ADAPTOR.....	1
11	BUTTON HEAD SCREW.....	5
12	HOSE (21"0).....	1
13	ELBOW 5/8.....	1
14	HOSE (4.5").....	1
15	FITTING (3/4x5/8).....	1

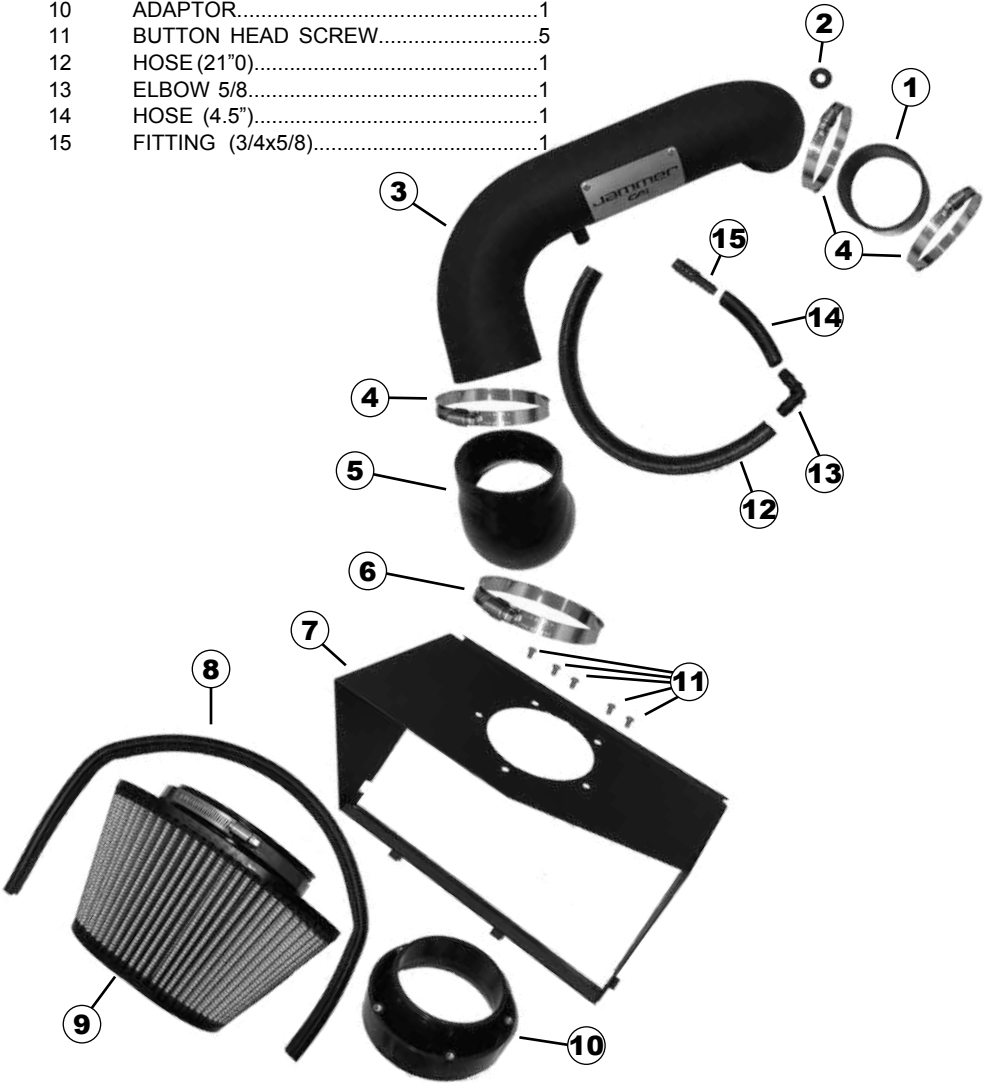

INSTALLATION INSTRUCTIONS

REMOVING THE STOCK INTAKE ASSEMBLY

CAUTION: Disconnect the ground cable from the battery before installation.

STEP 1 - Remove the 4 clips holding the top portion of the air box together.

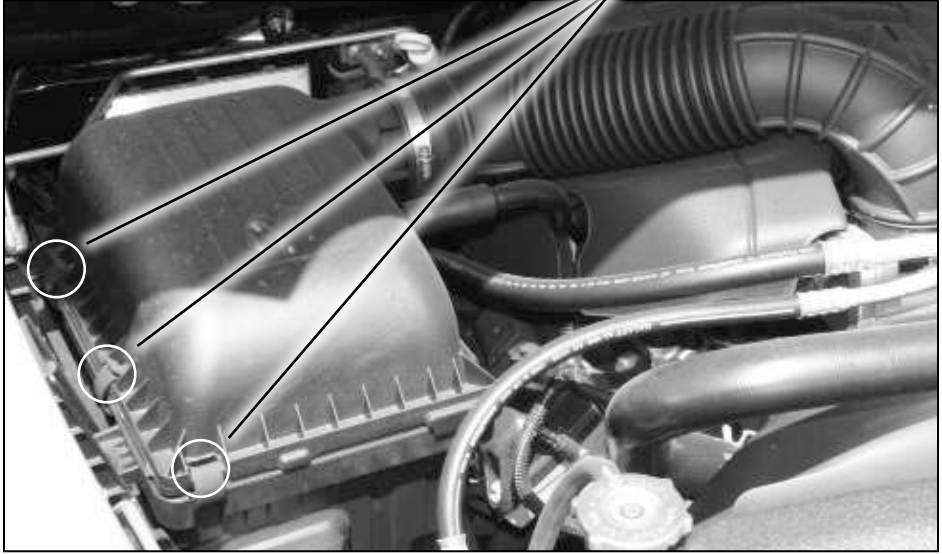

STEP 2 - Disconnect the Temperature Sensor harness from factory intake.



STEP 3 - Loosen the clamp holding the intake tube to the vehicle.

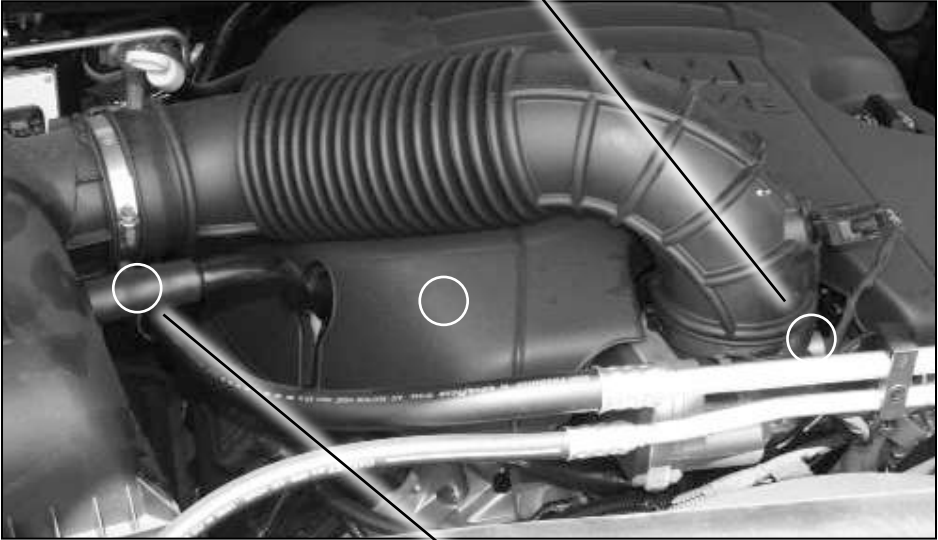

STEP 4 - Disconnect the crank case line from the air box.

STEP 5 - Pull the top of the intake system out of the vehicle with the intake tube.

STEP 6 - Pull the engine cover off by lifting it straight up.

STEP 7 - Now remove the stock crank case vent line from where it meets the engine, assemble the stock vent elbow with adaptor, long & short hose with elbow. Reinstall vent hose and engine cover.



INSTALLING THE AIR FILTER

STEP 8 - Using the hardware supplied, mount the adaptor to the heat shield using 5 button head screws.

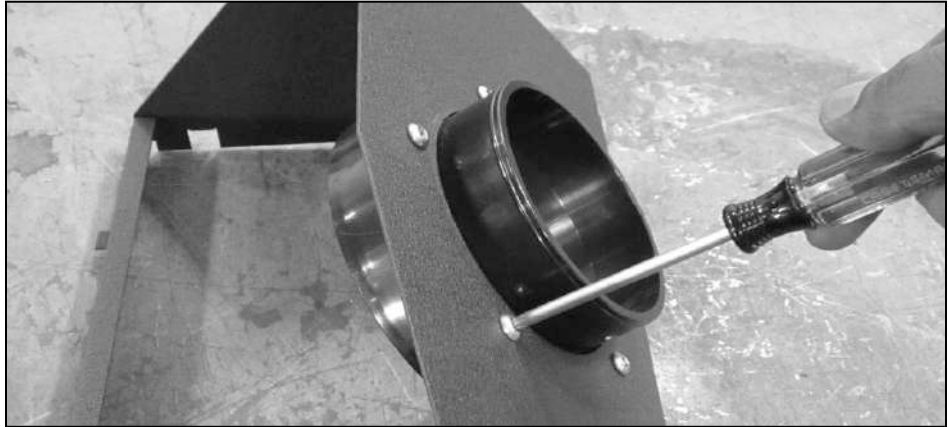

STEP 9 - Mount your Jammer air filter to the adaptor installed in step 8 with the clamp provided

STEP 10 - Now install the trim seal around the edge of the heat shield.



INSTALLING THE HOUSING

STEP 11 - Place the new heat shield and filter onto the lower half of the stock air box.

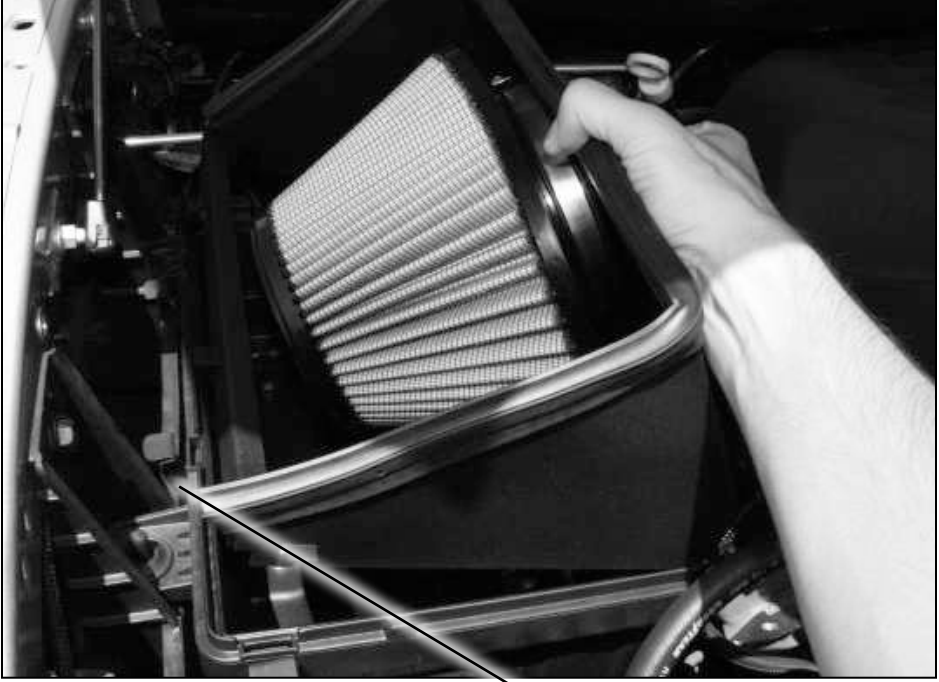

STEP 12 - Use the factory clips to secure the heat shield down onto the air box.

STEP 13 - Install the new grommet into your Jammer intake tube.

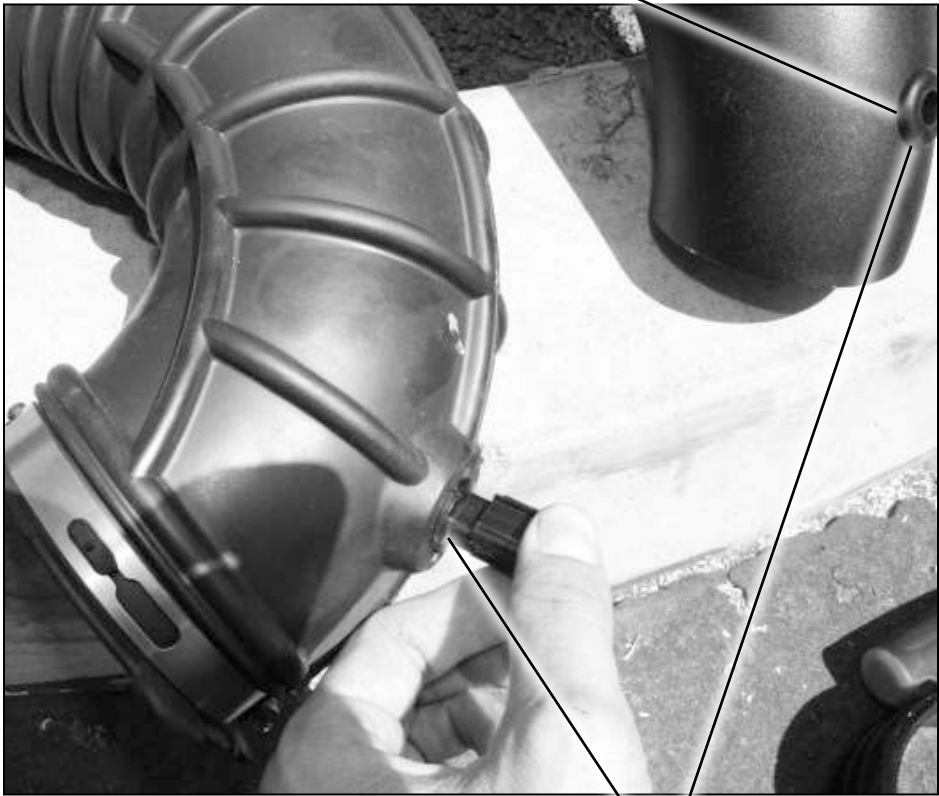

STEP 14 - Carefully pull the temperature sensor out of the stock intake tube. Remove the O-Ring and insert it into the grommet on your Jammer intake tube.

INSTALLING THE INTAKE TUBE

STEP 15 - Install the intake tube filter end FIRST, then throttle body end.

STEP 16 - Connect the crank case line that you installed in the step 7 to the intake tube.

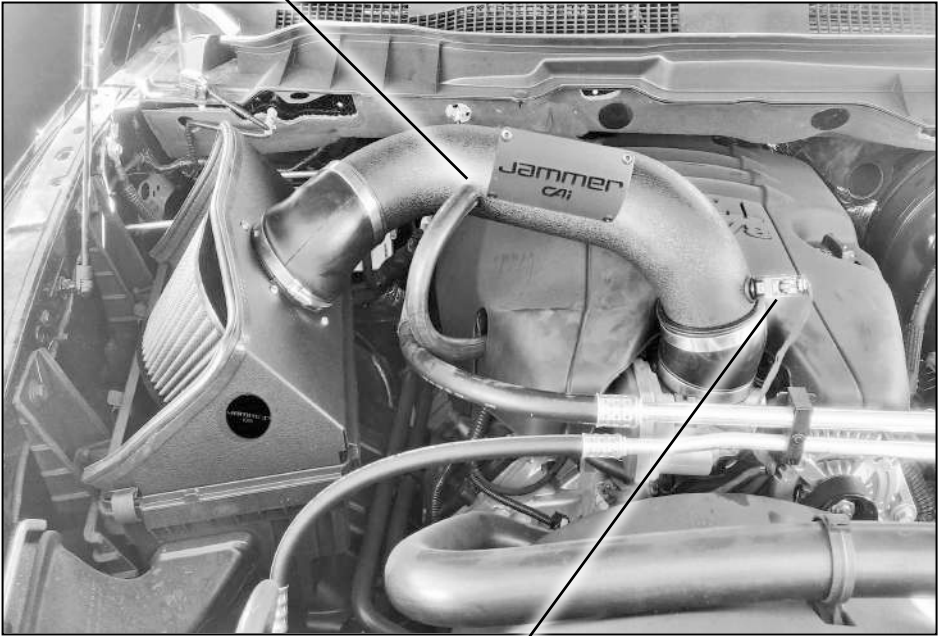

STEP 17 - Connect the temperature sensor harness.

STEP 18 - Your installation is now complete, check all connections to insure a proper seal.

NOTE: Verify all connections are secure 100-200 miles after installation.

[View other performance air intake systems made by Edge on our website.](#)