

# Installation Instructions

## Isuzu D-Max

Part Numbers:  
**75792**

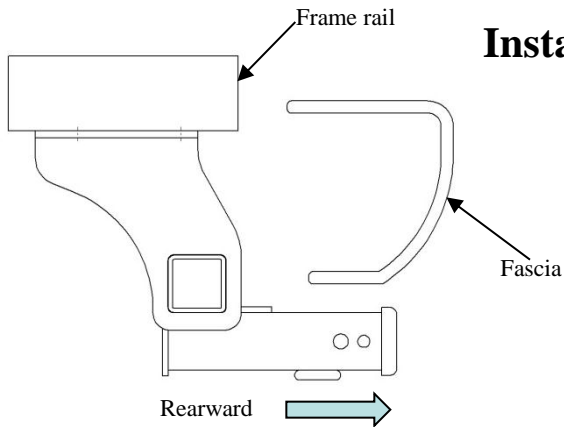

### Hitch Shown In Proper Position

**Do Not Exceed Lower of Towing Vehicle  
Manufacturer's Rating or**

Hitch type	Max Gross Trailer WT (LB)	Max Tongue WT (LB)
Weight Distributing	<b>6,000 (2724 Kg)</b>	<b>600 (272 Kg)</b>
Weight Carrying Ball Mount	<b>4,000 (1816 Kg)</b>	<b>600 (272 Kg)</b>

Wiring Access Location: PU3

Accessory Rating	C
------------------	---

### Equipment Required:

Fastener Kit: 75792F

Wrenches: 7/8"

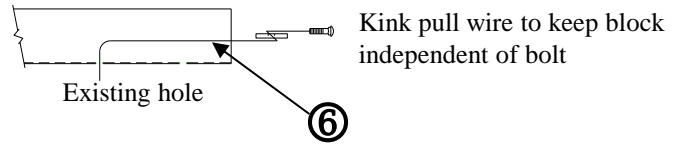
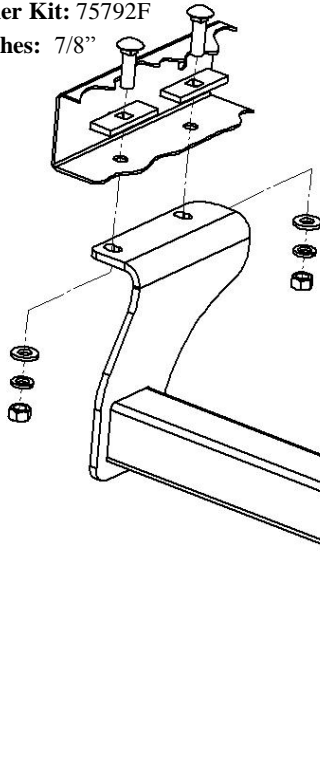

### Example of Pull Wire Procedure

Note: Fasteners typical both sides

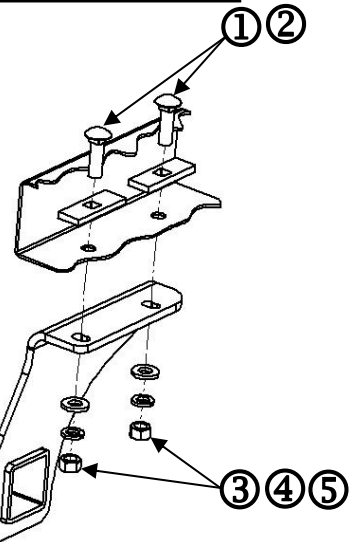

①	Qty. (4)	Carriage Bolt 1/2"-13 x 1-3/4" GR. 8	④	Qty. (4)	Lock Washer 1/2"
②	Qty. (4)	Block 1/4" x 1" x 3"	⑤	Qty. (4)	Flat Washer 1/2"
③	Qty. (4)	Hex Nut 1/2"-13 GR. 8	⑥	Qty. (4)	Pull Wire 1/2"-13

- Using the pull wire procedure shown above, install the carriage bolts and blocks into the frame rail. Leave the pull wires attached.
- Position the hitch beneath the frame rail as shown.
- Use the pull wires to insert the carriage bolts through the attachment holes of the hitch. Remove the pull wires.
- Install the flat washers, lock washers, and nuts as shown.
- Torque all fasteners to specification.

**Cequent**



Tighten all 1/2"-13 GR. 8 fasteners with torque wrench to 110 Lb.-Ft. (149 N\*M)