

# Installation Instructions

## Dodge 1500 2WD & 4WD Models

Part Numbers:  
**65062**

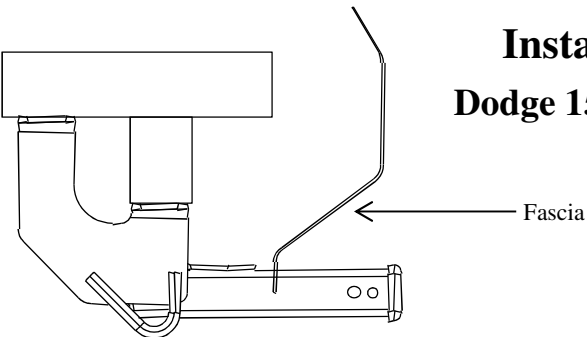

**CARGO CAPACITY – Do not exceed 500 LB. or Truck Front Gross Axle Weight Rating, (GAWR).**

<b>9,000lb.</b>	<b>^MAXIMUM WINCH LINE PULL</b>
-----------------	---------------------------------

### Hitch Shown In Proper Position

#### Equipment Required:

**Fastener Kit:** 65062F

**Wrenches:** 18mm, 7/8"

**Drill Bits:** 1/2", (Rotabroach Recommended)

**Other Tools:** Cutting tool for hard plastic fascia.

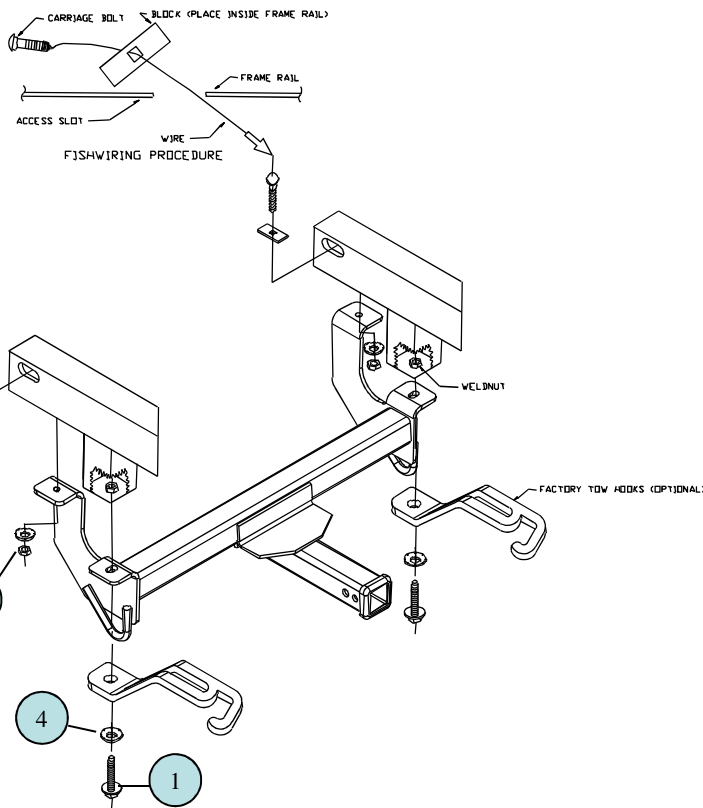
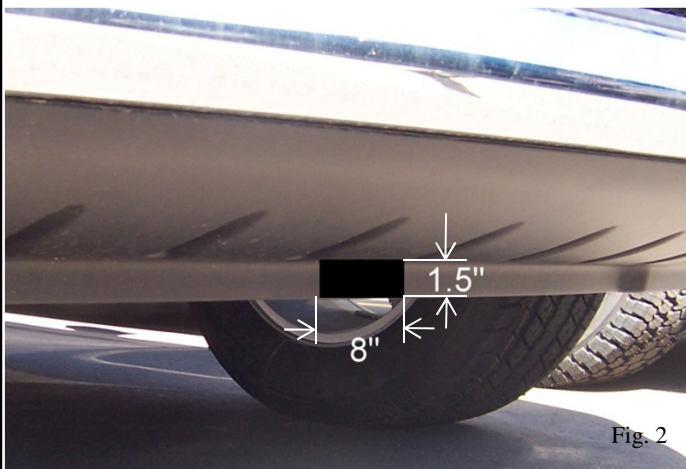

⑥ This is a magnified view of a Bolt Leader

\*Due to vehicle tow hooks variation, remove tow hooks from each frame rail and return hooks and fasteners to vehicle owner if the hitch can not be installed with tow hook.

①	Qty. (2)	Hex Bolt, M12 X 1.50 X 45 CL 10.9	④	Qty. (4)	Conical Washer, 1/2"
②	Qty. (2)	Carriage Bolt, 1/2" – 13 X 1-1/2" Gr5	⑤	Qty. (2)	Hex Nut, 1/2"
③	Qty. (2)	Block 1/4" X 1-1/2" X 2"	⑥	Qty. (2)	Bolt Leader. 1/2"

1. Using hitch as a reference and cut fascia as shown in Fig. 2
2. On drivers and passenger side remove both 12mm factory bolts attaching tow hooks to frame and loosen the (2) 12mm bolts that attach tow hook to bumper (If truck is not equipped with tow hooks skip step 1 and use provided bolts).
3. Once tow hook is loosened, slide hitch in-between the frame and the tow hook and reinstall the tow hooks with hitch in place.
4. With front hitch mounts secured use rear holes as a guide to drill a 1/2" hole into the frame .
5. Use 1/2" bolt leaders to pull 1/2" carriage bolts and spacer blocks thru the existing holes and through the hitch as shown. Square shoulders of bolts must be pulled into blocks to engage with the sides of frame. Install conical washers and hex nuts as shown.
6. Torque all hardware to the specs specified below.

Tighten all 12mm fasteners with torque wrench to 90 Lb.-Ft.

Tighten all 1/2" fasteners with torque wrench to 75 Lb.-Ft.

**Cequent**

