

# Installation Instructions

Part Numbers:

**24887**  
**60304**  
**77275**

## NISSAN VERSA SEDAN

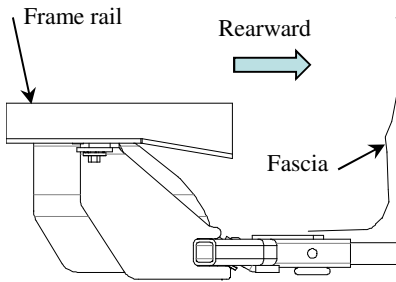

**Drawbar Kit:**  
3592

Drawbar must be used in the **RISE** position only.

**Do Not Exceed Lower of Towing Vehicle  
Manufacturer's Rating or**

**2000 LB (908 Kg) Max Gross Trailer Weight**  
**200 LB (90.8 Kg) Max Tongue Weight**

### Hitch Shown In Proper Position

**Equipment Required:** Pull wire, Galvanic isolators (provided), lubricant or soapy water, tin snips,  
**Fastener Kit:** 24887F

**Wrenches:** M10, 11/16, & 3/4

**Drill Bits:** 1/4"

Trim heat shield as shown.  
Access hole under heat shield passenger side only

**Wiring Access Location:** SUV3, 4

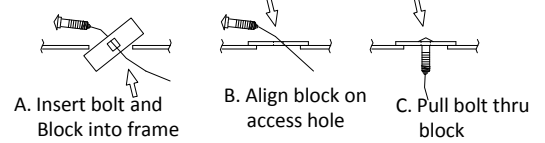

**Figure 3**

Pull wire Procedure

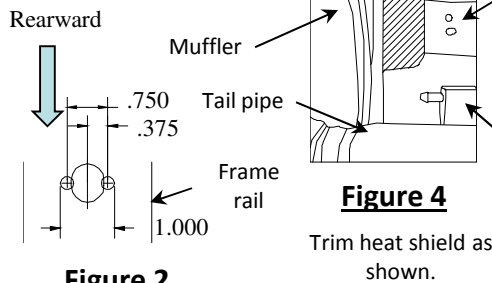

**Figure 2**

Access hole modification to allow for block and carriage bolt.

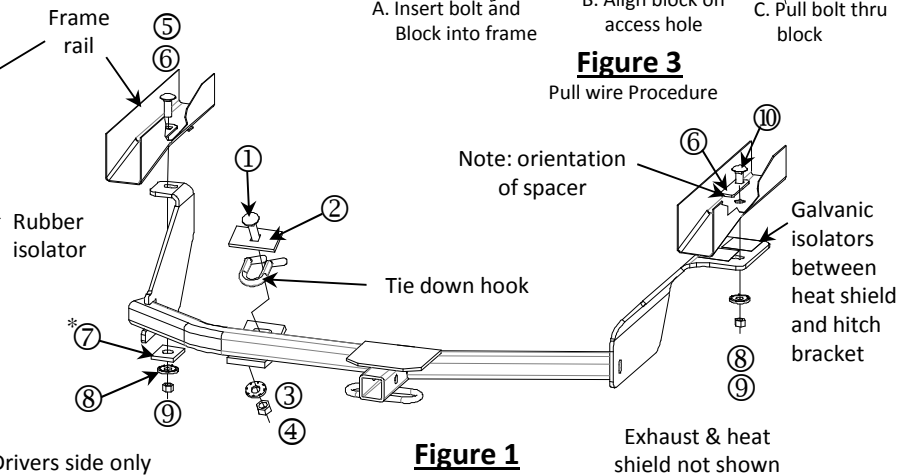

**Figure 1**

Exhaust & heat shield not shown

\*Drivers side only

①	Qty. (1)	Carriage bolt 1/2-13 X 2.00 GR5	⑥	Qty. (2)	Spacer 1/8" X .90 X 3.00
②	Qty. (1)	Spacer 1/4" x 1.50 x 3.00	⑦	Qty. (1)	Spacer 1/4" X 1.50 X 2.00
③	Qty. (1)	Conical washer 1/2"	⑧	Qty. (2)	Conical washer 7/16
④	Qty. (1)	Hex nut 1/2-13	⑨	Qty. (2)	Hex nuts 7/16-14
⑤	Qty. (1)	Carriage bolt 7/16-14 X 1.75 GR5	⑩	Qty. (1)	Carriage bolt 7/16-14 X 1.50 GR5

Note: sort hardware prior to hitch installation to confirm 1/2" & 7/16" conical washer are kept with coordinated 1/2" & 7/16" bolts and bolt lengths are installed in proper locations.

- Lower exhaust at the rubber isolator. Spraying a lubricant or soapy water on the metal hanger rod and the rubber isolator helps removal.
- Remove rearward m6 bolt holding heat shield in place. Return to owner. Trim heat shield for access to hole on passenger frame rail. Fig 4
- Remove the rubber plug from the hole on the driver side frame rail.
- Enlarge holes on both frame rails as shown Fig 2. Note: scrape undercoating and caulking from bottom of frame rails large enough to allow the hitch brackets to sit flush against the frame rails.
- Install 7/16 carriage bolts using the reverse pull wire procedure as seen in Fig 3. Leave pull wires attached. Note: length of bolts. Item 5 driver side, Item 10 passenger side.
- Install the 1/2 carriage bolt and spacer as shown in Fig 1. to the tie down hook.
- Apply the clear galvanic isolators to the passenger side bracket as shown. Fig 1
- Feed the pull wires through the slots on the hitch brackets.
- Raise the hitch into position and install 1/2 carriage bolt to the vehicles tie down hook, do not tighten down at this point. Fig 1.
- Feed the 7/16 fasteners through slots on both sides remove pullwires and install fasteners as shown Fig 1. Note: on passenger side sandwich the heat shield between the frame rail and the hitch.
- Center the hitch on the vehicle.
- Torque all fasteners to specifications shown below.
- Reinstall exhaust.

Tighten all 7/16-14 GR5 fasteners with torque wrench to 50 Lb.-Ft. (68 N\*M)  
Tighten all 1/2-13 GR5 fasteners with torque wrench to 75 Lb.-Ft. (102 N\*M)