

# Installation Instructions

## Kia Sorento

Part Numbers:

**75516**

**87425**

**44558**

**Do Not Exceed Lower of Towing Vehicle  
Manufacturer's Rating or**

Hitch type	Max Gross Trailer WT (LB)	Max Tongue WT (LB)
Weight Distributing	<b>5000 (2268 Kg)</b>	<b>500 (227 Kg)</b>
Weight Carrying Ball Mount	<b>5000 (2268 Kg)</b>	<b>500 (227 Kg)</b>

**Wiring Access Location: SUV7**

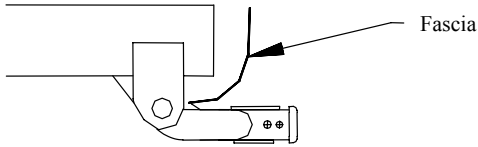

### Hitch Shown In Proper Position

#### Equipment Required:

**Fastener Kit:** 75516F

**Wrenches:** 19mm

**Drill Bits:** None

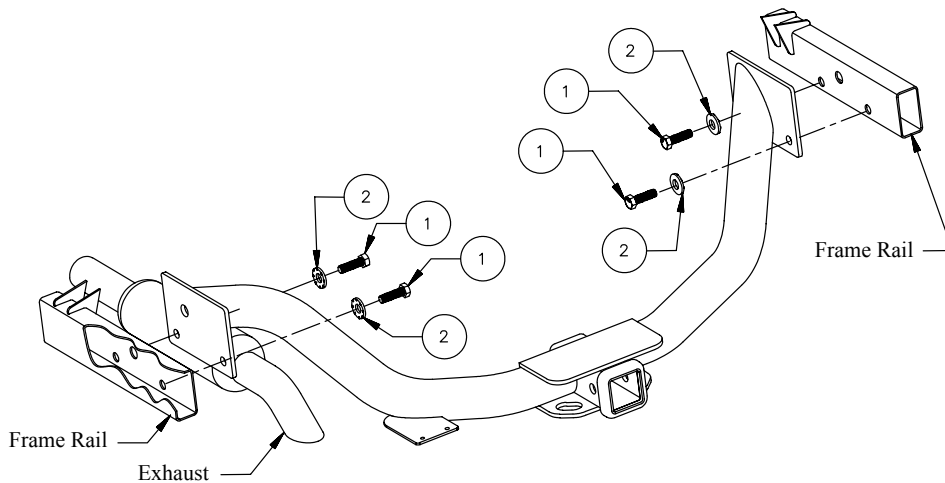

①	Qty. (4)	M12 X 1.50 X 40mm CL 10.9 Hex Bolt	②	Qty. (4)	Conical Toothed Washer
---	----------	------------------------------------	---	----------	------------------------

Spare tire may need to be lowered for installation.

1. Raise receiver over exhaust and into position between vehicle frame rails.
2. Install M12 X 1.50 Hex bolts and conical toothed washers into existing weldnuts.

Tighten all M12 X 1.50 CL10.9 fasteners with torque wrench to 92 Lb.-Ft. (125 N\*M)

Note: check hitch frequently, making sure all fasteners and ball are properly tightened. If hitch is removed, plug all holes in trunk pan or other body panels to prevent entry of water and exhaust fumes. A hitch or ball which has been damaged should be removed and replaced. Observe safety precautions when working beneath a vehicle and wear eye protection. Do not cut access or attachment holes with a torch.