

INSTALLATION INSTRUCTIONS

VEHICLE

DODGE DURANGO

EQUIPMENT REQUIRED:

WIRING ACCESS LOCATION: SUV 1, SUV 2

DRILL BITS: NONE

HITCH REQUIRES 5/8" PIN AND CLIP IF STABILIZING PIN IS NOT INSTALLED.

WRENCHES: (TIGHTEN ALL FASTENERS WITH TORQUE WRENCH) 3/4", 7/8", 18mm & 21mm DEEP WELL SOCKET

DO NOT EXCEED LOWER OF TOWING VEHICLE MFR'S RATINGS OR

| HITCH TYPE ▼ | MAX GROSS TRLR WT(LB) | MAX TONGUE WT(LB) |
|----------------------------|-----------------------|-------------------|
| WEIGHT DISTRIBUTING | 9000 | 900 |
| WEIGHT CARRYING BALL MOUNT | 6000 | 600 |

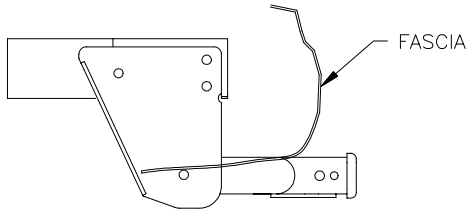

HITCH SHOWN IN PROPER POSITION

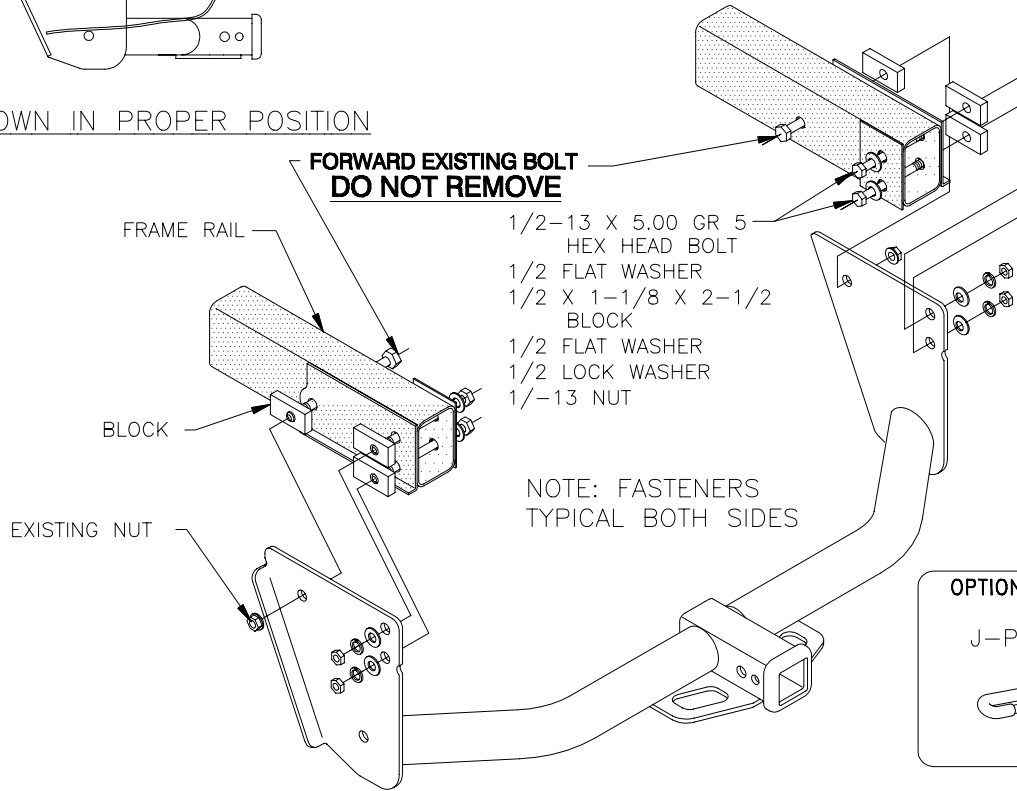

1. LOOSEN (6) BUMPER BRACKET NUTS, (3) EACH SIDE. REMOVE (4) REARMOST BOLTS, (2) EACH SIDE. REMOVE REMAINING FLANGE NUT. **DO NOT REMOVE FORWARD BOLT.** RETURN (4) BOLTS AND FLANGE NUTS TO OWNER.
2. REPLACE (4) REARMOST BOLT WITH NEW BOLTS SUPPLIED IN FASTENER KIT.
3. PLACE (1) BLOCKS FLUSH ON EACH BOLT.
4. RAISE HITCH INTO POSITION OVER THE EXHAUST PIPE, BEING CAREFUL NOT TO DROP BLOCKS.
5. PUSH BOLT WITH FLAT WASHER THROUGH FRAME RAIL, BLOCK & BRACKET AND ATTACH FLAT WASHER, LOCK WASHER AND NUTS, TO (4) REARMOST BOLTS (AS SHOWN).
6. REPLACE THE FLANGE NUT ON THE FORWARD EXISTING BOLT.

TIGHTEN ALL 1/2-13 GR5 FASTENERS TO 75 LB-FT.
TIGHTEN ALL M14 CL10.9 FASTENERS TO 148 LB-FT.

| | |
|---------------------|--------------|
| APPROX WEIGHT (LB.) | FASTENER KIT |
| 44 | 75292F |

NOTE: Check hitch frequently, making sure all fasteners and ball are properly tightened. If hitch is removed, plug all holes in trunk pan or other body panels to prevent entry of water and exhaust fumes. A hitch or ball which has been damaged should be removed and replaced. Observe safety precautions when working beneath a vehicle and wear eye protection. Follow car maker's specs for maximum trailer weight and tongue weight. Do not cut access or attachment holes with a torch.