

# INSTALLATION INSTRUCTIONS

Product No.

## CHEVROLET & GMC VANS

# 75121



SMALL PARTS  
PACKAGE 01130-492

**WARNING:** DO NOT LUBRICATE THREADS, BOLT FAILURE MAY OCCUR DUE TO OVER TIGHTENING.  
**WARNING:** DO NOT DRILL OR WELD TO THIS HITCH.

**IMPORTANT NOTES**  
USE ONLY TOWING PRODUCTS SUPPLIED OR APPROVED BOLTS, LOCKNUTS, AND WASHERS TO INSTALL THIS HITCH

### TOOLS REQUIRED

9/16" SOCKET  
9/16" WRENCH  
3/4" WRENCH  
3/4" SOCKET  
TORQUE WRENCH

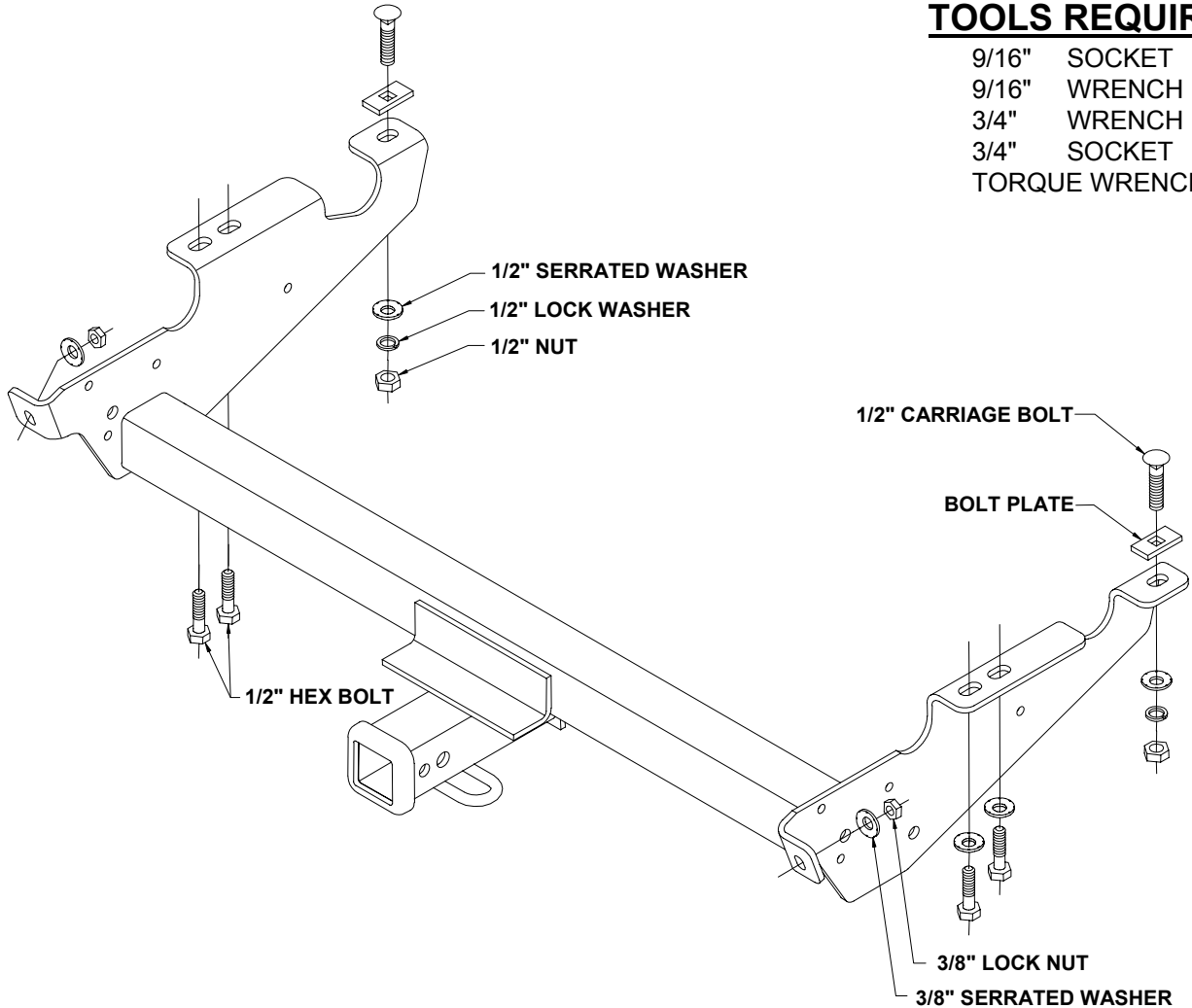

1. Remove the two lower bumper support brackets, one per side; save the bolts and washers. Save the bracket and return to the owner.
2. Place the left and right side brackets against the frame bottom. Install four 1/2" bolts and washers removed in step one. Leave the bolts loose.

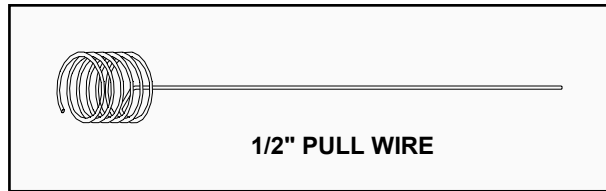

4. Install two 3/8" bumper bolts (removed in step one), two 3/8" serrated washers, and two 3/8" lock nuts (from the parts package). Leave the lock nuts loose at this time.

**!WARNING!** Two 3/8" lock nuts must be used with two 3/8" bumper bolts; otherwise the receiver could loosen and separate from the vehicle.

5. Screw the pull wire (55392) onto a 1/2" carriage bolt. Feed the pull wire through a bolt plate and the large hole in the outboard side of the frame. Pull it out the bottom hole of the frame. Repeat for the other side. Install two 1/2" serrated washers, lock washers and nuts on the bolts. Leave the nuts loose at this time.

6. Tighten bolts and nuts in the exact order listed; this allows the receiver to be pulled rearward to the bumper before the frame bolts are tightened.

\*Torque two 3/8" lock nuts on the bumper to 30 ft.\*lb.

\*Torque the 1/2" nuts and bolts to 75 ft.\*lb.