

For vehicles with appearance panel:
 Remove appearance panel which covers the trunk pan.
 (2)10mm
 Remove the (2) plastic rivets that fasten the fascia tabs to the vehicle. Note: Remove the center of the rivet with a screwdriver.
 Rivets to be reinstalled.
 Return appearance panel and fasteners to vehicle owner.

Installation Instructions

Part Numbers:

HONDA ACCORD

24787

Includes Hybrid

60953

6 cylinder

77161

Drawbar Kit:

3592

Drawbar must be used in the **RISE** position only.

Do Not Exceed Lower of Towing Vehicle Manufacturer's Rating or

**2000 LB (908Kg) Max Gross Trailer Weight
 200 LB (91Kg) Max Tongue Weight**

Wiring Access Location: PC3

Equipment Required:

Fastener Kit: KA-8002-249

Wrenches: 11/16", 3/4"

Drill Bits: 9/16"

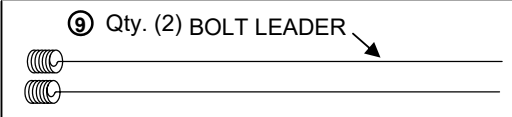
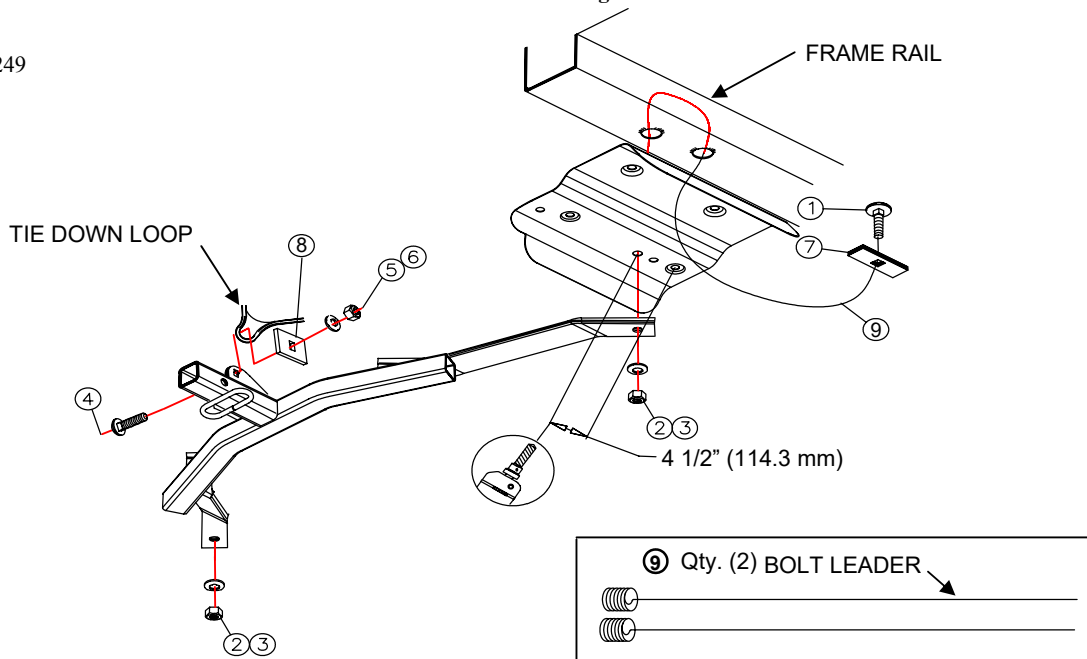

①	Qty. (2)	BOLT CARRIAGE 7/16" - 14 X 1 1/2" GR 5	⑤	Qty. (1)	WASHER CONICAL TOOTH 1/2"
②	Qty. (2)	WASHER CONICAL TOOTH 7/16"	⑥	Qty. (1)	NUT - 1/2"
③	Qty. (2)	NUT - 7/16"	⑦	Qty. (2)	PLATE REINFORCEMENT
④	Qty. (1)	BOLT CARRIAGE 1/2"-13 X 1 1/2" GR 5	⑧	Qty. (1)	BLOCK; CLAMPING, 1-1/2" X 3"

- Lower exhaust by removing both rubber isolators from muffler hangers. Be careful not to allow mufflers to fall under their own weight.
- Both heat shields will need to be marked and drilled 4 1/2" from the forward most hole on the frame channel. Mark holes then hold hitch in position to check. Refer to illustration for clarification. Remove heat shield to drill.
- Thread bolt leader (9) onto end of carriage bolt (1) and insert bolt leader through reinforcing plate (7). Fish the bolt leader and assembly through the access hole in frame and carefully pull through existing hole in frame till bolt is in position. Leave bolt leaders attached so the hardware does not get pushed back inside the frame. Repeat for other side of vehicle.
- Reinstall heat shields once the carriage bolts (1) are in position.
- Install 1-1/2" carriage bolt (4) through square hole in hitch and vehicle's tie down loop from driver's side. Install clamping block (8) and conical toothed washer (5) and nut (6) and hand tighten to hold hitch in place.
- Fish bolt leaders through holes in hitch's frame straps and being careful not to push bolt assemblies back into frame channels, raise hitch's frame straps up to vehicle's frame, remove bolt leaders and install conical toothed washers (2) and nuts (3).
- Tighten all bolts, referring to torque table on instruction sheet.
- Raise exhaust back into position and reinstall rubber isolators.

Tighten all 7/16 fasteners with torque wrench to 50 Lb.-Ft. (68 N*M)

Tighten all 1/2" fasteners with torque wrench to 75 Lb.-Ft. (102N*M)

Note: check hitch frequently, making sure all fasteners and ball are properly tightened. If hitch is removed, plug all holes in trunk pan or other body panels to prevent entry of water and exhaust fumes. A hitch or ball which has been damaged should be removed and replaced. Observe safety precautions when working beneath a vehicle and wear eye protection. Do not cut access or attachment holes with a torch.

Installation Instructions

HONDA ACCORD

4 cylinder

Part Numbers:

24787

60953

77161

Drawbar Kit:
3592

Drawbar must be used in the **RISE** position only.

**Do Not Exceed Lower of Towing Vehicle
Manufacturer's Rating or**

2000 LB (908Kg) Max Gross Trailer Weight

200 LB (91Kg) Max Tongue Weight

Wiring Access Location: PC3

Equipment Required:

Fastener Kit: KA-8002-249

Wrenches: 11/16", 3/4"

Drill Bits: - None

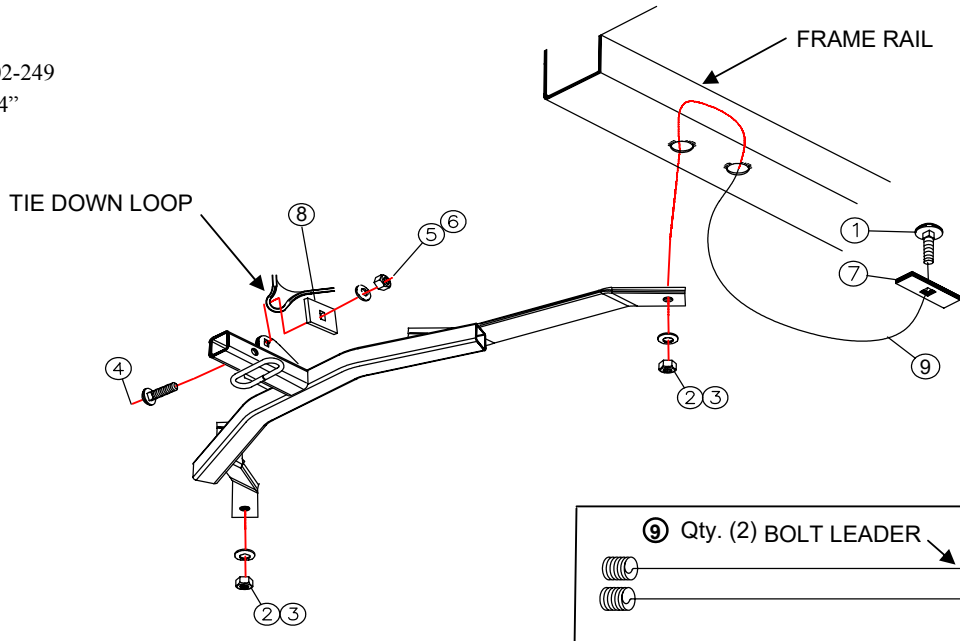

⑨ Qty. (2) BOLT LEADER



①	Qty. (2)	BOLT CARRIAGE 7/16" - 14 X 1 1/2" GR 5	⑤	Qty. (1)	WASHER CONICAL TOOTH 1/2"
②	Qty. (2)	WASHER CONICAL TOOTH 7/16"	⑥	Qty. (1)	NUT - 1/2"
③	Qty. (2)	NUT - 7/16"	⑦	Qty. (2)	PLATE REINFORCEMENT
④	Qty. (1)	BOLT CARRIAGE 1/2"-13 X 1 1/2" GR 5	⑧	Qty. (1)	BLOCK; CLAMPING, 1-1/2" X 3"

1. Thread bolt leader (9) onto end of carriage bolt (1) and insert bolt leader through reinforcing plate (7). Fish the bolt leader and assembly through the access hole in frame and carefully pull through existing hole in frame until bolt is in position. Leave bolt leaders attached so the hardware does not get pushed back inside the frame. Repeat for other side of vehicle.
2. Install 1-1/2" carriage bolt (4) through square hole in hitch and vehicle's tie down loop from driver's side. Install clamping block (8) and conical toothed washer (5) and nut (6) and hand tighten to hold hitch in place.
3. Fish bolt leaders through holes in hitch's frame straps and being careful not to push bolt assemblies back into frame channels, raise hitch's frame straps up to vehicle's frame, remove bolt leaders and install conical toothed washers (2) and nuts (3).
4. Tighten all bolts, referring to torque table on instruction sheet.

Tighten all 7/16 fasteners with torque wrench to 50 Lb.-Ft. (68 N*M)

Tighten all 1/2" fasteners with torque wrench to 75 Lb.-Ft. (102N*M)

Note: check hitch frequently, making sure all fasteners and ball are properly tightened. If hitch is removed, plug all holes in trunk pan or other body panels to prevent entry of water and exhaust fumes. A hitch or ball which has been damaged should be removed and replaced. Observe safety precautions when working beneath a vehicle and wear eye protection. Do not cut access or attachment holes with a torch.

Looking for dependable trailer hitches and towing? Rely on Draw-Tite for quality and long-lasting products.