

Front Mounted Receiver Installation Instructions

Part Numbers:

65067

Ford F-150

Removal of lower air dam or trimming required. Obtain vehicle owners approval before cutting

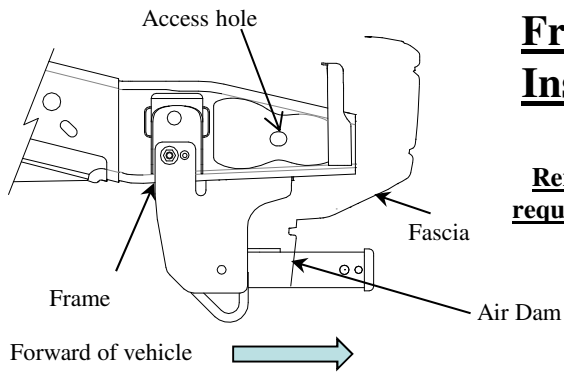

Hitch Shown In Proper Position

Equipment Required: Utility Knife, Tape Measure & Marking Pencil.

Fastener Kit: 65067F

Wrenches: 3/4"

Drill Bits: None

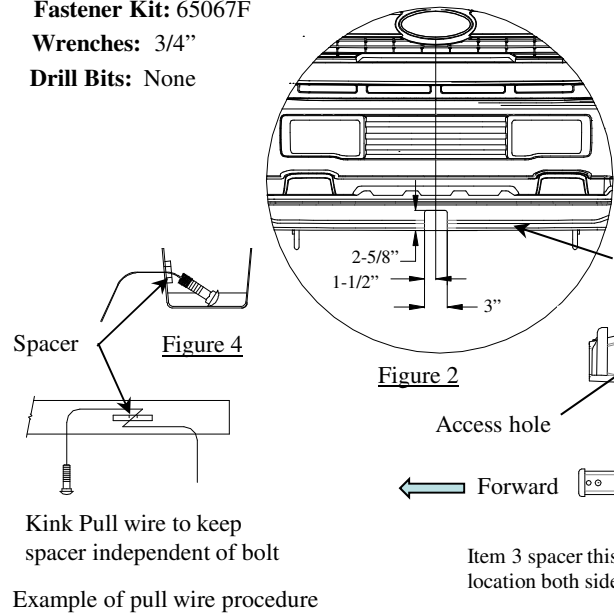

Kink Pull wire to keep spacer independent of bolt
Example of pull wire procedure

CARGO CAPACITY – Do not exceed 500 LB. (227 Kg) or Truck Front Gross Axle Weight Rating, (GAWR).	
9,000 lb. (4086 Kg)	MAXIMUM WINCH LINE PULL
	MAXIMUM WINCH LINE PULL

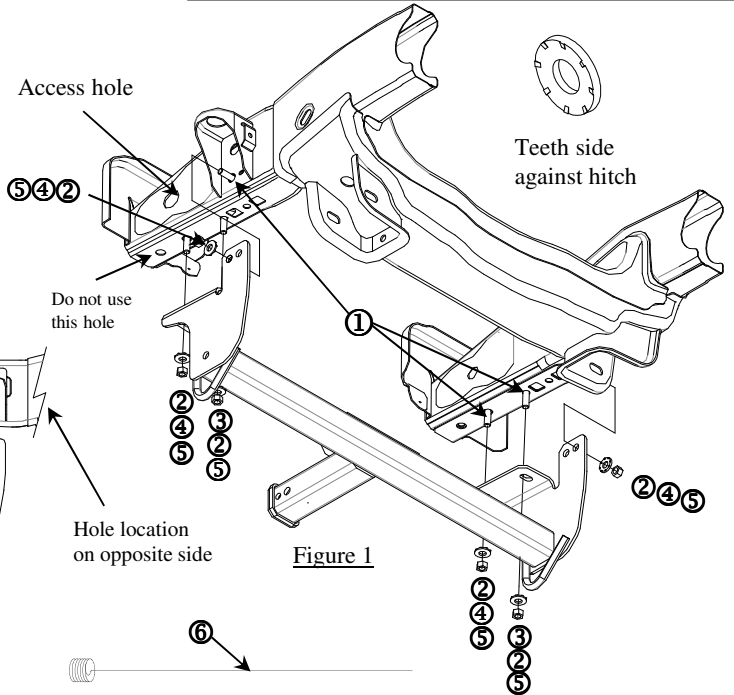

①	Qty. (6)	Carriage bolt 1/2-13 X 1.75 GR5	④	Qty. (6)	Conical washers 1/2"
②	Qty. (4)	Spacers 1/4" X 1.00 X 3.00	⑤	Qty. (6)	Hex nuts 1/2-13
③	Qty. (2)	Spacer 3/16" X 1.00 X 2.00	⑥	Qty. (4)	Pull wires 1/2"

It is necessary to either remove lower air dam or trim plastic air dam to install this hitch. See Picture above. **CONSULT VEHICLE OWNER BEFORE REMOVING OR CUTTING PLASTIC AIR DAM.**

- Trim or remove lower air dam. See Figure 2 If cutting, recommend drilling 3/8" at corners to maintain radius for appearance.
- Feed the coiled end of the pull wire through the bolt attachment hole in the side of the frame and out the access hole. (Note: driver & passenger side use opposite hole positions) Attach carriage bolt and spacer (item 1 & 2) to the pull wire. Pull the pull wire with fasteners into location through the hole. Leave pull wires attached. Repeat the same process on the both frame rails. Then push fasteners back into the frame rail leaving the pull wire attached and sticking out. See Figure 4
- Feed the coiled end of the pull wire through the forward bolt attachment hole in the bottom of the frame and out the access hole. Attach carriage bolt and spacer (item 1 & 2) to the pull wire. Leave the pull wire attached.
- Raise the hitch into position sliding the forward edge of the hitch bracket up over the air dam and into location, feed the pull wires through the slots/holes on the brackets. Pull the fasteners on the side, back through the frame and bracket for support. Feed conical washer over pull wire, using the washer to hold the bolt in place remove the pull wires and attach the hex nut. Tighten to hold hitch in place, repeat on all fasteners.
- Reusing (2) of the pull wires feed remaining carriage bolt and spacer (item 1 & 3) into the access slot on the side of the frame rail and through the rearward hole on the bottom of the frame. Note: if necessary use a screwdriver to prevent the spacer from spinning. (due to vehicle variation some vehicle have support plates that will prevent spacers from spinning) Repeat the same process on both frame rails.
- Torque all fasteners to specifications below.

Tighten all 1/2-13 GR 5 fasteners with torque wrench to 75 Lb.-Ft. (102 N*M)

Note: check hitch frequently, making sure all fasteners and ball are properly tightened. If hitch is removed, plug all holes in trunk pan or other body panels to prevent entry of water and exhaust fumes. A hitch or ball which has been damaged should be removed and replaced. Observe safety precautions when working beneath a vehicle and wear eye protection. Do not cut access or attachment holes with a torch.