

Installation Instructions

HONDA FIT

Part Numbers:

24920

60353

77307

← Vehicle Forward

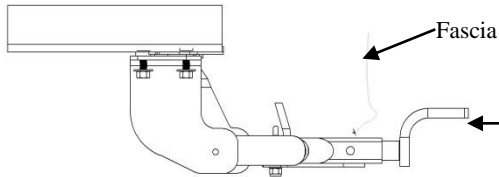

Drawbar Kit:

3593

Drawbar must be used in the **RISE** position only.

**Do Not Exceed Lower of Towing Vehicle
Manufacturer's Rating or**

2000 LB (908 kg) Max Gross Trailer Weight

200 LB (90.8 kg) Max Tongue Weight

Accessory Rating	A
------------------	---

Hitch Shown In Proper Position

Equipment Required: Pull Wire, Lubricant

Fastener Kit: 24920F

Wrenches: 11/16"

Drill Bits: None

Wiring Access Location: PC3, 4

← Vehicle Forward
(Driver Side)

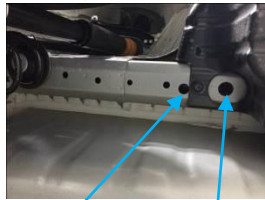

Forward Attachment Rear Attachment

Figure 2

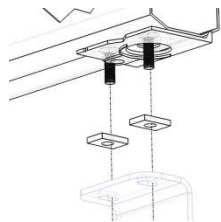

Figure 3

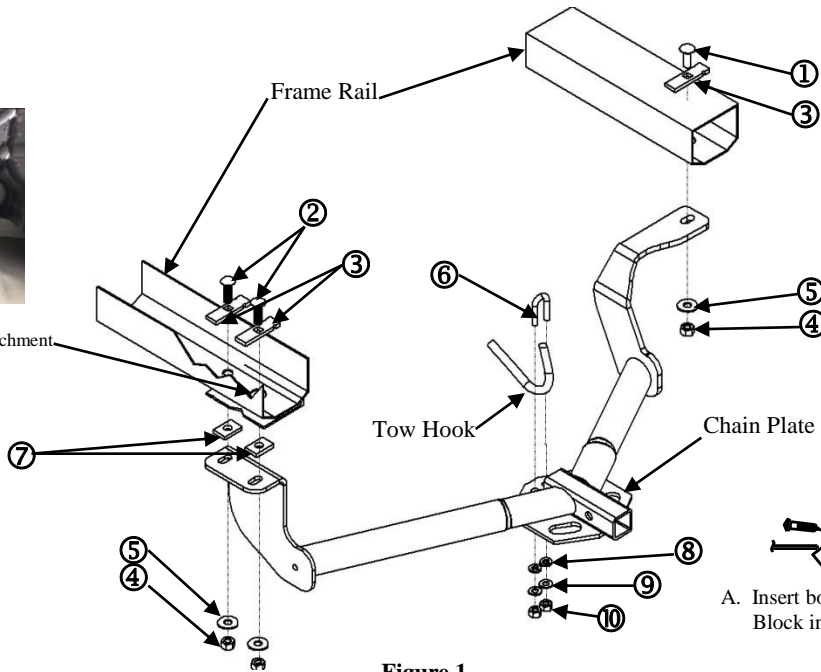

Figure 1

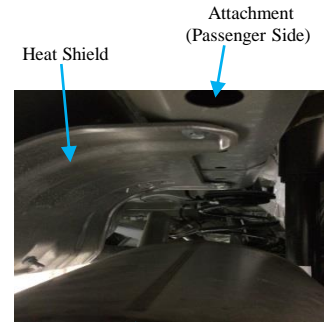

Figure 4

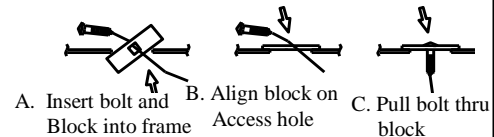

Figure 5

Reverse Pull wiring Procedure

①	Qty. (1)	Carriage Bolt 7/16 x 1-1/4" GR5	⑥	Qty. (1)	U-BOLT 3/8"
②	Qty. (2)	Carriage Bolt 7/16 x 1-1/2" GR5	⑦	Qty. (2)	Spacer 1/4 x 1 x 1.5
③	Qty. (3)	Spacer 1/4 x 7/8" x 3	⑧	Qty. (2)	3/8" flat washer
④	Qty. (3)	Hex Nut 7/16" GR5	⑨	Qty. (2)	3/8 lock washer
⑤	Qty. (3)	Conical Toothed Washer 7/16"	⑩	Qty. (2)	HEX NUT 3/8"

- Lower exhaust by detaching it from the rubber isolators (2). Spraying lubricant on rubber isolator helps with removal.
- Install **shorter** 7/16" bolt (item 1) and spacer (item 3) in passenger side frame rail (Figure 4), using the Reverse Pull wire Procedure (Figure 5). Leave pull wire attached. **NOTE:** shorter bolt must be on passenger side.
- Using the pull wire, install the forward bolt and spacer (items 2 & 3) on the driver side, leaving pull wire attached (Figure 2). Then, Reverse pull wire the rearward bolt and spacer (items 2 & 3) on drivers side, leave the pull wire attached.
- Place spacers (item 7) on driver side bracket, feed the pull wire end through the appropriate slots (Figure 3). Feed pull wire through slot on passenger side.
- Raise hitch into position, feed conical washers (item 5) through pull wire. Use conical washers to hold carriage bolts in place. Remove pull wires and attach hex nuts. Tighten nuts to hold hitch in place.
- Hang U-bolt around tow hook and through holes on chain plate. Put flat washer, lock washer and 3/8" nuts on. Center Hitch.
- Tighten all fasteners to required torque specifications.

Tighten all 7/16" - 14 GR5 fasteners with torque wrench to 55 Lb.-Ft. (75 N*M)

Tighten all 3/8"-16 GR5 fasteners with torque wrench to 30 Lb.-Ft. (41 N*M)

Note: check hitch frequently, making sure all fasteners and ball are properly tightened. If hitch is removed, plug all holes in trunk pan or other body panels to prevent entry of water and exhaust fumes. A hitch or ball which has been damaged should be removed and replaced. Observe safety precautions when working beneath a vehicle and wear eye protection. Do not cut access or attachment holes with a torch.