

⚠ WARNING

To prevent **SERIOUS INJURY, DEATH** or **PROPERTY DAMAGE**:

- **ALWAYS** read, understand and follow warnings and instructions for your hitch **BEFORE** installation. Keep for future reference.
- **DO NOT** cut, weld or modify this receiver.
- **CHECK** all fasteners are tight and your hitch is securely mounted to your vehicle periodically.
- **ALWAYS** read, understand and follow all warnings and instructions for your vehicle and for other accessories you will use with your hitch **BEFORE** use.
- **LOAD** the trailer heavier in front.
- **DO NOT** exceed lower of towing vehicle manufacturer's rating or:

Hitch Type	Max Gross Trailer Weight	Max Tongue Weight
Weight Carrying	7500 lb. (3401 kg)	1125 lb. (510 kg)
Weight Distributing	8000 lb. (3628 kg)	1200 lb. (544 kg)

- **ALWAYS** wear your seatbelt.
- **SLOW DOWN** when towing, **NEVER** exceed any posted speed limit.
- If **EXCESS SWAY** occurs, take your foot off the gas pedal and hold the steering wheel as steady as possible. **DO NOT** apply your brakes and **DO NOT** speed up.

Applications:

Years	Make	Models
2019-Current*	FORD	RANGER

*Visit our website for the most up to date information regarding application years and trim levels.

Installation Time: **30 min**

The time listed above is the average time for professional installers. If you do not feel comfortable performing this installation on your own or are in need of assistance, please contact a professional installer.



Representative Vehicle Photo

Equipment Required:

Safety Glasses	Ratchet	Sockets
Torque Wrench	6" Socket Extension	C-CLAMPS (2)

**DO NOT EXCEED LOWER OF TOWING VEHICLE
MANUFACTURER'S RATING OR:**

Hitch Type	Max Gross Trailer Weight	Max Tongue Weight
Weight Carrying	7500 lb. (3401 kg)	1125 lb. (510 kg)
Weight Distributing	8000 lb. (3628 kg)	1200 lb. (544 kg)

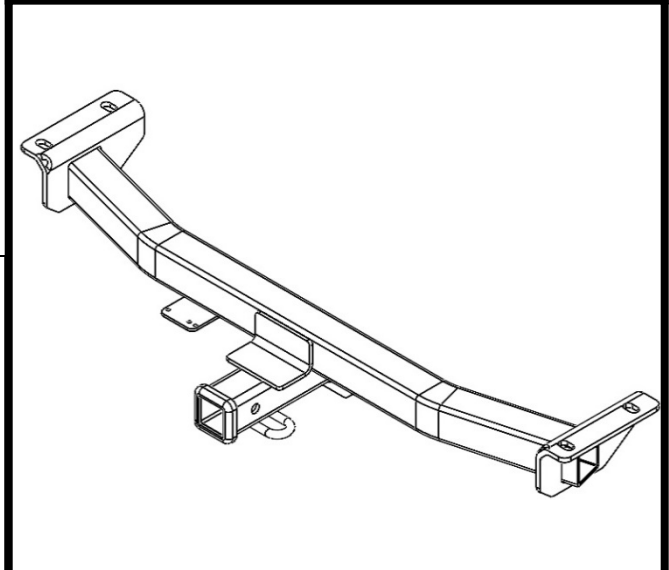

Hitch Illustration



Always wear SAFETY GLASSES
when installing hitch

Installation Instructions

PART NUMBERS: 76583, 84583, CQT76583

Fastener Kit: 76583F

*No fasteners supplied in the
fastener kit

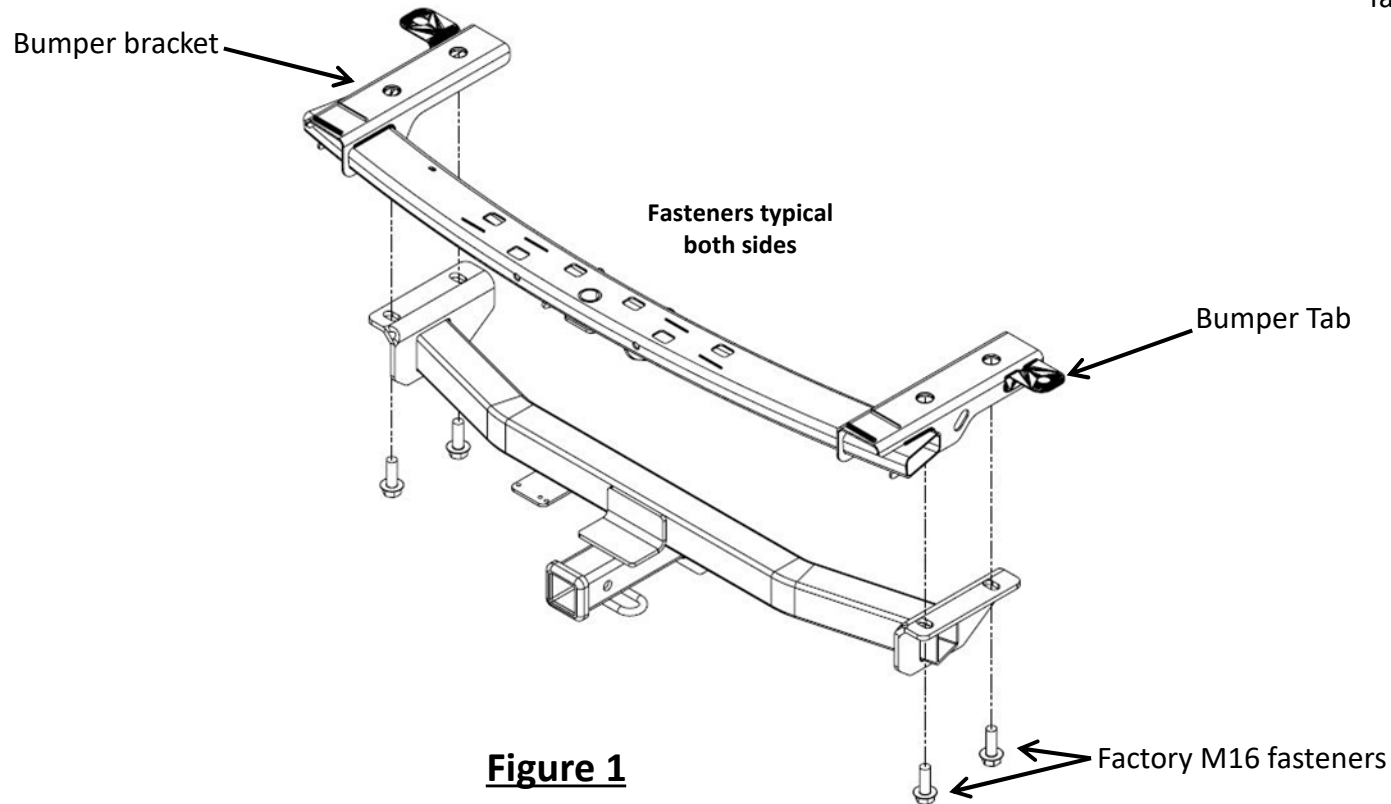
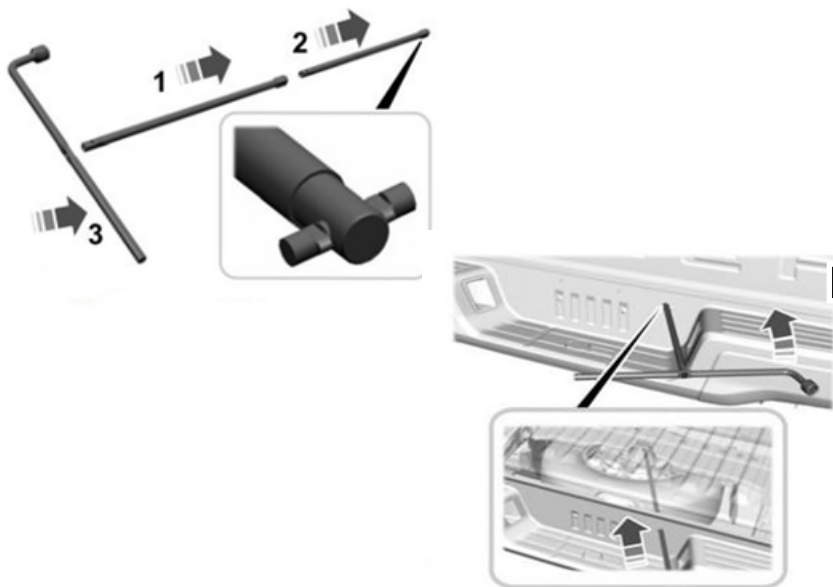

Figure 1

1. **Lower spare tire** – Refer to vehicle owner's manual
2. **Clamp bumper tabs** – Use the C clamps to clamp the bumper tabs to the matching tabs directly above (1 each side) to prevent the bumper from coming down when removing the factory M16 fasteners holding it to the vehicle frame.
3. **Remove factory bolts** – Using a 21mm socket, remove (4) M16 bolts holding the bumper brackets to the vehicle frame.
4. **Install hitch** – Raise the hitch into position, aligning the attachment holes in the hitch to the holes in the bumper bracket and frame rail. Re-install the factory M16 bolts each side.
5. **Torque fasteners** – Tighten all M16 fasteners with torque wrench to 146Lb.-Ft. (195 N*M)
 - ⚠ Proper torque is needed to keep the hitch secure to the vehicle when towing.
6. **Reinstall spare tire** – Raise the spare tire back into position.

1. Lower spare tire – Refer to vehicle owner's manual.



2. Clamp bumper tabs – Use the C clamps to clamp the bumper tabs to the matching tabs directly above (1 each side) to prevent the bumper from coming down when removing the factory M16 fasteners holding it to the vehicle frame.



3. Remove factory bolts – Using a 21mm socket, remove (4) M16 bolts holding the bumper brackets to the vehicle frame.



4. Install hitch – Raise the hitch into position, aligning the attachment holes in the hitch to the holes in the bumper bracket and frame rail. Re-install the factory M16 bolts each side.



5. Torque fasteners – Tighten all M16 fasteners with torque wrench to 146lb.-Ft. (195 N*M)

⚠ Proper torque is needed to keep the hitch secure to the vehicle when towing.



6. Reinstall spare tire – Raise the spare tire back into position.

