



Installation Instructions

PART NUMBERS: 45509, 45709, CQT45509

Applications:

Years	Make	Models
03-16	Dodge	Ram 2500
03-16	Dodge	Ram 3500

Installation Time: 95 min

The time listed above is the average time for professional installers. If you do not feel comfortable performing this installation on your own or are in need of assistance, please contact a professional installer.

Equipment Required:



**DO NOT EXCEED LOWER OF TOWING VEHICLE
MANUFACTURER'S RATING OR:**

Hitch Type	Max Gross Trailer Weight	Max Tongue Weight
Weight Carrying	18,000 lb.(8172 kg)	2,000 lb. (908 kg)
Weight Distributing	18,000 lb.(8172 kg)	2,500 lb. (1135 kg)



Representative Vehicle Photo

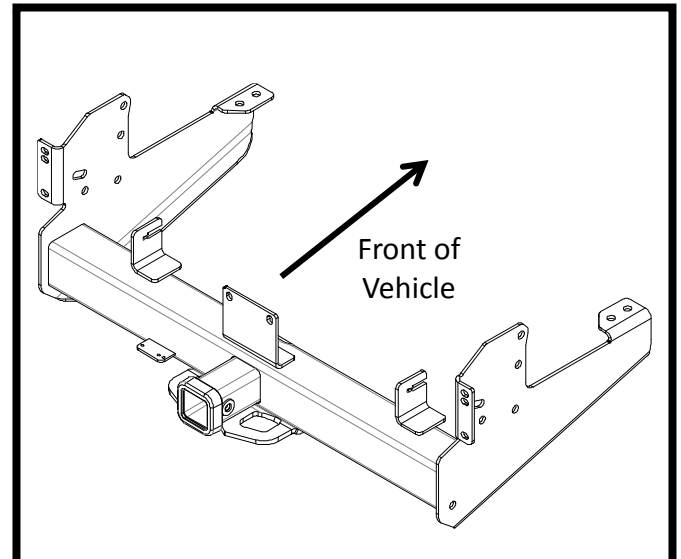

Hitch Illustration



Always wear **SAFETY GLASSES** when installing hitch

Installation Instructions

PART NUMBERS: 45509, 45709, CQT45509

NOTE;
WITH THIS HITCH INSTALLED
THE STEP BUMPER IS NO LONGER ABLE
TO BE USED AS A TOWING POINT.

Must have pick-up chassis
 Spring mount (as shown
 above the frame).

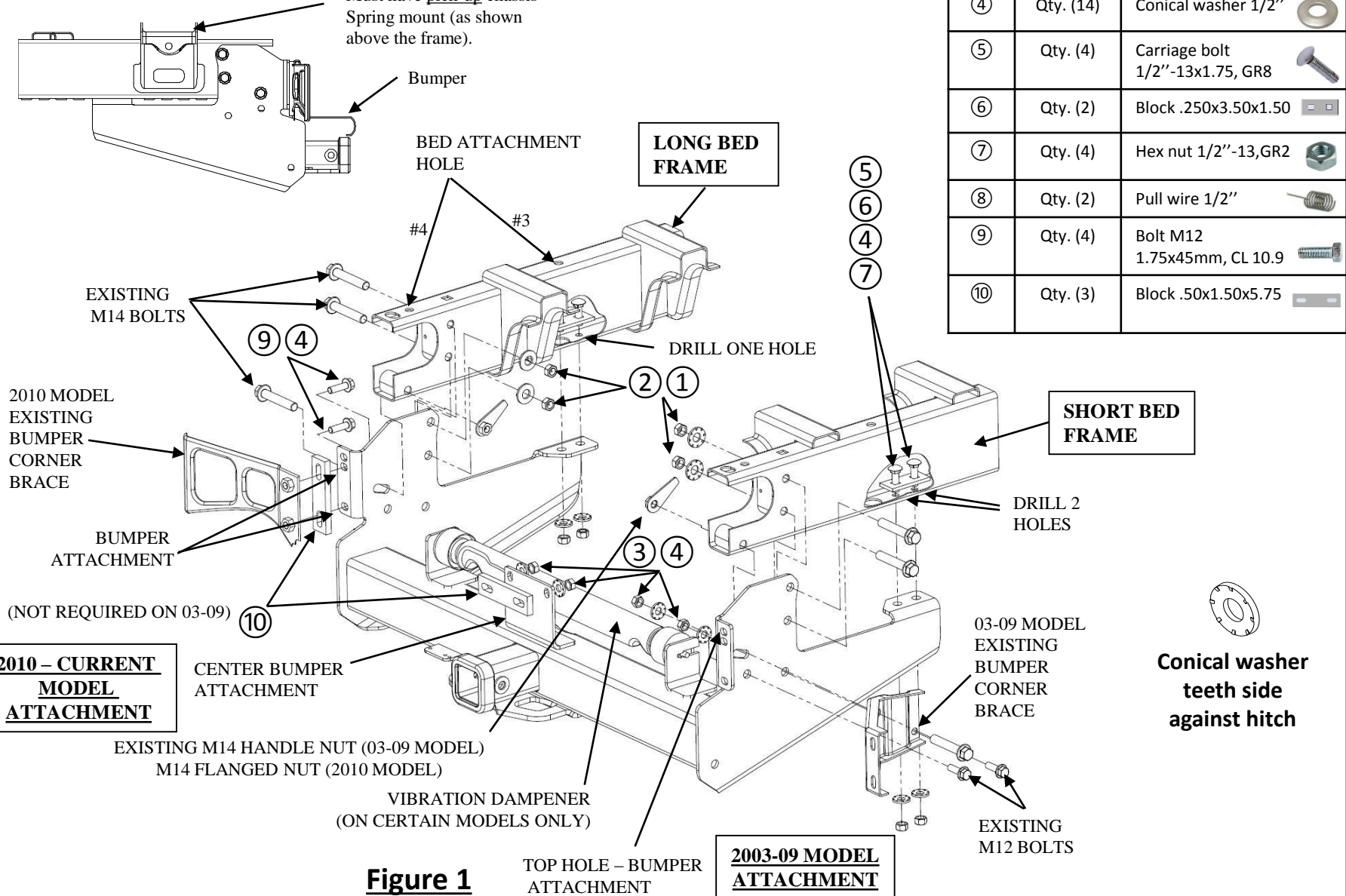

Fastener Kit: 45509F

①	Qty. (4)	Hex nut M14x2.00	
②	Qty. (4)	Conical washer 5/8"	
③	Qty. (6)	Hex nut M12x1.75	
④	Qty. (14)	Conical washer 1/2"	
⑤	Qty. (4)	Carriage bolt 1/2"-13x1.75, GR8	
⑥	Qty. (2)	Block .250x3.50x1.50	
⑦	Qty. (4)	Hex nut 1/2"-13,GR2	
⑧	Qty. (2)	Pull wire 1/2"	
⑨	Qty. (4)	Bolt M12 1.75x45mm, CL 10.9	
⑩	Qty. (3)	Block .50x1.50x5.75	

2010 - CURRENT MODEL ATTACHMENT

EXISTING M14 HANDLE NUT (03-09 MODEL)
 M14 FLANGED NUT (2010 MODEL)

VIBRATION DAMPENER
 (ON CERTAIN MODELS ONLY)

Figure 1

TOP HOLE - BUMPER ATTACHMENT

2003-09 MODEL ATTACHMENT

Conical washer teeth side against hitch



Always wear SAFETY GLASSES
when installing hitch

Installation Instructions

PART NUMBERS: 45509, 45709, CQT45509

- Lower spare tire for ease of installation. (18 INCH SPARE TIRE WILL REQUIRE REMOVAL OF THE TIRE LOCATOR BRACKET (SEE FIGURE 3) AND 20 INCH SPARE TIRE MUST BE RELOCATED FROM UNDER THE BED)
- Remove 6 of the rear most bed attachment bolts. These can be accessed thru large holes in bottom of frame or suspension mounts. Leave the two forward most bed bolts tight. (Total of eight bed bolts)
- Raise back of bed up and place a 2" thick wooden block between frame and #3 bed attachment location.
- Remove license plate to access two bolts for next step.
- Protect and then remove the bumper by removing 6 to 12 bolts (depending on model year).
 - (03-09) Two M12 bolts and one M14 bolt from the inner bumper corner brace to the bumper / hitch attachment - per side.
 - (03-09) One M12 bolt from the frame rail bumper attachment to the bumper - per side.
 - (2010) Two M12 bolt from the frame rail bumper attachment to the bumper - per side.
 - (all years) Two M12 bolt at the license plate area - uncovered in step 4.
- Set bumper aside for re-installation later.
- Remove the bumper / hitch structure.
 - (03-09) Remove the last two M14 bolts at the frame rail.
 - (2010) Remove three M14 bolts at the frame rail.
 - The structure will need to be rotated up and pulled back to clear boss and tab / slot engagements. See figure 2.
- Lower bed and reinstall the bed bolts.
- Raise hitch into position and use two forward most M14 bolt (2 per side) to hold it in place.
- Using the hitch as a template, mark and drill 9/16" holes in bottom of frame.
- Fish wire the 1/2" carriage bolts and block into place thru the end of the frame. Attach 1/2" washers and nuts finger tight.
- If equipped, remove the vibration dampener from OEM unit and install on this unit (as shown in figure 1).
- To ease the installation of the bumper, loosen the two bolts per side at the inner and outer corner brace (03-09 model only).
- Raise bumper into position and attach with bolts from step 5.
- Install the remaining fasteners per figure 1.
- Measure the gap between bumper and tail gate and adjust for even gap. Tighten fasteners.
- Raise spare tire.
- Give the OEM bumper / hitch structure to customer in case hitch is removed.

Note: check hitch frequently, making sure all fasteners and ball are properly tightened. If hitch is removed, plug all holes in trunk pan or other body panels to prevent entry of water and exhaust fumes. A hitch or ball which has been damaged should be removed and replaced. Observe safety precautions when working beneath a vehicle and wear eye protection. Do not cut access or attachment holes with a torch.

This product complies with safety specifications and requirements for connecting devices and towing systems of the state of New York, V.E.S.C. Regulation V-5 and SAE J684.

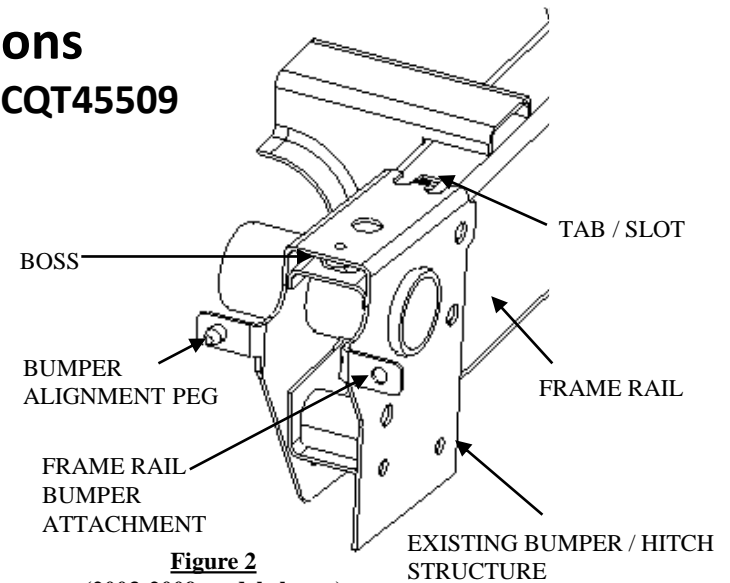

Figure 2
(2003-2009 model shown)

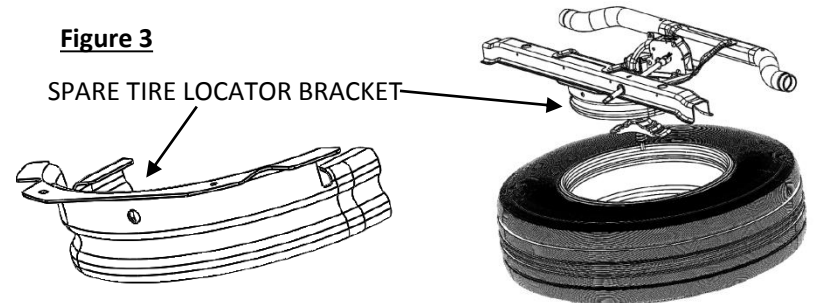

Figure 3

Tighten M12 hitch fasteners with torque wrench to 75 Lb.-Ft. (102 N*M)

Tighten M14 and 1/2" fasteners with torque wrench to 100 Lb.-Ft. (136 N*M)

Tighten M12 bed fasteners with torque wrench to 85 Lb.-Ft. (115 N*M)

Tighten all M10 fasteners with torque wrench to 42 Lb.-Ft. (57 N*M)



Proper torque is needed to keep the hitch secure to the vehicle when towing.