

INSTALL/REMOVAL INSTRUCTIONS: IGNITION LOCK CYLINDER

ATTENTION: Refer to the appropriate shop manual for your vehicle to obtain specific service procedures for this part. If you do not have a service manual or lack the skill to install this part, it is recommended that you seek the services of a qualified technician. Pay special attention to all cautions and warnings included in the shop manual. Read and follow all instructions carefully.

REMOVAL/INSTALL OF IGNITION LOCK CYLINDER (989-018) Ford 2011–00, Lincoln 2004–03, Mazda 2009–01, Mercury 2007–00

General Tech Tip:

- This lock cylinder kit consists of an ignition lock with keys and a programming tool. There are 3 keys provided in this kit; 2 transponder security keys and 1 non-transponder security key. The 2 transponder keys will need to be programmed to your car to avoid a no-start condition.

**PLEASE WEAR
SAFETY GLASSES!**

Removal Instructions

STEP 1: Disconnect negative battery cable.

STEP 2: Rotate the lock cylinder to the run position.

STEP 3: Insert a small screwdriver or small drift punch in the hole in the trim shroud under lock cylinder. Push retaining pin in with the tool while pulling on the lock cylinder to remove it from the column.



Disclaimer:

Even though every attempt is made to ensure this information is complete and accurate, it is impossible to account for all possible circumstances or situations. Please consult with a qualified auto technician before attempting to perform any work you are not qualified to do. Automobiles can be hazardous to work on; be sure to take all necessary safety precautions. Failure to do so may result in property damage or personal injury. Certain motor vehicle standards and performance requirements may apply to your motor vehicle (such as Federal Motor Vehicle Safety Standards by the National Highway Traffic Safety Administration). Be sure that your work is performed in accordance with such standards and that you do not disable any motor vehicle safety feature.

INSTALL/REMOVAL INSTRUCTIONS: IGNITION LOCK CYLINDER

ATTENTION: Refer to the appropriate shop manual for your vehicle to obtain specific service procedures for this part. If you do not have a service manual or lack the skill to install this part, it is recommended that you seek the services of a qualified technician. Pay special attention to all cautions and warnings included in the shop manual. Read and follow all instructions carefully.

Installation Instructions

STEP 1: Install the new lock cylinder by rotating the new lock to the run position and pressing down on retaining pin.

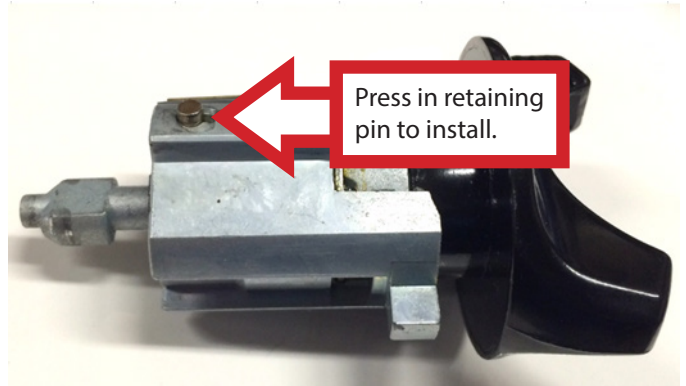

STEP 2: Insert the lock into the column. Ensure that the cylinder is fully seated and aligned in the interlocking washer before turning the key to the off position. This will enable the lock retaining pin to extend into cylinder housing.

STEP 3: Rotate the new lock cylinder using the key to ensure proper operation in all positions.

STEP 4: Reconnect the battery.

Programming Procedure

STEP 1: Remove all keys from the ring and separate them from each other.

STEP 2: Plug the programmer into the OBD2 port. (The OBD2 port is located under the dash by brake pedal). Wait for a beep.



Disclaimer:

Even though every attempt is made to ensure this information is complete and accurate, it is impossible to account for all possible circumstances or situations. Please consult with a qualified auto technician before attempting to perform any work you are not qualified to do. Automobiles can be hazardous to work on; be sure to take all necessary safety precautions. Failure to do so may result in property damage or personal injury. Certain motor vehicle standards and performance requirements may apply to your motor vehicle (such as Federal Motor Vehicle Safety Standards by the National Highway Traffic Safety Administration). Be sure that your work is performed in accordance with such standards and that you do not disable any motor vehicle safety feature.

INSTALL/REMOVAL INSTRUCTIONS: IGNITION LOCK CYLINDER

ATTENTION: Refer to the appropriate shop manual for your vehicle to obtain specific service procedures for this part. If you do not have a service manual or lack the skill to install this part, it is recommended that you seek the services of a qualified technician. Pay special attention to all cautions and warnings included in the shop manual. Read and follow all instructions carefully.

STEP 3: Insert the non-transponder key into the new lock while simultaneously holding the original key up against the lock. Turn the key to the ON position without starting, and wait for programmer to beep. **NOTE:** Do not hold original key next to the column or ignition after step 3 as this will cause a programming failure.



STEP 4: Insert the first new transponder key. Turn the key to the ON position but do not start vehicle. Wait for the programmer to beep twice.

STEP 5: The programmer will begin a 10 minute security access wait. The programmer LED will flash.

STEP 6: The programmer will beep twice when security access is obtained.

STEP 7: Cycle the first new key from ON to OFF back to ON.

STEP 8: Wait for the programmer to beep once, then the turn key to the off position and remove.

STEP 9: Insert the second new transponder key and turn to ON position.

STEP 10: The programmer will beep 3 times when programming is complete.

STEP 11: Both transponder keys are now programmed; the non-transponder key can be discarded.