

# INSTALL/REMOVAL INSTRUCTIONS: IGNITION LOCK CYLINDER

**ATTENTION:** Refer to the appropriate shop manual for your vehicle to obtain specific service procedures for this part. If you do not have a service manual or lack the skill to install this part, it is recommended that you seek the services of a qualified technician. Pay special attention to all cautions and warnings included in the shop manual. Read and follow all instructions carefully.

## REMOVAL/INSTALL OF IGNITION LOCK CYLINDER (924-730) Ford 1996–90, Lincoln 1998–93, Mercury 1995–90

**PLEASE WEAR  
SAFETY GLASSES!**

### Removal Instructions

**STEP 1:** Disconnect battery

**STEP 2:** Rotate lock cylinder to the run position.

**STEP 3:** Push a small screwdriver or small drift punch in hole in trim shroud under lock cylinder. Push retaining pin in while pulling on lock cylinder to remove from column.



# INSTALL/REMOVAL INSTRUCTIONS: IGNITION LOCK CYLINDER

**ATTENTION:** Refer to the appropriate shop manual for your vehicle to obtain specific service procedures for this part. If you do not have a service manual or lack the skill to install this part, it is recommended that you seek the services of a qualified technician. Pay special attention to all cautions and warnings included in the shop manual. Read and follow all instructions carefully.

## Installation Instructions

**STEP 1:** Install lock cylinder by rotating the new lock to the run position and pressing down on retaining pin.

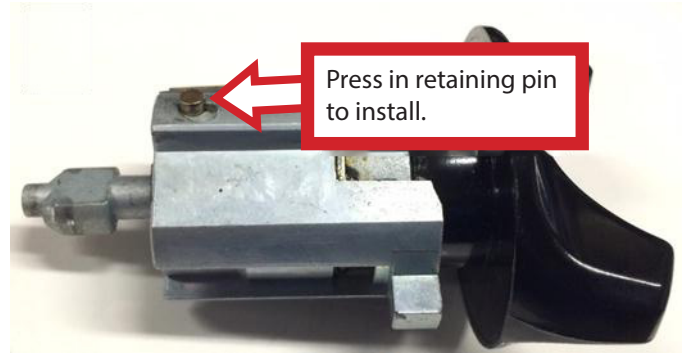

---

**STEP 2:** Insert lock into column. Ensure that cylinder is fully seated and aligned in interlocking washer before turning key to the off position. This will enable the lock retaining pin to extend into cylinder housing.

**STEP 3:** Rotate new lock cylinder using key to ensure proper operation in all positions.

**STEP 4:** Reconnect battery.