

INSTALL/REMOVAL INSTRUCTIONS: IGNITION LOCK CYLINDER

ATTENTION: Refer to the appropriate shop manual for your vehicle to obtain specific service procedures for this part. If you do not have a service manual or lack the skill to install this part, it is recommended that you seek the services of a qualified technician. Pay special attention to all cautions and warnings included in the shop manual. Read and follow all instructions carefully.

REMOVAL/INSTALL OF IGNITION LOCK CYLINDER (924-703)

Chrysler 2007–1998, Dodge 2009–1998, Jeep 2005–1998, Plymouth 2001–1997

General Tech Tip:

- This lock cylinder must be coded to the original vehicle key if your vehicle uses a key with a microchip or if you wish to retain the original key. If your vehicle uses a key with a microchip and you do not code the new cylinder to use the original key, the car will not sense the chip and will start and then shut right off and will not run.

**PLEASE WEAR
SAFETY GLASSES!**

Instructions

The ignition lock cylinder uses eight cut positions for tumblers. The ignition tumblers (3) are located on both sides of the cylinder (1) and are self-retaining.

STEP 1: Remove the old cylinder from the steering column.

INSTALL/REMOVAL INSTRUCTIONS: IGNITION LOCK CYLINDER

ATTENTION: Refer to the appropriate shop manual for your vehicle to obtain specific service procedures for this part. If you do not have a service manual or lack the skill to install this part, it is recommended that you seek the services of a qualified technician. Pay special attention to all cautions and warnings included in the shop manual. Read and follow all instructions carefully.

STEP 2: Locate brass lock pin on side of tumbler housing. Note that there are two (2) pins. One side of the tumbler has a lock position.



STEP 3: Insert supplied key and turn tumbler counter clockwise to the "Accessory" position. **NOTE:** the key will not be removable from the lock cylinder when in this position.



STEP 4: Using a small screwdriver, press the brass pin down and rotate the tumbler counter clockwise to unlock tumbler.

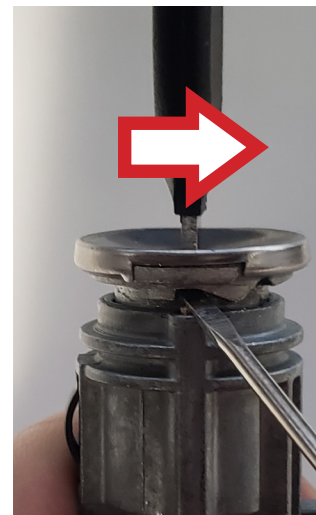

INSTALL/REMOVAL INSTRUCTIONS: IGNITION LOCK CYLINDER

ATTENTION: Refer to the appropriate shop manual for your vehicle to obtain specific service procedures for this part. If you do not have a service manual or lack the skill to install this part, it is recommended that you seek the services of a qualified technician. Pay special attention to all cautions and warnings included in the shop manual. Read and follow all instructions carefully.

STEP 5: Tumbler is now removable from the housing.

STEP 6: Using the original key and a small screwdriver, remove the old cylinder from the case to expose the tumblers. Each of the eight tumblers is stamped with a number 1, 2, 3, or 4. For your original key to work, they must be replaced in the new cylinder exactly as they were placed in the old cylinder.

STEP 7: Remove the tumblers, one at a time from the old cylinder, noting the identification number and its position in the cylinder.

STEP 8: Using the new key, remove the new cylinder from its case, and remove the new tumblers from it, taking care not to lose the springs (2). Now place new tumblers back into the slots, in the same order that you recorded when you removed the tumblers from the old cylinder. Use new tumblers, as necessary, with parts provided in the kit. Do not reuse the old tumblers since worn tumblers are the primary cause of lock cylinder failure.

STEP 9: When all of the tumblers have been replaced, squeeze them together and insert the old key. Now, reassemble the new cylinder into the new case.

STEP 10: Reinstall the new cylinder back into the steering column.

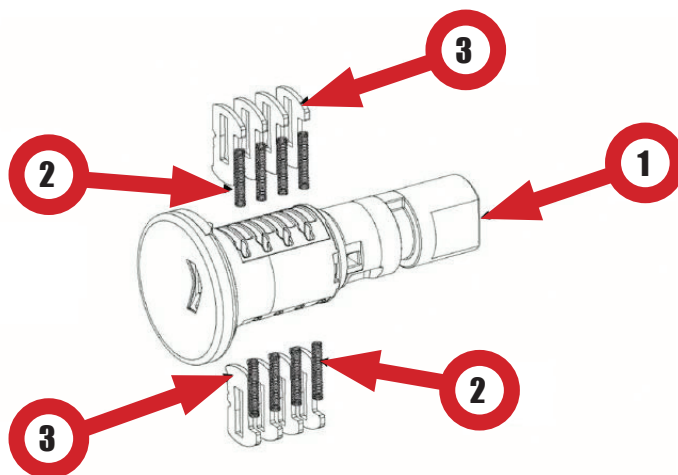

INSTALL/REMOVAL INSTRUCTIONS: IGNITION LOCK CYLINDER

ATTENTION: Refer to the appropriate shop manual for your vehicle to obtain specific service procedures for this part. If you do not have a service manual or lack the skill to install this part, it is recommended that you seek the services of a qualified technician. Pay special attention to all cautions and warnings included in the shop manual. Read and follow all instructions carefully.

1

2

3

4

OLD Cylinder

NEW Cylinder

Key Code