



**DINAN**

**REAR SHOCK MOUNT KIT  
INSTALLATION NOTES**

PART NUMBER D110-0009

APPLICATION: 2008-09 M3 (E90, E92, E93; EDC only)

Congratulations for being selective enough to use a Dinan Engineering rear shock mount. This mount allows for an additional 7mm of suspension travel, which improves vehicle handling and ride comfort.

We have spent many hours developing our suspension components to assure that you will receive maximum performance and durability with minimum difficulty in installation. Please take the time to read these notes and call us if you have any difficulties during the installation.

NOTE: This kit is designed to work in conjunction with stock BMW EDC shocks in an E9x M3, which have 14mm threads. DO NOT use this kit for any other application!

- DO NOT WORK ON VEHICLES SUPPORTED BY A JACK ONLY. USE SECURE JACK STANDS!
- Some of the existing upper shock mount components must be replaced with corresponding parts included in this kit. Study the assembly diagram carefully to determine which components are used, and the order in which they are assembled.
- Remember to install the bumpstop & cover before assembling upper shock mount!

---

**PARTS LIST**

Qty	Part #	Description
2	D112-0008	Shock Bushing; Lower
2	D112-0009	Shock Bushing; Upper
2	D112-0025	Spacer 14mm

---

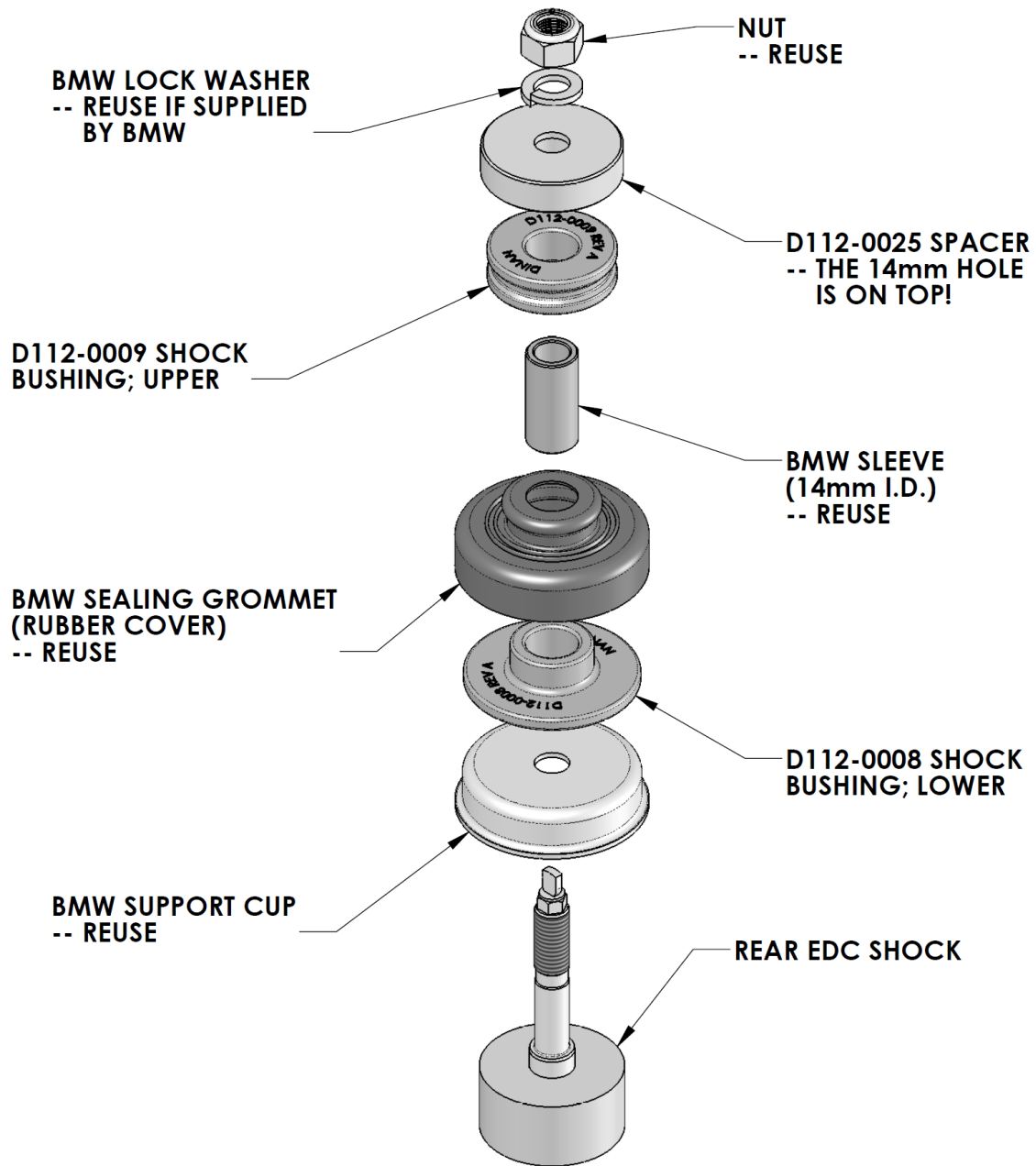

**BUMPSTOP NOT SHOWN FOR CLARITY**