



DINAN

**REAR SHOCK MOUNT KIT
INSTALLATION NOTES**

PART NUMBER DI10-0007

APPLICATION:	2006	325i, 330i (E90)
	2007-10	328i (E90, E92, E93)
	2007-10	335i/xi (E90, E92, E93)
	2011	335is (E92, E93; w/ N54 engine)
	2011	335i (E90, E92, E93; w/ N55 engine))
	2008-10	135i (E82)

Congratulations for being selective enough to use a Dinan Engineering rear shock mount. This mount allows for an additional 10mm of suspension travel, which improves vehicle handling and ride comfort.

We have spent many hours developing our suspension components to assure that you will receive maximum performance and durability with minimum difficulty in installation. Please take the time to read these notes and call us if you have any difficulties during the installation.

NOTE: This kit is designed to work in conjunction with Dinan DI40-0946 Rear Shocks, which have an external adjustment at the top of the shock shaft. This shock shaft has 12mm threads, which are larger than stock. DO NOT use this kit with stock shocks, or other shocks with 10mm threads on the shock shaft.

- DO NOT WORK ON VEHICLES SUPPORTED BY A JACK ONLY. USE SECURE JACK STANDS!
- Some of the existing upper shock mount components must be replaced with corresponding parts included in this kit. Study the assembly diagram carefully to determine which components are used, and the order in which they are assembled.
- Remember to install the bumpstop & cover before assembling upper shock mount!

PARTS LIST

Qty	Part #	Description
2	DI12-0007	Sleeve (12mm I.D.)
2	DI12-0008	Shock Bushing; Lower
2	DI12-0009	Shock Bushing; Upper
2	DI12-0010	Spacer

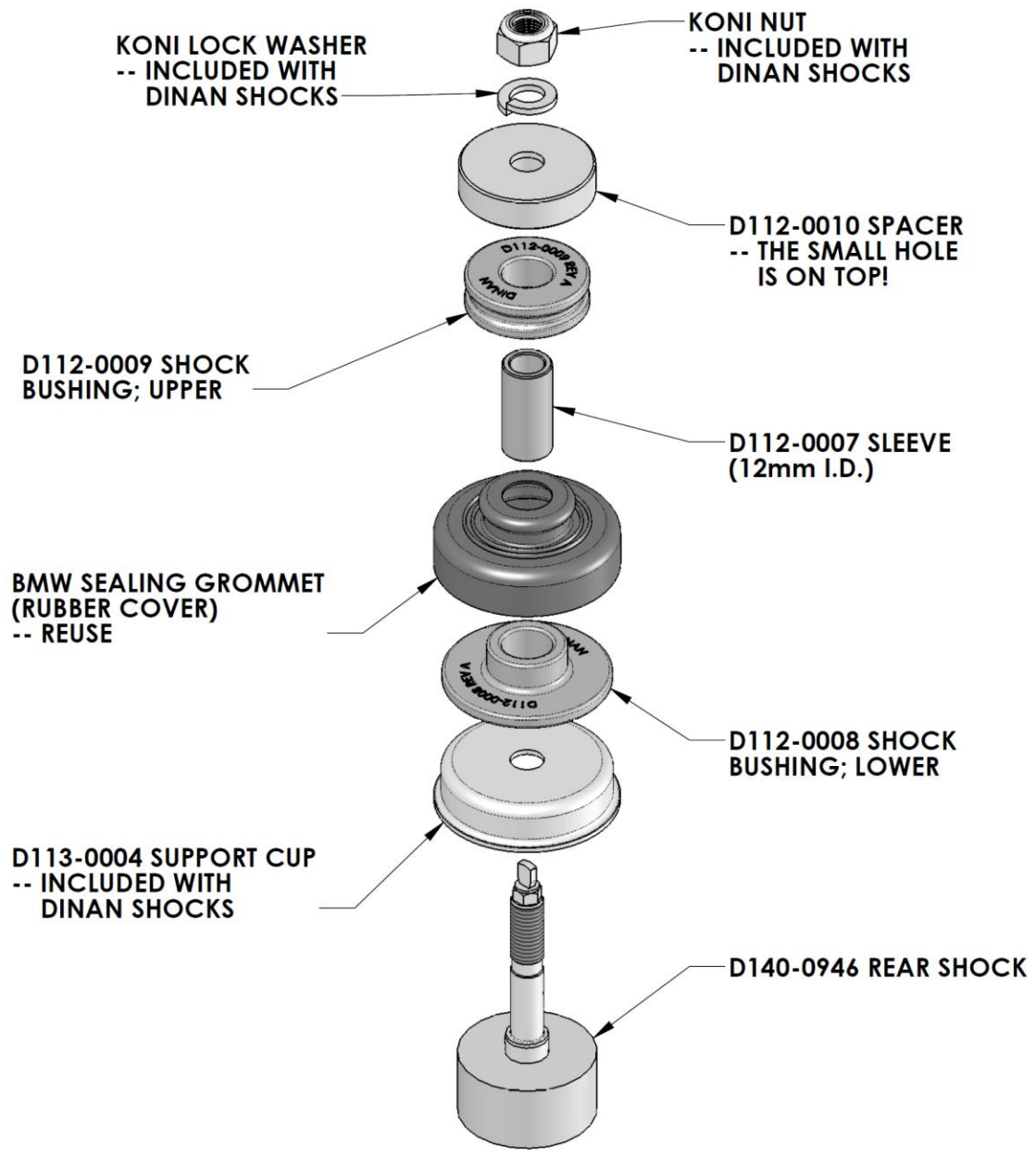

BUMPSTOP NOT SHOWN FOR CLARITY