

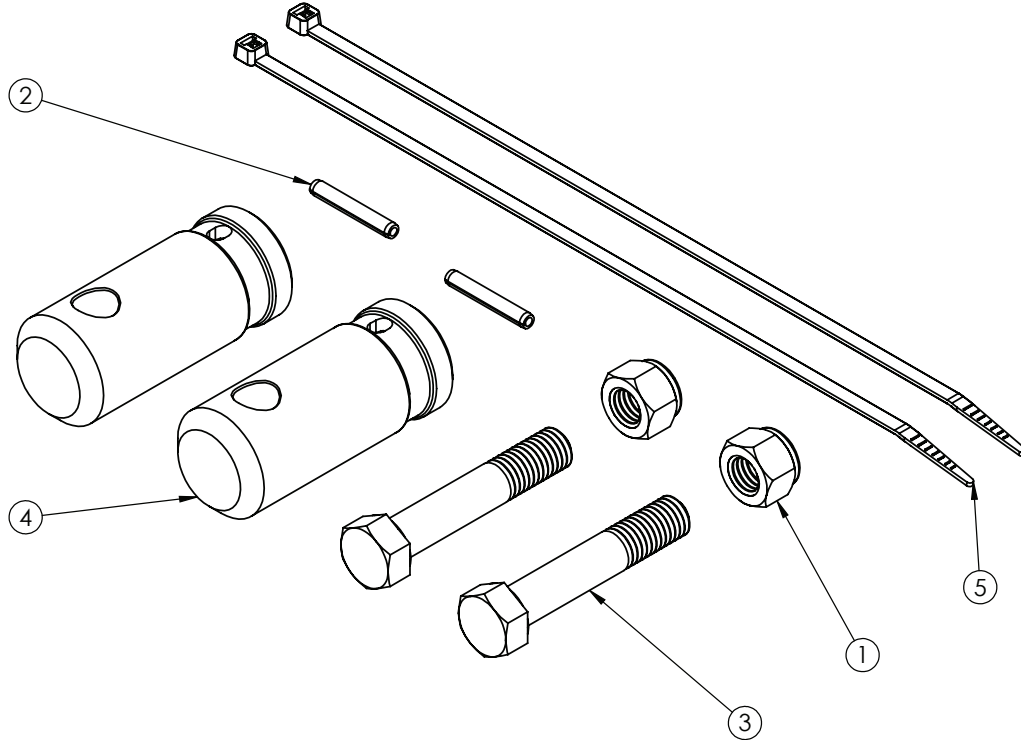

9523127
 Blue Ox Tow Bar to
 Demco Tableless Baseplate



9523127 PARTS LIST

ITEM	PART #	QTY	DESCRIPTION
1	02178	2	NUT, .50NC LOCK, NY. INSERT
2	02583	2	PIN, ROLL, .188 X 1.25 ZINC
3	15352	2	BOLT .50NC X 2.75 W/1.75 SHANK
4	15630-81	2	BLUE OX TABLESS ADAPTOR
5	NHT11	2	HOSE TIE, 11" NYLON
6	12329	1	THREAD LOCK BLUE TUBE (NOT SHOWN)

Please order replacement parts by PART NO. and DESCRIPTION



1. Cut plastic tie off of rubber boot on clevis end.

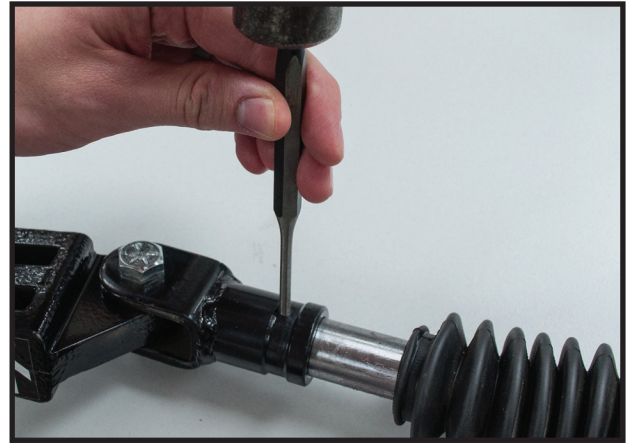

2. Use punch to drive out roll pin.



3. Use a vise grip with a rag or bench vise with rag to hold shaft and use a rod or wrench in the clevis to turn off clevis assembly.



4. Clean the threads and apply some thread lock to threads. Turn on the tabless adapter on shaft until it threads on all the way. Turn off until the hole in shaft lines up with hole in adapter. Drive the new roll pin in hole until flush with adapter.



5. With the hole facing up with tow bar, place the rubber boot over adapter and use the supplied plastic tie to clamp boot to adapter. Cut unused plastic tie.



6. Bolt tabless clevis to adapter making sure not to over tighten, the clevis should rotate freely.