

# Demco

## BASEPLATE

Fiat 500 Sport & Pop



Pin Height: 13-1/2" Centers: 24"

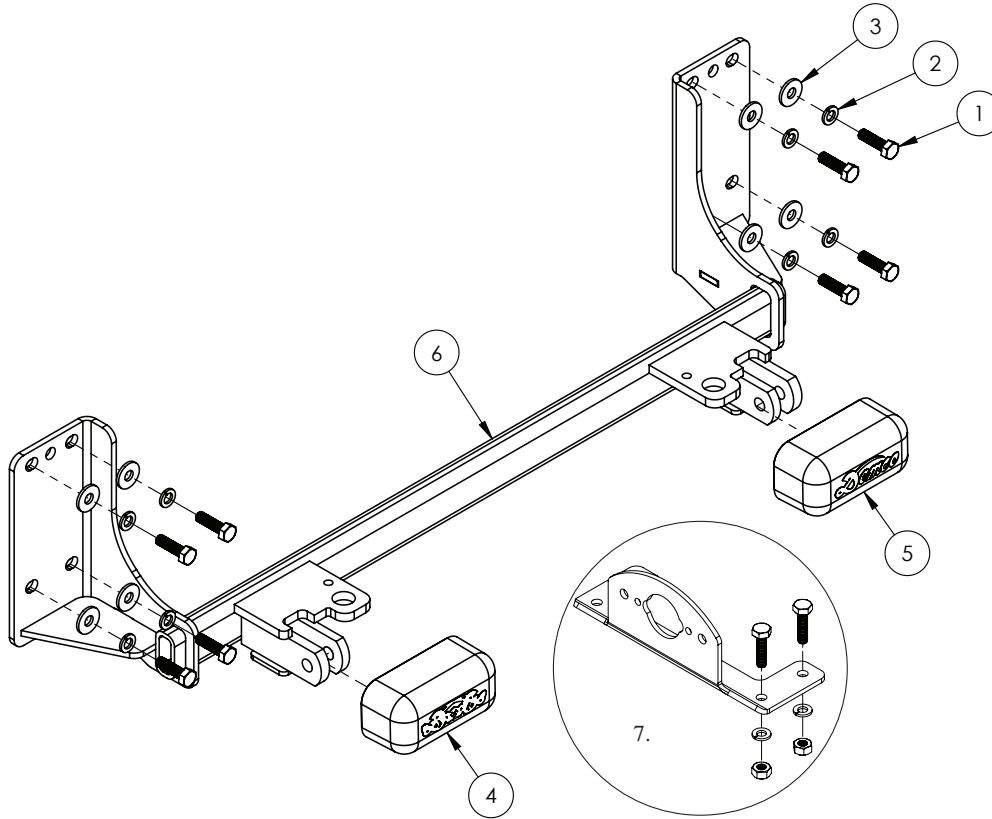

### 9518298 PARTS LIST

REF. NO.	PART NO.	QTY.	DESCRIPTION
1.	07281	8	10MM-1.25 X 35MM Hex Bolt Gr.8.8
2.	07284	8	10MM Lockwasher
3.	09229	8	10MM Fender Washer
4.	12979	1	Pull Ear Cover "A"
5.	12980	1	Pull Ear Cover "B"
6.	14468-76	1	Baseplate Crossmember
7.	5937	1	Plug Mount Kit
8.	12329	1	Loctite (not shown)

Please order replacement parts by PART NO. and DESCRIPTION.

ASSEMBLY  
OPERATION  
REPLACEMENT PARTS

**READ** complete manual CAREFULLY  
BEFORE attempting operation.

Doing Our Best to Provide You the Best

**WARNING: FAILURE TO FOLLOW THESE INSTRUCTIONS CAN RESULT IN LOSS OF TOWING VEHICLE CONTROL, SEPARATION OF THE TOW BAR FROM THE TOWING VEHICLE, SEPARATION OF THE TOWED VEHICLE FROM THE TOW BAR, CAUSING SEVERE PERSONAL INJURY, DEATH, OR PROPERTY DAMAGE.**



## CAUTION

Safety is of utmost importance at all times. There are several items that must be checked each time before using and while using a tow bar.

Before allowing anyone to hook up or operate a tow bar, be sure they have read and understand the proper operating procedure.

**DO NOT** use worn or damaged cables and/or pins.

Be sure the **SAFETY CABLES** are hooked, chassis to chassis, to both the towing and towed vehicles using the crisscross method.

Check clearance between vehicles in a turning situation.

Check base plate mounting bolts for tightness and frame for metal fatigue.

Do not load the towed vehicle with anything as you may exceed the towing capacity of the tow bar.

Keep fingers away from pivot points to prevent personal injury.

Be sure the steering components of the towed vehicle are properly aligned.

**NOTE:** This unit can be backed up in moderate increments. Any severe backwards cornering could result in damage to the Tow Bar and/or towed vehicle chassis.

**For automatic transmissions:** Consult your vehicle owners manual for towing suitability with the drive shaft connected. Otherwise, the towed vehicle will have to be equipped with a transmission pump or drive shaft disconnect.

Check to make sure that all lights are in proper working order.

**The information on towability of vehicles is reprinted with permission of MotorHome® Magazine,** and is believed to be reliable. However, **Demco does not** warrant the information to be correct. Always consult your towed vehicle owner's manual and follow towing instructions. Each year, **MotorHome® Magazine,** compiles a list of vehicles that can be towed four-down behind a motorhome with no modifications required. This guide contains only those vehicles that have been approved by their manufacturers for towing.

**Caution: MotorHome® Magazine** left out any vehicles that have towing speed limits slower than 55 m.p.h., or distance limits of less than 200 miles. At a minimum, these vehicles require significant modification, such as the use of an aftermarket product, to make them towable. The availability of a **Demco Tow Bar Base Plate** does **not** imply that these vehicles can be modified or that there is an aftermarket product available. Refer to your vehicle owner's manual or consult your dealer to determine whether your vehicle can be modified to make it towable. Failure to observe this precaution could result in property damage or personal injury.

### BOLT TORQUE SPECIFICATIONS

#### STANDARD BOLTS:

#### METRIC BOLTS:

Size	Grade	Torque	Size	Grade	Torque
5/16"	5	18 ft/lbs	8mm	8	23 ft/lbs
3/8"	5	30 ft/lbs	10mm	8	45 ft/lbs
7/16"	5	50 ft/lbs	12mm	8	78 ft/lbs
1/2"	5	75 ft/lbs	14mm	8	125 ft/lbs

## IMPORTANT INSTALLATION ITEMS

DEMCO products and accessories are intended to be installed by professional installers with experience, proper equipment and the ability to do modification work. Installers with these qualifications can be found in RV and Automotive Service Centers.

If the car to be towed has been in an accident, the chassis may be damaged in an area where the Base Plate attaches. It may no longer be suitable for towing. Extreme caution and careful examination are required in such a situation. It is also likely, even from a minor accident, that the hole alignment will be more difficult due to hole alignment problems.

Many DEMCO Base Plates are designed to use existing holes and hardware to mount the Base Plate to the towed vehicle. Even though the bolt is there, however, do not assume it is adequate for mounting the Base Plate. Manufacturers make many changes in hardware both within and between model years. Be sure the bolt is long enough to protrude past the nut a distance no less than 1/2 the diameter of the bolt, after the Base Plate is mounted. The threads should be in good condition. **We require that "LOCTITE® Blue" be used on all bolts.** If a new bolt is required, be sure it is SAE Grade 5 or Metric 8.8.

**NOTE: The dimensional variations between otherwise identical vehicles can be considerable. Some minor modifications may have to be made to ensure a proper fit.**



1. Remove four T30 Torx screws from top of fascia.



2. Remove three screws from front of each wheel well.

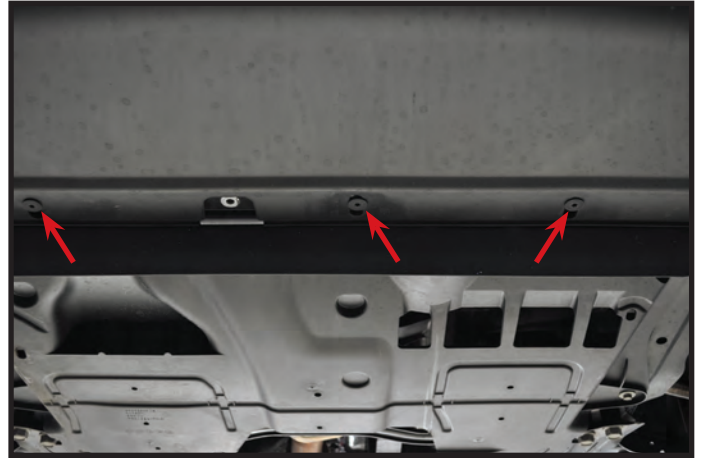

5. Remove three T30 Torx screws from underside of fascia.

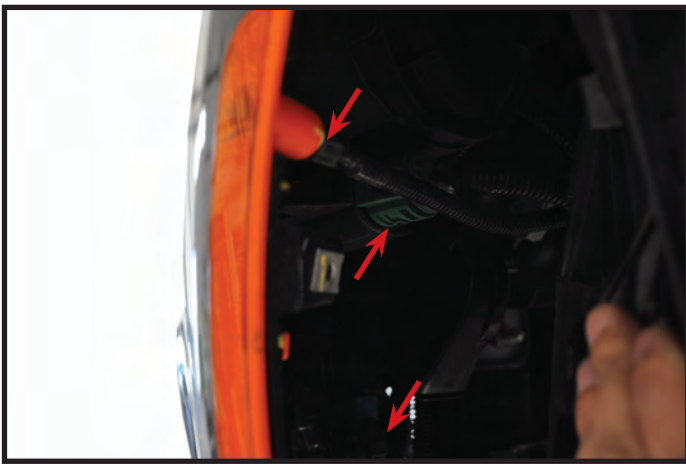

3. Pull inner wheel well back and unplug marker lights and head lights (if needed) on each side. Also unplug fog lights master disconnect on drivers side if equipped.



6. Remove one screw from fascia in front of tire on both sides of vehicle.



4. Remove one T30 Torx screw from behind inner wheel well liner on each side where fascia attaches to fender.



7. Pull out and forward from each side of fascia and set aside.

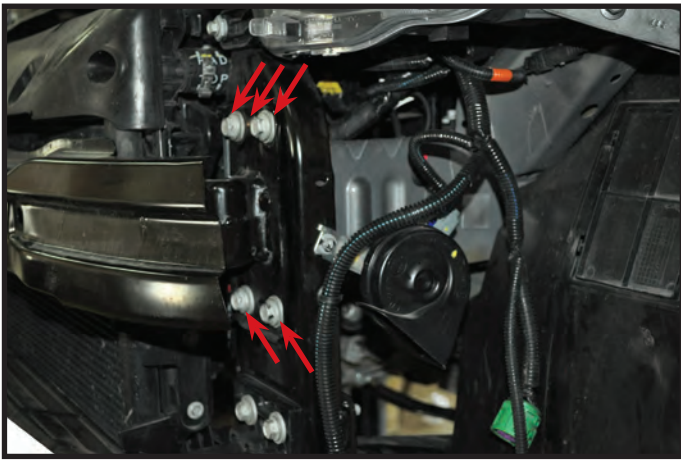

8. On each side of bumper remove four bolts and one nut and set bumper aside.



11. On each side of lower grill opening, trim as shown in picture. If needed trim fog light mount to allow fascia to mount properly.



9. On each bumper mount remove material as shown by line in picture. Once material is removed slide over baseplate to make sure enough has been removed.

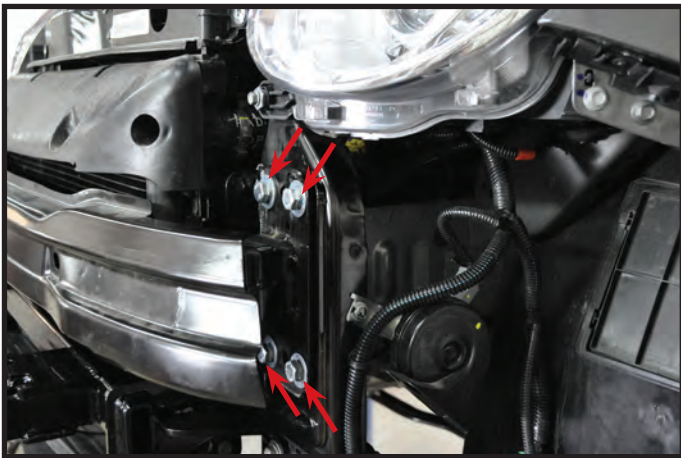

10. With an assistant mount bumper and baseplate (with baseplate between bumper and frame) with four 10MM-1.25 x 35mm bolts, 10MM lock washers, and 10MM fender washers on each side. **NOTE:** Use Blue **LOCTITE**® on threads and tighten bolts according to bolt chart on front page.



12. Reinstall fascia in reverse order. Plug mount (item #7) may be installed if desired in convenience holes on either chain anchor or as desired. **NOTE:** Excess material may be trimmed from bracket.

*Demco*