



Dee Zee Running Board Installation Instructions

Congratulations on your purchase of a quality Dee Zee product. Dee Zee is recognized as having the highest quality running boards and accessories on the market today. We have earned this reputation by offering our customers a product they can be proud to place on their vehicles. Dee Zee meets all the criteria of manufacturing a custom-fit product which guarantees it to be the easiest product to install.

Note: Please take time to read all of the instructions before beginning this installation.

Cleaning instructions: To maintain the finish of your Dee Zee Running Board, clean with a mild detergent and use a high grade automotive type wax. **DO NOT USE ABRASIVE CLEANERS ON THIS PRODUCT!**

Rough Step Running Board Installation Instructions DZ15336 (2013-Current) Dodge Ram

A Running Board

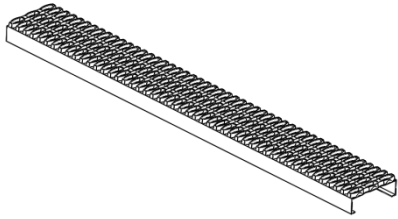

***** BOARDS SOLD SEPARATELY**

Various **SEPARATELY** X2

B Left Hand Bracket

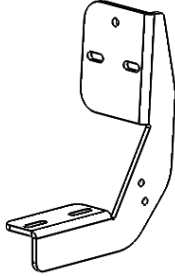

B 2266LP X3

C Right Hand Bracket

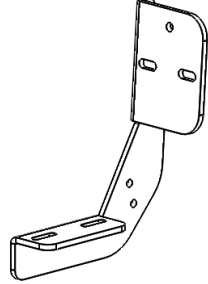

B 2266RP X3

D Left Hand Support Bracket

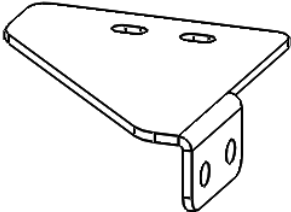

B 2267LP X3

E Right Hand Support Bracket

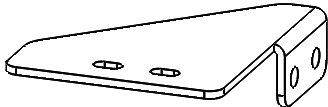

B 2267RP X3

F M8 Bolt

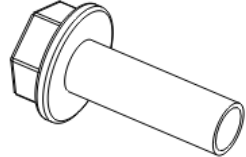

PN 525 X30

G 8MM Threaded Plate

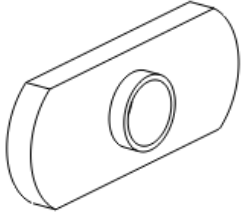

PN 611 X6

H M8 Crimp nut

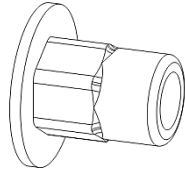

PN 686 X12

I 1/4" Carriage Bolt

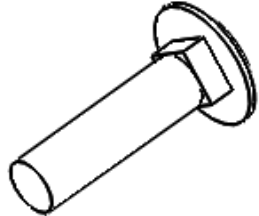

PN 1093 X12

J 1/4" Flat Washer



PN 72B X48

K 1/4" Hex Nut



PN 71B X30

L Install tool

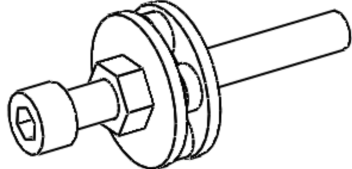

PN 685 X1

M

1/4" Hex Bolt

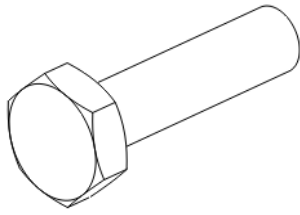

PN 96B

X18

N

M8 Nut

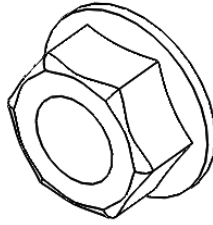

PN 526

X12

O

Strap Bracket

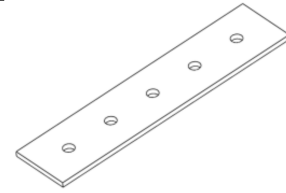

B 1791P

X6

P

Angle Bracket

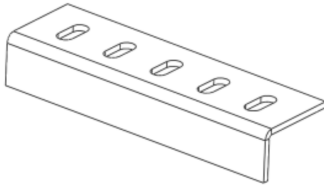

B 1792P

X6

Tools Required

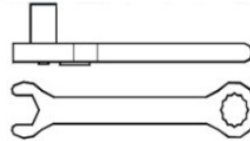
Ratchet / Wrench
13mm / 15mm / 7/16"**1**

Install the 8 mm Crimp Nut (H) as shown below.

Front
Passenger

**NOTE: FOR REGULAR CAB APPLICATIONS,
MIDDLE BRACKET LOCATION IS NOT AVAILABLE.
PROCEED AS DIRECTED USING FRONT AND REAR
MOUNTING LOCATIONS. EXTRA BRACKETS AND
HARDWARE MAY BE DISCARDED.**

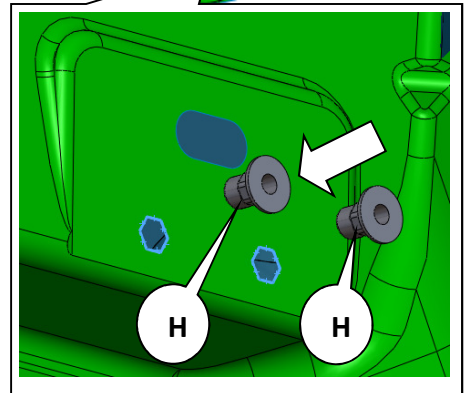
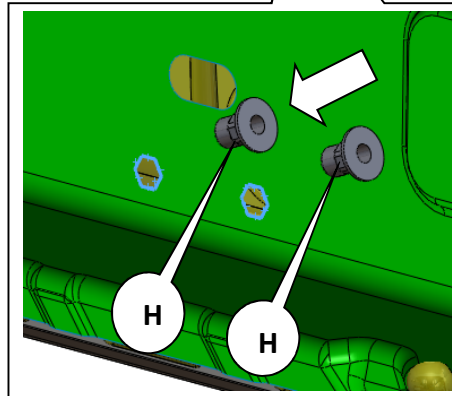
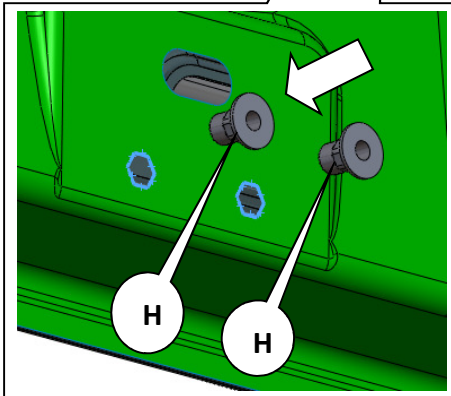
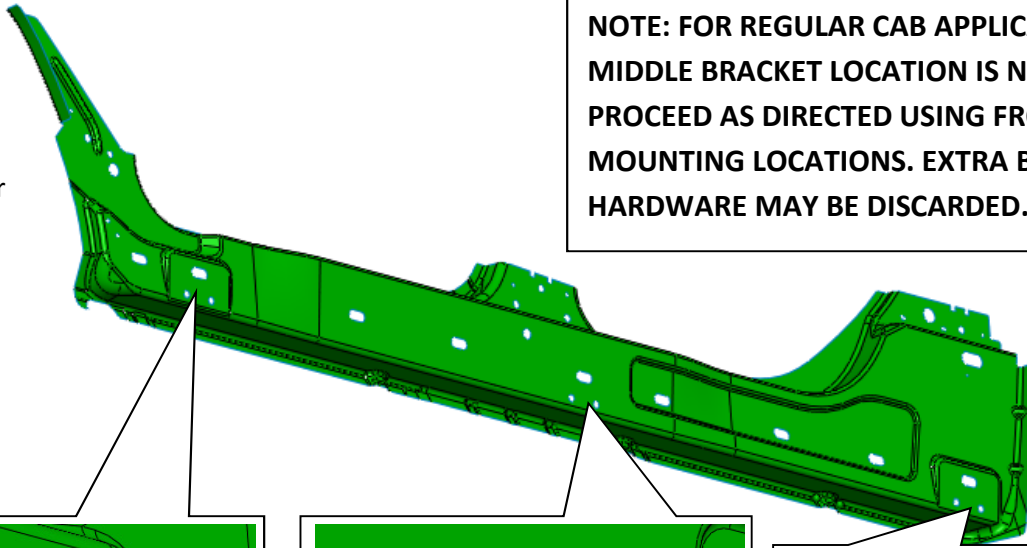

2

Because the nutserts are being installed in a hexagon shaped hole, the nut on the Install Tool (L) is not required. Remove the washers and bearing plate, and then remove the nut from the bolt.

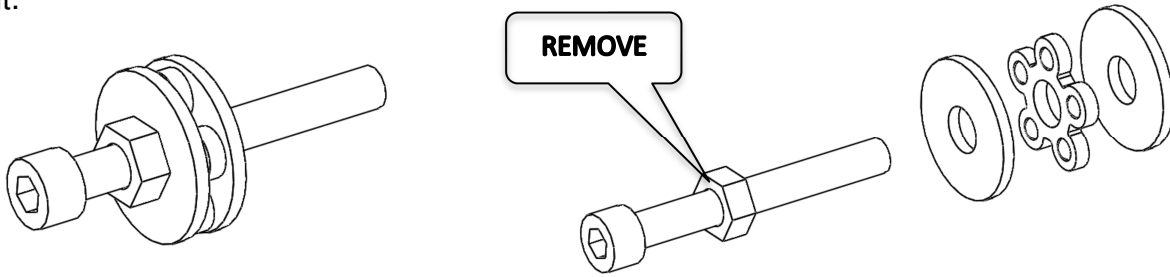

3

Replace the washers and bearing plate. Thread the bolt into a nutserts and tighten with a M6 allen wrench to set the nutserts. Torque the nutserts to the specification below to insure that they are set correctly.

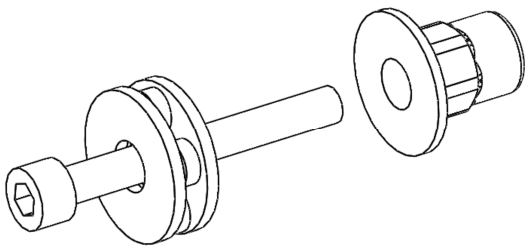

25-30 ft-lbs (34-40Nm)

4

Put an 8 mm x 25 mm bolt (F) through the top hole in the braces and thread into the 8mm threaded plate (G) until the bolt starts to come through the threaded plate using a 13 mm wrench or socket.

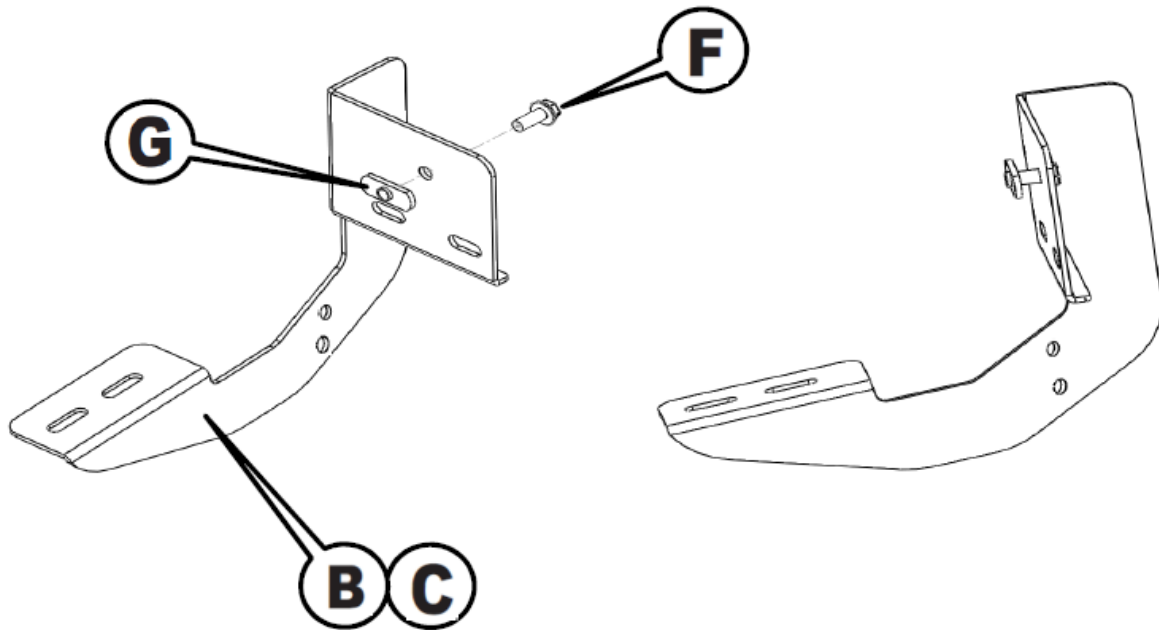
**5**

The vehicle cab style will determine which brackets are to be used at the different mounting locations. Please refer to the following cab drawings for bracket configurations.

REGULAR CAB

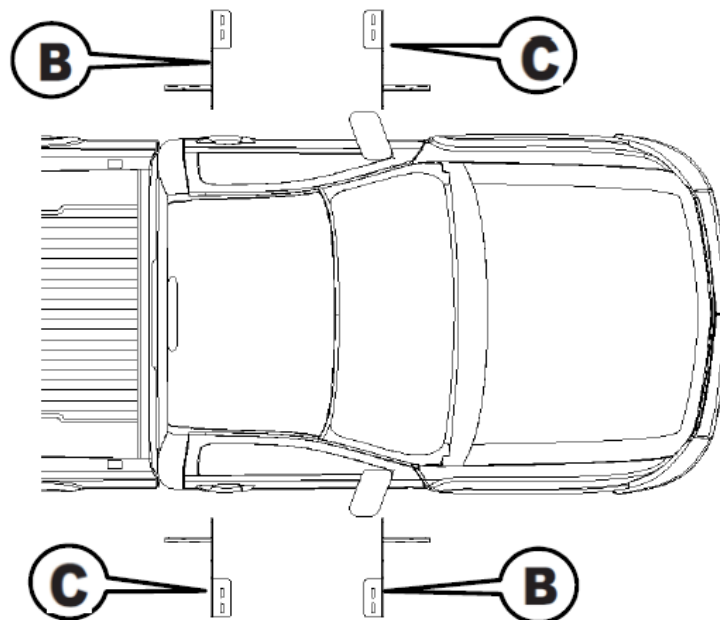

QUAD CAB

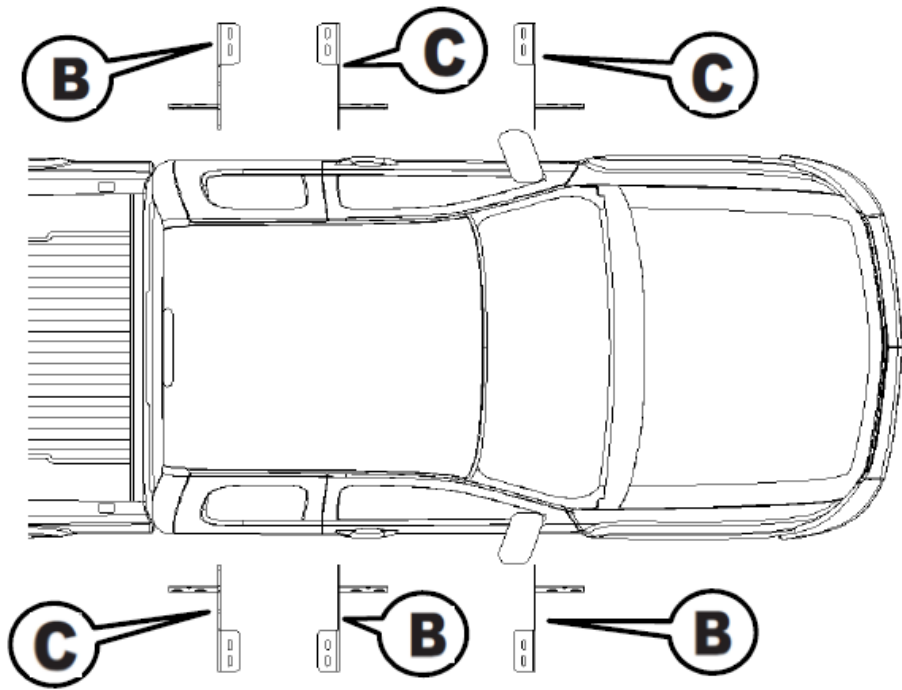

CREW CAB

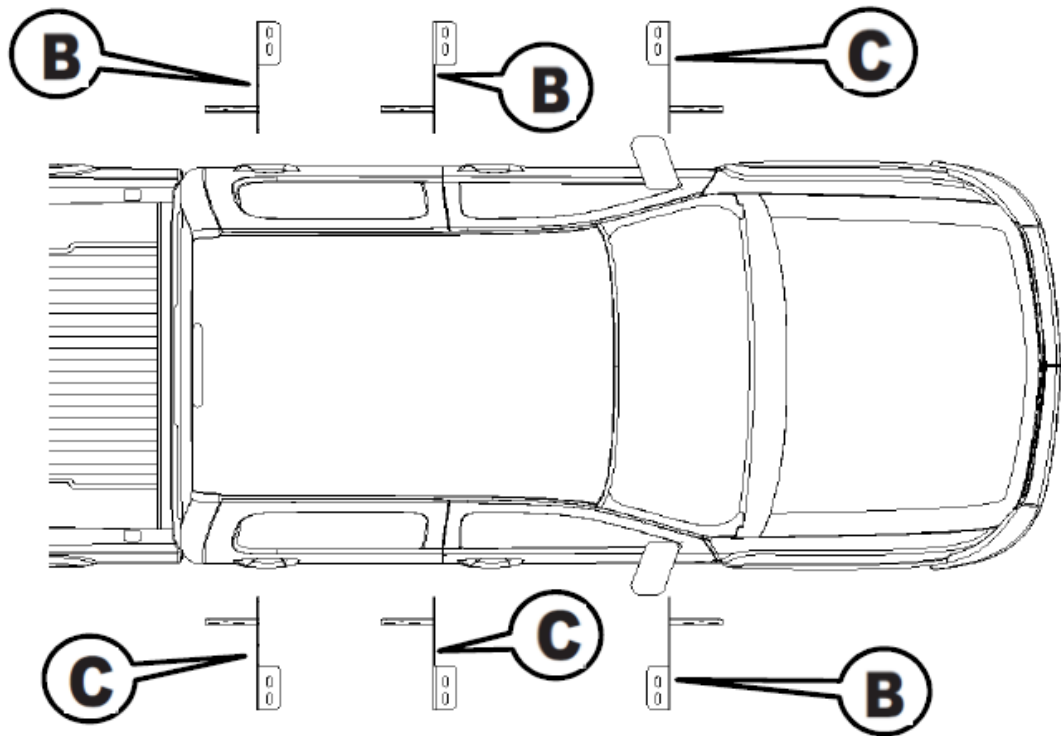

6

When the brace is put up to the vehicle mounting location, the threaded plate must go into the large slot above the nutserts previously installed.

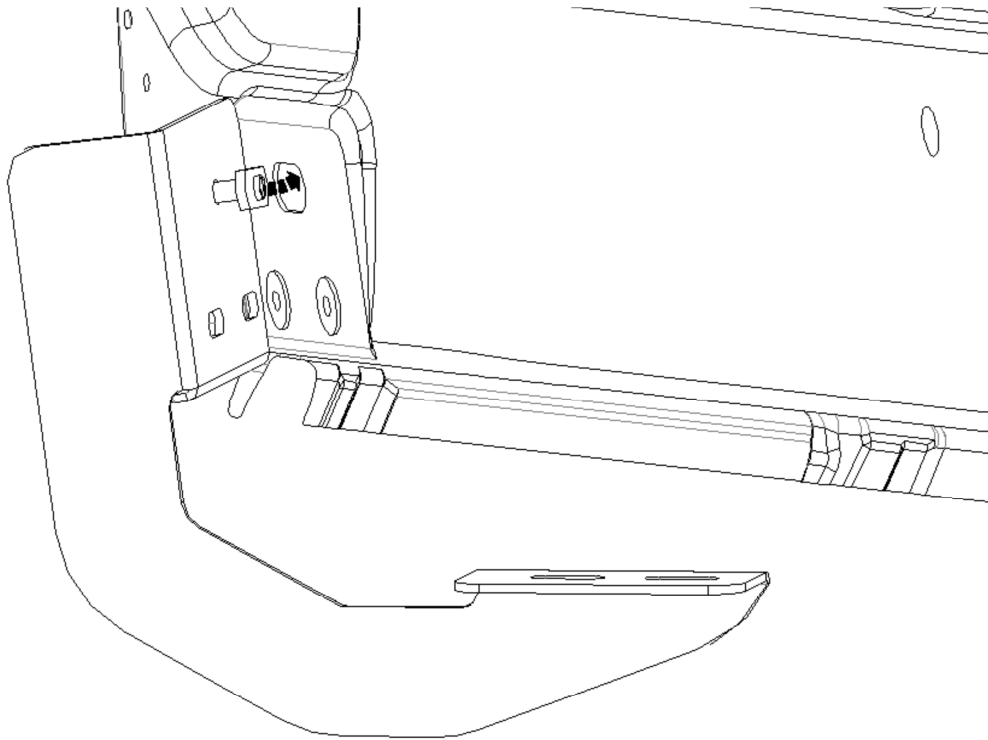
**7**

Thread 2 of the 8 mm bolts (F) through the slots in the braces into the nutserts (H). Only engage the bolts a few threads into the nutserts. Then pushing up on the brace to put tension on the threaded plate, tighten the top until it is snug but not completely tight. Tighten bottom bolts.

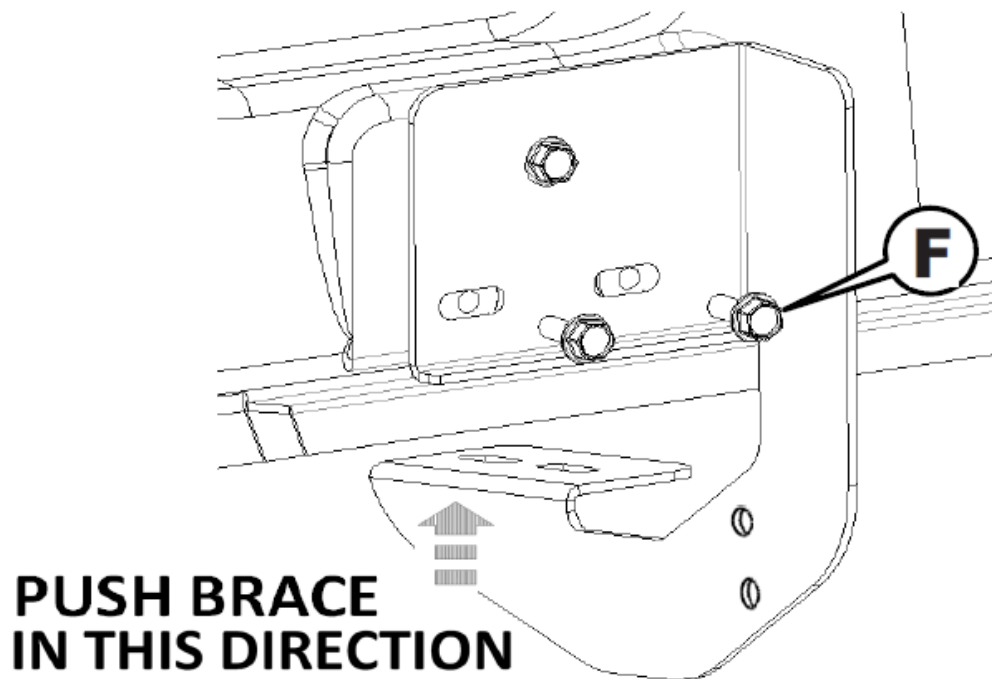

**PUSH BRACE
IN THIS DIRECTION**

8

Using two of the carriage bolts (I), two 1/4" washers (J), and two 1/4" nuts (K) loosely attach the support bracket (D/E) to the pinch weld on the truck. The bent flange with two holes in it should point up. Select the appropriate one for each of the mounting locations. Do not tighten.

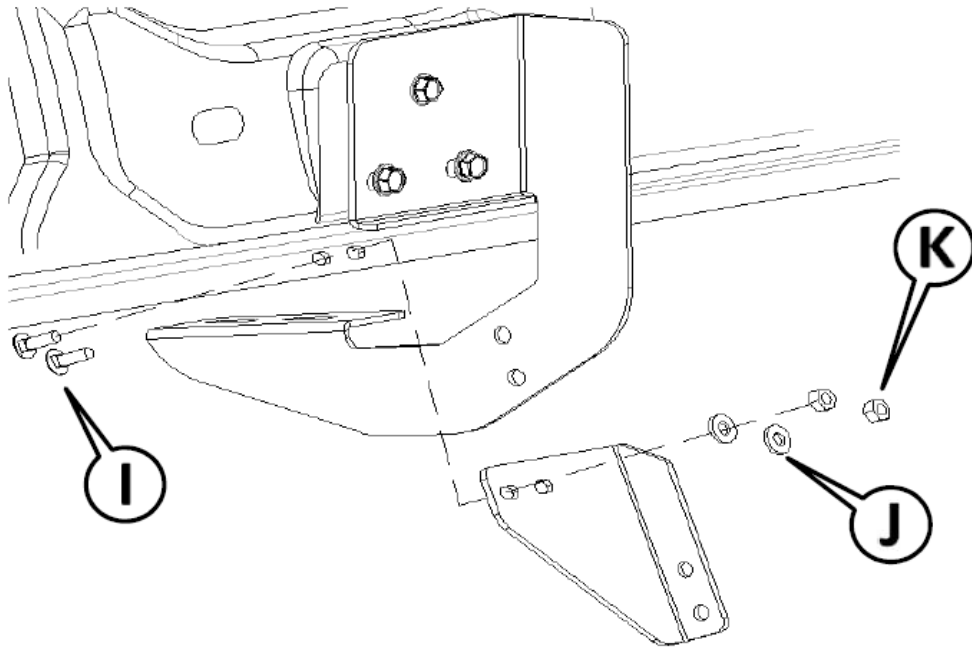
**9**

Attach the support brace to the main brace using two of the 8mm bolts (F) and two of the 8mm flange nut (N). Do not tighten at this time.

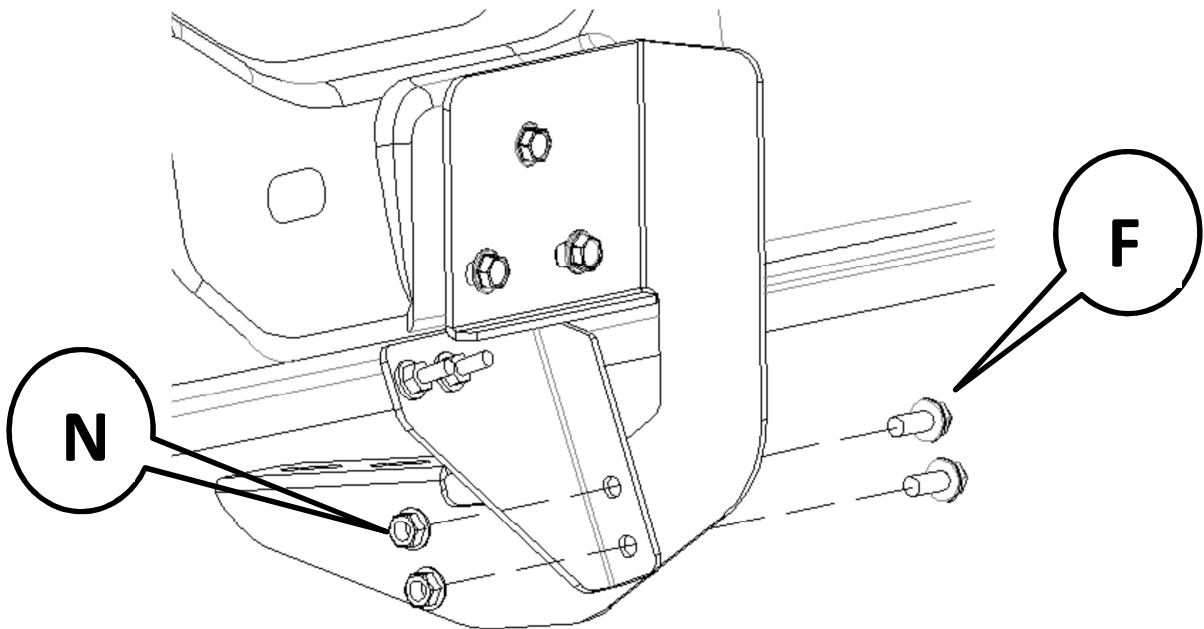

- 10** With the end caps off of the running board (A), slide strap brackets (O) into one of the ends on the running board. For Regular Cab use 2 strap brackets per board, and for both Quad Cab and Crew Cab use 3 strap brackets per board. After slide straps are installed, install the end caps onto both ends of the running boards.

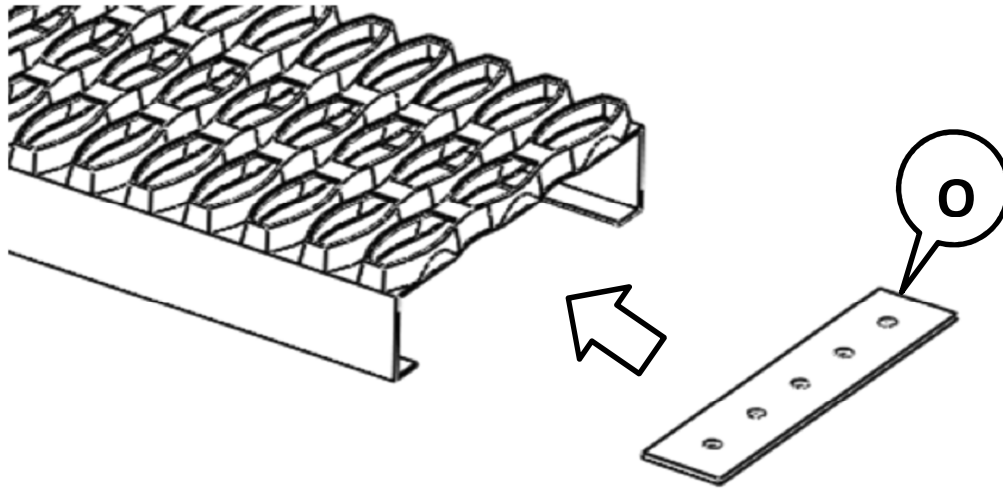

- 11** Align the strap brackets that were placed inside the board on the previous step with the braces that are attached to the vehicle (Braces B&C). Place an angle brace (P) on the brace board mounting area. Attach the running board to the brace using three bolts (J), six washers (K), and six nuts (I) at each location and repeat for all braces. Do not completely tighten the hardware at this time.

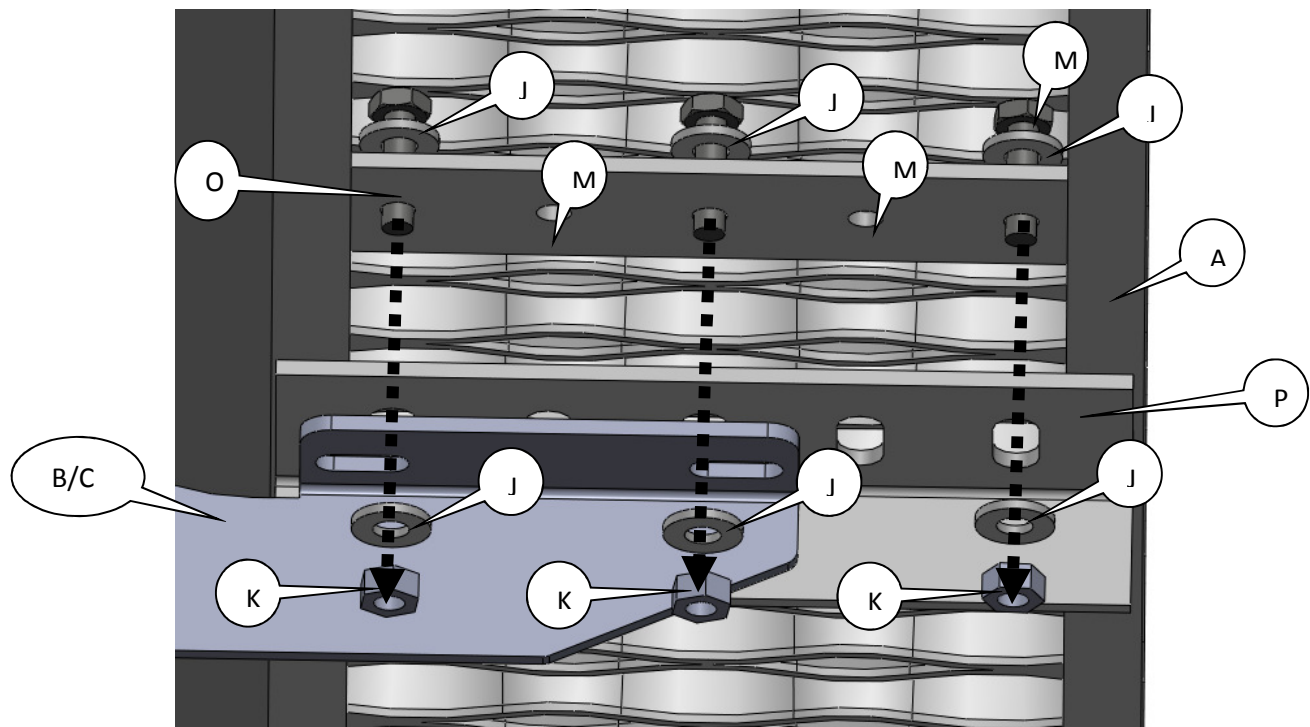

12

Align the board with the vehicle from to back and in/out.

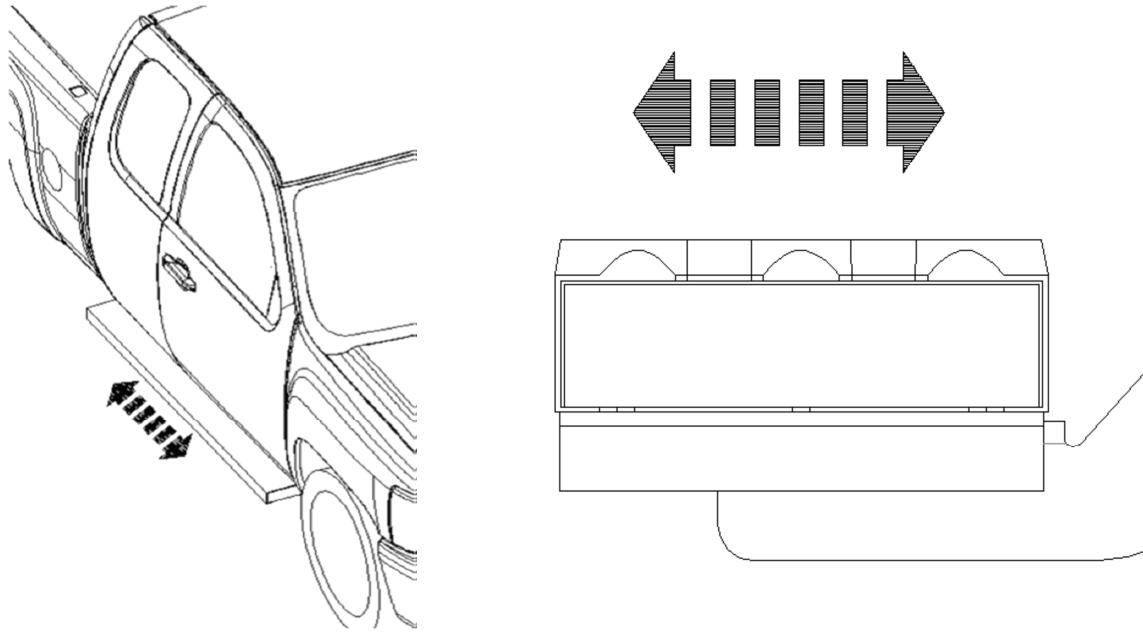

Once the board is in the desired location, tighten the bolts that attach the board to the brace using a 7/16" wrench and socket.

Make sure all bolts are tightened. Repeat steps for other side.