

FOR INSTALLATION ON DRIVER'S SIDE ONLY

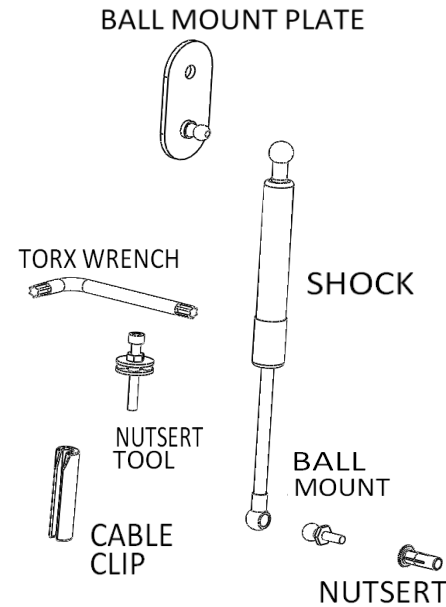

DZ 43301
 DODGE RAM [TAILGATE ASSIST](#)
 1500 2009- CURRENT
 2500/3500 2010 - CURRENT



PARTS LIST:

ITEM	QTY
THREAD LOCK TUBE	1
SHOCK	1
BALL MOUNT PLATE	1
NUTSERT TOOL	1
BALL MOUNT	1
NUTSERT	1
TORX WRENCH	1
CABLE CLIP	1

TOOLS REQUIRED:

- T-45 TORX
- M5 ALLEN WRENCH
- TAPE MEASURE
- 10MM WRENCH
- 13MM WRENCH/SOCKET

NOTE: THIS PRODUCT CAN ONLY BE INSTALLED ON THE DRIVER'S SIDE.

STEP 1)
 Adjust the nutsert tool so there is 3/4" from the washer to the head of the bolt.

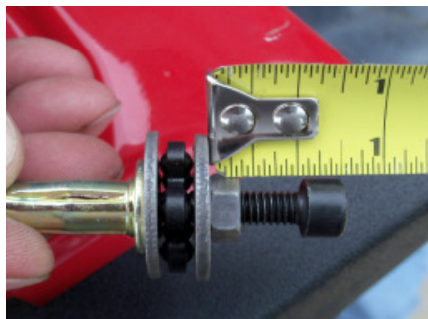

STEP 2)
 Using a M5 Allen wrench and a 10mm wrench, install the nutsert in the opening by the tailgate pivot point



The nutsert should be tightened 9 360 degree turns.

Mark one side of the nut and count the number of revolutions to insure the correct number of full turns. Overtightening the nutsert can strip the threads and cause the nutsert to be unusable. Remove the nutsert tool when installation is complete.



STEP 3)
 Apply thread lock to the threads of the ball mount. Install the ball mount into the nutsert using a 13mm wrench/socket. Torque to 8 ft-lbs with 13mm socket.



FOR INSTALLATION ON DRIVER'S SIDE ONLY

STEP 4)

Use a T45 torx socket or the wrench provided to remove the cable bolt. Remove the tailgate cable from the bolt.



STEP 5)

Install the bolt removed from the previous step through the hole in the ball mount plate back into the hole.



Tighten the bolt with the T45.

STEP 6)

Install the cable back onto the cable bolt, and the larger part of the shock on the ball mount.



STEP 7)

Install the narrow end of the shock on the ball mount previously installed.



STEP 8)

Remove the other end of the tailgate cable with the T45 torx and remove the motion limiter.

The flat retaining nut must be taken off to remove the limiter.



To remove the limiter, pry up one edge of the flat nut with a screwdriver. Hold this edge with a pair of pliers and spin the bolt out of it.

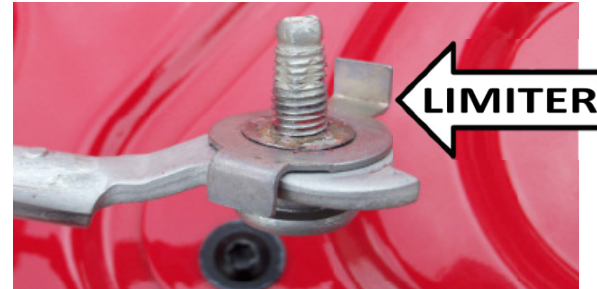

Once the limiter is removed, reinstall the cable mount to the tailgate.

STEP 9)

Measure down from the top of the cable 3 1/2". This is where the cable clip needs to start. Press the clip onto the cable with a pair of pliers.



Failure to remove the limiter and to install the cable clip will cause the cable to bind or become caught between the shock and truck bed. This may lead to vehicle damage, so these steps **MUST** be done.