

## FOR INSTALLATION ON DRIVER'S SIDE ONLY



DZ 43203  
TAILGATE ASSIST  
 FORD F-150 1997-2003  
 SUPERDUTY 1999-2011



### BALL MOUNT PLATE

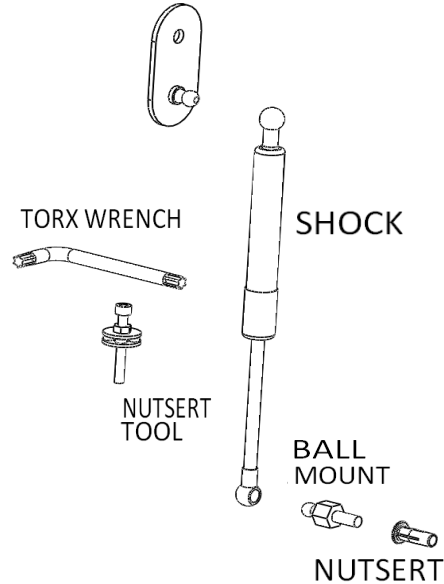

### PARTS LIST:

ITEM	QTY
THREAD LOCK TUBE	1
SHOCK	1
BALL MOUNT PLATE	1
NUTSERT TOOL	1
BALL MOUNT	1
NUTSERT	1
TORX WRENCH	1

### TOOLS REQUIRED:

- T-50 TORX
- M6 ALLEN WRENCH
- 16MM WRENCH
- 13MM WRENCH
- TAPE MEASURE
- 16MM DEEPWELL SOCKET
- SUPERDUTY ONLY
- 8MM WRENCH
- 11MM WRENCH

**NOTE:** THIS PRODUCT CAN ONLY BE INSTALLED ON THE DRIVER'S SIDE.

#### STEP 1)

Adjust the nutsert tool so there is 3/4" from the washer to the head of the bolt.

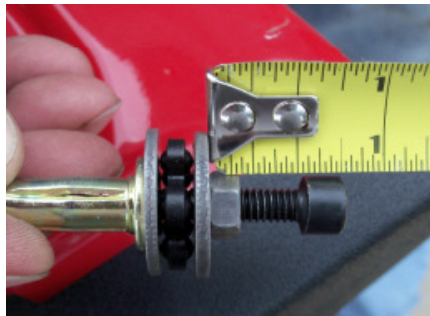

#### STEP 2)

Using a M6 Allen wrench and a 13mm wrench, install the nutsert in the opening by the tailgate pivot point.

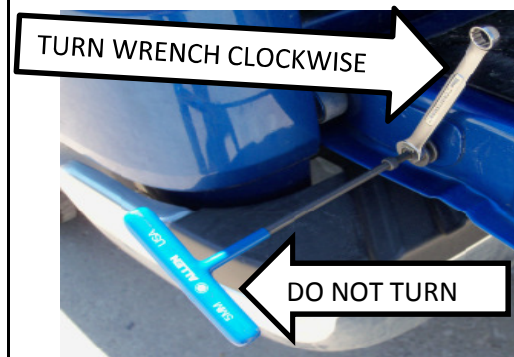

The nutsert should be tightened 9 360 degree turns.

Mark one side of the nut and count the number of revolutions to insure the correct number of full turns.

Overtightening the nutsert can strip the threads and cause the nutsert to be unusable. Remove the nutsert tool when installation is complete.

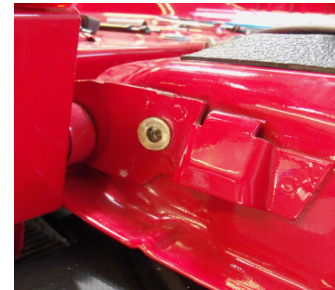

#### STEP 3)

Apply thread lock to the threads of the ball mount. Install the ball mount into the nutsert using a 16mm wrench/socket. Torque to 12 ft-lbs with 16mm deepwell socket

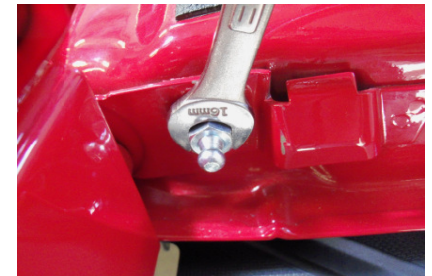

## FOR INSTALLATION ON DRIVER'S SIDE ONLY

### STEP 4)

Use a T50 torx socket or the wrench provided to remove the cable bolt. Remove the tailgate cable from the bolt.



### STEP 5)

Install the bolt removed from the previous step through the hole in the ball mount plate back into the hole.



Tighten the bolt with the T50.

### STEP 6)

Install the cable back onto the cable bolt, and the larger part of the shock on the ball mount.



### STEP 7)

Install the narrow end of the shock on the ball mount previously installed.

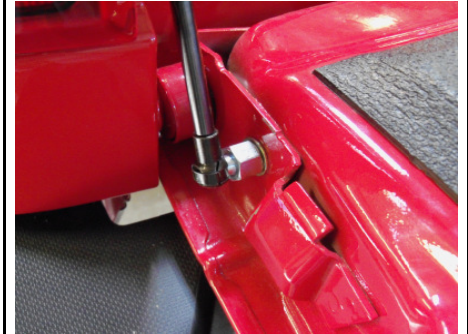

### STEP 8)

Using a 8mm wrench/socket, remove the 2 bolts holding the taillight in place.

There will still be 2 clips holding the taillight in place. Pull the taillight towards the rear of the vehicle to remove,

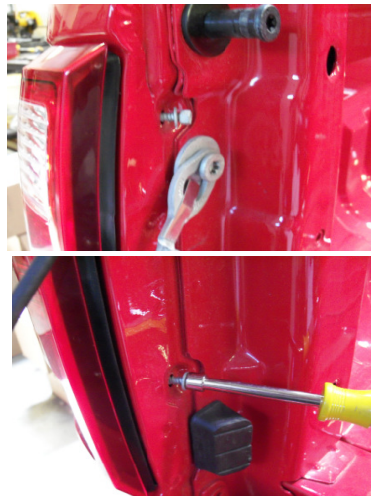

Inside the taillight opening , use an 11mm socket to remove the 2 nuts holding the rubber block in place.

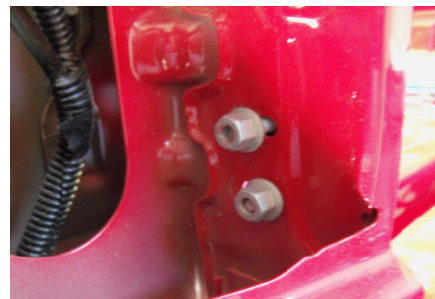

After removing the rubber block reinstall the taillight. If the rubber block is not removed, it will interfere with the shock.