



HOW TO: DRAIN PLUG INSTALLATION

TOOLS NEEDED : DRILL, 1" HOLE SAW, #2 PHILLIPS-HEAD SCREWDRIVER

STEP 1 : Drill 1" hole at center dimple of drawer depression

STEP 2 : Place the gasket around the bottom of the drain plug, then place the plug and gasket into the drawer depression. Screw plate and gasket into drawer.

NOTE : Drain plugs don't really work with long 6'6" drawers, unless you're Kareem Abdul-Jabbar, as you won't likely be able to reach them.

INCLUDED:

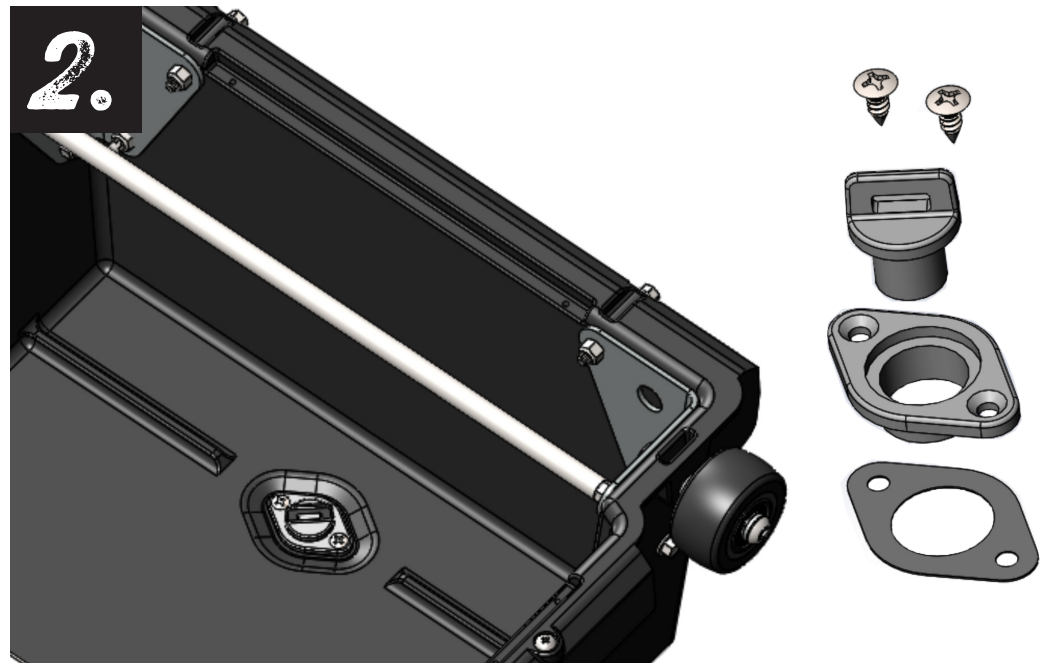

Check out the collection of truck bed accessories we offer.