

PART RC671



SNACK TRAY INSTALL INSTRUCTIONS

These can be installed on the driver's side or passenger's side of the Tool Box with no ladder.

- Press Snack Tray firmly into Tool Box
- the DECKED logo should read as shown.
- Insert four screws in screw locator holes.
- Using a #2 Phillips screwdriver (no power tools, please!)
turn until the screw head is flush with the tray bottom.
- Do not over-tighten.
- Enjoy your new accomplishment in organization!

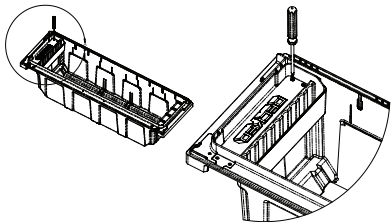

Learn more about bed accessories on our website.