



**INSTALLATION INSTRUCTIONS TRUCK MODEL: DF4
ALUMINUM FORD F150
5'6" [bed length](#) | 2015-current**

VERSION 1.5

TOOLS REQUIRED

Adjustable wrench (that opens to about 1"), **1/2" open end wrench**,
Phillips screwdriver, **3/8" socket**, **7/32" Allen wrench**, **T30 Torx Driver**,
Pliers (locking needle-nose works best)

NOTE: These might actually be useful

▼ **THIS IS A TEST - Are you reading these BEFORE you install DECKED?** ▼

- All the parts are labeled by step sequence
- The tailgate ammo cans have flat bottoms
- The cabside ammo cans are narrow at the bottom
- Get all these bolts good and tight, **BUT DON'T USE POWER TOOLS**
- You'll need a buddy for exactly two steps. *Don't go super-human on us and hurt yourself!*

Note: DECKED drawers are weatherproof, but you can still get some water in them as they don't seal like Tupperware. Anything that is airborne, like mist, dust, or really fine particle snow can get in the drawers - usually in small amounts. In most cases the drawers will stay dry, but please use caution (e.g. car washes). Also, the four ammo cans are not waterproof, but you can drill drain holes in the bottoms if you wish

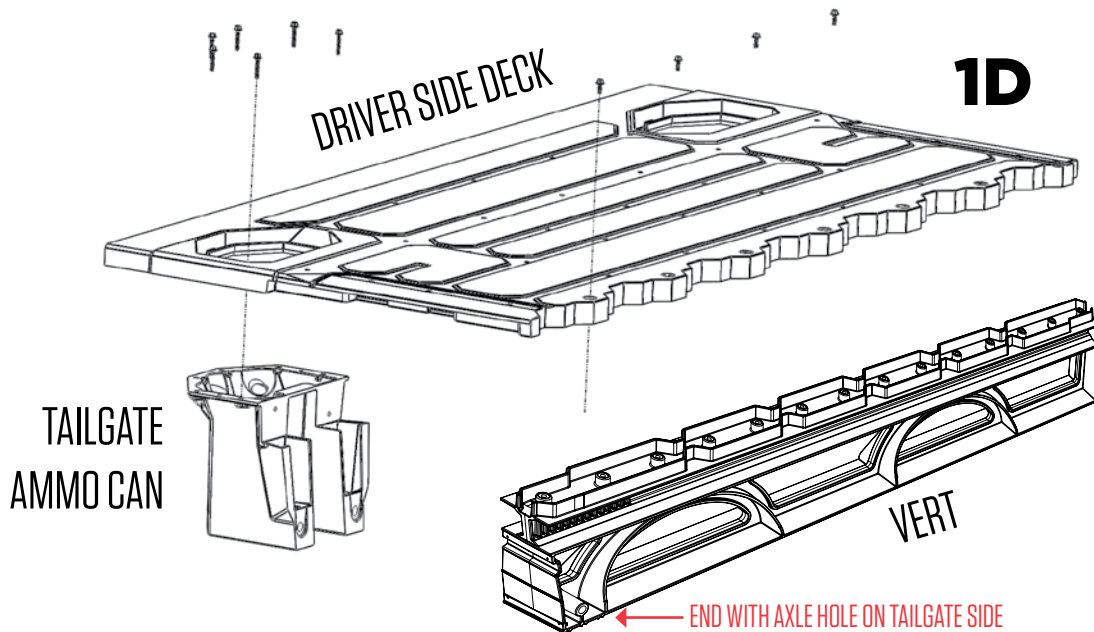

Step 1: Driver side deck assembly

- Loosely bolt C-channel to the ledges on the “inside” of the two ammo cans; bag 1A

Note: The small rectangular hole in the C-channel indicates the tailgate end

- Before bolting anything else together, line up the deck on top of the C-channel/ammo can assembly and the bosses on the vert, in their fully assembled position. This will make everything level and easier to bolt in place

Note: Tailgate end of vert has an axle hole at the bottom (see diagram below)

- Bolt deck to C-channel/ammo can assembly; bag 1B tailgate ammo can, bag 1C cabside ammo can.

Note: 1C only has 4 screws for 6 spots. Do not use the two spots along the cabside edge of ammo can

- Tighten bolts connecting ammo cans to C-channel
- Bolt the deck to the vert; bag 1D. **Do NOT use power tools** (See previous page for diagram)

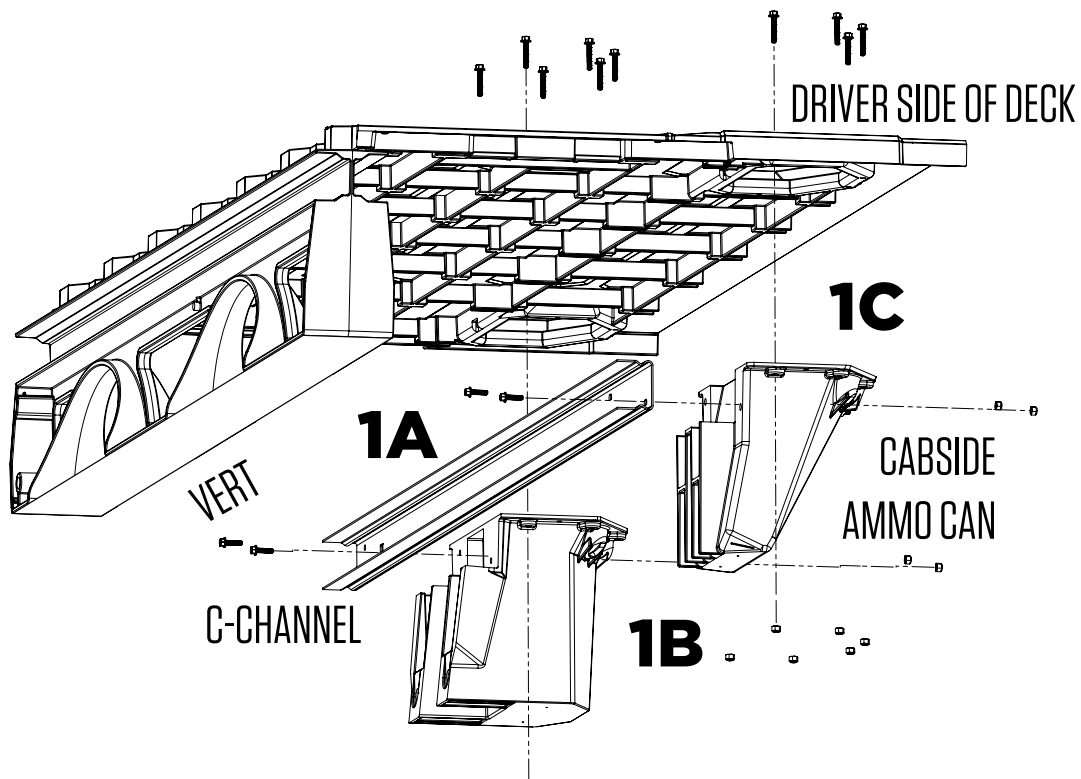

Step 2: Install axles

- Install the tailgate ammo can axles. One per ammo can, on the side that is nearest to the tailgate; bag 2A
 - Simply rotate the axle from its inbound side using a wrench on the “flat” end (the flat is 1/2”)
- Install vert axle; bag 2B

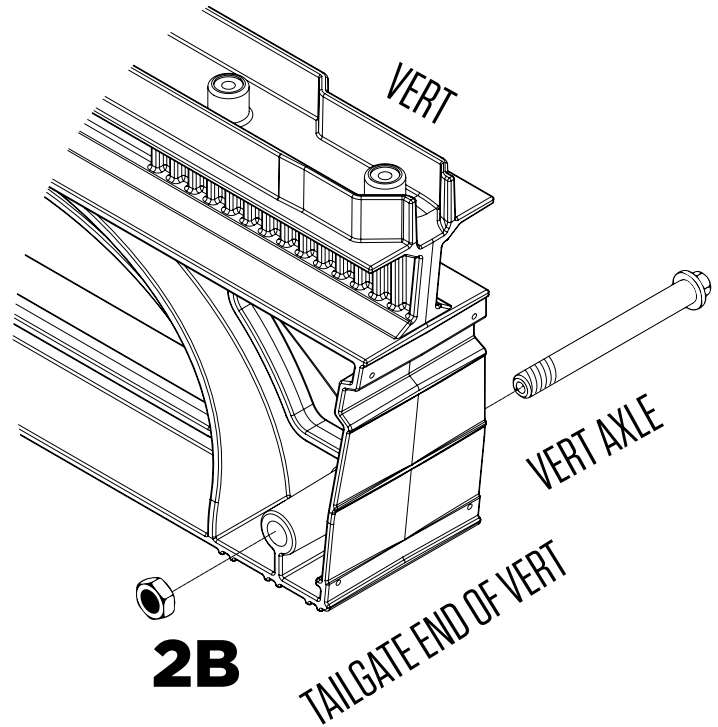
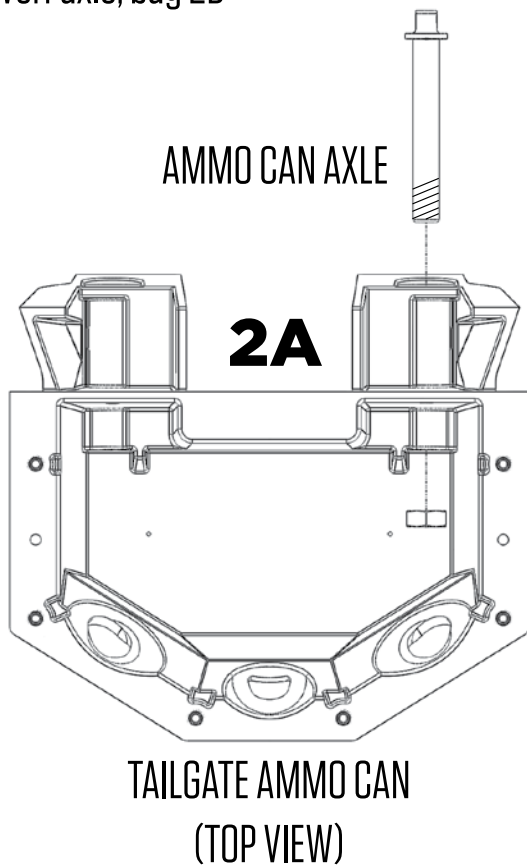

Step 3: Bracket installation

- The aluminum trucks require a shim between DECKED parts and the truck for the cabside ammo cans and the tailgate end of the vert. Please follow the added instructions showing where to apply the three solid shims; loose in the box
- Remove **cabside** factory tie-downs on both sides of truck bed (T30 Torx driver) and save the screws
- Aluminum and coated steel don't like each other. Install DECKED brackets on both sides of the truck with the soft rubber shim placed between the bracket and the sidewall using the screws from step above; bag 3A

EXISTING TIE DOWN
BRACKET

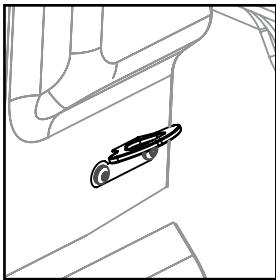

**NOTE: USE EXISTING
TIE DOWN SCREWS**

DECKED
"J" HOOK BRACKET

CABSIDE

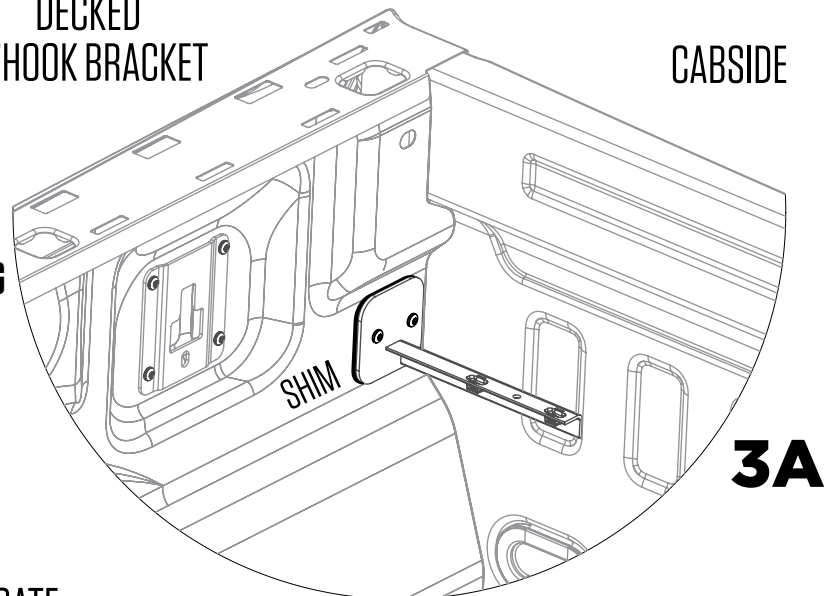

TAILGATE

Step 3.5: Install driver side deck half

- Get a buddy to help you place the driver side deck assembly into your truck bed and slide it up against the side of the bed
- Bolt deck, cabside ammo can and bracket together by aligning bracket with the cabside lip of the ammo can; bag 3B
- Insert the J-hook through the tailgate hole on the tailgate ammo can and loosely affix it to tie-down with J-hook (hook pointing upward); bag 3C

Important: **Leave all J-hook screws loose until entire deck is in place**

3B

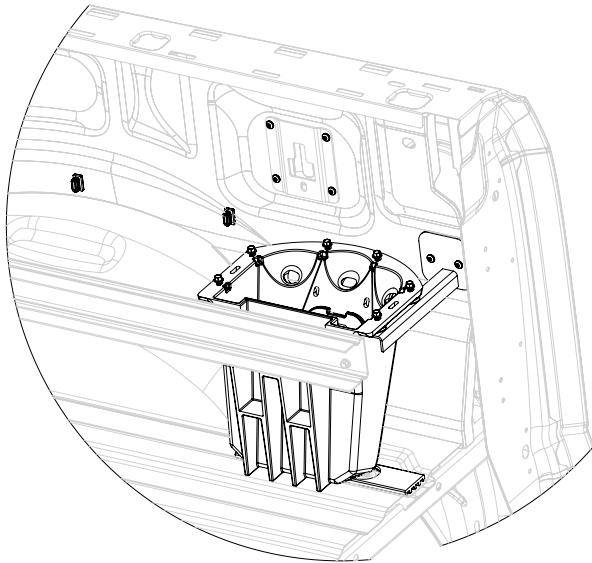

CABSIDE AMMO CAN

3C

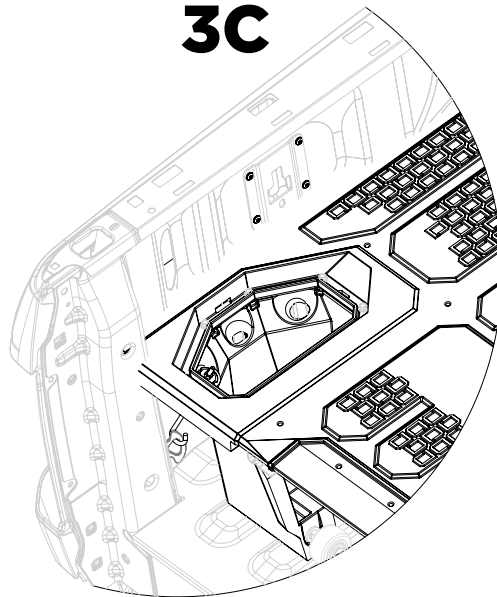

TAILGATE AMMO CAN



Step 4: Passenger side deck assembly

- Loosely bolt C-channel to the ledges on the “inside” of the two ammo cans; bag 4A

Note: The small rectangular hole in the C-channel is the tailgate end

- Bolt deck to C-channel/ammo can assembly;
bag 4B for tailgate ammo can, bag 4C for cabside ammo can
- Tighten bolts connecting ammo cans to C-channel

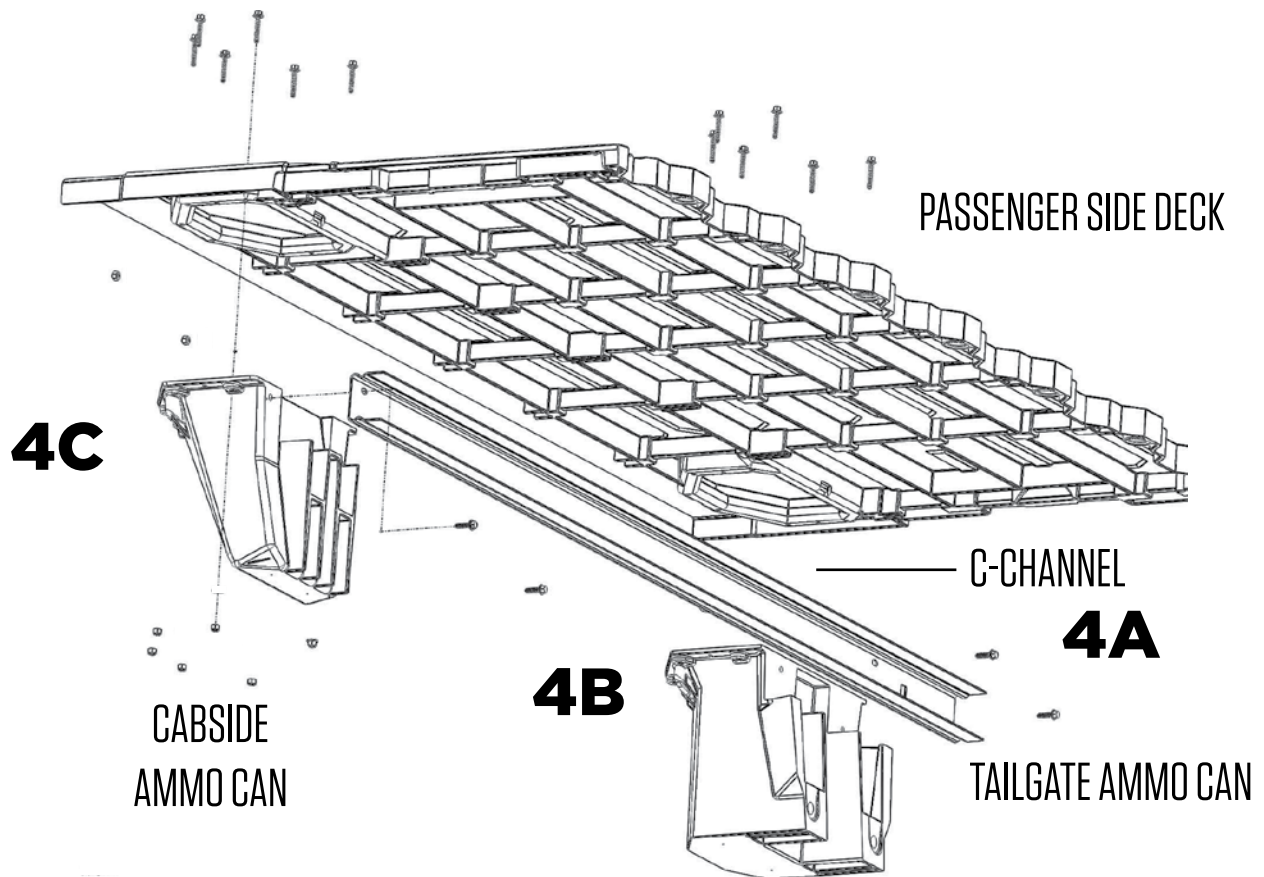

Step 5: Install passenger side deck half

- Wake up your buddy to have him (or her? nice) help you place the passenger side deck assembly into the truck so that it overlaps the driver side deck section

Note: Slide the passenger side deck section towards the side of the bed until the inside edge of the deck rests on the round bosses of the vert

- Repeat step 3.5; use hardware in bags 5A & 5B
- Bolt passenger side deck half to the vert; bag 5C (just like step 1D)

Note: Make sure all bolts connecting deck to vert are snug to ensure water-tight seal, **but no power tools**

- Alternately and gradually tighten all J-hooks to ensure deck is centered and secure
 - If you tighten one side all the way in one step, guess what will happen?
- Install window covers in cabside ammo cans

NOTE: GM units might require a shim; bag 5D

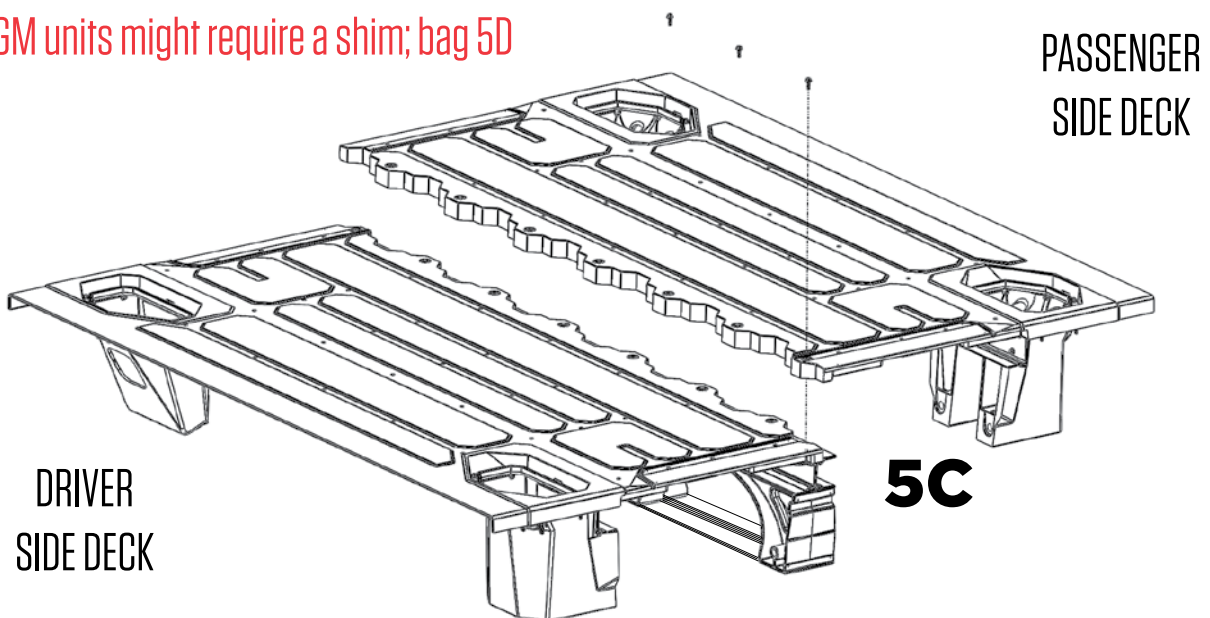

Step 6: Install drawer wheels

- There is a left and a right corner bracket for each drawer – bolt brackets in place (use the 2" bolts for the upper back wall bracket hole); bags 6A and 6B
- Use tube brace with two bolts to connect the two corner brackets; bag 6C.
- Insert axle through wheel and affix to drawer bracket; bag 6D. Do this for each wheel (4 times)
- The L-braces (loose in the system box) have six holes. Align brace with underside of drawerside lip. Repeat for all drawer sides; bag 6E (4 times)

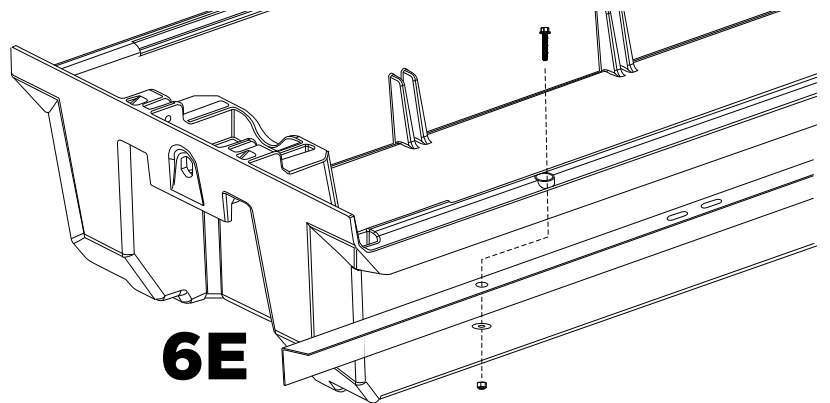
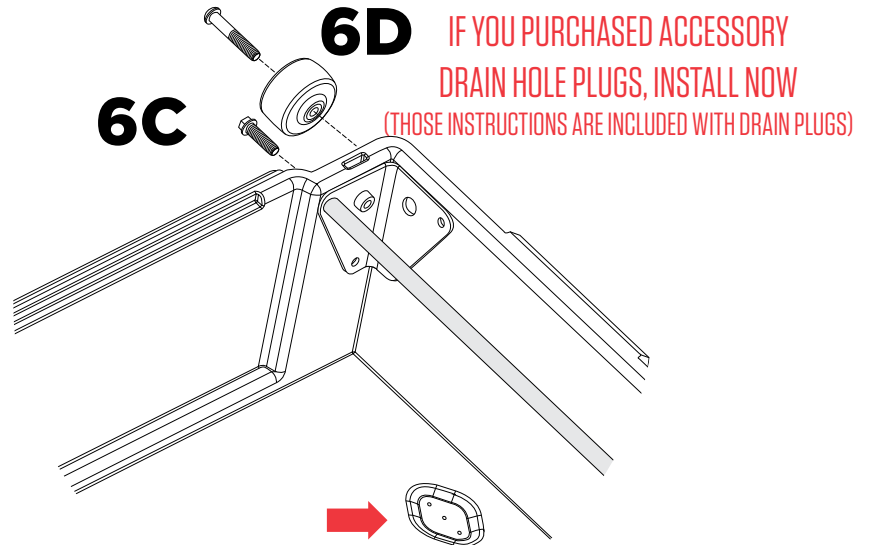
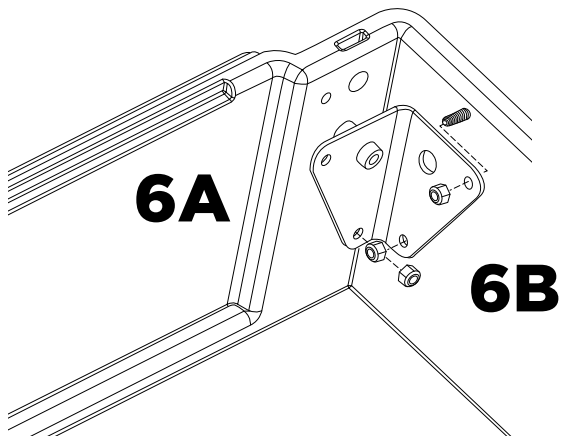

Step 7: Install drawer handles

- From the **outside** of the drawer, place the torsion springs in their spot, red=right; bag 7A

Note: The horizontal arms on the torsion springs need to point inward, NOT outward

- For each side, from the **inside** of the drawer, install clevis pin (head on the outside) through drawer hole, torsion spring, and through the second drawer hole to hold the torsion springs in place; bag 7B
- With DECKED logo facing outward, insert the handle behind the spring arms and rotate the top of the handle toward the clevis pins. When the latch handle hole is lined up with the clevis pin hole, push the pin through the handle hole and finish through the drawer hole. Repeat on the other side of the handle
- Install hairpin through the clevis pin, needle nose pliers may help; bag 7B
- Repeat process for the other drawer; bags 7C and 7D

**7B
7D**

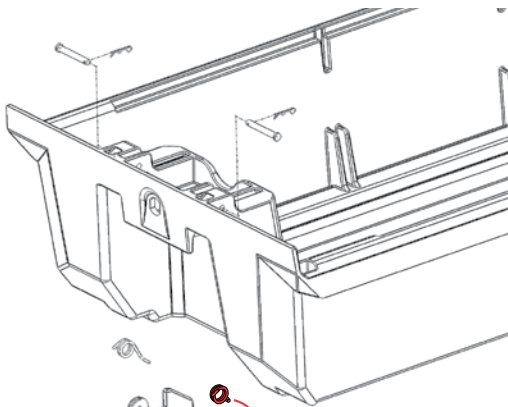

TORSION
SPRING ARMS
POINT IN, NOT OUT

**7A
7C**

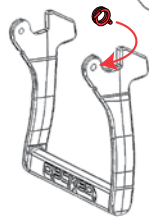

INSTALL DRAWER PLUGS OR LOCKS*, BAG 7E

*Purchased separately

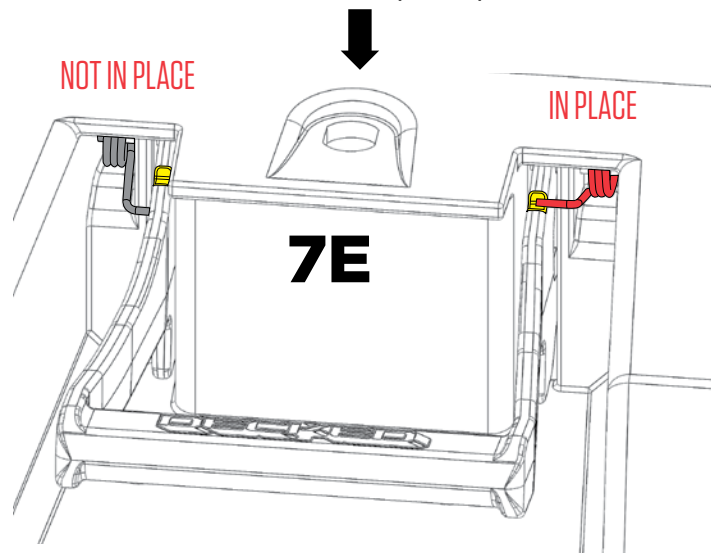

Step 8: Install drawers

- Install drawer braces (packed separately); bag 8A
- Slide the rear drawer wheels into their two channels (C-channel and vert)
- Install remaining tailgate side wheels onto their axles; bag 8B

Note: Placing a spacer (2" x 2" or ammo can lid works well) under the drawer to raise it into position makes this easier

- Place weather stripping on top of the tailgate side drawer edge **with the wiper facing cab**; bag 8C

Note: Facing the weather stripping the wrong way creates a water funnel into the drawer: **BAD**

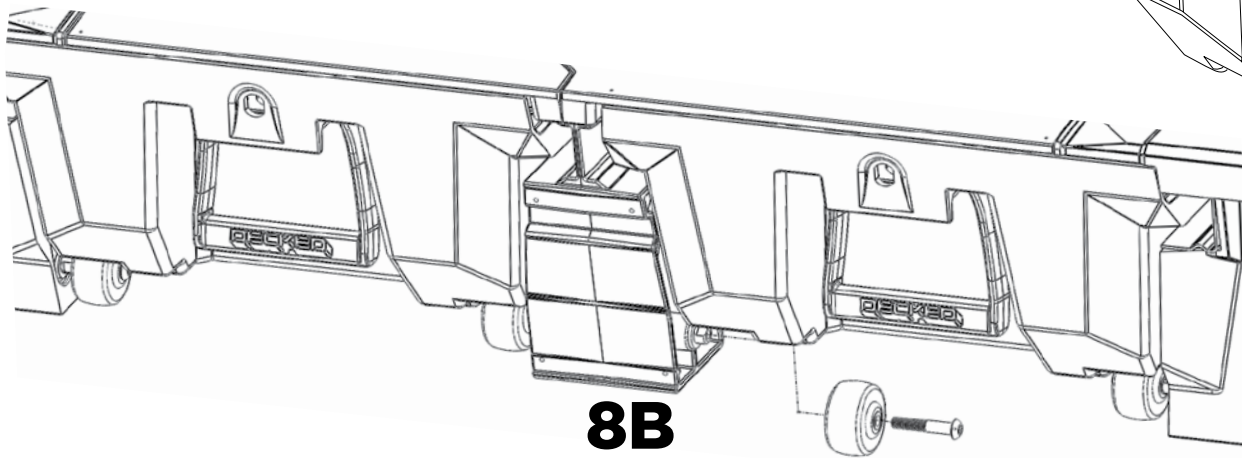
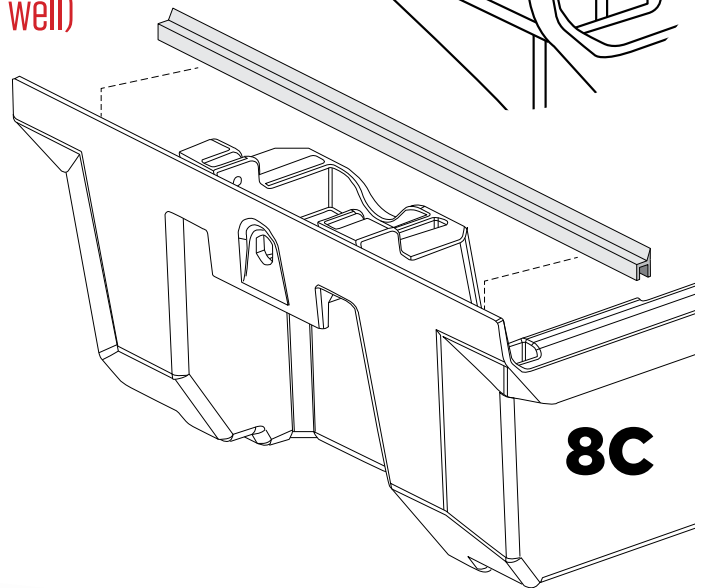
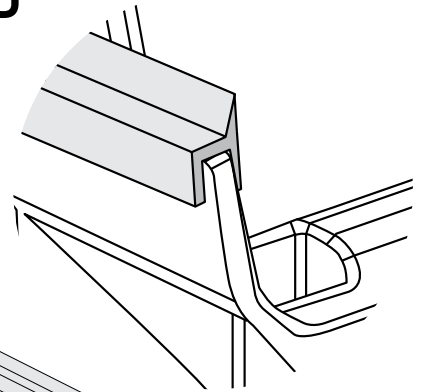

Step 9: The fun stuff

Caution: These are small gauge screws – light, hand-tightening is all that is required

- Center and screw on the edge guard/ruler; bag 9A
- Screw on the bottle opener; bag 9A
- Using your favorite beverage, test the bottle opener, sit on your tailgate, and think about how jealous your buddies are going to be

