

15410

FORD F-250 / F-350 SUPER DUTY

GROSS LOAD CAPACITY WHEN USED AS A WEIGHT CARRYING HITCH: 17,000 LBS. TRAILER WEIGHT & 2,550 LBS. TONGUE WEIGHT.
 GROSS LOAD CAPACITY WHEN USED AS A WEIGHT DISTRIBUTION HITCH: 17,000 LBS. TRAILER WEIGHT & 1,700 LBS. TONGUE WEIGHT
 DO NOT EXCEED VEHICLE MANUFACTURER'S RECOMMENDED TOWING CAPACITY.

Parts List				
ITEM	QTY	PART NUMBER	DESCRIPTION	
1	8	9/16-12 x 1 3/4	HEX BOLT	
2	8	CM-SP8	.188 x 1.25 x 1.50" ROUND HOLE SPACER	
3	8	9/16"	WASHER	
4	8	9/16	LOCK WASHER	
5	8	9/16 - 12	HEX NUT	

TOOLS REQUIRED

13/16" WRENCH
 7/8" SOCKET
 12" EXTENSION
 SOCKET WRENCH
 TORQUE WRENCH

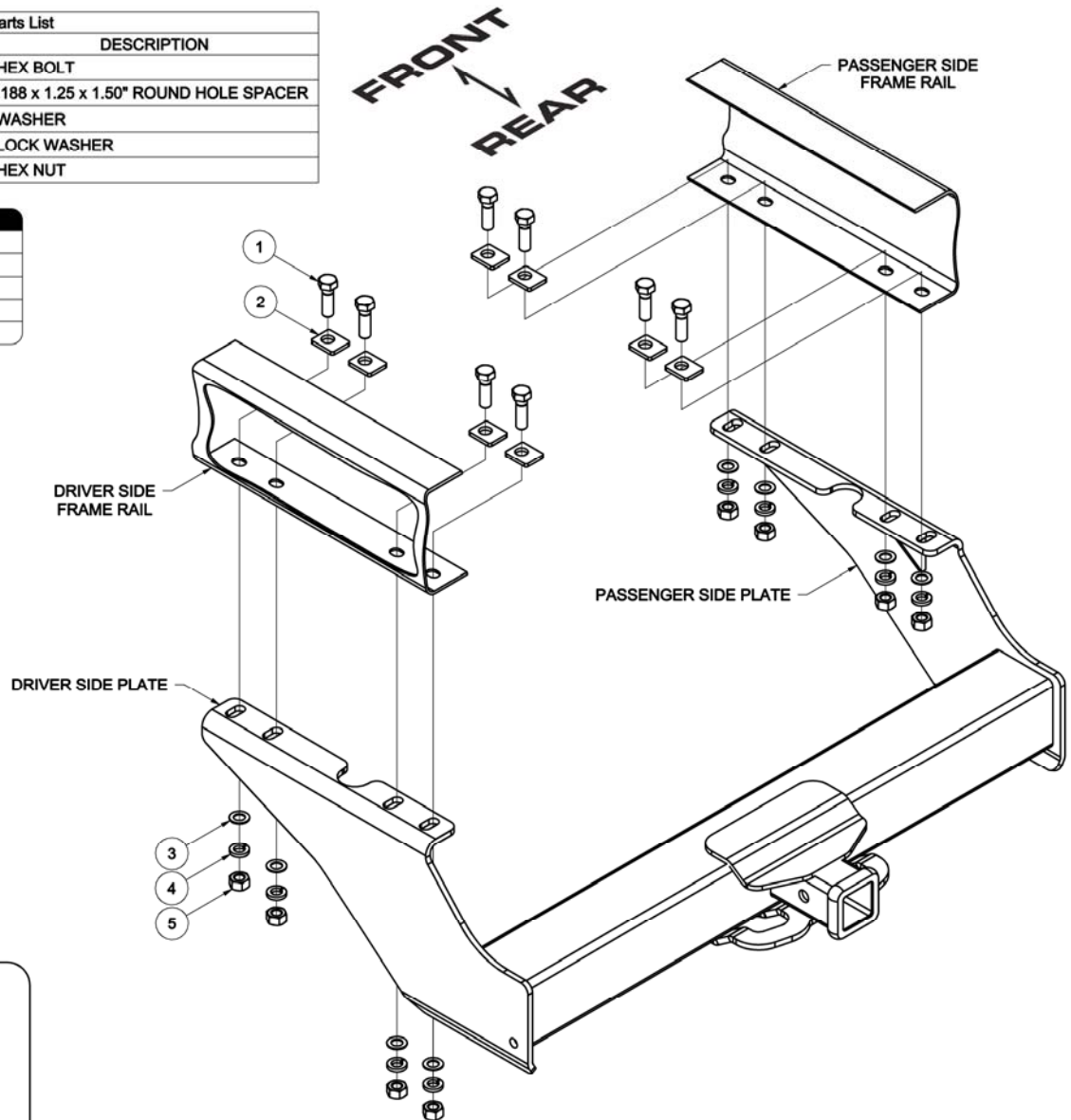

HITCH WEIGHT: 68 LBS.

INSTALL TIME

PROFESSIONAL: 30 MINUTES

NOVICE (DIY): 60 MINUTES

INSTALL NOTES:

- NO DRILLING REQUIRED

INSTALLATION STEPS

Note: To ease installation, removal of the spare tire is recommended.

1. Position the hitch against the frame, aligning the holes in the hitch with the holes in the frame. Take note of the fastener locations and lower the hitch.
2. Place a carriage bolt and spacer into each bolt location from inside the frame rail as shown.
3. Raise the hitch into position and secure it to the frame rails using flat washers, lock washers and hex nuts as shown.
4. Torque all hardware to 150 lb-ft.

PERIODICALLY CHECK THIS RECEIVER HITCH TO ENSURE THAT ALL FASTENERS ARE TIGHT AND THAT ALL STRUCTURAL COMPONENTS ARE SOUND.

Curt Manufacturing LLC., warrants this product to be free of defects in material and/or workmanship at the time of retail purchase by the original purchaser. If the product is found to be defective, Curt Manufacturing LLC., may repair or replace the product, at their option, when the product is returned, prepaid, with proof of purchase. Alteration to, misuse of, or improper installation of this product voids the warranty. Curt Manufacturing LLC.'s liability is limited to repair or replacement of products found to be defective, and specifically excludes liability for incidental or consequential loss or damage.