

11658

## 80-84 VOLKSWAGEN JETTA

**GROSS LOAD CAPACITY WHEN USED AS A WEIGHT CARRYING HITCH: 1,500 LBS. TRAILER WEIGHT & 150 LBS. TONGUE WEIGHT.**

\*\*\*DO NOT EXCEED VEHICLE MANUFACTURER'S RECOMMENDED TOWING CAPACITY.\*\*\*

**WARNING: ALL NON-TRAILER LOADS APPLIED TO THIS PRODUCT MUST BE SUPPORTED BY 18050 STABILIZING STRAPS.**

\*\* FAILURE TO PROPERLY SUPPORT NON-TRAILER LOADS WILL VOID PRODUCT WARRANTY\*\*

Parts List			
ITEM	QTY	PART NUMBER	DESCRIPTION
1	2	3/8-16 X 1 1/2	HEX BOLT
2	2	3/8"	WASHER
3	6	HFN3816	HEX FLANGE NUT
4	4	3/8 - 16 x 1 1/4	HEX BOLT
5	4	3/8"	FENDER WASHER

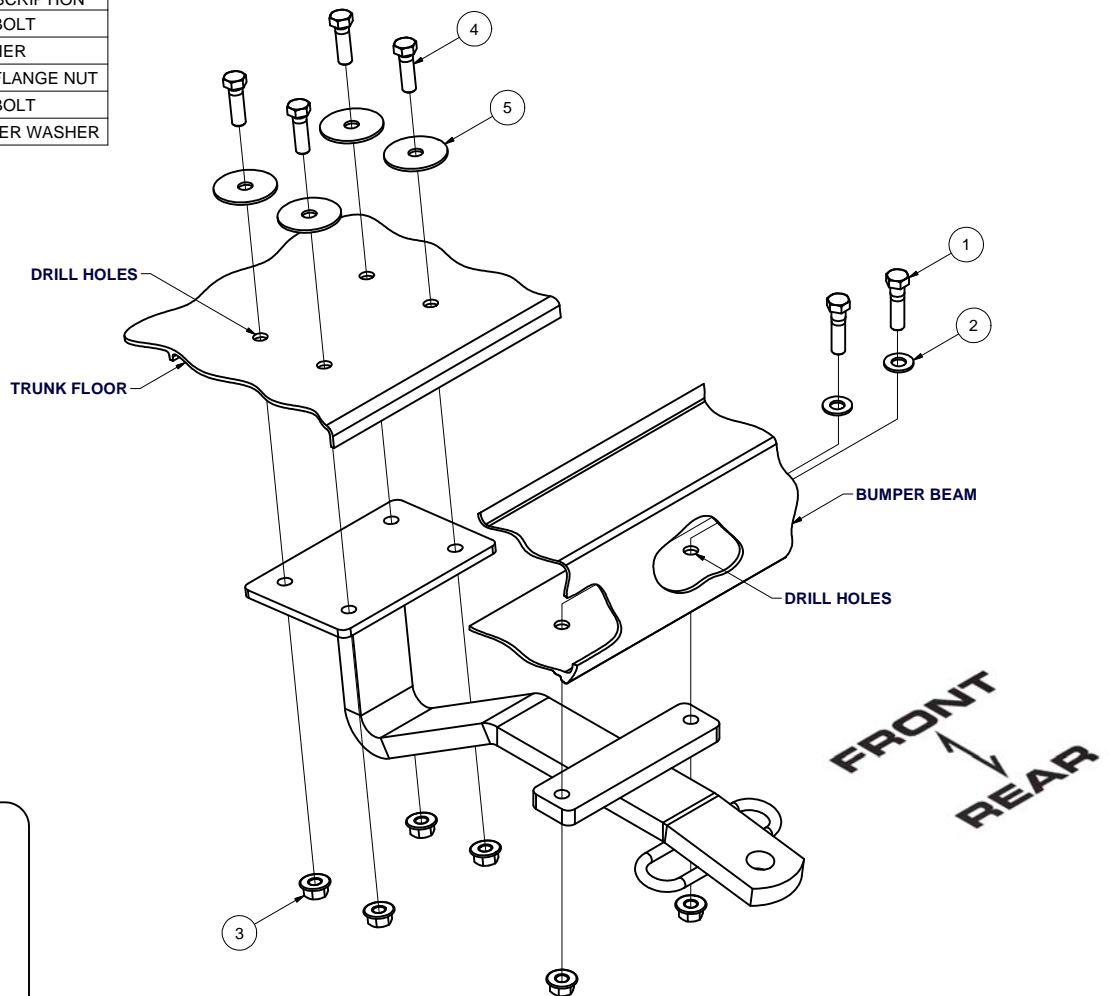

**HITCH WEIGHT:** 11 LBS.

**INSTALL TIME**

PROFESSIONAL: 45 MINUTES

NOVICE (DIY): 90 MINUTES

**INSTALL NOTES:**

- CLEAR TRUNK
- DRILLING REQUIRED
- SILICONE SEAL HARDWARE

## INSTALLATION STEPS

1. Clear trunk of contents.
2. Position the hitch against the underside of the floor and the rear bumper, centered and square with the vehicle. Use the hitch as a template to mark (4) places in the trunk floor and (2) places in the bumper beam for fasteners as shown. Drill marked holes for 3/8" hardware.
3. Bolt the hitch to the floor and the rear bumper as shown. Use fender washers inside the trunk, opposite the hitch. Bolt the hitch to the bumper as shown.
4. Torque all 3/8" fasteners to 30 lb-ft.
5. Silicone seal hardware installed through trunk floor.
6. Reinstall floor covering removed in Step 1.

PERIODICALLY CHECK THIS RECEIVER HITCH TO ENSURE THAT ALL FASTENERS ARE TIGHT AND THAT ALL STRUCTURAL COMPONENTS ARE SOUND.

Curt Manufacturing Inc., warrants this product to be free of defects in material and/or workmanship at the time of retail purchase by the original purchaser. If the product is found to be defective, Curt Manufacturing Inc., may repair or replace the product, at their option, when the product is returned, prepaid, with proof of purchase. Alteration to, misuse of, or improper installation of this product voids the warranty. Curt Manufacturing Inc.'s liability is limited to repair or replacement of products found to be defective, and specifically excludes liability for incidental or consequential loss or damage.

Looking for dependable trailer hitches and towing? Rely on CURT for quality and long-lasting products.