

11585

84-86 HONDA CIVIC SEDAN

GROSS LOAD CAPACITY WHEN USED AS A WEIGHT CARRYING HITCH: 1,000 LBS. TRAILER WEIGHT & 100 LBS. TONGUE WEIGHT.

DO NOT EXCEED VEHICLE MANUFACTURER'S RECOMMENDED TOWING CAPACITY.

WARNING: ALL NON-TRAILER LOADS APPLIED TO THIS PRODUCT MUST BE SUPPORTED BY AUXILIARY STABILIZING STRAPS.

** FAILURE TO PROPERLY SUPPORT NON-TRAILER LOADS WILL VOID PRODUCT WARRANTY**

Parts List			
ITEM	QTY	PART NUMBER	DESCRIPTION
1	6	3/8"	LOCK WASHER
2	6	3/8 - 16	HEX NUT
3	2	3_8 - 16 x 3 1_2 HEX	HEX BOLT
4	4	3/8"	WASHER
5	4	3/8 - 16 x 1 1/4	HEX BOLT
6	4	3/8"	FENDER WASHER

FRONT
↑
REAR

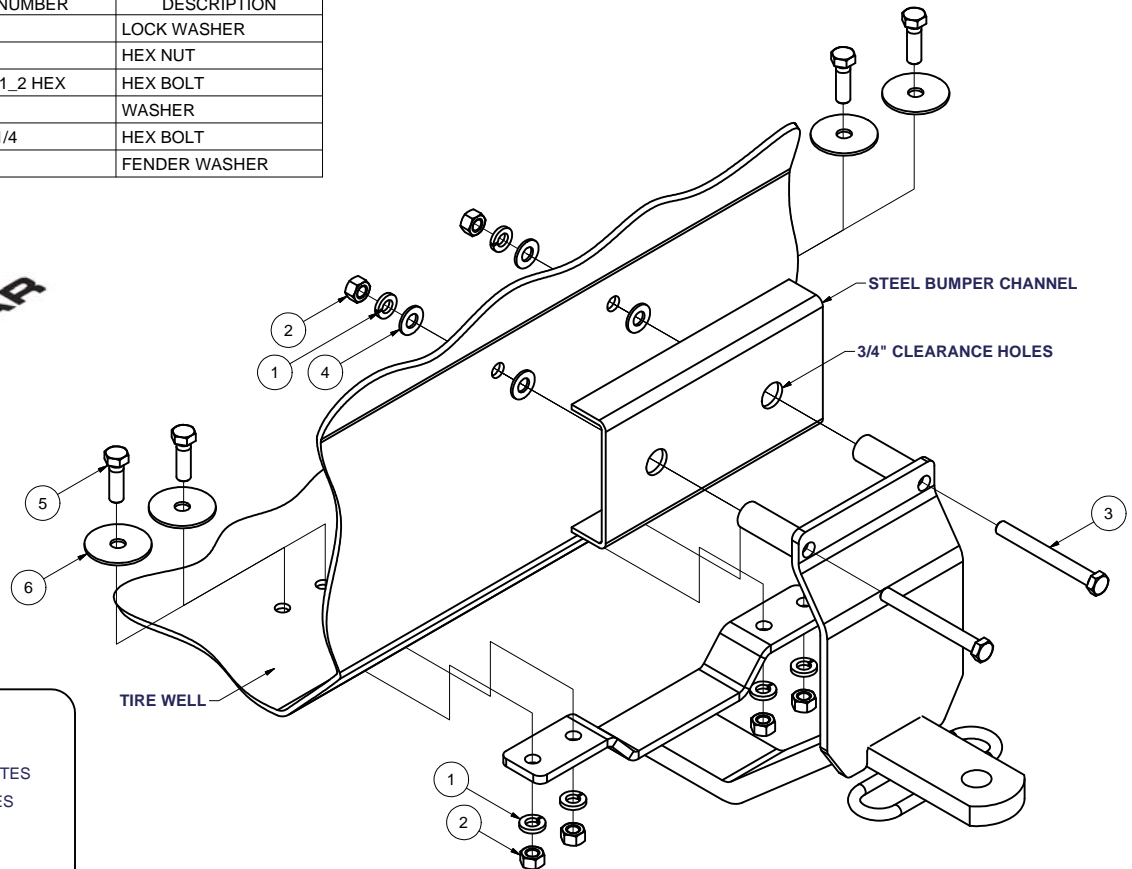

HITCH WEIGHT: 10 LBS.

INSTALL TIME

PROFESSIONAL: 30 MINUTES

NOVICE (DIY): 60 MINUTES

INSTALL NOTES:

- DRILLING REQUIRED
- REMOVE LICENSE PLATE

INSTALLATION STEPS

1. Remove the rear license plate. Clear trunk area where hitch will bolt up.
2. Hold the hitch centered and level against the car so that the hitch spacer tubes rest against the car's steel bumper channel. Mark the bumper channel for 3/4" diameter clearance holes for spacer tubes. The spacer tubes may fit higher or lower in bumper channel than shown. Trim plastic licence frame if necessary for hitch bracket to fit directly on steel bumper.
3. Position the hitch on the car as shown, with spacer tubes passing through the bumper channel. Drill car's rear panel for 3/8" screws by drilling directly through spacer tubes. Use fasteners provided and bolt the hitch to the rear panel making sure the flat washers are used both inside and outside to sandwich the rear panel.
4. Drill the trunk floor four (4) places for 3/8" screws by drilling through the hitch bracket. Fasten the hitch to the trunk floor as shown. Make sure the fender washers are installed inside the trunk.
5. Replace the material in the trunk. Replace license plate, modifying shape slightly if necessary.
6. Torque all 3/8" fasteners to 30 lb-ft.

PERIODICALLY CHECK THIS RECEIVER HITCH TO ENSURE THAT ALL FASTENERS ARE TIGHT AND THAT ALL STRUCTURAL COMPONENTS ARE SOUND.

Curt Manufacturing Inc., warrants this product to be free of defects in material and/or workmanship at the time of retail purchase by the original purchaser. If the product is found to be defective, Curt Manufacturing Inc., may repair or replace the product, at their option, when the product is returned, prepaid, with proof of purchase. Alteration to, misuse of, or improper installation of this product voids the warranty. Curt Manufacturing Inc.'s liability is limited to repair or replacement of products found to be defective, and specifically excludes liability for incidental or consequential loss or damage.

Looking for dependable trailer hitches and towing? Rely on CURT for quality and long-lasting products.