

11541

## 1990 - 1992 NISSAN STANZA SEDAN

**GROSS LOAD CAPACITY WHEN USED AS A WEIGHT CARRYING HITCH: 2,000 LBS. TRAILER WEIGHT & 200 LBS. TONGUE WEIGHT.**

\*\*\*DO NOT EXCEED VEHICLE MANUFACTURER'S RECOMMENDED TOWING CAPACITY.\*\*\*

**WARNING: ALL NON-TRAILER LOADS APPLIED TO THIS PRODUCT MUST BE SUPPORTED BY AUXILIARY STABILIZING STRAPS.**

\*\* FAILURE TO PROPERLY SUPPORT NON-TRAILER LOADS WILL VOID PRODUCT WARRANTY\*\*

Parts List			
ITEM	QTY	PART NUMBER	DESCRIPTION
1	5	3/8-16 X 1 1/2	HEX BOLT
2	6	3/8"	LOCK WASHER
3	1	3/8 - 16 x 2	HEX BOLT
4	4	3/8"	FENDER WASHER
5	4	3/8 - 16	HEX NUT
6	2	3_8-16 TAB NUT	HANDLE NUT

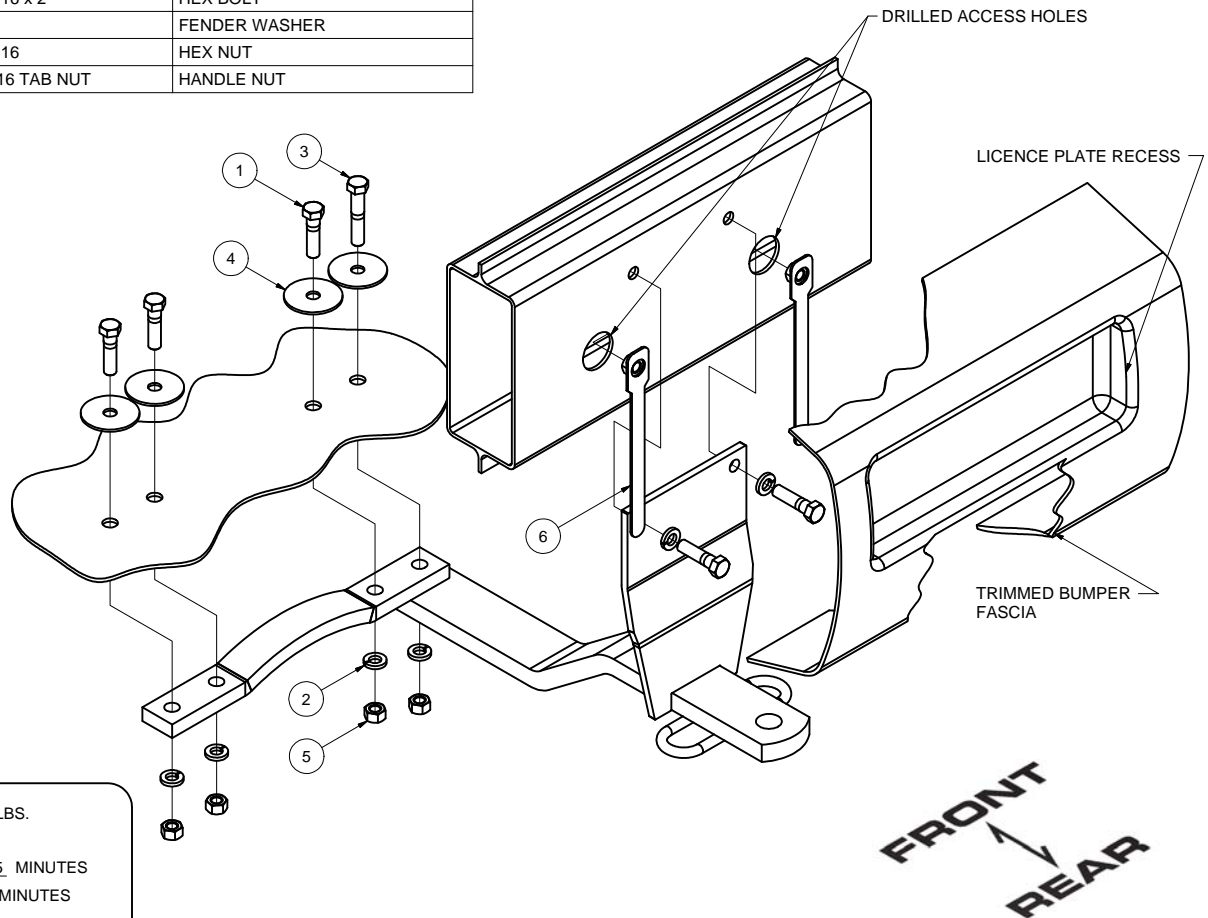

HITCH WEIGHT: 11 LBS.

INSTALL TIME

PROFESSIONAL: 45 MINUTES

NOVICE (DIY): 90 MINUTES

INSTALL NOTES

- DRILLING REQUIRED
- TRIM FASCIA

## INSTALLATION STEPS

1. Remove the rear license plate. The hitch bumper plate will bolt to the car's rear bumper beam (steel) in licence plate area. The hitch chassis bracket will bolt to the car's floor pan. Be certain to clear the interior before drilling.
2. Trim the bumper fascia (plastic material) at the licence plate recess as shown.
3. Locate the car's centerline at the rear bumper and support the hitch on the car, centered and square. Using the hitch as a template; mark, centerpunch, and drill the car's bumper beam (steel) and tire well for 3/8" diameter mounting screws.
4. Mark two 1" diameter access holes in the bumper beam to insert 3/8" handle nuts inside the bumper beam. The location for these access holes is shown in diagram. Access holes must be just outside (left and right) of the hitch bumper plate.
5. Torque all 3/8" hardware to 35 ft-lbs.

PERIODICALLY CHECK THIS RECEIVER HITCH TO ENSURE THAT ALL FASTENERS ARE TIGHT AND THAT ALL STRUCTURAL COMPONENTS ARE SOUND.

Curt Manufacturing Inc., warrants this product to be free of defects in material and/or workmanship at the time of retail purchase by the original purchaser. If the product is found to be defective, Curt Manufacturing Inc., may repair or replace the product, at their option, when the product is returned, prepaid, with proof of purchase. Alteration to, misuse of, or improper installation of this product voids the warranty. Curt Manufacturing Inc.'s liability is limited to repair or replacement of products found to be defective, and specifically excludes liability for incidental or consequential loss or damage.

Looking for dependable trailer hitches and towing? Rely on CURT for quality and long-lasting products.