

GROSS LOAD CAPACITY WHEN USED AS A WEIGHT CARRYING HITCH: 1,500 LBS. TRAILER WEIGHT & 150 LBS. TONGUE WEIGHT.

DO NOT EXCEED VEHICLE MANUFACTURER'S RECOMMENDED TOWING CAPACITY.

WARNING: ALL NON-TRAILER LOADS APPLIED TO THIS PRODUCT MUST BE SUPPORTED BY 18050 STABILIZING STRAPS.

** FAILURE TO PROPERLY SUPPORT NON-TRAILER LOADS WILL VOID PRODUCT WARRANTY**

Parts List			
ITEM	QTY	PART NUMBER	DESCRIPTION
1	8	3/8 - 16 x 1 1/4	HEX BOLT
2	8	3/8"	LOCK WASHER
3	8	3/8 - 16	HEX NUT
4	4	3/8"	FENDER WASHER
5	2	3/8"	WASHER
6	1	CM-11514-BP	.250" BACKING PLATE

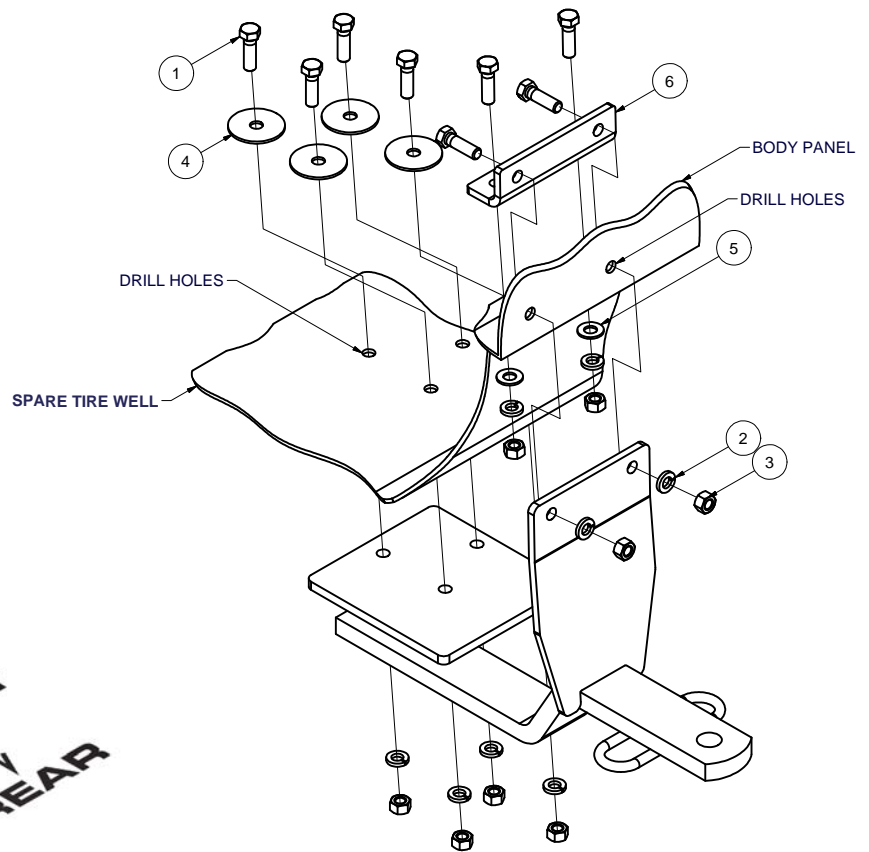

HITCH WEIGHT: 12 LBS.

INSTALL TIME

PROFESSIONAL: 45 MINUTES

NOVICE (DIY): 90 MINUTES

INSTALL NOTES:

- DRILLING REQUIRED
- TEMPORARILY REMOVE INTERIOR PANELS
- TEMPORARILY REMOVE SPARE TIRE
- SILICONE SEAL HARDWARE

INSTALLATION STEPS

1. Temporarily remove the interior trim panels at the rear panel and adjacent to the floor area. Light units are removed on the driver and passenger side with (2) finger nuts.
2. Locate and mark the centerline of the vehicle inside the trunk area, so supplied CM-11514-BP backing plate can be located as shown inside the trunk. Position the CM-11514-BP backing plate against the floor and the rear panel with the holes equal distance left and right of the vehicle centerline. Mark, centerpunch and drill the vehicle spare tire well and body panel for 3/8" diameter bolts.
3. Fasten the CM-11514-BP to the trunk floor as shown, placing bolts through backing plate and body panel to fasten to the hitch. Place the hitch from under the vehicle, over the bolts. Fasten hitch to vehicle using fasteners as shown.
4. Hitch floor bracket should lie in recess of spare tire well. With the spare tire removed, use hitch as a template and drill spare tire well 3/8" diameter fasteners. Fasten hitch to vehicle using fasteners as shown. Make certain to use fender washers inside the tire well; opposite the hitch.
5. Torque all 3/8" fasteners to 30 lb-ft.
6. Use silicone sealant to seal hardware installed through spare tire well.
7. Reinstall spare tires, interior trim panels and light units previously removed.

PERIODICALLY CHECK THIS RECEIVER HITCH TO ENSURE THAT ALL FASTENERS ARE TIGHT AND THAT ALL STRUCTURAL COMPONENTS ARE SOUND.

Curt Manufacturing Inc., warrants this product to be free of defects in material and/or workmanship at the time of retail purchase by the original purchaser. If the product is found to be defective, Curt Manufacturing Inc., may repair or replace the product, at their option, when the product is returned, prepaid, with proof of purchase. Alteration to, misuse of, or improper installation of this product voids the warranty. Curt Manufacturing Inc.'s liability is limited to repair or replacement of products found to be defective, and specifically excludes liability for incidental or consequential loss or damage.