



Safety glasses should be worn at all times while installing this product.

YEARS: 2013

MAKE: NISSAN

MODEL: SENTRA

STYLE: SEDAN

WARNING: NEVER EXCEED YOUR VEHICLE MANUFACTURER'S RECOMMENDED TOWING CAPACITY

WEIGHT CARRYING:
 TRAILER WEIGHT: 2,000 LBS.
 TONGUE WEIGHT: 200 LBS.

INSTALLATION TIME: 30/60 MIN.

THE INSTALL TIME LISTED IS FOR PROFESSIONAL INSTALLERS. IF YOU ARE HESITANT TO UNDERTAKE THIS TASK ON YOUR OWN, CONTACT AN AUTHORIZED CURT INSTALLER FOR ADDITIONAL ASSISTANCE.

INSTALLATION REQUIRES:

 SAFETY GLASSES	 SCREW DRIVER	 RATCHET
 6" SOCKET EXTENSION	 9/16" SOCKET	 BOXED END WRENCH 9/16", 3/4"
 TORQUE WRENCH		

INSTALLATION TIPS:

- BEFORE YOU BEGIN INSTALLATION, READ ALL INSTRUCTIONS THOROUGHLY.
- TO EASE INSTALLATION, 2 PEOPLE MAY BE REQUIRED.
- USING PROPER TOOLS WILL GREATLY IMPROVE THE QUALITY OF THE INSTALL AND REDUCE THE TIME REQUIRED.

LEVEL OF DIFFICULTY: EASY

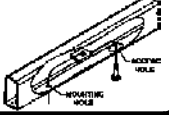
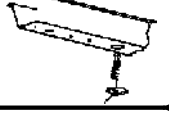
EASY	MODERATE	CHALLENGING
	ENLARGE ACCESS HOLES	
	FISHWIRING REQUIRED	
	REVERSE FISHWIRING REQUIRED	

VEHICLE PHOTO:



REPRESENTATIVE PHOTO

HITCH ILLUSTRATION:

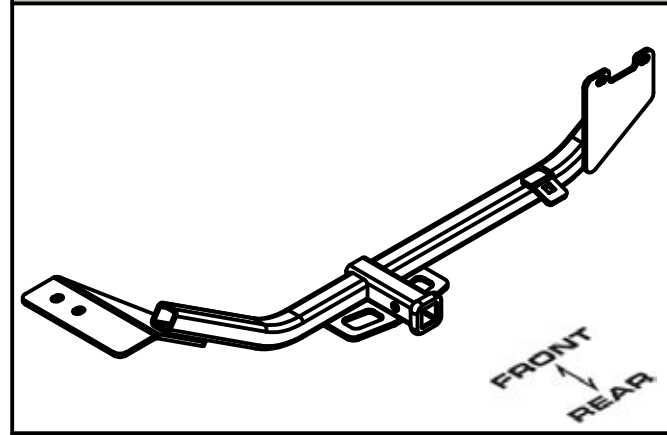

MAKE SURE YOUR HITCH MATCHES

PERIODICALLY CHECK THIS RECEIVER HITCH TO ENSURE ALL FASTENERS ARE TIGHT AND ALL STRUCTURAL COMPONENTS ARE SOUND

INSTALLATION WALKTHROUGH:

Parts List			
ITEM	QTY	PART NUMBER	DESCRIPTION
1	2	CM-SP6	.250 x 1.00 x 3.00" SQUARE HOLE SPACER
2	2	3/8 - 16 x 1 1/4	HEX BOLT
3	2	3/8"	WASHER
4	2	HFN3816P	3/8-16, HEX FLANGE NUT,PLAIN
5	2	1/2-13 x 1 1/2	CARRIAGE BOLT
6	3	HFN 1213	HEX FLANGE NUT
7	1	1/2 - 13 x 2"	CARRIAGE BOLT
8	1	CM-SP4	.250 x 1.50 x 3.00" SQUARE HOLE SPACER
9	2	1_2 FISHWIRE	1/2" FISHWIRE

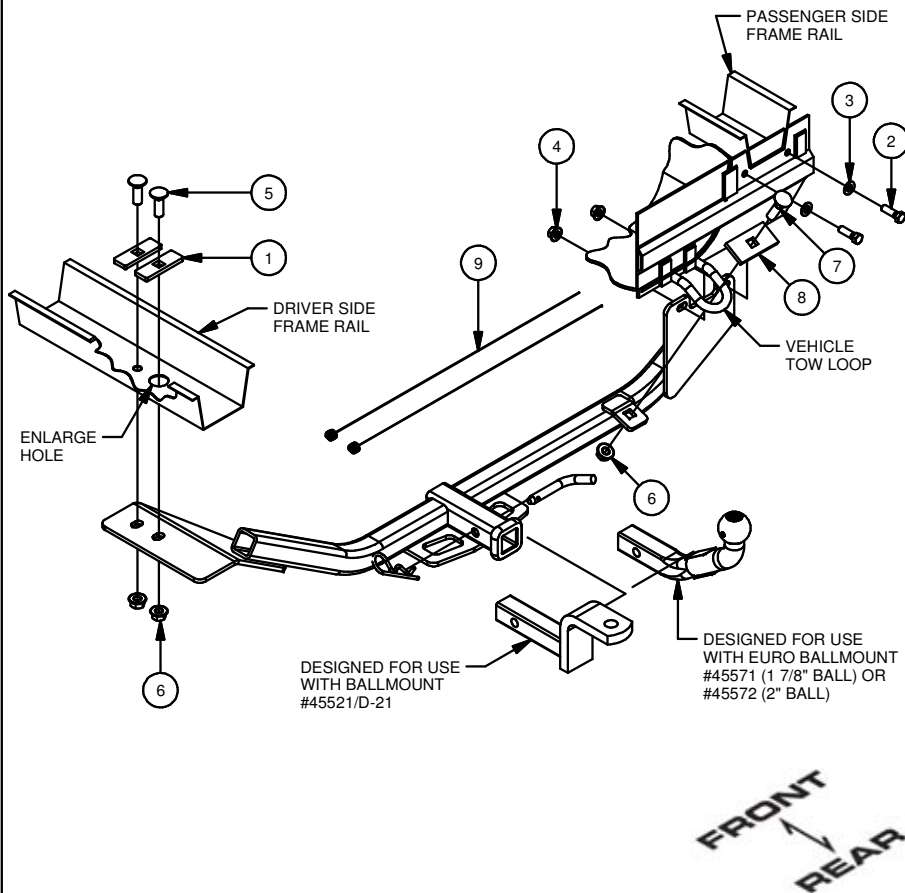

1. Locate (2) plastic fascia clips at rear of vehicle. Use flat head screwdriver to pry out and gain additional visibility and access to rear of vehicle frame. Retain clips for reinstallation.

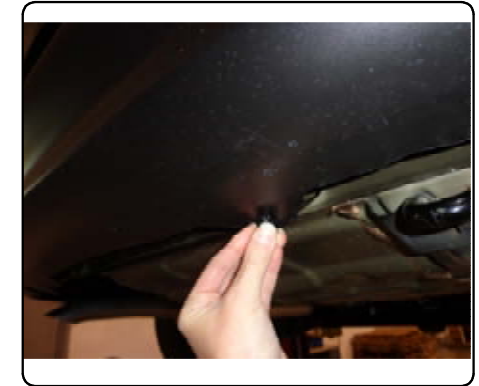

2. Use a die grinder to enlarge the rear hole in the driver side framerrail. This will be used for the access hole for fishwiring mounting hardware.

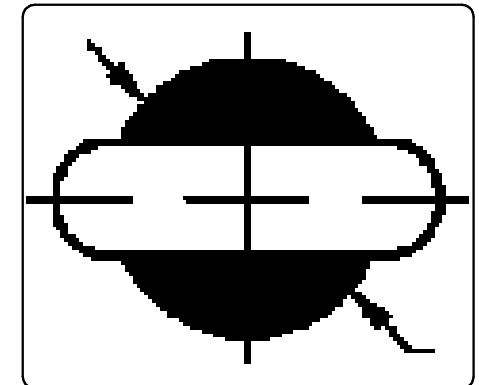

INSTALLATION WALKTHROUGH:

3. Fishwire forward 1/2" mounting hardware through the frame access hole as shown.

See fishwire diagram for reference.

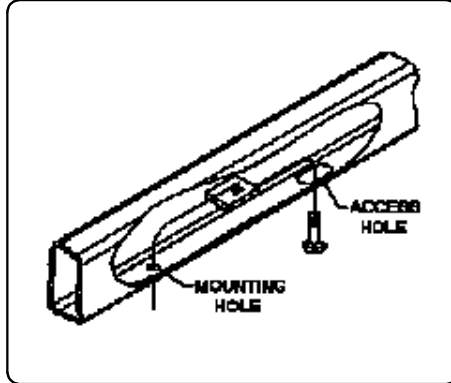

4. Reverse fishwire rearward 1/2" mounting hardware into the frame access hole as shown.

See reverse fishwire diagram for reference.

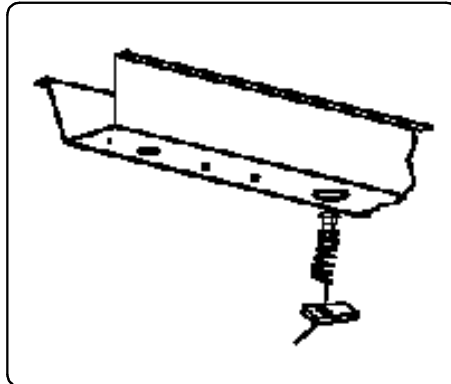

5. Raise hitch into position, attaching to the fishwired hardware on the driver side. 3/8" hardware will push through the rear of the vehicle frame on the passenger side and attach with a 9/16" socket as shown. Hold tightly on the back side with a boxed end wrench to secure.

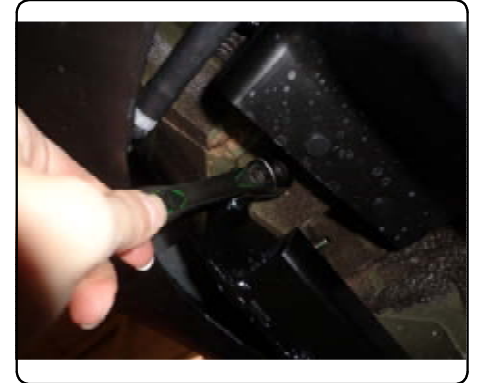
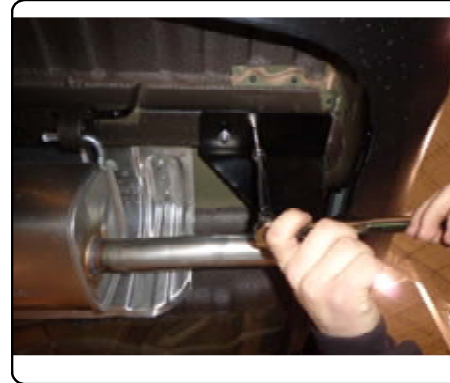

6. Using 1/2" carriage bolt, nut and spacer, attach rear hitch plate to vehicle tow loop.

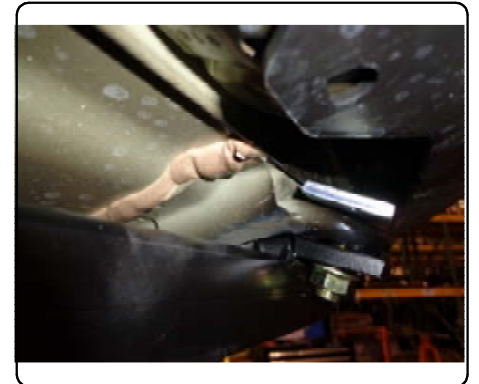
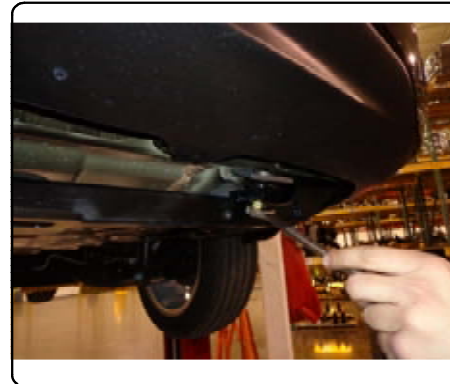

INSTALLATION WALKTHROUGH:

7. Reattach (2) plastic fascia clips at rear of vehicle.

Torque all 1/2" hardware to 110 ft-lbs, torque all 3/8" hardware to 45 ft-lbs.



Installation is complete

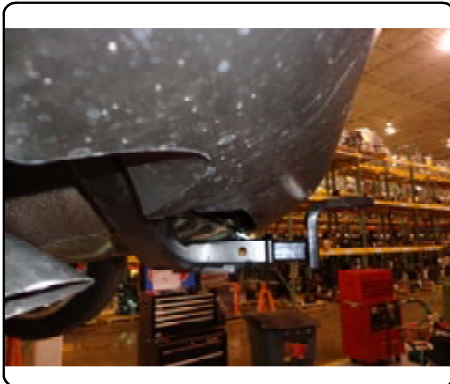

Parts List				
ITEM	QTY	PART NUMBER	DESCRIPTION	
1	2	CM-SP6	.250 x 1.00 x 3.00" SQUARE HOLE SPACER	
2	2	3/8 - 16 x 1 1/4	HEX BOLT	
3	2	3/8"	WASHER	
4	2	HFN3816P	3/8-16, HEX FLANGE NUT,PLAIN	
5	2	1/2-13 x 1 1/2	CARRIAGE BOLT	
6	3	HFN 1213	HEX FLANGE NUT	
7	1	1/2 - 13 x 2"	CARRIAGE BOLT	
8	1	CM-SP4	.250 x 1.50 x 3.00" SQUARE HOLE SPACER	
9	2	1_2 FISHWIRE	1/2" FISHWIRE	

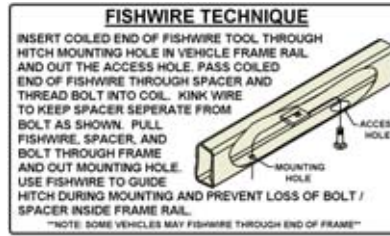

TOOLS REQUIRED
SCREWDRIVER
RATCHET
6" SOCKET EXTENSION
9/16" SOCKET
9/16", 3/4" BOXED END WRENCH
TORQUE WRENCH

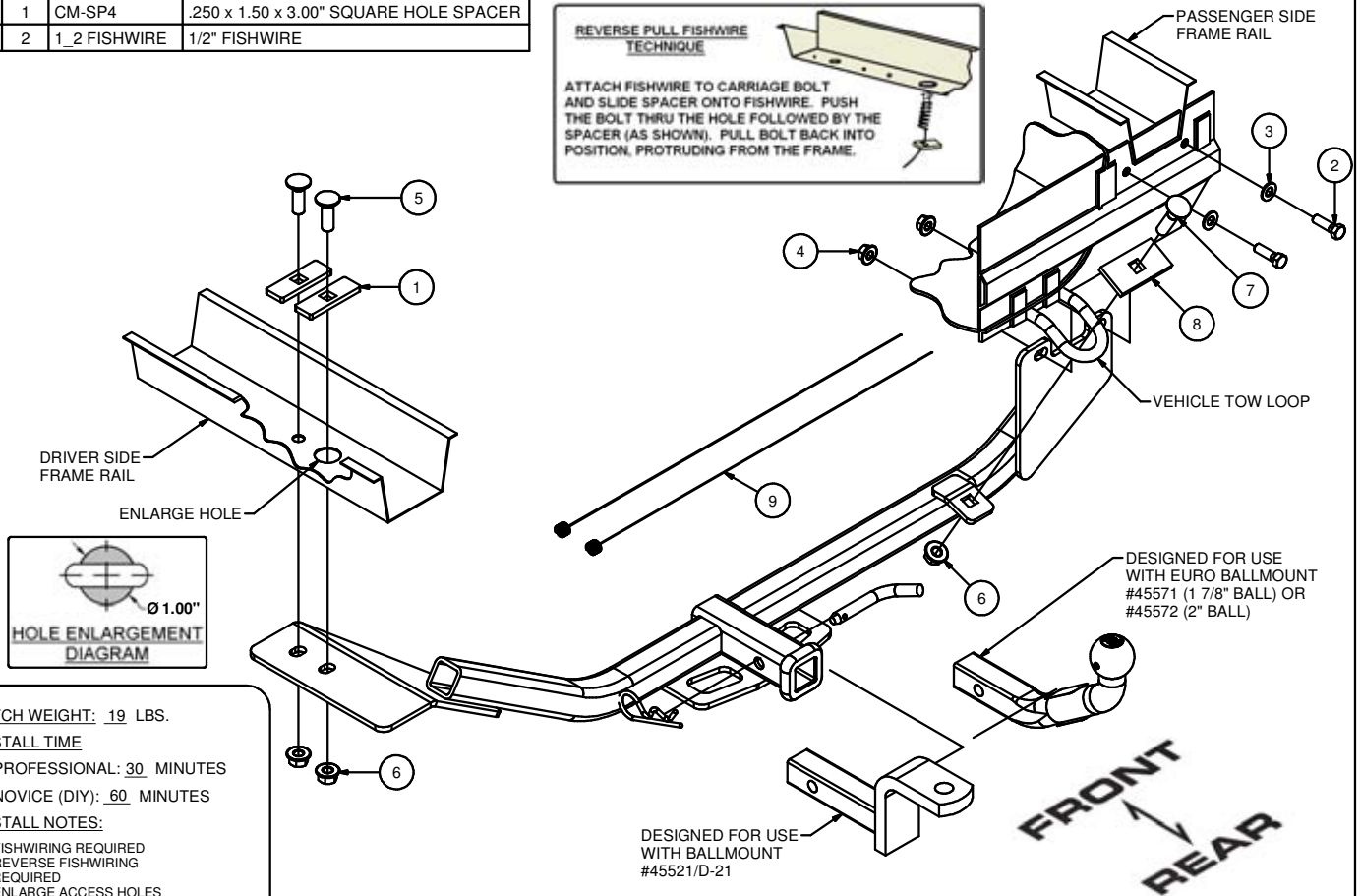
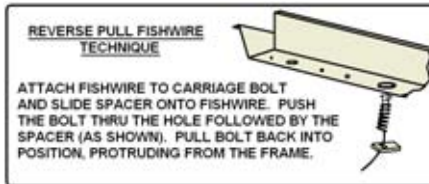

HITCH WEIGHT: .19 LBS.

INSTALL TIME

PROFESSIONAL: .30 MINUTES

NOVICE (DIY): .60 MINUTES

INSTALL NOTES:

- FISHWIRING REQUIRED
- REVERSE FISHWIRING REQUIRED
- ENLARGE ACCESS HOLES

INSTALLATION STEPS

1. Locate (2) plastic fascia clips at rear of vehicle. Use flat head screwdriver to pry out and gain additional visibility and access to rear of vehicle frame. Retain clips for reinstallation.
2. Use a die grinder to enlarge the rear hole in the driver side framerail. This will be used for the access hole for fishwiring mounting hardware.
3. Fishwire forward 1/2" mounting hardware through the frame access hole as shown. See fishwire diagram for reference.
4. Reverse fishwire rearward 1/2" mounting hardware into the frame access hole as shown. See reverse fishwire diagram for reference.
5. Raise hitch into position, attaching to the fishwired hardware on the driver side. 3/8" hardware will push through the rear of the vehicle frame on the passenger side and attach with a 9/16" socket. Hold tightly on the back side with a boxed end wrench to secure.
6. Using 1/2" carriage bolt, nut and spacer, attach rear hitch plate to vehicle tow loop.
7. Reattach (2) plastic fascia clips at rear of vehicle.
8. Torque all 1/2" hardware to 110 ft-lbs, torque all 3/8" hardware to 45 ft-lbs.

PERIODICALLY CHECK THIS RECEIVER HITCH TO ENSURE THAT ALL FASTENERS ARE TIGHT AND THAT ALL STRUCTURAL COMPONENTS ARE SOUND.