

INSTALLATION INSTRUCTIONS

DO NOT EXCEED PRODUCT RATING OR TOW VEHICLE LAMP LOAD RATING, WHICHEVER IS LOWER

56310 APPLICATIONS

Make	Model
Mazda	CX-5

VEHICLE-TO-TRAILER WIRING HARNESS

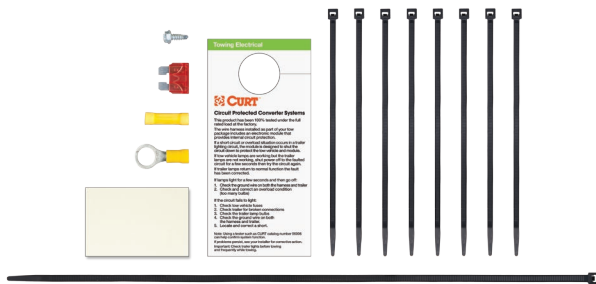
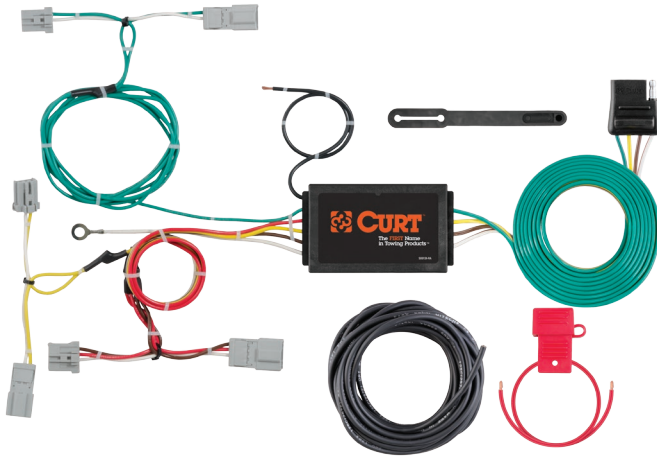

WIRING LOCATION GUIDE

SUVs, MINI & FULL-SIZED VANS (S)

Representative vehicle shown below

S3 - Behind driver side rear access panel

S4 - Behind passenger side rear access panel



NOTE

All steps must be followed to ensure the CURT wiring harness will function properly. Once installed, test for proper function by using a test light or connecting a properly wired trailer.

TOOLS NEEDED

10mm socket

Ratchet

Panel trim removal tool

Phillips screwdriver

Wire stripper

Crimping tool

Cutting tool

WARNING

The battery connection must be fuse protected, 10 amp max. Exceeding the product rating can cause loss of warranty, overheating and potential fire. Do not exceed product rating or tow vehicle lamp load rating, whichever is lower.

Signal Circuits - 3.0 amps per side

Tail / Running Circuits - 6.0 amps total

Check vehicle owner's manual or contact the vehicle manufacturer for more information.

INSTALLATION

Step 1

Locate vehicle battery on the driver side under the hood and disconnect the negative battery terminal.

Step 2

Open the vehicle trunk. Remove the fasteners securing the trunk floor covering to the rear seats (A). Remove the covering.

Step 3

Remove the spare tire floor cover (B) and all the foam storage trays (C).

Step 4

Remove the fasteners securing the rear scuff panel (D). Remove the scuff panel by pulling out on the bottom and then up. Take care not to damage the alignment tabs on the back.

Step 5

Starting on the driver side, remove the push fastener and cargo tie down holders from the side trim panel (E,F,G).

Step 6

Pull back the side trim panel to locate the vehicle taillight wiring harness connectors (H). The connectors will be similar to those on the CURT wiring harness. Separate the connectors from the taillight housing taking care not to damage the locking tabs.

Step 7

Insert the CURT wiring harness end with yellow wire between the separated connectors. Make sure the connectors are fully inserted with locking tabs in place.

Step 8

Locate a suitable grounding point near the connector such as an existing screw with nut in the vehicle frame or drill a 3/32" pilot hole

for the provided screw. The area should be free of rust, dirt and paint. Secure the white ground wire using the ring terminal and provided screw.

WARNING: Check for miscellaneous items that may be hidden behind or under any surface before drilling to avoid damage and / or personal injury.

Step 9

Route the CURT wiring harness end with the green wire to the passenger side behind the side trim panel and removed scuff panel. Repeat steps 5-7 on the passenger side using the harness end with the green wire.

Step 10

Locate a flat clean surface that is out of the path of spray and debris from the rear wheels and road. Adhere the black converter box using the provided double-sided tape. Failure to mount the box in a protected area can cause loss of warranty, product failure, overheating and potential fire (I).

Step 11

Route the black power wire from the vehicle battery as shown on the included CME-PCL-INS sheet.

Step 12

When in use, route the 4-flat to the center of the vehicle. When not in use, roll up and store in a convenient, out of the way location. Secure any loose wires with the provided cable ties.

Step 13

Reinstall all items removed during install and reconnect negative battery terminal. Install the provided 4-flat dust cover to help prevent corrosion.

