

# 56211 DODGE AVENGER CHRYSLER 200

## WIRING LOCATION GUIDE



### MUST READ FIRST!

All steps must be followed to ensure correct function of the T-Connector. To verify proper installation once installed, test by connecting a test light or properly wired trailer.

1. Access the vehicle's wiring harness connectors in the trunk behind the taillight in positions P1 and P2 as shown in the Wiring Location Guide.
2. Locate the vehicle's battery on the driver's side under the hood and disconnect the negative battery terminal.
3. Open the trunk. Remove the rear scuff panel by removing the plastic fasteners holding it in place (A). On both sides of the trunk pull back on the felt trunk liner behind the taillights and locate two plastic wing nuts on each side (B). Remove the plastic wing nuts holding the taillights in place. Remove the taillights by pulling rearward and out.
4. On the driver side of the vehicle behind the taillight locate the vehicle's taillight wiring harness connectors (C). The connectors will be similar to those on the T-Connector harness. Separate the connectors taking care not to damage the locking tabs (D).
5. Behind the taillight remove the grommet that the wires run through from the inside of the trunk to the taillight (E). Make a small slit in the grommet to route the wires through. Route the T-Connector end with the yellow wire out through the slit in the grommet from the trunk out to the taillights (F). Insert the T-Connector end with yellow wires between the separated connectors. Make sure the connectors are fully inserted with locking tabs in place.
6. Locate a suitable grounding point such as an existing screw with nut in the vehicle's frame or drill a 3/32" pilot hole for the provided screw. Clean the ground area of rust and dirt.

### WARNING!

Verify miscellaneous items that may be hidden behind or under any surface before drilling to avoid damage and/or personal injury.

Secure the white ground wire using the ring terminal and screw provided.

7. Inside the vehicle, locate a flat spot and adhere the black converter box using the double-sided tape provided.
8. Review instruction sheet CME-PCL-INS and route the black power wire from the battery to the converter as shown.
9. Route the T-Connector end with the green wire out from behind the felt trunk liner across to the passenger side behind the removed rear scuff panel. Repeat Steps 4 and 5 on the passenger side using the T-Connector end with the green wire.
10. Route the 4-flat wire out from behind the felt trunk liner and to the center of the vehicle and out of the trunk when in use. When not in use roll up and store in a convenient out of the way location in the trunk. Secure any loose wires with the cable ties provided.
11. Reinstall all items removed during install.
12. Connect negative battery terminal.

### IMPORTANT!

The battery connection must be fuse protected, 10 amp max. Exceeding the product rating can cause loss of warranty, overheating and potential fire. Do not exceed the tow vehicle's lamp load rating or the product rating, whichever is lower:

Signal Circuits - 3.0 amps per side

Tail/Running Circuits - 6.0 amps total

Check vehicle owner's manual or contact the vehicle manufacturer for more information.

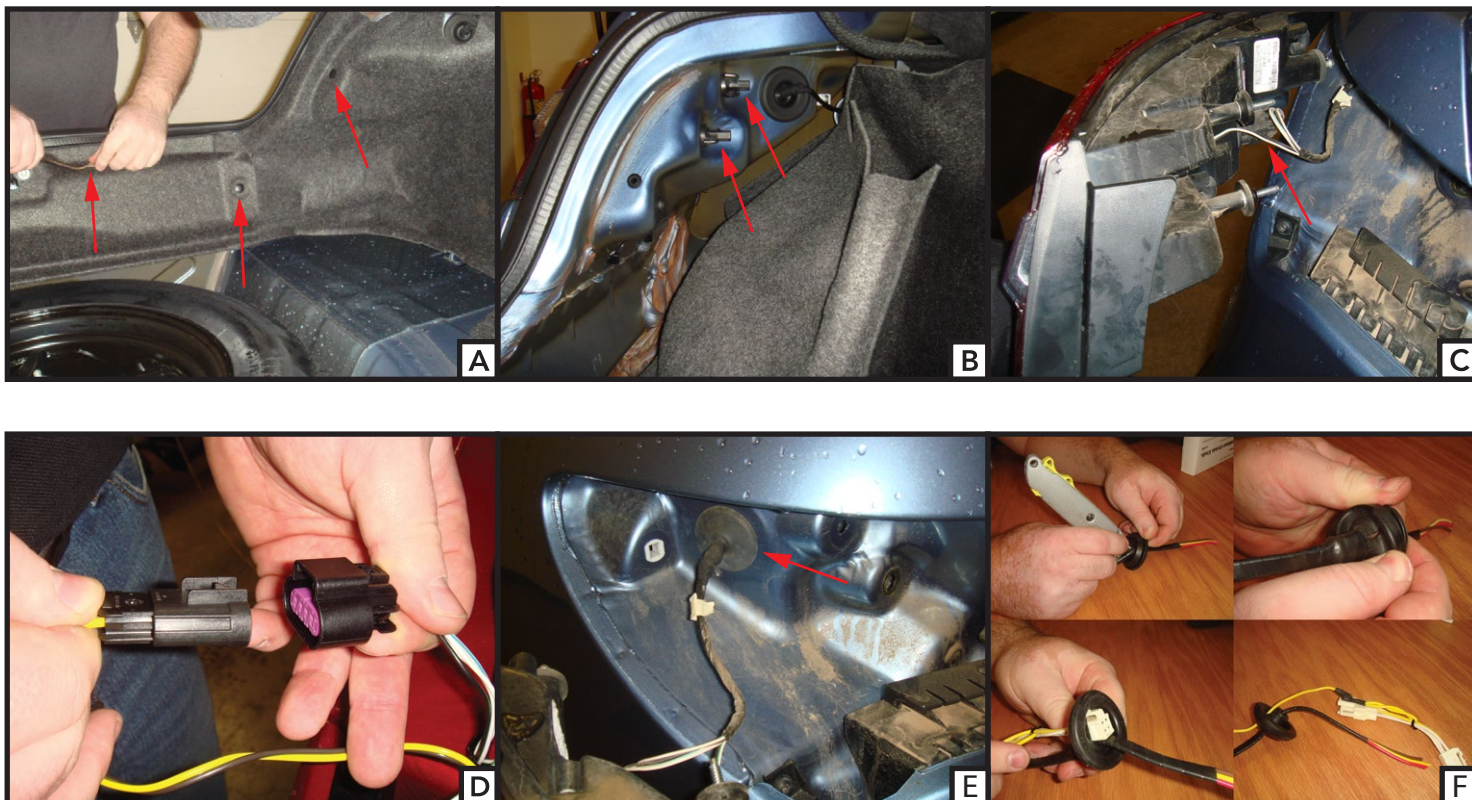

# PACKAGE CONTENTS

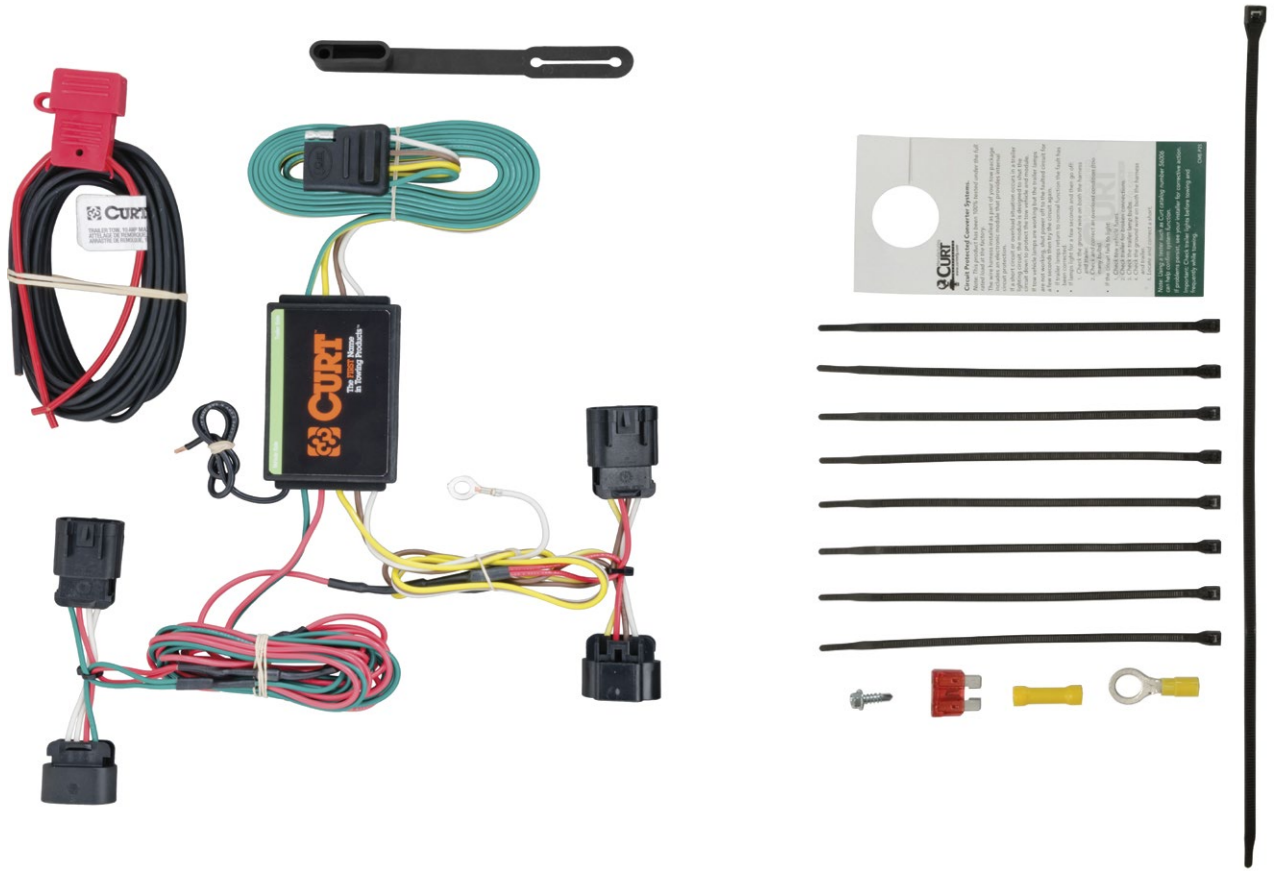

Find more CURT products on our website.

Learn more about trailer hitches and towing we have.