

56206

NISSAN VERSA NOTE

WIRING LOCATION GUIDE

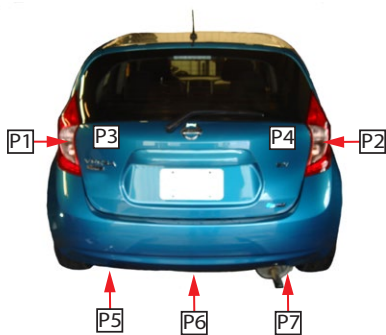

MUST READ FIRST!

All steps must be followed to ensure correct function of the T-Connector. To verify proper installation once installed, test by connecting a test light or properly wired trailer.

1. Access the vehicle's wiring harness connectors in the cargo area behind the taillight in positions P3 and P4 as shown in the Wiring Location Guide.
2. Locate the vehicle's battery on the driver's side under the hood and disconnect the negative battery terminal.
3. Open the rear hatch. Remove all floor coverings (A). Remove the two plastic push fasteners on each side of the rear scuff panel (B). Remove the rear scuff panel section by pulling out on the bottom and then up (C).
4. On both sides of the trunk remove the plastic cargo net tie down using a small flat screw driver (D). Remove the two plastic screw fasteners along the trunk floor (E).
5. On the driver's side pull back the trim panel to locate the vehicle's taillight wiring harness connectors (F). The connectors will be similar to those on the T-Connector harness. Separate the connector from the taillight housing taking care not to damage the locking tabs. Insert the T-Connector end with the yellow wire between the separated connectors. Make sure the connectors are fully inserted with locking tabs in place.

WARNING!

Verify miscellaneous items that may be hidden behind or under any surface before drilling to avoid damage and/or personal injury.

6. Locate a suitable grounding point near the connector such as an existing screw with nut in the vehicle's frame or drill a 3/32" pilot hole for the provided screw. Clean the ground area from any rust, dirt or paint. Secure the white ground wire using the ring terminal and screw provided.

7. Route the T-Connector end with the green wire to the passenger side behind the trim and removed scuff panel. Repeat Step 5 on the passenger side using the T-Connector end with the green wire. Use the provided cable ties to secure any loose wires.

8. Inside the vehicle, locate a flat spot and adhere the black converter box using the double-sided tape that is provided.

9. Route the 4-flat wire to the center of the vehicle. Secure the 4-flat to the center of the vehicle in a convenient, out of the way location. Secure any loose wires with the cable ties provided.

10. Reinstall all items removed during install.

IMPORTANT!

The battery connection must be fuse protected, 10 amp max. Exceeding the product rating can cause loss of warranty, overheating and potential fire. Do not exceed the tow vehicle's lamp load rating or the product rating, whichever is lower:

Signal Circuits - 3.0 amps per side

Tail/Running Circuits - 7.5 amps total

Check vehicle owner's manual or contact the vehicle manufacturer for more information.

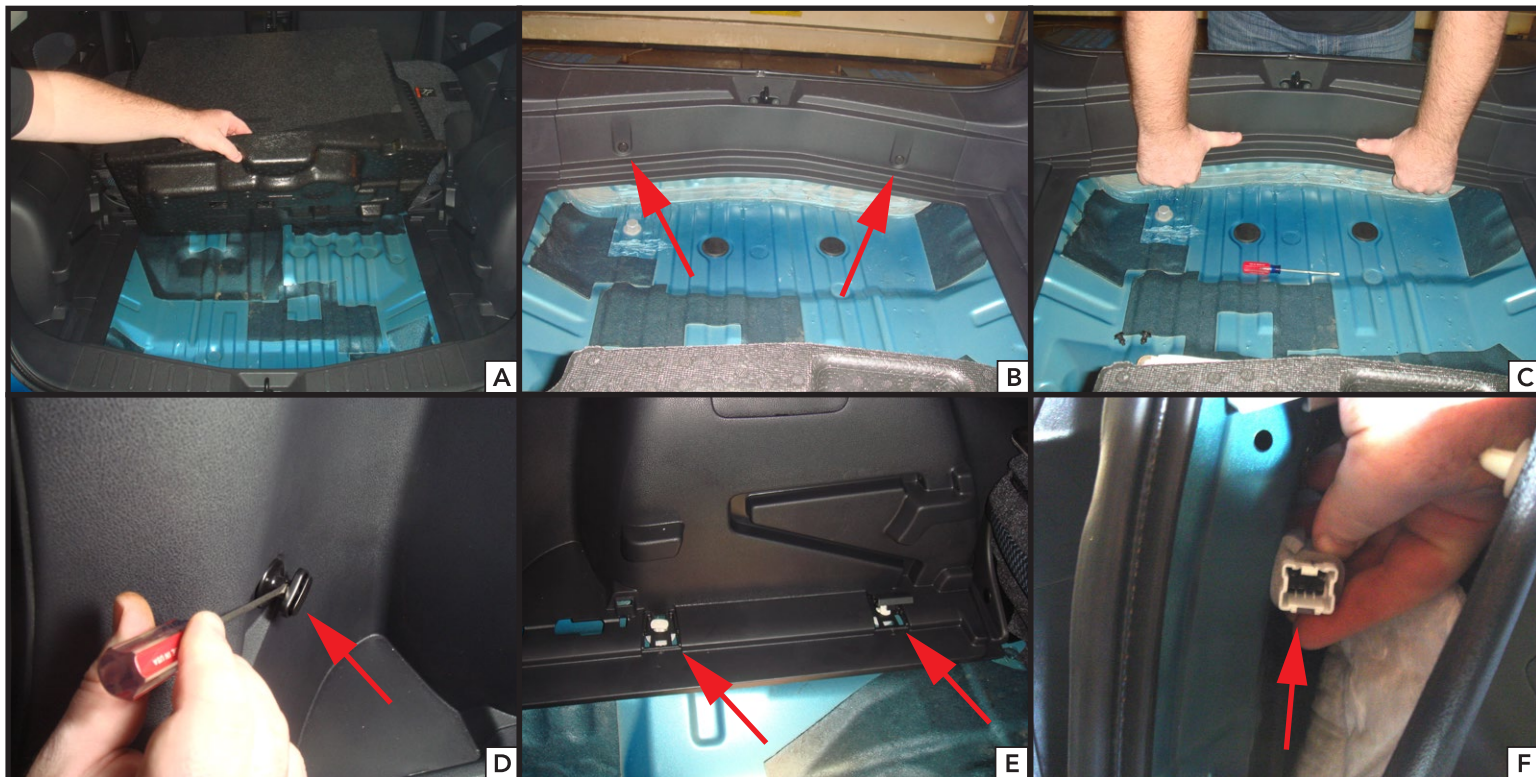

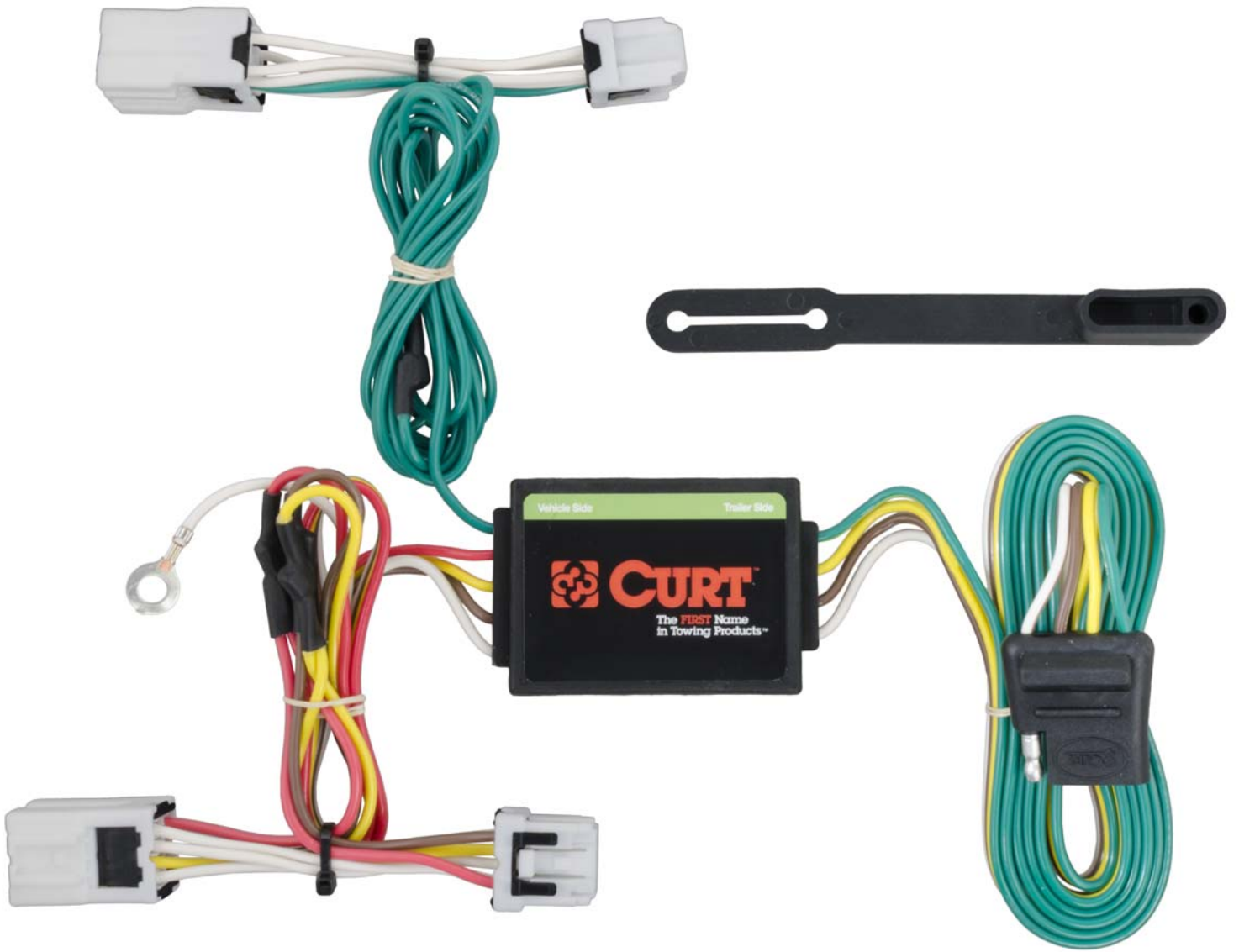

Find more CURT products on our website.

Learn more about trailer hitches and towing we have.