



31075 INSTALLATION INSTRUCTIONS



Safety glasses should be worn at all times while installing this product.

YEARS: 2016-PRESENT

MAKE: TOYOTA

MODEL: TACOMA

STYLE: PICKUP

WEIGHT CARRYING:
TRAILER WEIGHT: 3,500 LBS.
TONGUE WEIGHT: 350 LBS.

GROSS LOAD CAPACITY WHEN USED AS A STRAIGHT LINE PULL:
9,000 LBS MAX.

PRO INSTALL TIME: 30 MIN.
NOVICE INSTALL TIME: 60 MIN.

IF YOU ARE HESITANT TO UNDERTAKE THIS TASK ON YOUR OWN, CONTACT AN AUTHORIZED CURT INSTALLER FOR ADDITIONAL ASSISTANCE.

INSTALLATION TIPS:



- BEFORE YOU BEGIN INSTALLATION, READ ALL INSTRUCTIONS THOROUGHLY.
- TO EASE INSTALLATION, 2 PEOPLE MAY BE REQUIRED.
- USING PROPER TOOLS WILL GREATLY IMPROVE THE QUALITY OF THE INSTALL AND REDUCE THE TIME REQUIRED.



INSTALLATION REQUIRES:

 RATCHET	 TORQUE WRENCH	 10mm 17mm 3/4" SOCKET
 MASKING TAPE	 TAPE MEASURE	 MARKER
 AVIATION SHEARS	 SAFETY GLASSES	

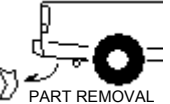
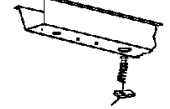
LEVEL OF DIFFICULTY: MODERATE

<i>EASY</i>	<i>MODERATE</i>	<i>CHALLENGING</i>
 PART REMOVAL	REMOVE TOW LOOP REMOVE LOWER AIR DAM	
	FISHWIRE (2) FASTENERS	
 TRIM	TRIM LOWER AIR DAM TO REINSTALL WITH HITCH	
	NO DRILLING REQUIRED	

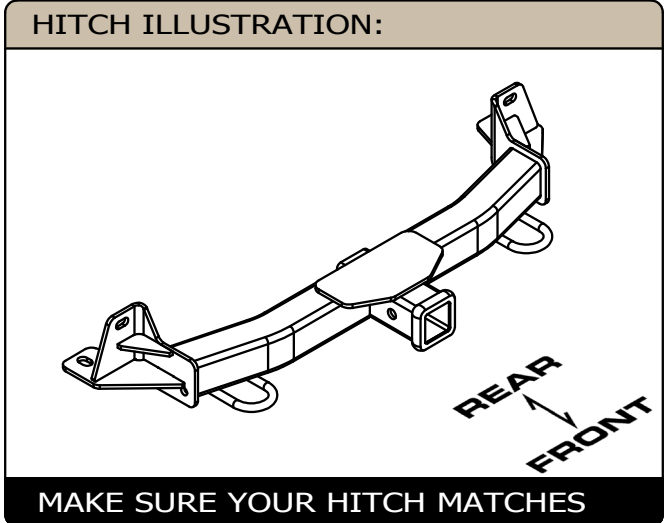

INSTALLATION WALKTHROUGH:

Parts List			
ITEM	QTY	PART NUMBER	DESCRIPTION
1	2	HFN 1213, GR8	HEX FLANGE NUT
2	2	1/2-13 x 1 1/2, GR8	CARRIAGE BOLT
3	2	CM-SP12	.250 x 1.00 x 2.00" SQUARE HOLE SPACER
4	2	1_2 FISHWIRE	1/2" FISHWIRE

REVERSE PULL FISHWIRE TECHNIQUE

ATTACH FISHWIRE TO CARRIAGE BOLT AND SLIDE SPACER ONTO FISHWIRE. PUSH THE BOLT THRU THE HOLE FOLLOWED BY THE SPACER (AS SHOWN). PULL BOLT BACK INTO POSITION, PROTRUDING FROM THE FRAME.

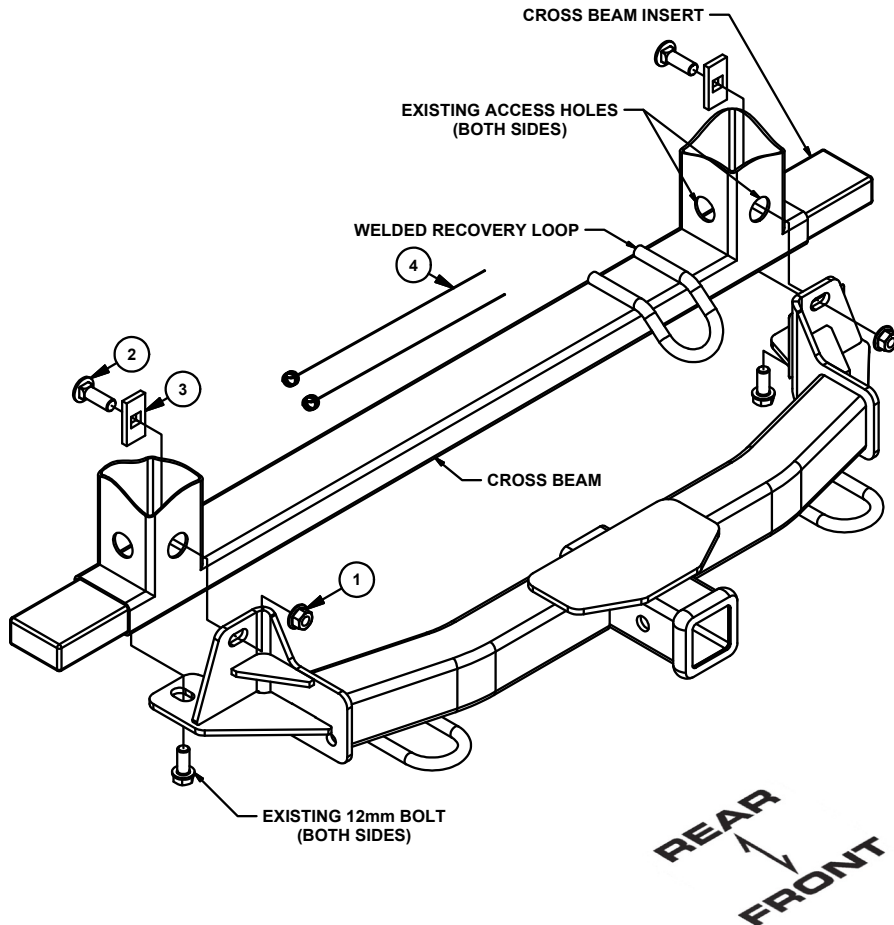
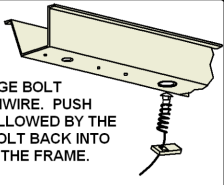

1. Remove tow loop from passenger side of the vehicle by removing (2) M12 bolts with a 17mm socket. Remove the (2) M12 bolts that attach the cross beam inserts in the cross beam and save for later use.

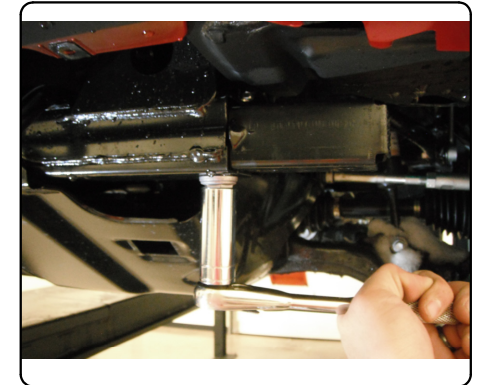
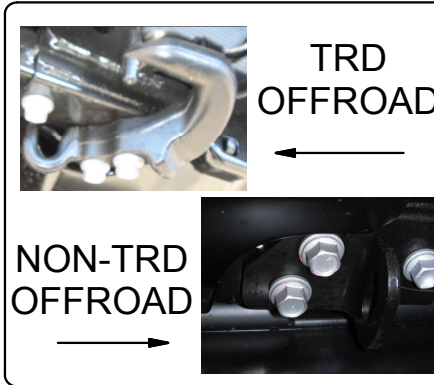

2. **Non-TRD Offroad models:** Remove (11) screws from the lower air dam using a 10mm socket and either return to owner or trim as shown in the diagram below.

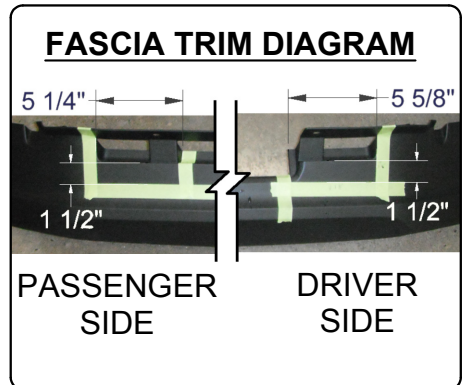
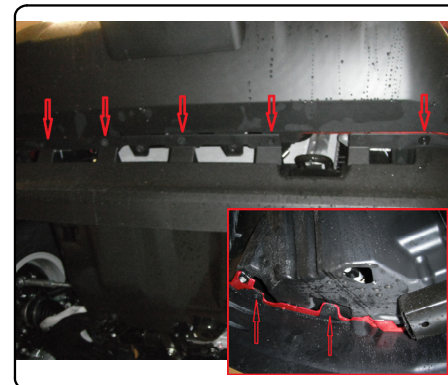

INSTALLATION WALKTHROUGH:

3. Fishwire the 1/2" bolts and CM-SP12 Spacers supplied into the forward hole above the cross beam. Raise hitch into position and loosely install 1/2" flange nuts and the 12mm bolts removed in step 1 for the cross beam inserts.



4. Torque all 12mm fasteners to 86 lb-ft and all 1/2" fasteners to 110 ft-lb.

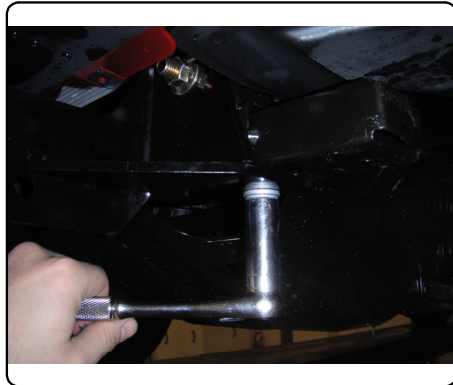

31075

TOYOTA TACOMA

GROSS LOAD CAPACITY WHEN USED AS A WEIGHT CARRYING HITCH: 3,500 LBS. TRAILER WEIGHT & 350 LBS. TONGUE WEIGHT.
GROSS LOAD CAPACITY WHEN USED AS A STRAIGHT LINE PULL: 9,000 LBS. MAX. LINE PULL.



WARNING: * DO NOT EXCEED VEHICLE MANUFACTURER'S RECOMMENDED TOWING CAPACITY. *****



Parts List			
ITEM	QTY	PART NUMBER	DESCRIPTION
1	2	HFN 1213, GR8	HEX FLANGE NUT
2	2	1/2-13 x 1 1/2, GR8	CARRIAGE BOLT
3	2	CM-SP12	.250 x 1.00 x 2.00" SQUARE HOLE SPACER
4	2	1_2 FISHWIRE	1/2" FISHWIRE

**REVERSE PULL FISHWIRE
TECHNIQUE**

ATTACH FISHWIRE TO CARRIAGE BOLT AND SLIDE SPACER ONTO FISHWIRE. PUSH THE BOLT THRU THE HOLE FOLLOWED BY THE SPACER (AS SHOWN). PULL BOLT BACK INTO POSITION, PROTRUDING FROM THE FRAME.

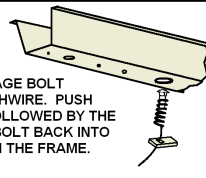

TOOLS REQUIRED	
	RATCHET
	TORQUE WRENCH
	10mm, 17mm SOCKETS
	3/4" SOCKET
	MASKING TAPE
	SAFETY GLASSES
	TAPE MEASURE
	MARKER
	AVIATION SHEARS

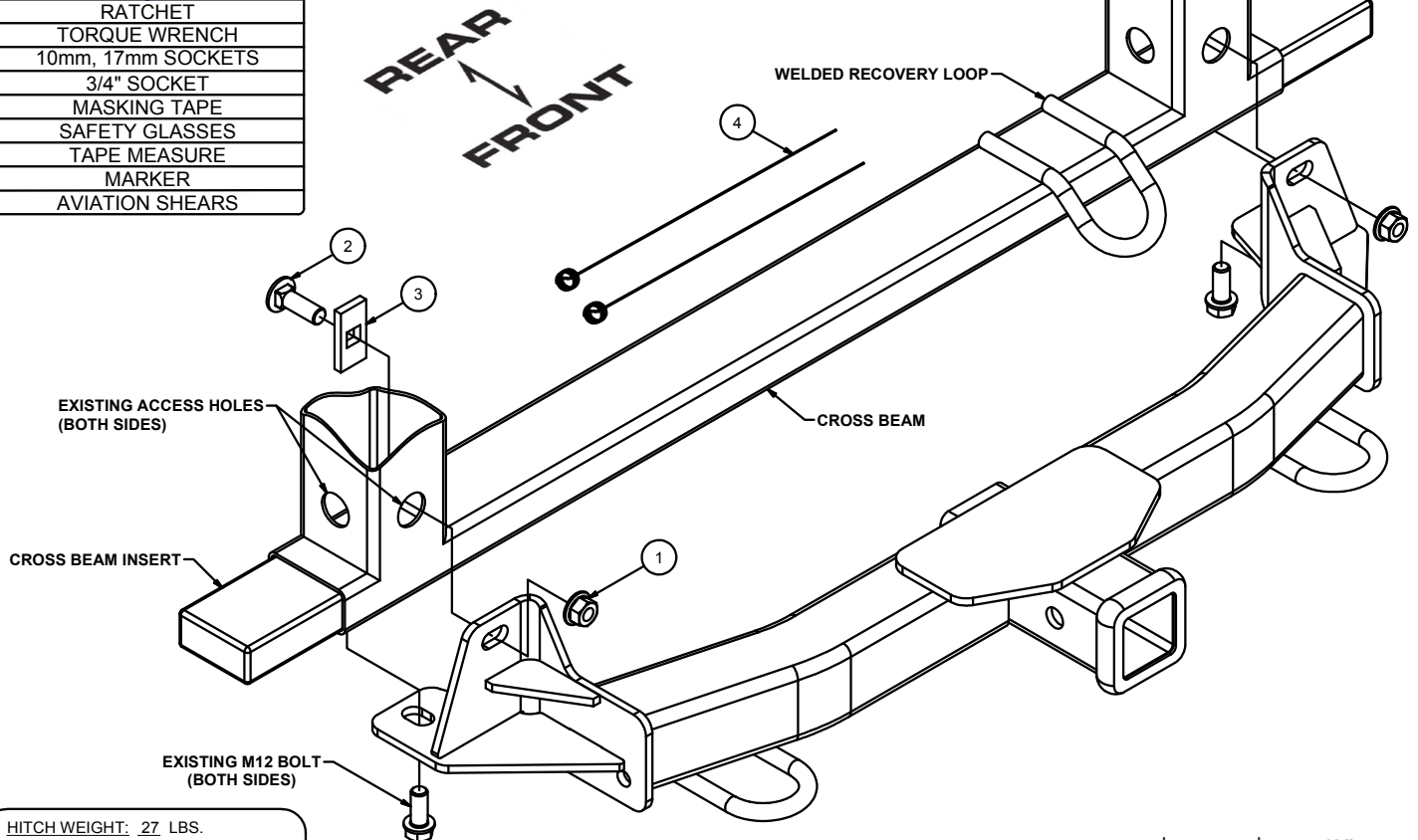

HITCH WEIGHT: 27 LBS.

INSTALL TIME

PROFESSIONAL: 30 MINUTES

NOVICE (DIY): 60 MINUTES

INSTALL NOTES:

- TRIM / REMOVE AIR DAM
- NO DRILLING REQUIRED
- REVERSE FISHWIRE HARDWARE
- REMOVE TOW LOOP



INSTALLATION STEPS

1. Remove tow loop from passenger side of the vehicle by removing (2) M12 bolts with a 17mm socket. Remove the (2) 12mm bolts that attach the cross beam inserts in the cross beam and save for later use.
2. **Non-TRD Offroad models:** Remove (11) screws from the lower air dam using a 10mm socket and either return to owner or trim as shown in the diagram above.
3. Fishwire the 1/2" bolts and CM-SP12 Spacers supplied into the forward hole above the cross beam. Raise hitch into position and loosely install 1/2" flange nuts and the 12mm bolts removed in step 1 for the cross beam inserts.
4. Torque all M12 fasteners to 86 lb-ft and all 1/2" fasteners to 110 ft-lb.

PERIODICALLY CHECK THIS RECEIVER HITCH TO ENSURE THAT ALL FASTENERS ARE TIGHT AND THAT ALL STRUCTURAL COMPONENTS ARE SOUND.

TOYOTA TACOMA

DO NOT EXCEED VEHICLE MANUFACTURER'S RECOMMENDED TOWING CAPACITY.

FRONT MOUNTED ACCESSORIES

1) Do not exceed front axle Gross Weight Rating (GAWR). Consult owners manual or specification plate located on driver's door frame. Measure gross front axle weight by placing front wheels of loaded vehicle on a scale.

WARNING: Exceeding GAWR may overload the front axle and/or suspension. This could result in **accident, property damage and personal injury.**

- 2) Reposition front mounted license plate if obstructed.
- 3) Do not obstruct vehicle lights.
- 4) Allow free air flow into grille opening.
- 5) Rear wheel traction may be reduced. This could effect handling. Reduce speed and drive with caution.
- 6) Accessories extend front of vehicle. This may reduce approach angle. Use caution when parking and maneuvering.
- 7) Do not obstruct driver view.

VEHICLE RECOVERY AND WINCHING TIPS

1) Use OEM tow hooks, recovery eyes or a clevis mount for attachment of a tow strap or winch cable.

WARNING: NEVER use a ball and/or ball mount as an anchor point for tow strap or winch cable. Severe personal injury or death could result.

- 2) Observe winch manufacturer's recommendations, cautions and warnings.
- 3) Attach return cable to tow hook or recovery eye when using a snatch block (See figure 1).

CAUTION: Do not attach return cable to winch mount. This may overload winch mount and/or front mounted receiver.

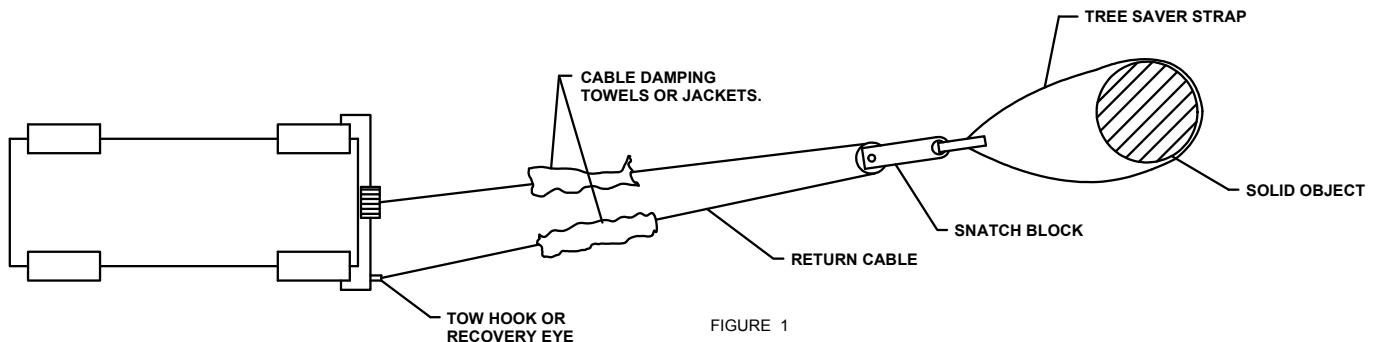

RATING

For **Maximum** line pull rating, winch cable must not exceed:
- 15 degree angle up or down from horizontal (See Figure 2).
- 45 degree angle left or right from straight ahead (See Figure 3).

CAUTION: Exceeding the maximum line pull rating may over load winch, winch mount, and/or front mounted receiver.

