

15398

TOYOTA TUNDRA

GROSS LOAD CAPACITY WHEN USED AS A WEIGHT CARRYING HITCH: 16,000 LBS. TRAILER WEIGHT & 2,400 LBS. TONGUE WEIGHT.  
 GROSS LOAD CAPACITY WHEN USED AS A WEIGHT DISTRIBUTION HITCH: 17,000 LBS. TRAILER WEIGHT & 2,400 LBS. TONGUE WEIGHT  
**\*\*\*DO NOT EXCEED VEHICLE MANUFACTURER'S RECOMMENDED TOWING CAPACITY.\*\*\***

Parts List			
ITEM	QTY	PART NUMBER	DESCRIPTION
1	4	1/2	CONICAL TOOTHED WASHER
2	4	1/2-13 x 1 1/2, GR8	CARRIAGE BOLT
3	8	9/16" CONICAL WASHER	CONICAL TOOTHED WASHER
4	4	9/16-12 x 1 1/2	HEX BOLT
5	4	9_16-12, GR8	HEX FLANGE NUT
6	4	HFN 1213, GR8	HEX FLANGE NUT

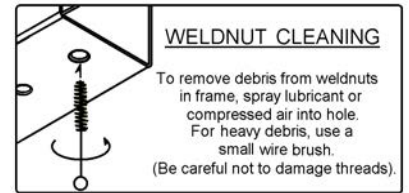
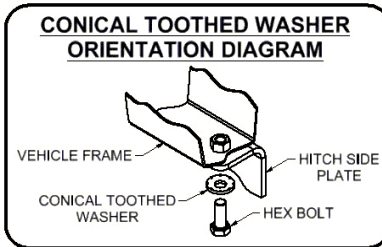

TOOLS REQUIRED	
	RATCHET
	TORQUE WRENCH
	10" EXTENSION
	3/4" SOCKET
	13/16" SOCKET
	17mm SOCKET
	19mm SOCKET
	7/8" WRENCH

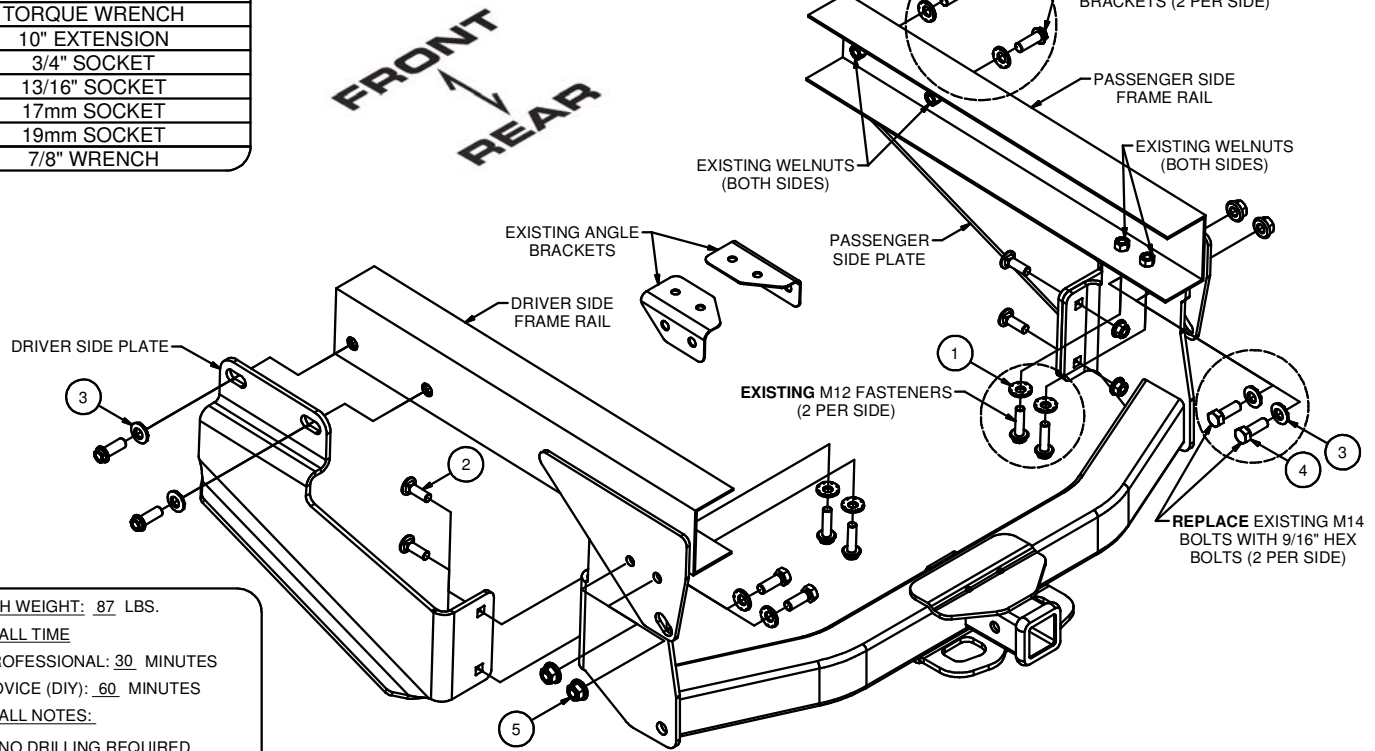

HITCH WEIGHT: 87 LBS.  
 INSTALL TIME  
 PROFESSIONAL: 30 MINUTES  
 NOVICE (DIY): 60 MINUTES  
 INSTALL NOTES:  
 - NO DRILLING REQUIRED

**INSTALLATION STEPS**

1. Remove the (8) bolts securing the existing angle brackets between the truck frame rails. Return the angle brackets to the vehicle owner. Save the bolts as they will be used to secure hitch in Steps 3 and 5.
2. Raise the hitch into position and loosely secure it to the vehicles frame using the supplied 9/16" hardware as shown.
3. Re-install (4) M12-1.25 bolts (removed in Step 1) with conical toothed washers through the hitch and into the weld nuts in the frame as shown.
4. Raise provided side plates into position using 1/2" hardware as shown.
5. Secure side plates to the side of the frame rails using (4) M14-1.50 bolts (removed in Step 1) and 9/16" conical toothed washers as shown.
6. Torque M12 hardware to 86 ft-lbs.  
 Torque M14 hardware to 136 ft-lbs.  
 Torque 9/16" hardware to 150 ft-lbs.  
 Torque 1/2" hardware to 110 ft-lbs.

**PERIODICALLY CHECK THIS RECEIVER HITCH TO ENSURE THAT ALL FASTENERS ARE TIGHT AND THAT ALL STRUCTURAL COMPONENTS ARE SOUND.**