

YEARS: 2016-PRESENT

MAKE: HONDA

MODEL: CIVIC

STYLE: SEDAN

**WARNING: NEVER EXCEED YOUR VEHICLE MANUFACTURER'S RECOMMENDED TOWING CAPACITY**

**WEIGHT CARRYING:**  
 TRAILER WEIGHT: 2000 LBS.  
 TONGUE WEIGHT: 200 LBS.

**PRO INSTALL TIME: 30 MIN.**  
**NOVICE INSTALL TIME: 60 MIN.**

IF YOU ARE HESITANT TO UNDERTAKE THIS TASK ON YOUR OWN, CONTACT AN AUTHORIZED CURT INSTALLER FOR ADDITIONAL ASSISTANCE.

**INSTALLATION REQUIRES:**

		<b>11/16"</b>
<b>RATCHET</b>	<b>TORQUE WRENCH</b>	<b>SOCKET</b>
<b>6"</b>		<b>1/4"</b>
<b>SOCKET EXTENSION</b>	<b>POWER DRILL</b>	<b>DRILL BIT</b>
<b>1/2"</b>		
<b>DRILL BIT</b>	<b>DIE GRINDER</b>	<b>PAINT PEN</b>
<b>SAFETY GLASSES</b>		

**INSTALLATION TIPS:**

- BEFORE YOU BEGIN INSTALLATION, READ ALL INSTRUCTIONS THOROUGHLY.
- TO EASE INSTALLATION, 2 PEOPLE MAY BE REQUIRED.
- USING PROPER TOOLS WILL GREATLY IMPROVE THE QUALITY OF THE INSTALL AND REDUCE THE TIME REQUIRED.

**LEVEL OF DIFFICULTY: MODERATE**

EASY	MODERATE	CHALLENGING
	DRILLING REQUIRED	
	HOLE ENLARGEMENT REQUIRED	
	FISHWIRE TECHNIQUE	
	REVERSE FISHWIRE TECHNIQUE	

**VEHICLE PHOTO:**



REPRESENTATIVE PHOTO

**HITCH ILLUSTRATION:**

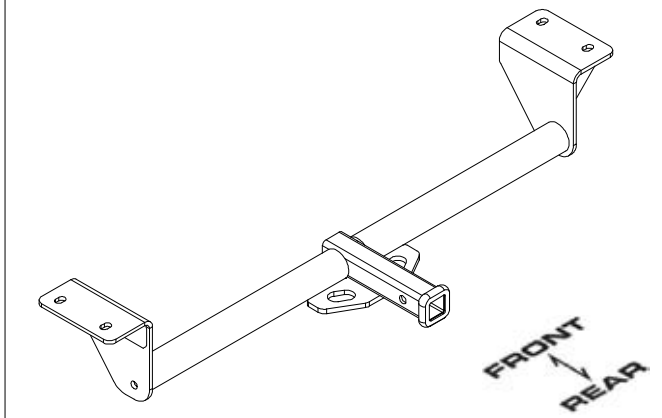

MAKE SURE YOUR HITCH MATCHES

# INSTALLATION WALKTHROUGH:

Parts List			
ITEM	QTY	PART NUMBER	DESCRIPTION
1	4	7/16-14 x 1 1/4	CARRIAGE BOLT
2	4	7/16-14	HEX FLANGE NUT
3	4	CM-SP7	.250 x 1.00 x 2.00" SQUARE HOLE SPACER
4	4	7_16 FISHWIRE	7/16" FISHWIRE

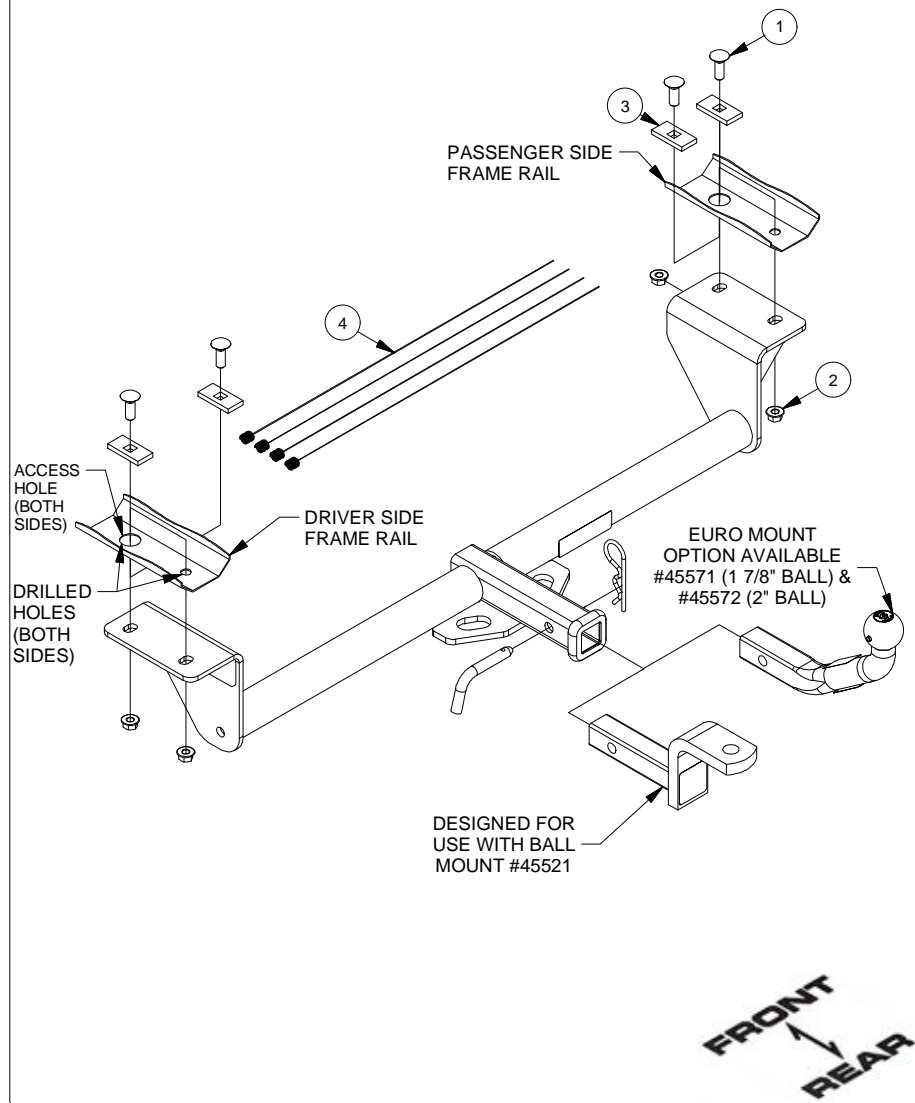

1. Raise hitch into position against the back of the frame rail. Using the hitch as a template, center the holes on the frame rail and use a paint pen to mark out the (4) hole locations.



2. Lower the hitch and use a drill and 1/4" drill bit to drill (4) holes located at the marked areas from step 1. Then, use a 1/2" drill bit to open up the holes to the final size.



## INSTALLATION WALKTHROUGH:

3. Use a die grinder to open up the (2) forward-most holes (1) on each frame rail. (See hole enlargement diagram).



4. Using the forward-most holes that were enlarged in step 3, fishwire (2) 7/16" carriage bolts and (2) CM-SP7 spacers into the rear most holes. (See fishwire diagram).



5. Using the forward-most holes that were enlarged in step 3, reverse fishwire (2) 7/16" carriage bolts and (2) CM-SP7 spacers into the frame. (See reverse fishwire diagram).



6. Raise hitch into position running the fishwires through the holes on the hitch. Remove fishwires and loosely fasten (4) 7/16" flange nuts.



## INSTALLATION WALKTHROUGH:

7. Torque all fasteners to 59 ft-lbs.



8. Installation Complete





# 11604

# HONDA CIVIC

**GROSS LOAD CAPACITY WHEN USED AS A WEIGHT CARRYING HITCH: 2000 LBS. TRAILER WEIGHT & 200 LBS. TONGUE WEIGHT.**  
**WARNING: ALL NON-TRAILER LOADS APPLIED TO THIS PRODUCT MUST BE SUPPORTED BY 18050 STABILIZING STRAPS.**



Parts List			
ITEM	QTY	PART NUMBER	DESCRIPTION
1	4	7/16-14 x 1 1/4	CARRIAGE BOLT
2	4	7/16-14	HEX FLANGE NUT
3	4	CM-SP7	.250 x 1.00 x 2.00" SQUARE HOLE SPACER
4	4	7_16 FISHWIRE	7/16" FISHWIRE

**FISHWIRE TECHNIQUE**

INSERT COILED END OF FISHWIRE TOOL THROUGH HITCH MOUNTING HOLE IN VEHICLE FRAME RAIL AND OUT THE ACCESS HOLE. PASS COILED END OF FISHWIRE THROUGH SPACER AND THREAD BOLT INTO COIL. KINK WIRE TO KEEP SPACER SEPERATE FROM BOLT AS SHOWN. PULL FISHWIRE, SPACER, AND BOLT THROUGH FRAME AND OUT MOUNTING HOLE. USE FISHWIRE TO GUIDE HITCH DURING MOUNTING AND PREVENT LOSS OF BOLT / SPACER INSIDE FRAME RAIL.

\*\*NOTE: SOME VEHICLES MAY FISHWIRE THROUGH END OF FRAME\*\*

**REVERSE PULL FISHWIRE TECHNIQUE**

ATTACH FISHWIRE TO CARRIAGE BOLT AND SLIDE SPACER ONTO FISHWIRE. PUSH THE BOLT THRU THE HOLE FOLLOWED BY THE SPACER (AS SHOWN). PULL BOLT BACK INTO POSITION, PROTRUDING FROM THE FRAME.

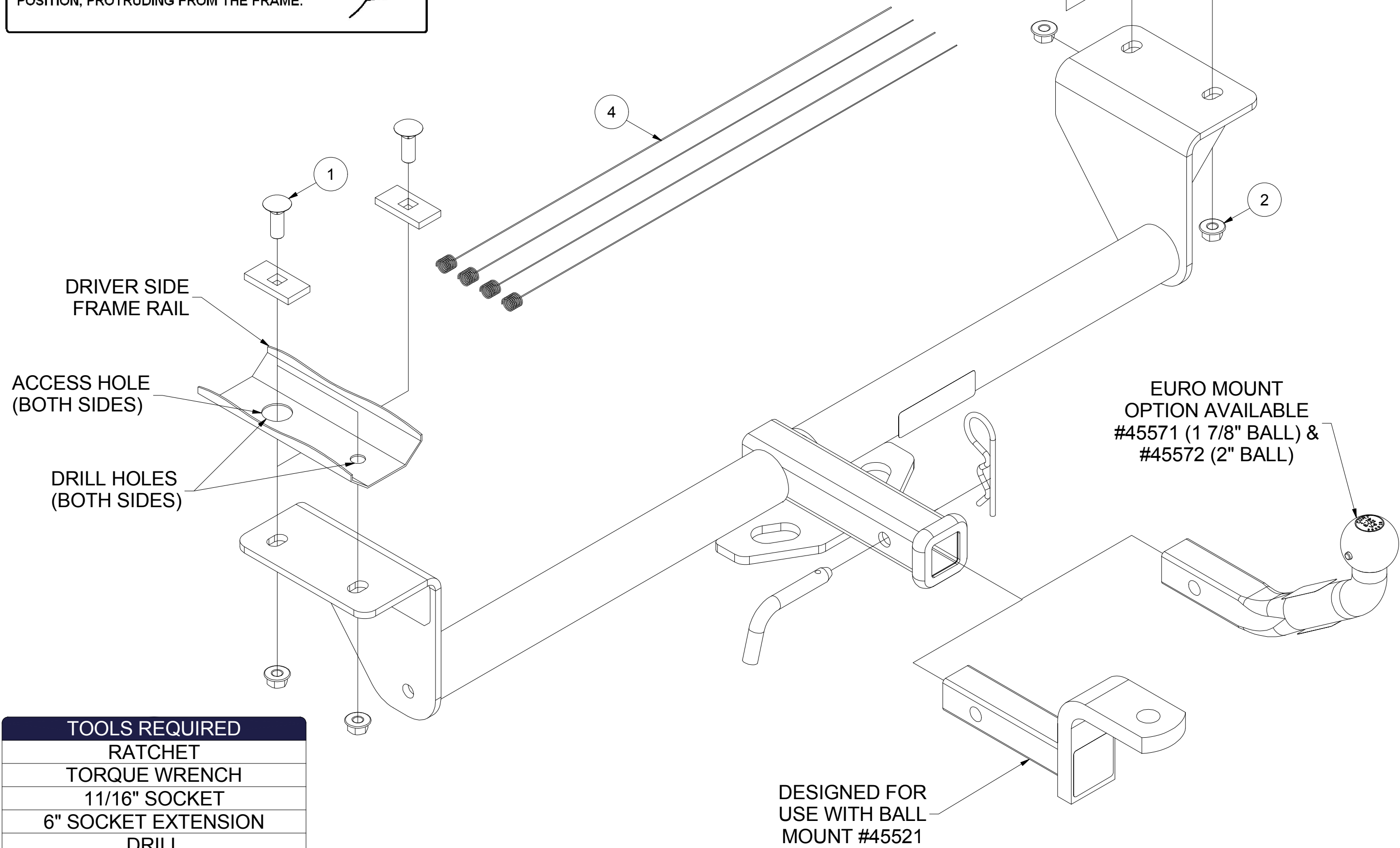

TOOLS REQUIRED
RATCHET
TORQUE WRENCH
11/16" SOCKET
6" SOCKET EXTENSION
DRILL
1/4" DRILL BIT
1/2" DRILL BIT
DIE GRINDER
PAINT PEN
SAFETY GLASSES

HITCH WEIGHT: 20 LBS.  
 INSTALL TIME  
 PROFESSIONAL: 30 MINUTES  
 NOVICE (DIY): 60 MINUTES  
 INSTALL NOTES:  
 -DRILLING REQUIRED  
 -FISHWIRE  
 -REVERSE FISHWIRE

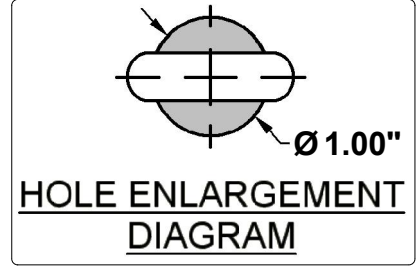

**FRONT**  
**REAR**

**PERIODICALLY CHECK THIS RECEIVER HITCH TO ENSURE THAT ALL FASTENERS ARE TIGHT AND THAT ALL STRUCTURAL COMPONENTS ARE SOUND.**

**INSTALLATION STEPS**

1. Raise hitch into position against the back of the frame rail. Using the hitch as a template, center the holes on the frame rail and use a paint pen to mark out the (4) hole locations.
2. Lower the hitch and use a drill and 1/4" drill bit to drill (4) holes located at the marked areas from step 1. Then, use a 1/2" drill bit to open up the holes to the final size.
3. Use a die grinder to open up the (2) forward-most holes (1) on each frame rail. (See hole enlargement diagram)
4. Using the forward-most holes that were enlarged in step 3, fishwire (2) 7/16" carriage bolts and (2) CM-SP7 spacers into the rear most holes. (See fishwire diagram).
5. Using the forward-most holes that were enlarged in step 3, reverse fishwire (2) 7/16" carriage bolts and (2) CM-SP7 spacers into the frame. (See reverse fishwire diagram).
6. Raise hitch into position running the fishwires through the holes on the hitch. Remove fishwires and loosely fasten (4) 7/16" flange nuts.
7. Torque all fasteners to 59 ft-lbs.
8. Installation Complete.

PERIODICALLY CHECK THIS RECEIVER HITCH TO ENSURE THAT ALL FASTENERS ARE TIGHT AND THAT ALL STRUCTURAL COMPONENTS ARE SOUND.