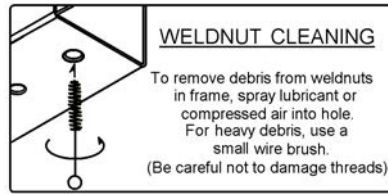

**12284****SUBARU LEGACY SEDAN & WAGON  
OUTBACK SEDAN & WAGON 2.5 XT & 3.0 LL BEAN**

EXCLUDING OUTBACK SPORT

**GROSS LOAD CAPACITY WHEN USED AS A WEIGHT CARRYING HITCH: 3,500 LBS. TRAILER WEIGHT & 300 LBS. TONGUE WEIGHT.****\*\*\*DO NOT EXCEED VEHICLE MANUFACTURER'S RECOMMENDED TOWING CAPACITY.\*\*\*****WARNING: ALL NON-TRAILER LOADS APPLIED TO THIS PRODUCT MUST BE SUPPORTED BY AUXILIARY STABILIZING STRAPS.****\*\* FAILURE TO PROPERLY SUPPORT NON-TRAILER LOADS WILL VOID PRODUCT WARRANTY\*\***

		Parts List	
ITEM	QTY	PART NUMBER	DESCRIPTION
1	1	CM-SP4	.250 x 1.50 x 3.00" SQUARE HOLE SPACER
2	4	CM-SP16	.250 x 1.50 x 2.00" ROUND HOLE SPACER
3	1	HFN 1213	HEX FLANGE NUT
4	1	1/2-13 x 1 3/4	CARRIAGE BOLT
5	4	M10 - 1.25 x 40 HEX	HEX BOLT
6	4	7/16 LOCK WASHER	HELICAL LOCK WASHER
7	4	3/8"	WASHER

**RUBBER ISOLATOR  
REMOVAL DIAGRAM**

This technique can be used if and Exhaust Hanger Removal Pliers is not available.

Using a 5/8" open end wrench, slide the wrench up to the rubber isolator, cradling the hanger rod as shown. Next place the flat edge of a pry bar between the wrench and the hanger stop or hanger rod. Then simply rotate the pry bar toward the wrench to remove the rubber isolator.

Note: Using a spray lubricant or soapy water on the hanger rod and the rubber isolator helps removal.

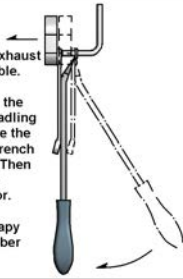
**TOOLS REQUIRED**

14mm, 17mm, 3/8" SOCKETS
RATCHET
SMALL FLAT SCREWDRIVER
TORQUE WRENCH

USE SPACERS TO LEVEL HITCH

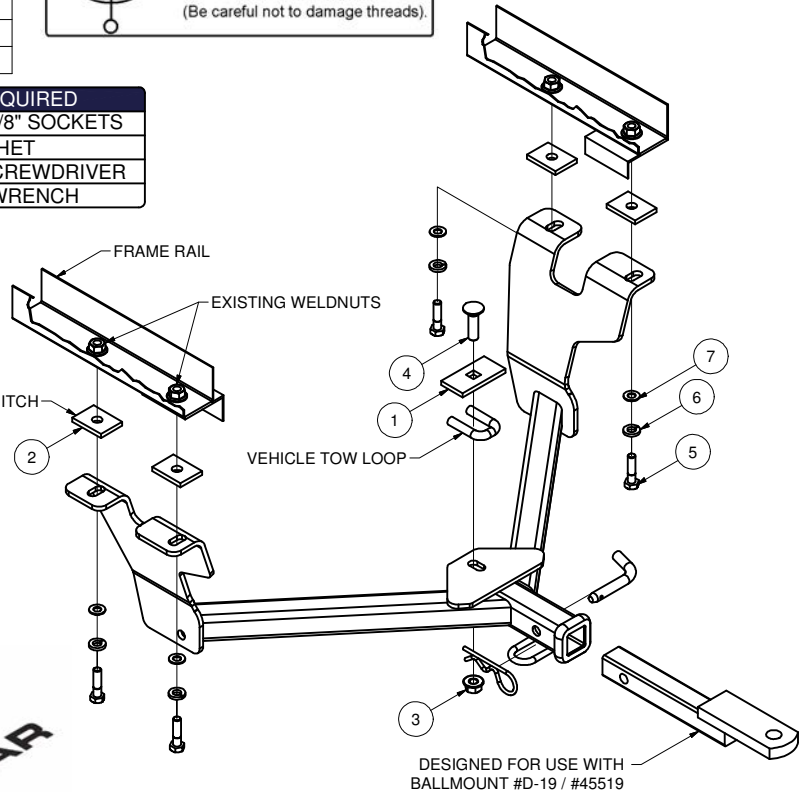

HITCH WEIGHT: 27 LBS.

**INSTALL TIME**

PROFESSIONAL: 35 MINUTES

NOVICE (DIY): 75 MINUTES

**INSTALL NOTES:**

- NO DRILL
- LOWER EXHAUST
- WELDNUT PLUG REMOVAL
- BOLT REMOVAL

**INSTALLATION STEPS**

1. Lower exhaust from (5) hangers. (Two per per muffler and one rearward of catalytic converter)

**Note: Do not allow exhaust to hang on its own. Use wire to hang exhaust with enough space to allow for hitch installation. Damage may occur to exhaust if allowed to hang too low.**

**Note: If installed, rear factory splash guards will need to be removed to allow room for the exhaust to hang.**

2. Remove bolt from forward most part of bracket underneath frame rails for wagon models.
3. Remove plastic plugs covering weld nuts in frame rails. Raise hitch over exhaust and slide under vehicle from rear and loosely attach 1/2-13 carriage bolt and hardware through tow loop.
4. Spacer usage will vary with vehicle application. Install spacers until hitch is level.
5. Install M10 x 1.25 x 40 hex bolts and hardware into existing weld nuts.
6. Tighten 1/2-13 bolt to 110 lb.-ft. and M10 bolts to 49 lb.-ft.
7. Raise exhaust and reinstall muffler hangers.

**PERIODICALLY CHECK THIS RECEIVER HITCH TO ENSURE THAT ALL FASTENERS ARE TIGHT AND THAT ALL STRUCTURAL COMPONENTS ARE SOUND.**

The **FIRST** Name  
in Towing Products™

Trailer Hitches