

12272

2004-2007 CHEVROLET MALIBU - SEDAN ONLY

GROSS LOAD CAPACITY WHEN USED AS A WEIGHT CARRYING HITCH: 3500 LBS. TRAILER WEIGHT & 350 LBS. TONGUE WEIGHT.

DO NOT EXCEED VEHICLE MANUFACTURER'S RECOMMENDED TOWING CAPACITY.

WARNING: ALL NON-TRAILER LOADS APPLIED TO THIS PRODUCT MUST BE SUPPORTED BY AUXILIARY STABILIZING STRAPS.

** FAILURE TO PROPERLY SUPPORT NON-TRAILER LOADS WILL VOID PRODUCT WARRANTY**

Parts List			
ITEM	QTY	PART NUMBER	DESCRIPTION
1	2	1/2 - 13 x 2"	CARRIAGE BOLT
2	2	CM-SP4	.250 x 1.50 x 3.00" SQUARE HOLE SPACER
3	2	HFN 1213	HEX FLANGE NUT
4	4	3/8-16 x 1 1/2	CARRIAGE BOLT
5	4	CM-SP18	.250 x 1.00 x 2.00" SQUARE HOLE SPACER
6	4	3/8"	CONICAL TOOTHED WASHER
7	4	3/8 - 16	HEX NUT
8	1	CM-500-FW	FISHWIRE TOOL

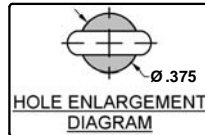

RUBBER ISOLATOR REMOVAL DIAGRAM

This technique can be used if and Exhaust Hanger Removal Pliers is not available.

Using a 5/8" open end wrench, slide the wrench up to the rubber isolator, cradling the hanger rod as shown. Next place the flat edge of a pry bar between the wrench and the hanger stop or hanger rod. Then simply rotate the pry bar toward the wrench to remove the rubber isolator.

Note: Using a spray lubricant or soapy water on the hanger rod and the rubber isolator helps removal.

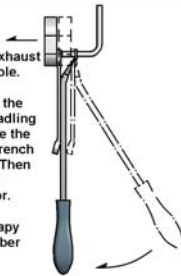

FISHWIRE TECHNIQUE

INSERT COILED END OF FISHWIRE TOOL THROUGH HITCH MOUNTING HOLE IN VEHICLE FRAME RAIL AND OUT THE ACCESS HOLE. PASS COILED END OF FISHWIRE THROUGH SPACER AND THREAD BOLT INTO COIL. KINK WIRE TO KEEP SPACER SEPARATE FROM BOLT AS SHOWN. PULL FISHWIRE, SPACER, AND BOLT THROUGH FRAME AND OUT MOUNTING HOLE. USE FISHWIRE TO GUIDE HITCH DURING MOUNTING AND PREVENT LOSS OF BOLT / SPACER INSIDE FRAME RAIL.

NOTE: SOME VEHICLES MAY FISHWIRE THROUGH END OF FRAME

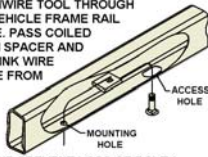

HITCH WEIGHT: 48 LBS.

INSTALL TIME

PROFESSIONAL: 30 MINUTES

NOVICE (DIY): 65 MINUTES

INSTALL NOTES:

- Hole enlargement required
- Fishwiring required

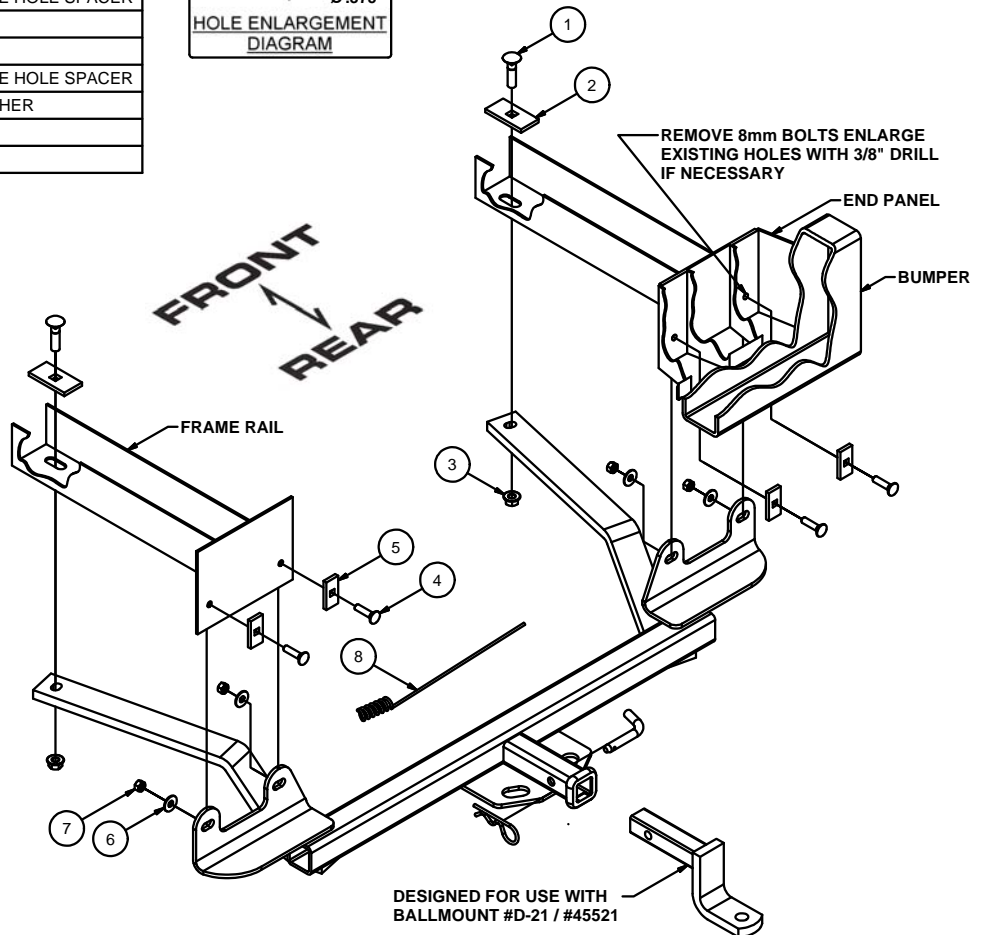

INSTALLATION STEPS

- 1) Lower muffler by removing the two (2) exhaust hangers.
- 2) Remove the bottom four (4) 8mm bumper bolts from the end panel. Do **NOT** loosen or remove the top bumper bolts.
- 3) Remove existing weldnut from end panel on the inboard side of frame rail.
- 4) If necessary, enlarge existing holes in end panel using a 3/8" drill.
- 5) Fishwire 1/2" carriage bolts and large spacer blocks through large slot in bottom of frame rail as shown.
Note: Keep bolt and block separate while inserting fasteners through slot.
- 6) Raise hitch into position, aligning slots in hitch with holes in vehicle end panel.
- 7) Loosely install the 3/8" carriage bolts, small spacer blocks, conical toothed washers, and hex nuts as shown.
- 8) Pull fasteners through, orient spacer block as shown. Loosely install conical toothed washers and hex nuts onto carriage bolts.
- 9) Torque all 3/8" hardware to 45 lb-ft. and all 1/2" hardware to 110 lb-ft.
- 10) Reinstall exhaust hangers removed in step 1.

PERIODICALLY CHECK THIS RECEIVER HITCH TO ENSURE THAT ALL FASTENERS ARE TIGHT AND THAT ALL STRUCTURAL COMPONENTS ARE SOUND.



The **FIRST** Name
in Towing Products™

Trailer Hitches