

12044

00-05 BUICK LE SABRE- ALL MODELS, 06-CURRENT BUICK LUCERNE
00-05 PONTIAC BONNEVILLE- ALL(EXCEPT SLE), 00-03 OLDSMOBILE AURORA

GROSS LOAD CAPACITY WHEN USED AS A WEIGHT CARRYING HITCH: 3,500 LBS. TRAILER WEIGHT & 350 LBS. TONGUE WEIGHT.

DO NOT EXCEED VEHICLE MANUFACTURER'S RECOMMENDED TOWING CAPACITY.

WARNING: ALL NON-TRAILER LOADS APPLIED TO THIS PRODUCT MUST BE SUPPORTED BY AUXILIARY STABILIZING STRAPS.

** FAILURE TO PROPERLY SUPPORT NON-TRAILER LOADS WILL VOID PRODUCT WARRANTY**

Parts List			
ITEM	QTY	PART NUMBER	DESCRIPTION
1	2	1/2-13 x 1 3/4	CARRIAGE BOLT
2	2	CM-SP6	.250 x 1.00 x 3.00" SPACER
3	2	HFN 1213	HEX FLANGE NUT
4	2	3/8-16 x 2	CARRIAGE BOLT
5	2	3/8"	CONICAL TOOTHED WASHER
6	2	M10 - 1.5 x 45mm	HEX BOLT
7	2	3/8-16	HEX FLANGE NUT
8	1	1/2"	FISHWIRE TOOL
9	2	CM-12044-EHB	.250" EXHAUST HANGER BRACKET

TOOLS REQUIRED
17/32 DRILL BIT
DRILL
17mm, 9/16 & 3/4 SOCKETS
10" EXTENSION
RATCHET
TORQUE WRENCH

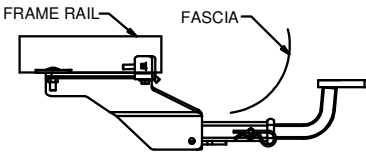
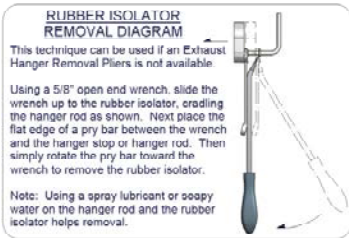
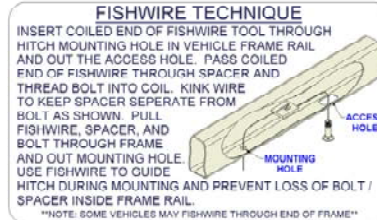

HITCH SHOWN PROPERLY INSTALLED

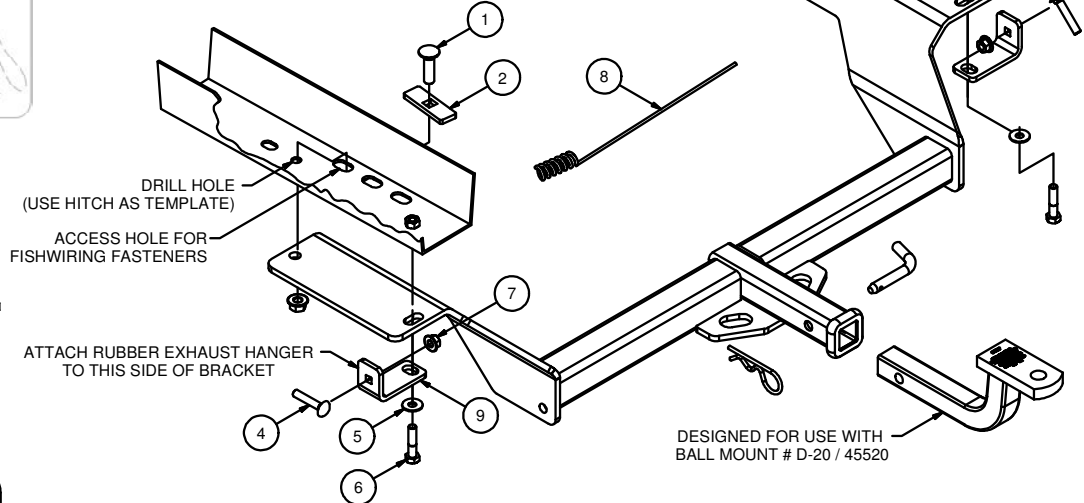

HITCH WEIGHT: 32 LBS.

INSTALL TIME

PROFESSIONAL: 30 MINUTES

NOVICE (DIY): 60 MINUTES

INSTALL NOTES:

-DRILLING REQUIRED

-FISHWIRE HARDWARE

Note: On vehicles equipped with heat shield, remove rearmost fastener which secures heat shield to frame rail and discard. Trim heat shield as needed.

Note: On vehicles equipped with automatic load leveling control, remove rearmost fastener which secures load leveling control housing to frame rail and discard. Trim load leveling control housing as needed.

INSTALLATION STEPS

- 1) Remove the exhaust hanger bracket from the bottom of the frame rail and disconnect the rubber hanger attached to the exhaust tail pipe. A replacement bracket is provided and will be installed later. Return factory exhaust brackets to the vehicle owner. (See Rubber Isolator Removal Diagram)
- 2) When lifting hitch into position you may need to bend or cut heat shield to allow for hitch clearance, temporarily attach to vehicle with hex bolts. Using hitch as a template drill two 17/32" holes as shown above.
- 3) Lower hitch and fishwire carriage bolts and spacers through frame access holes. (See Fishwire Technique Diagram)
- 4) Attach hanger brackets, install M10 hex bolt through square hole in bracket to bottom of frame. Slide the rubber hanger onto the 3/8" carriage bolt and secure with flanged hex nut. Tighten nut against the rubber hanger allowing the hanger to rotate. Do not over tighten.
- 5) Torque all M10 fasteners to 45 ft.-lbs. Torque all 1/2" fasteners to 110 ft.-lbs.

PERIODICALLY CHECK THIS RECEIVER HITCH TO ENSURE THAT ALL FASTENERS ARE TIGHT AND THAT ALL STRUCTURAL COMPONENTS ARE SOUND.



The **FIRST** Name in Towing Products™

Trailer Hitches