

12028

00-07 CHEVY MONTE CARLO (EXCEPT SS PACKAGE)

**GROSS LOAD CAPACITY WHEN USED AS A WEIGHT CARRYING HITCH: 3,500 LBS. TRAILER WEIGHT & 350 LBS. TONGUE WEIGHT**  
**\*\*\*DO NOT EXCEED VEHICLE MANUFACTURER'S RECOMMENDED TOWING CAPACITY\*\*\*.**

Parts List			
ITEM	QTY	PART NUMBER	DESCRIPTION
1	2	HFN 1213	HEX FLANGE NUT
2	2	CM-SP1	.250 x 1.50 x 2.00" SQUARE HOLE SPACER
3	2	1/2-13 x 1 3/4	CARRIAGE BOLT
4	1	CM-500-FW	FISHWIRE TOOL
5	6	M8-1.25 x 35	HEX BOLT
6	6	3/8"	CONICAL TOOTHED WASHER

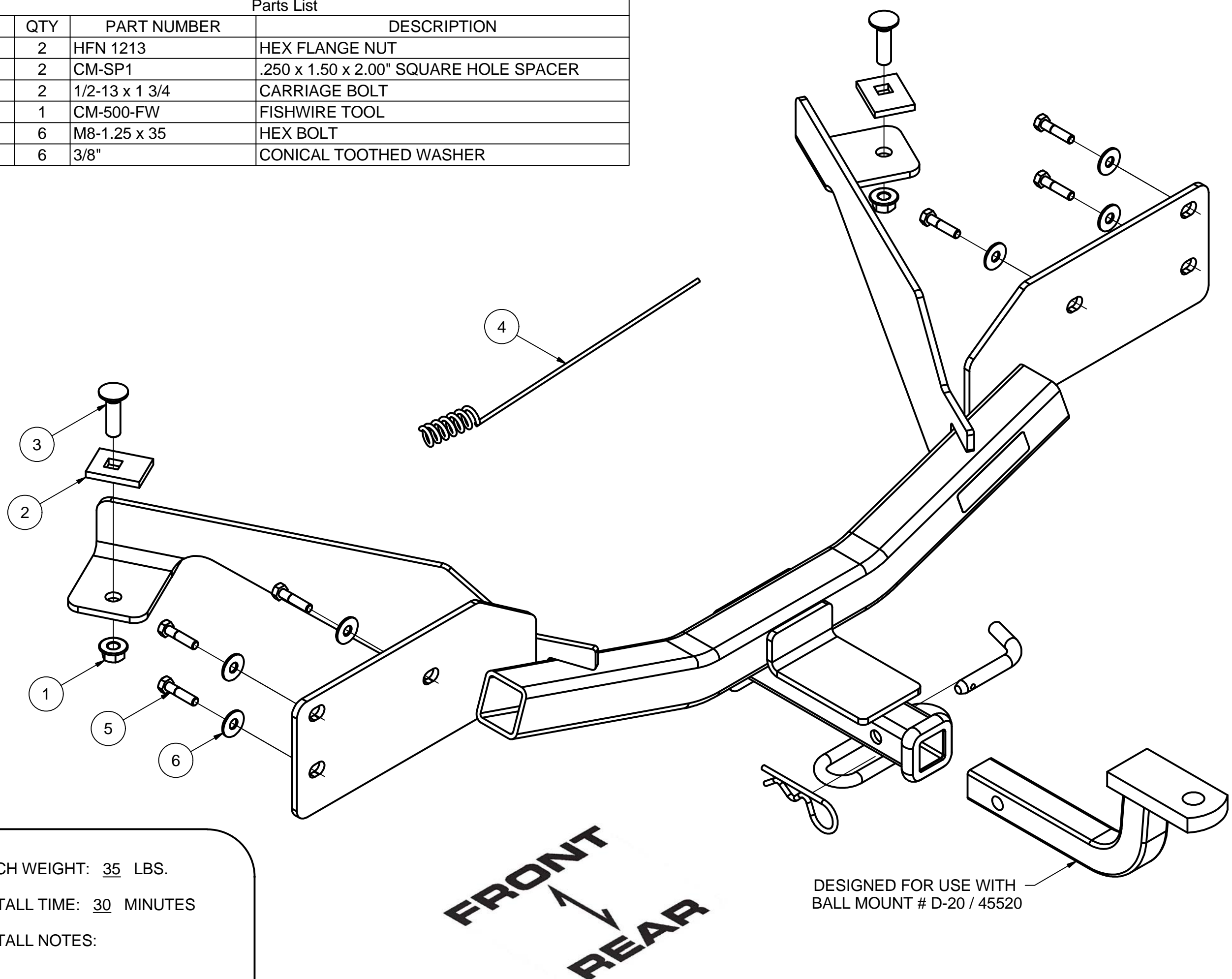

HITCH WEIGHT: 35 LBS.

INSTALL TIME: 30 MINUTES

INSTALL NOTES:

## **INSTALLATION STEPS**

- 1) LOWER VEHICLE EXHAUST
- 2) REMOVE THREE EXISTING BUMPER MOUNTING BOLTS FROM EACH SIDE AND RETURN TO VEHICLE OWNER.
- 3) INSERT HITCH BETWEEN BUMPER BRACKET AND FRAME RAIL. INSTALL SUPPLIED M8 FASTENERS AS SHOWN ABOVE.
- 4) FISHWIRE CARRIAGE BOLTS AND BLOCKS INTO FRAME RAILS THROUGH ACCESS HOLES.
- 5) INSTALL REMAINING FASTENERS AS SHOWN ABOVE, AND RAISE EXHAUST BACK INTO PLACE.
- 6) TORQUE ALL M8 FASTENERS TO 23 LB-FT. TORQUE ALL 1/2" FASTENERS TO 110 LB-FT.

**PERIODICALLY CHECK THIS [RECEIVER HITCH](#) TO ENSURE THAT ALL FASTENERS ARE TIGHT AND THAT ALL STRUCTURAL COMPONENTS ARE SOUND.**