

11329

FORD FUSION, MERCURY MILAN
MAZDA 6, 06 LINCOLN ZEPHYR / 07-CURRENT MKZ

GROSS LOAD CAPACITY WHEN USED AS A WEIGHT CARRYING HITCH: 2,000 LBS. TRAILER WEIGHT & 200 LBS. TONGUE WEIGHT.

DO NOT EXCEED VEHICLE MANUFACTURER'S RECOMMENDED TOWING CAPACITY.

WARNING: ALL NON-TRAILER LOADS APPLIED TO THIS PRODUCT MUST BE SUPPORTED BY AUXILIARY STABILIZING STRAPS.

** FAILURE TO PROPERLY SUPPORT NON-TRAILER LOADS WILL VOID PRODUCT WARRANTY**

Parts List			
ITEM	QTY	PART NUMBER	DESCRIPTION
1	2	1/2-13 x 1 1/4	CARRIAGE BOLT
2	2	CM-SP12	.250 x 1.00 x 2.00" SQUARE HOLE SPACER
3	4	HFN 1213	HEX FLANGE NUT
4	2	1/2-13 x 1 1/2	CARRIAGE BOLT
5	2	CM-SP62	.250" SPACER PLATE
6	2	M8 - 1.25 x 30	HEX HEAD TAP BOLT
7	2	5/16"	WASHER
8	1	1/2"	FISHWIRE TOOL
9	2	5/16"	LOCK WASHER

**** SPECIAL NOTE ****
NOTCH FASCIA AS NEEDED TO PROVIDE CLEARANCE FOR HITCH

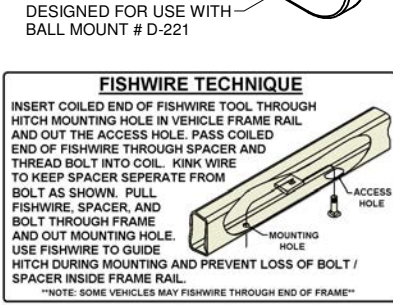
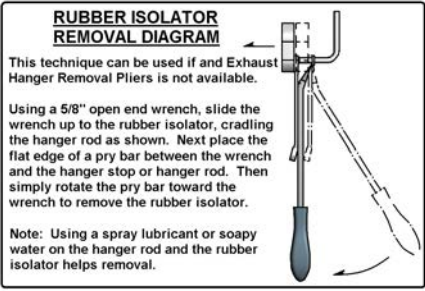
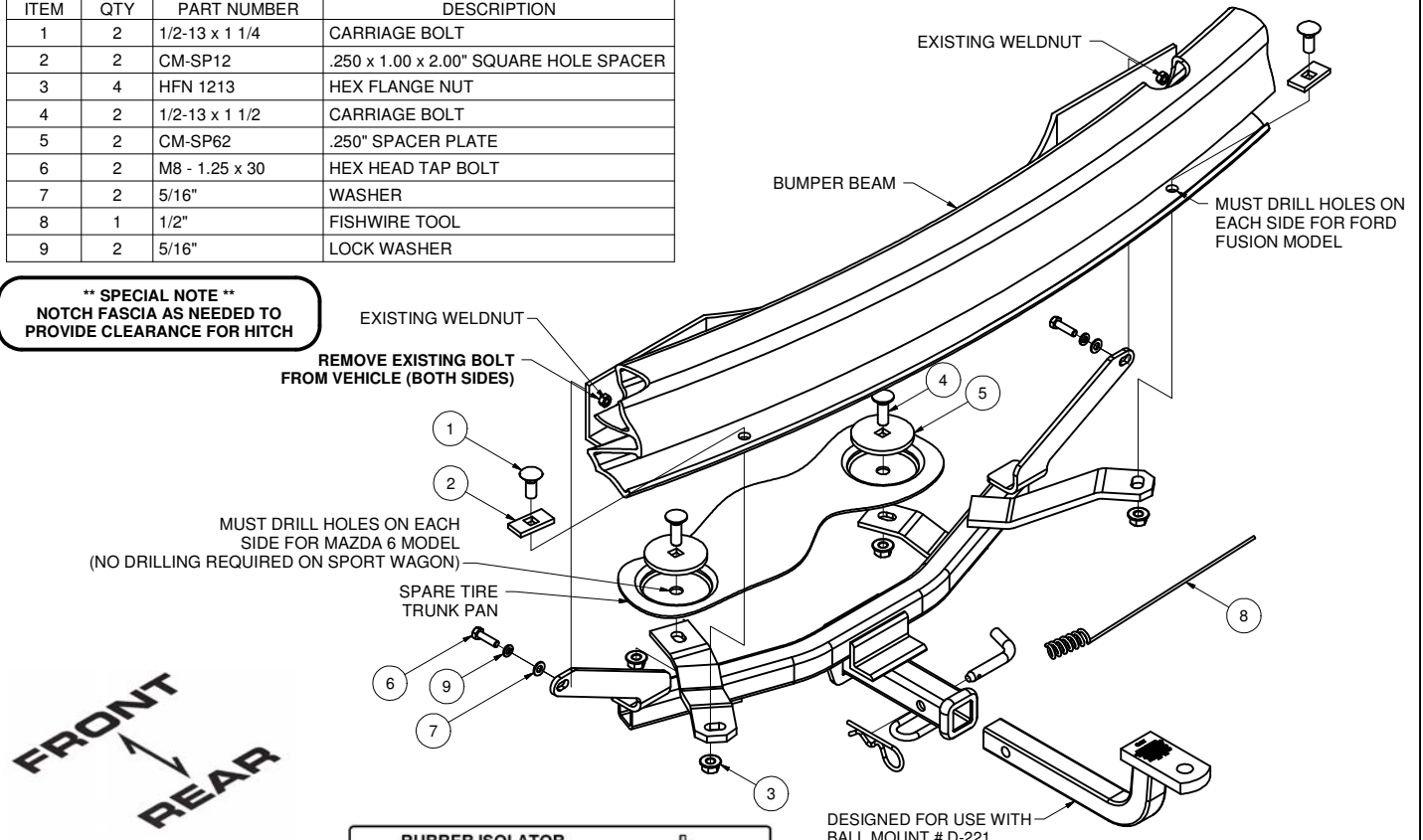

HITCH WEIGHT: 28 LBS.
INSTALL TIME
PROFESSIONAL: 45 MINUTES
NOVICE (DIY): 90 MINUTES
INSTALL NOTES:
-MAY REQUIRE DRILLING
-MAY REQUIRE FASCIA TRIMMING
-LOWER EXHAUST

INSTALLATION STEPS

- 1) Lower mufflers, remove (2) 8mm hex bolts from bumper beam (as shown), and 2 rubber plugs from spare tire well.
- 2) Raise hitch into position over exhaust, aligning bumper beam weld nuts with each side plate.
- 3) Install supplied 8mm hex bolts, 5/16" lock washers, and 5/16" flat washers into bumper beam weld nuts.
- 4) Fishwire a 1/2" x 1 1/4" carriage bolt and CM-SP12 spacer into the bumper beam rail on both sides as shown.
- 5) Install remaining 1/2" carriage bolts and round spacers into spare tire well as shown. Use silicone caulk or equivalent to seal holes from exhaust fumes and water. (Note: Some models may require drilling for Steps 4 and 5)
- 6) Torque all 8mm fasteners to 23 ft-lbs. Torque all 1/2" fasteners to 110 ft-lbs.

PERIODICALLY CHECK THIS RECEIVER HITCH TO ENSURE THAT ALL FASTENERS ARE TIGHT AND THAT ALL STRUCTURAL COMPONENTS ARE SOUND.