

11319

FORD FOCUS S,SE,& SES COUPE & SEDAN

9/21/2012

GROSS LOAD CAPACITY WHEN USED AS A WEIGHT CARRYING HITCH: 2,000 LBS. TRAILER WEIGHT & 200 LBS. TONGUE WEIGHT.
 DO NOT EXCEED VEHICLE MANUFACTURER'S RECOMMENDED TOWING CAPACITY.

Parts List				
ITEM	QTY	PART NUMBER	DESCRIPTION	
1	1	1_2 FISHWIRE	1/2" FISHWIRE	
2	2	3/8-16 X 1 1/2	HEX BOLT	
3	2	HFN3816	HEX FLANGE NUT	
4	2	3/8"	WASHER	
5	2	7/16-14	HEX FLANGE NUT	
6	2	7/16-14 x 1 1/2	HEX BOLT	
7	2	7/16 WASHER	WASHER	
8	2	HFN 1213	HEX FLANGE NUT	
9	2	1/2-13 x 1 1/2	CARRIAGE BOLT	
10	2	CM-SP6	.250 x 1.00 x 3.00" SQUARE HOLE SPACER	
11	1	CM-11319-PSB	.375" PASSENGER SIDE BRACKET	
12	1	CM-11319-DSB	.375" DRIVER SIDE BRACKET	

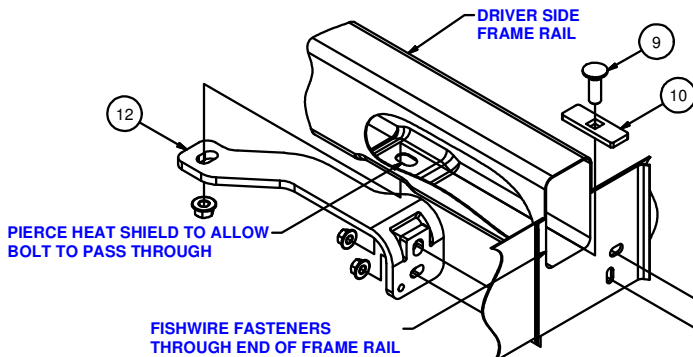
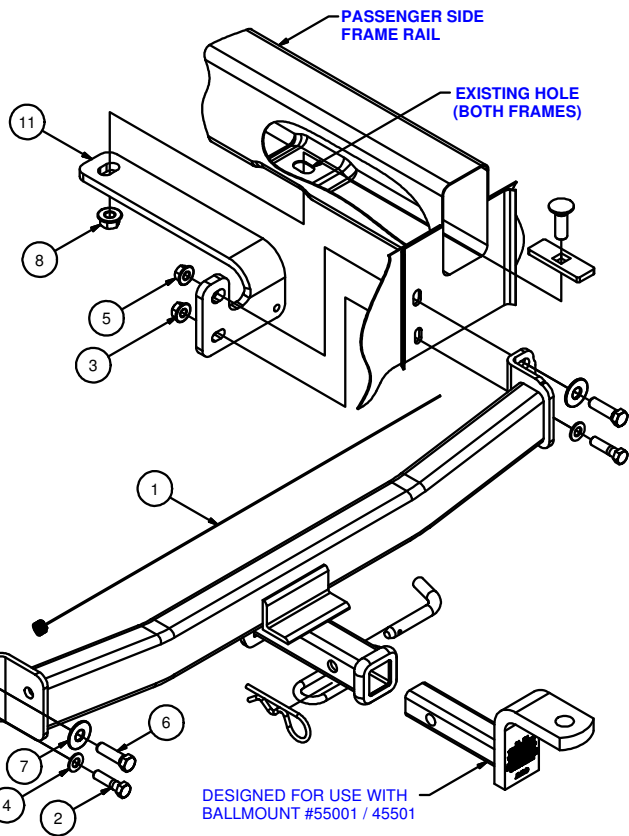

TOOLS REQUIRED

PHILLIPS HEAD SCREW DRIVER
3/8" DRIVE RATCHET
3/8" DRIVE TORQUE WRENCH
3/4" - 3/8" DRIVE SHORT SOCKET
11/16" - 3/8" DRIVE SOCKET
9/16" - 3/8" DRIVE SOCKET
5/8" BOXED END WRENCH
9/16" BOXED END WRENCH

HITCH WEIGHT: 27 LBS.

INSTALL TIME: 40 MINUTES

INSTALL NOTES:

- LOWER EXHAUST
- FISHWIRING REQUIRED
- MODIFY HEAT SHIELD

INSTALLATION STEPS

- 1) Lower exhaust from vehicle by unhooking the 3 rear rubber hangers.
- 2) Locate the hole existing on the driver side frame rail. Using a screwdriver or pointed tool, pierce the heat shield just below the hole in the frame rail. (Enlarge to approximately 1/2")
- 3) Fishwire the 1/2" carriage bolts and spacers through the end of the frame and into position as shown.
- 4) Install the passenger and driver side brackets over fishwired bolts, install flange nuts finger tight.
- 5) Raise hitch into position and aligning the brackets and vehicle flange holes with the hitch. Install the remaining fasteners.
- 6) Torque all 1/2" fasteners 110 lb-ft, all 7/16" fasteners to 70 lb-ft, and all 3/8" fasteners to 45 lb-ft.
- 7) Raise exhaust and re-install rubber hangers.

PERIODICALLY CHECK THIS RECEIVER HITCH TO ENSURE THAT ALL FASTENERS ARE TIGHT AND THAT ALL STRUCTURAL COMPONENTS ARE SOUND.



The **FIRST** Name
in Towing Products™

Trailer Hitches