

11307

CADILLAC CTS & STS 4 DOOR SEDAN

9/28/2012

GROSS LOAD CAPACITY WHEN USED AS A WEIGHT CARRYING HITCH: 2,000 LBS. TRAILER WEIGHT & 200 LBS. TONGUE WEIGHT.

DO NOT EXCEED VEHICLE MANUFACTURER'S RECOMMENDED TOWING CAPACITY.

WARNING: ALL NON-TRAILER LOADS APPLIED TO THIS PRODUCT MUST BE SUPPORTED BY AUXILIARY STABILIZING STRAPS.

** FAILURE TO PROPERLY SUPPORT NON-TRAILER LOADS WILL VOID PRODUCT WARRANTY**

Parts List			
ITEM	QTY	PART NUMBER	DESCRIPTION
1	6	7/16 - 14 x 1 3/4	CARRIAGE BOLT
2	2	CM-11307-SP	.250" SPACER
3	6	7/16-14	HEX FLANGE NUT

RUBBER ISOLATOR
REMOVAL DIAGRAM

This technique can be used if and Exhaust Hanger Removal Pliers is not available.

Using a 5/8" open end wrench, slide the wrench up to the rubber isolator, cradling the hanger rod as shown. Next place the flat edge of a pry bar between the wrench and the hanger stop or hanger rod. Then simply rotate the pry bar toward the wrench to remove the rubber isolator.

Note: Using a spray lubricant or soapy water on the hanger rod and the rubber isolator helps removal.

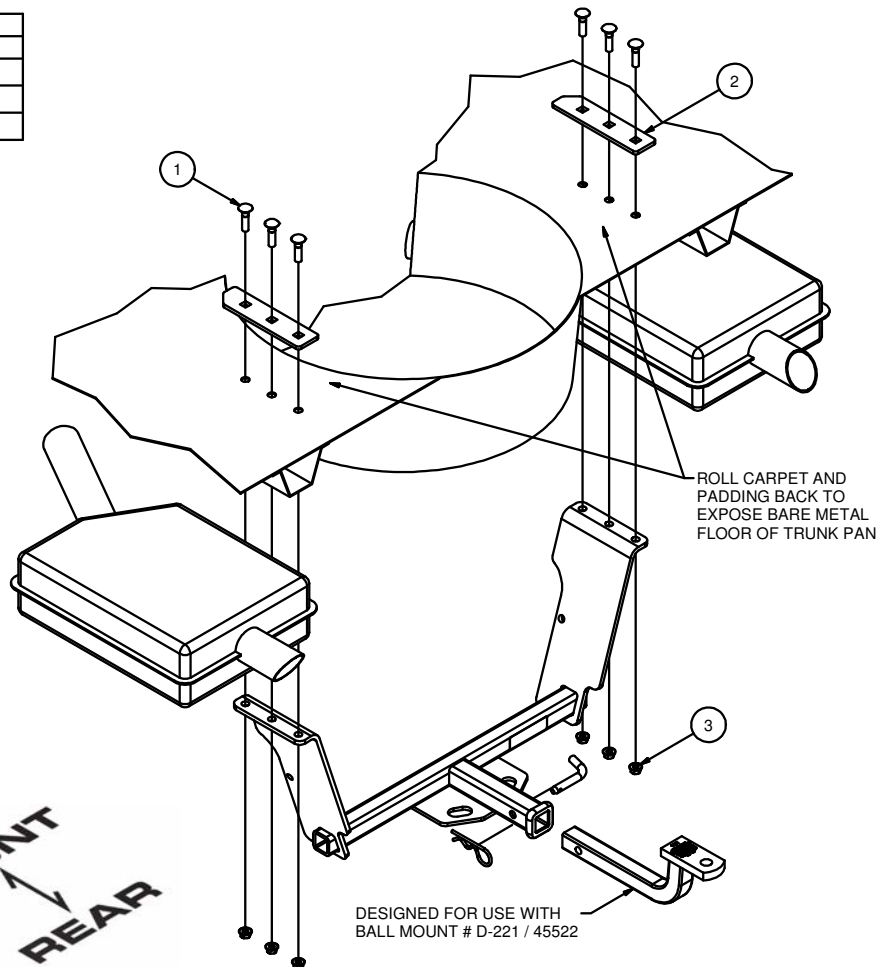
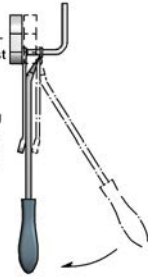

HITCH WEIGHT: 34 LBS.

INSTALL TIME

PROFESSIONAL: 60 MINUTES

NOVICE (DIY): 120 MINUTES

INSTALL NOTES:

-DRILLING REQUIRED

-LOWERING EXHAUST REQUIRED

INSTALLATION STEPS

- 1) Lower muffler(s) by removing the two (2) rearmost exhaust hangers and the one (1) forward exhaust hanger.
- 2) Open the trunk and remove the spare tire cover.
- 3) Roll the carpet and padding back to expose the bare metal floor of the trunk pan.
- 4) Raise hitch into position. Align the rear edge of hitch side plate flush against the frame end plate as shown and center hitch from side to side.
- 5) Using the hitch as a template mark and center punch the three (3) mounting holes on both sides.
- 6) Lower hitch. Drill 1/8 pilot holes up through bottom of trunk pan at center punched locations. Check hole alignment under vehicle and adjust if necessary. Enlarge holes to 1/2.
- 7) Position spacer plate over holes inside trunk and insert the carriage bolts through plate and trunk pan. (NOTE: Seal all holes drilled in vehicle to prevent entry of exhaust fumes into trunk.)
- 8) Raise hitch into position over carriage bolts and install flange nuts as shown.
- 9) Tighten all fasteners to 70 lb-ft.
- 10) Roll carpet and padding back in place and reinstall spare tire cover.
- 11) Reinstall the three (3) exhaust hangers removed in step 1.

PERIODICALLY CHECK THIS RECEIVER HITCH TO ENSURE THAT ALL FASTENERS ARE TIGHT AND THAT ALL STRUCTURAL COMPONENTS ARE SOUND.



The **FIRST** Name
in Towing Products™

Trailer Hitches