

# 11290 98-07 HONDA ACCORD (INC. HYBRID), 99-03 ACURA 2.5 & 3.2 TL & 01-03 ALL CL

9/19/2014

GROSS LOAD CAPACITY WHEN USED AS A WEIGHT CARRYING HITCH: 2,000 LBS. TRAILER WEIGHT & 200 LBS. TONGUE WEIGHT.

\*\*\*DO NOT EXCEED VEHICLE MANUFACTURER'S RECOMMENDED TOWING CAPACITY.\*\*\*

**WARNING: ALL NON-TRAILER LOADS APPLIED TO THIS PRODUCT MUST BE SUPPORTED BY AUXILIARY STABILIZING STRAPS.**

\*\* FAILURE TO PROPERLY SUPPORT NON-TRAILER LOADS WILL VOID PRODUCT WARRANTY\*\*

| Parts List |     |                  |  |
|------------|-----|------------------|--|
| ITEM       | QTY | PART NUMBER      | DESCRIPTION                            |
| 1          | 3   | HFN 1213         | HEX FLANGE NUT                         |
| 2          | 3   | CM-SP1           | .250 x 1.50 x 2.00" SQUARE HOLE SPACER |
| 3          | 1   | 1/2 - 13 x 2 1/2 | HEX BOLT                               |
| 4          | 2   | CM-SP4           | .250 x 1.50 x 3.00" SQUARE HOLE SPACER |
| 5          | 2   | 1/2-13 x 1 3/4   | CARRIAGE BOLT                          |

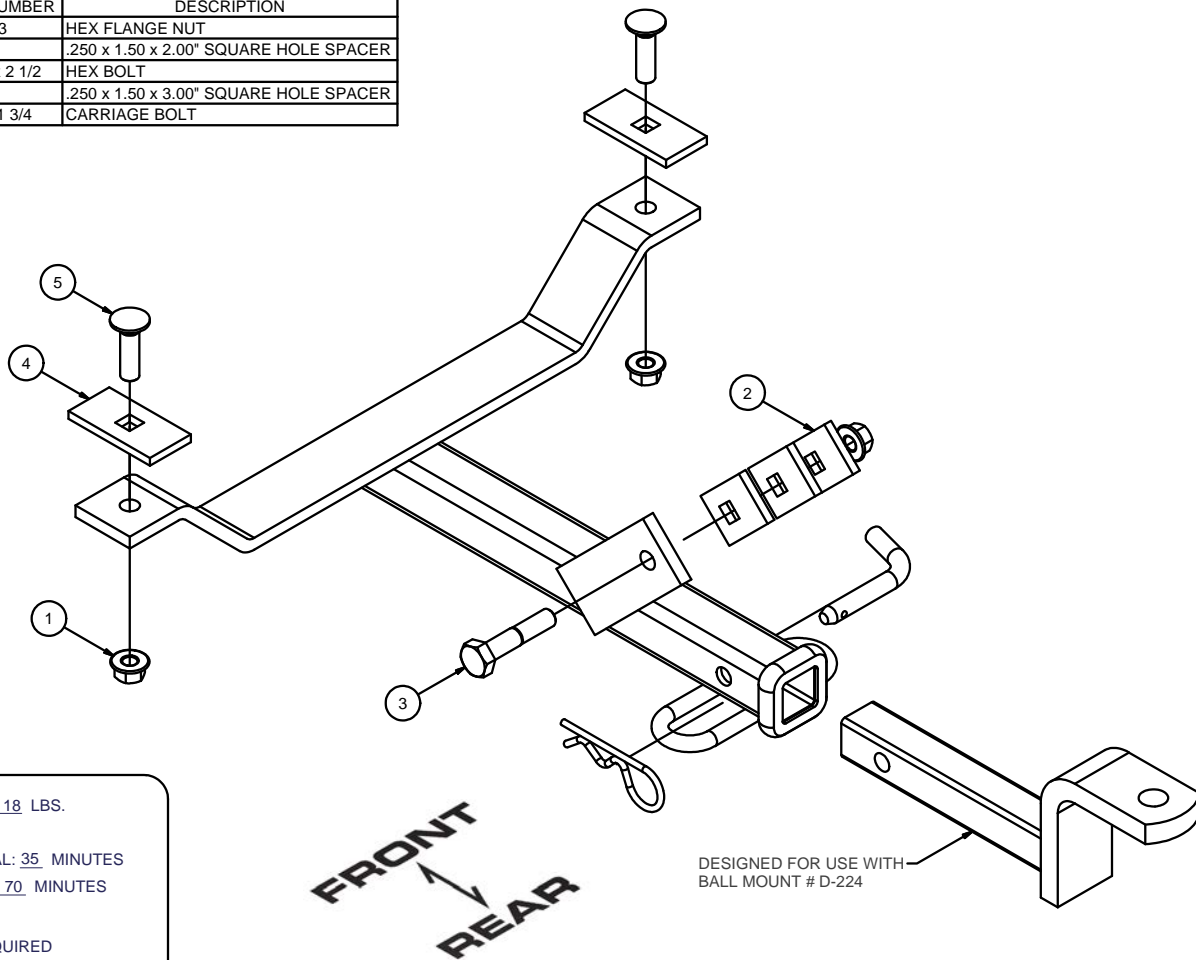

HITCH WEIGHT: 18 LBS.

#### INSTALL TIME

PROFESSIONAL: 35 MINUTES

NOVICE (DIY): 70 MINUTES

#### INSTALL NOTES:

- DRILLING REQUIRED
- UNINSTALL/INSTALL SPARE TIRE

## INSTALLATION STEPS

- 1) REMOVE SPARE TIRE FROM TRUNK.
- 2) ATTACH HITCH TO TOW HOOK WITH ATTACHMENT POINT NEAREST END OF RECEIVER TUBE. TWO SPACERS ON DRIVER SIDE OF HOOK, AND ONE ON THE PASSENGER SIDE OF HOOK, BOLTED TOGETHER WITH 1/2" x 2 1/2 LG. BOLT
- 3) USING HITCH AS TEMPLATE, DRILL TWO 1/2" HOLES IN TRUNK PAN.
- 4) INSTALL 1/2-13 BOLTS, BLOCKS, LOCK WASHERS AND NUTS AS SHOWN ABOVE.
- 5) SEAL HOLES DRILLED IN TRUNK PAN TO PREVENT INTRUSION OF EXHAUST FUMES AND WATER.
- 6) REINSTALL SPARE TIRE IN TRUNK.
- 7) TORQUE ALL 1/2" FASTENERS TO 110 LB.-FT.

PERIODICALLY CHECK THIS RECEIVER HITCH TO ENSURE THAT ALL FASTENERS ARE TIGHT AND THAT ALL STRUCTURAL COMPONENTS ARE SOUND.



# CURT

The **FIRST** Name  
in Towing Products™

Trailer Hitches