

11186**AUDI A4 SEDAN**

10/19/2012

GROSS LOAD CAPACITY WHEN USED AS A WEIGHT CARRYING HITCH: 2,000 LBS. TRAILER WEIGHT & 200 LBS. TONGUE WEIGHT.

*****DO NOT EXCEED VEHICLE MANUFACTURER'S RECOMMENDED TOWING CAPACITY.*******WARNING: ALL NON-TRAILER LOADS APPLIED TO THIS PRODUCT MUST BE SUPPORTED BY AUXILIARY STABILIZING STRAPS.****** FAILURE TO PROPERLY SUPPORT NON-TRAILER LOADS WILL VOID PRODUCT WARRANTY****

Parts List			
ITEM	QTY	PART NUMBER	DESCRIPTION
1	2	CM-11186-BP	BOLT PLATE
2	4	1/2-13 x 4 1/2	CARRIAGE BOLT
3	6	HFN 1213	HEX FLANGE NUT
4	2	1/2-13 x 1 3/4	CARRIAGE BOLT
5	2	CM-SP62	.250" SPACER PLATE

TOOLS REQUIRED
T-25 TORX DRIVER
3/4" SOCKET
SWIVEL EXTENSION
12" EXTENSION
RATCHET
ROTARY CUTTING TOOL
TORQUE WRENCH
SILICONE CAULK

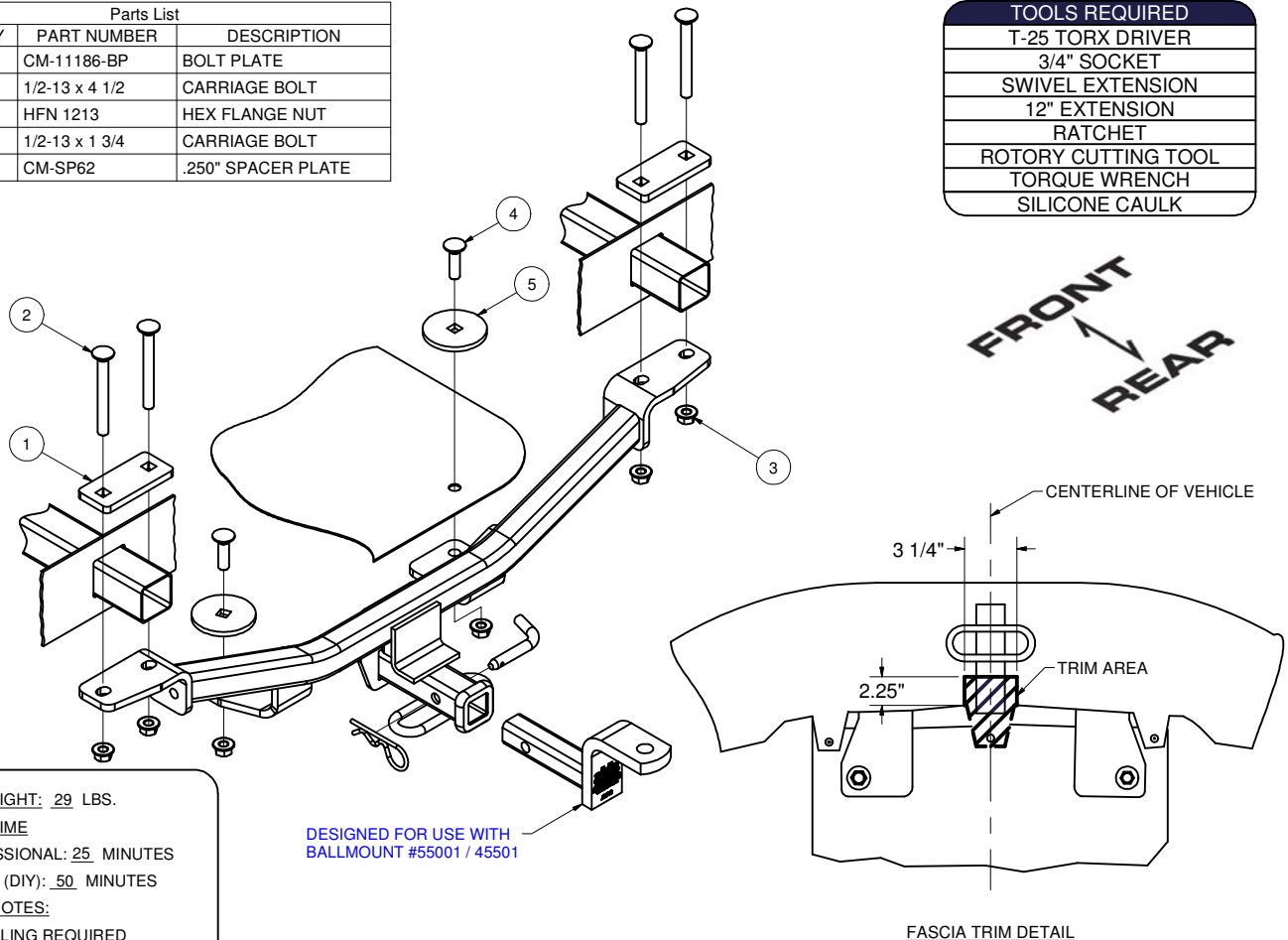

HITCH WEIGHT: 29 LBS.

INSTALL TIME

PROFESSIONAL: 25 MINUTES

NOVICE (DIY): 50 MINUTES

INSTALL NOTES:

-NO DRILLING REQUIRED

-FASCIA TRIMMING REQUIRED

DESIGNED FOR USE WITH
BALLMOUNT #55001 / 45501**INSTALLATION STEPS**

- 1) Remove the (3) screws holding the plastic bumper fascia to the bottom of the trunk pan.
- 2) Remove the spare tire and jack from inside the trunk.
- 3) Remove the (2) rearmost plastic drain plugs from the bottom of the trunk pan.
- 4) Using the rotary cutting tool, remove material from the lower part of the plastic fascia as shown in the Fascia Trim Detail above.
- 5) While gently pulling the fascia down and rearward, install the bolt plates and 1/2-13 x 4 1/2 long carriage bolts on top of the bumper support tubes.
- 6) Raise the hitch into position, aligning the slots in the hitch brackets with the long carriage bolts and loosely secure the hitch with hex flange nuts as shown.
- 7) Seal the drain holes in the trunk pan with silicone caulk. Insert a CM-SP-62 spacer and 1/2-13 x 1 3/4 long carriage bolt into each of the drain holes and secure from below with hex flange nuts as shown.
- 8) Torque all 1/2" hardware to 110 ft-lbs.
- 9) Reinstall the two outer screws through the bumper fascia and into the trunk pan.
- 10) Reinstall the jack and spare tire into the trunk.

PERIODICALLY CHECK THIS RECEIVER HITCH TO ENSURE THAT ALL FASTENERS ARE TIGHT AND THAT ALL STRUCTURAL COMPONENTS ARE SOUND.The **FIRST** Name
in Towing Products™

Trailer Hitches