

11109

95-99 CHEVROLET CAVALIER (EXCEPT Z24)
 00-05 CHEVROLET CAVALIER (EXCEPT LS SPORT)
 95-05 PONTIAC SUNFIRE (EXCEPT CONVERTIBLE, GT COUPE, AND LS SPORT)

GROSS LOAD CAPACITY WHEN USED AS A WEIGHT CARRYING HITCH: 2,000 LBS. TRAILER WEIGHT & 200 LBS. TONGUE WEIGHT.

DO NOT EXCEED VEHICLE MANUFACTURER'S RECOMMENDED TOWING CAPACITY.

WARNING: ALL NON-TRAILER LOADS APPLIED TO THIS PRODUCT MUST BE SUPPORTED BY AUXILIARY STABILIZING STRAPS.

** FAILURE TO PROPERLY SUPPORT NON-TRAILER LOADS WILL VOID PRODUCT WARRANTY**

Parts List			
ITEM	QTY	PART NUMBER	DESCRIPTION
1	1	CM-438-FW	7/16" FISHWIRE TOOL
2	2	CM-SP31	.250 x 1.75 x 2.00" U-SHAPE SPACER
3	2	CM-SP7	.250 x 1.00 x 2.00" SQUARE HOLE SPACER
4	2	7/16-14	HEX FLANGE NUT
5	2	3/8-16 X 1 1/2	HEX BOLT
6	2	3/8"	CONICAL TOOTHED WASHER
7	2	HFN3816	HEX FLANGE NUT
8	2	7/16 - 14 x 1 3/4	CARRIAGE BOLT

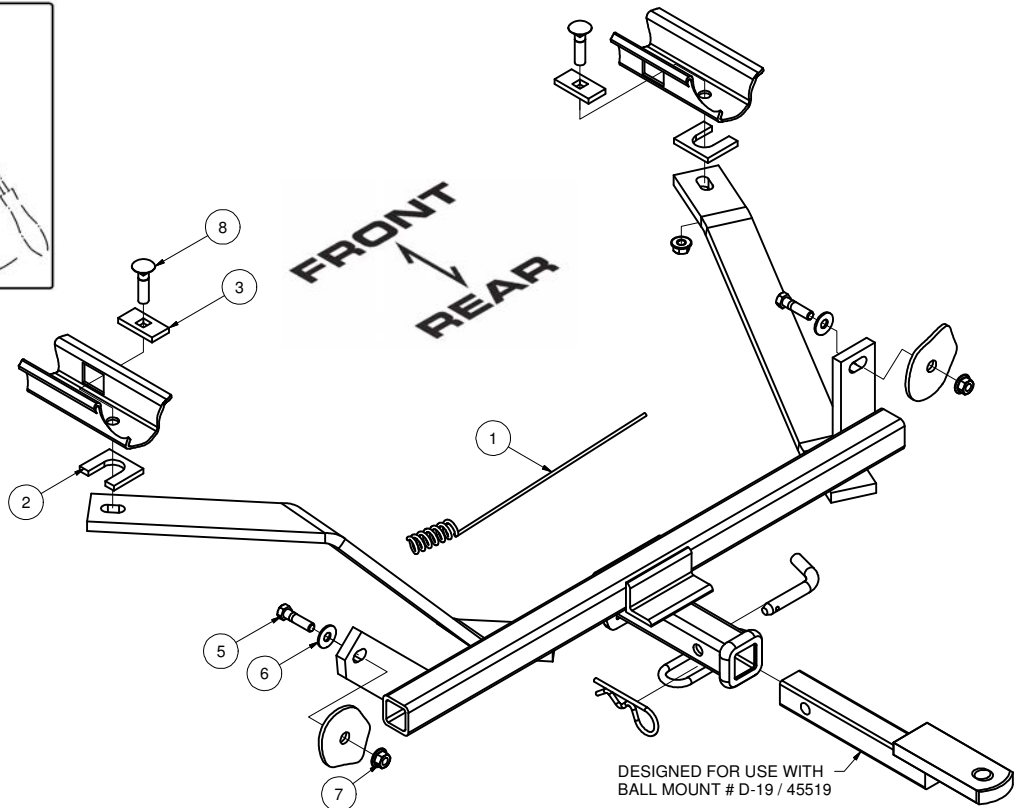
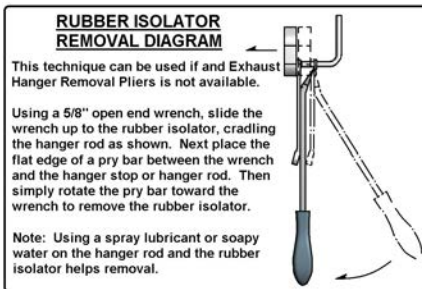
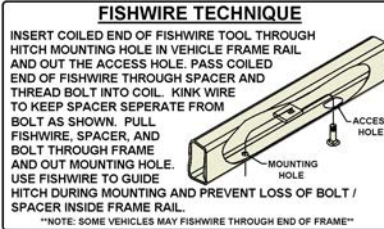

HITCH WEIGHT: .37 LBS.

INSTALL TIME

PROFESSIONAL: .45 MINUTES

NOVICE (DIY): .90 MINUTES

INSTALL NOTES:

-LOWER EXHAUST

-DRILLING REQUIRED

INSTALLATION STEPS

- 1) Remove two (2) 8mm bolts from inboard lower corners which attach bumper brackets to vehicle frame. Enlarge holes with 7/16 drill bit.
- 2) Temporarily lower exhaust system.
- 3) Remove the (two) rearmost exhaust heat shield rivets. Raise hitch up into position and trim heat shield to provide clearance for hitch installation.
- 4) Raise hitch into position, lining up holes in hitch upright mounting plates with holes in forward surface of vehicle. Install 3/8 fasteners through valence panel and hitch upright bracket, each side.
- 5) Fishwire 7/16" fasteners with spacers through square access hole on inboard side of frame.
 Note: Use of u-shape block on passenger side, place u-shape block if nessesary on driver side.
- 6) Reattach exhaust system.
- 7) Torque 3/8" fasteners to 45 LB.-FT. and 7/16" fasteners to 70 LB.-FT.

PERIODICALLY CHECK THIS RECEIVER HITCH TO ENSURE THAT ALL FASTENERS ARE TIGHT AND THAT ALL STRUCTURAL COMPONENTS ARE SOUND.



The **FIRST** Name in Towing Products™

Trailer Hitches